

# **GPV-1 PRO**

**1:8 R/C MOTORCYCLE**



**BUILD MANUAL**

**VENOM**  
[www.venom-group.com](http://www.venom-group.com)



Thank you for purchasing the Venom GPV-1 GP Motorcycle. This revolutionary R/C Motorcycle was designed with die hard racers, motorcycle enthusiasts and beginning R/C Hobbyists in mind. Racers will love the unlimited adjustability and tuneability of the chassis. Enthusiasts will enjoy it's scale realism, and beginning and novice hobbyists will enjoy how easy the GPV-1 is to drive. We hope you have as much fun with your GPV-1 as we did creating it. Not only did you purchase the best R/C motorcycle but you have also joined the Venom Team and it's world class product line and customer service. Some information contained herein may not be relevant to consumers who purchased the GPV-1 in Ready-To-Run (RTR) Pre-Built Form.

## EQUIPMENT NEEDED



AA Batteries  
x8 for Radio (15290)



\*Micro/ Mini Servo  
16.3mm Max.  
26.4mm Min.  
42mm Max.

### Suggested Servo List:

Futaba	JR	Airtronics
9602	DS34215A	94145z
9650	DS3301	94141z
S3110	DS3517	
Hitec		KO Propo
HS-56HB	23550	PDS 949ICS
HS-81	3121	
HS-85	321	
HS-225		

\* The GPV-1 chassis can accept multiple servo sizes. If you plan to change servos or use the Optional Brake Kit (0355) please refer to the Suggested Servo List for a complete list of compatible servos.

## SUGGESTED TOOL KIT



5.5mm Nut Driver



Screw Driver No. 1



No. 2



Needle Nose Pliers



Side Cutters



Hex Driver .5, 1.0, 2.0, 2.5mm



Curved Scissors



Emery Board



Hobby Knife/ #11 Blade



Double Sided Tape



Bottom Tap



CA Glue (Thin)



Thread Lock



Shock Oil  
35 Wt.



Ruler



Calipers

## TOOLS INCLUDED

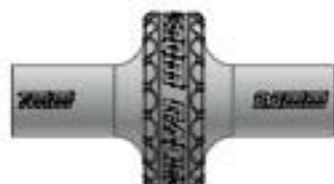

## PART SIZE REFERENCE

0150a  
10.4mm Standoff



0150b  
12mm Standoff



0150c  
16mm Standoff



0150d  
4mm Standoff



0153  
28T Chain Sprocket

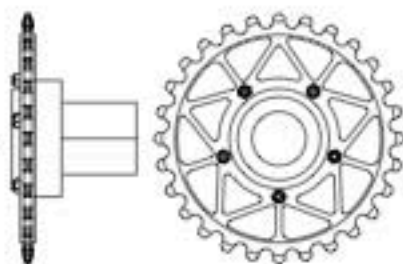

0155  
64T Spur 0.5M

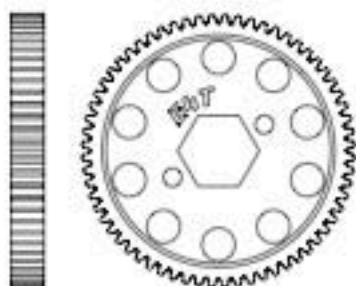

0156  
Battery Plate

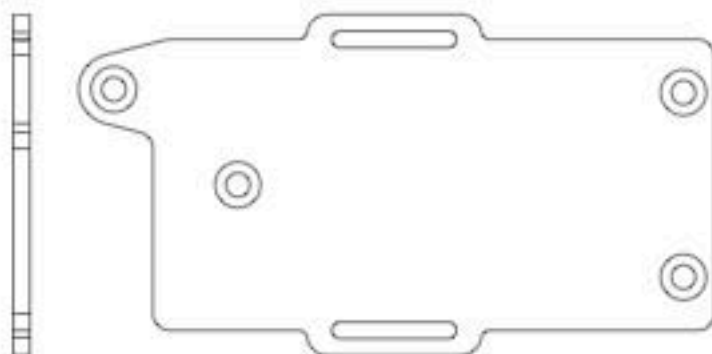

0157  
Steering Stem

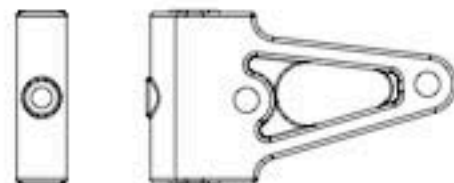

0159  
Fr. Battery Tray Mount



0160a  
Front Brake Rotor

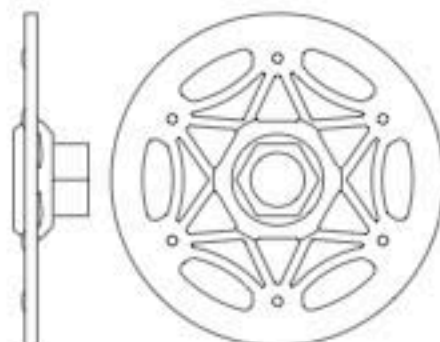

0160b  
Rear Brake Rotor

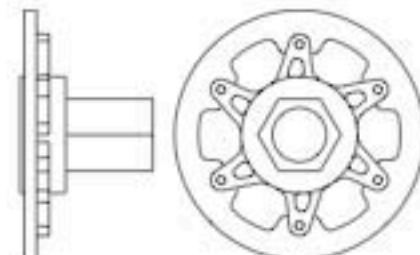

0162a  
Lft Fork Lower Leg

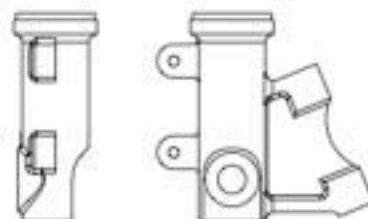

0162b  
Rt Fork Lower Leg

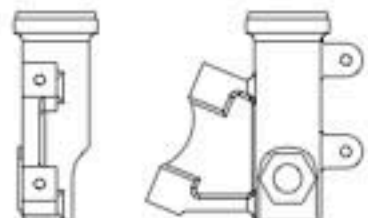

0163a/b  
Lft & Rt Chain Tensioner



0163a Left

0163b Right

0164a  
Lft Side Chassis Block

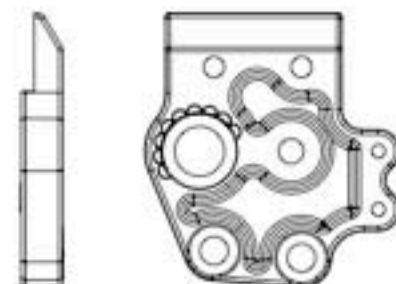

0164b  
Rt Side Chassis Block

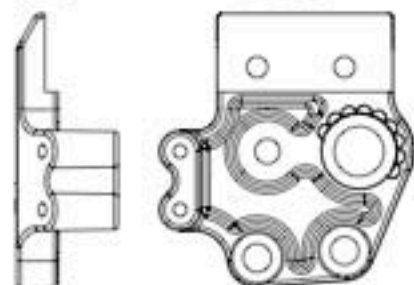





0165  
O-Ring Spacer Flanged



0166  
O-Ring Spacer Flat



0168a  
Rr Cross Member

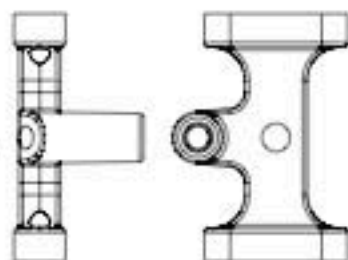

0168b  
Rr Body Post

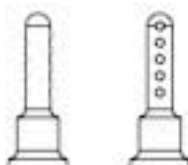

0170a  
RTR Servo Mount

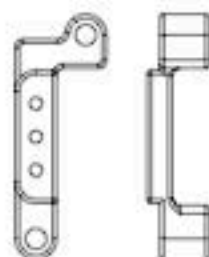

0170b  
Servo Mount Washer

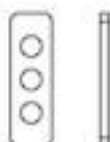

0173  
Swing Arm

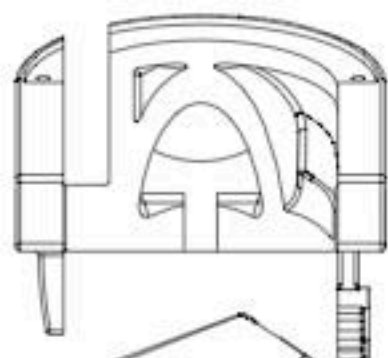

0174  
Swing Arm Stop

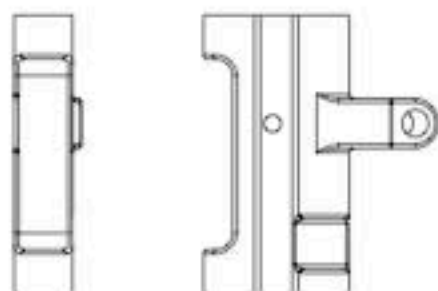

0175a  
Triple Clamp Bottom



0175b  
Triple Clamp Top



0177a  
Front Track Stand Frame

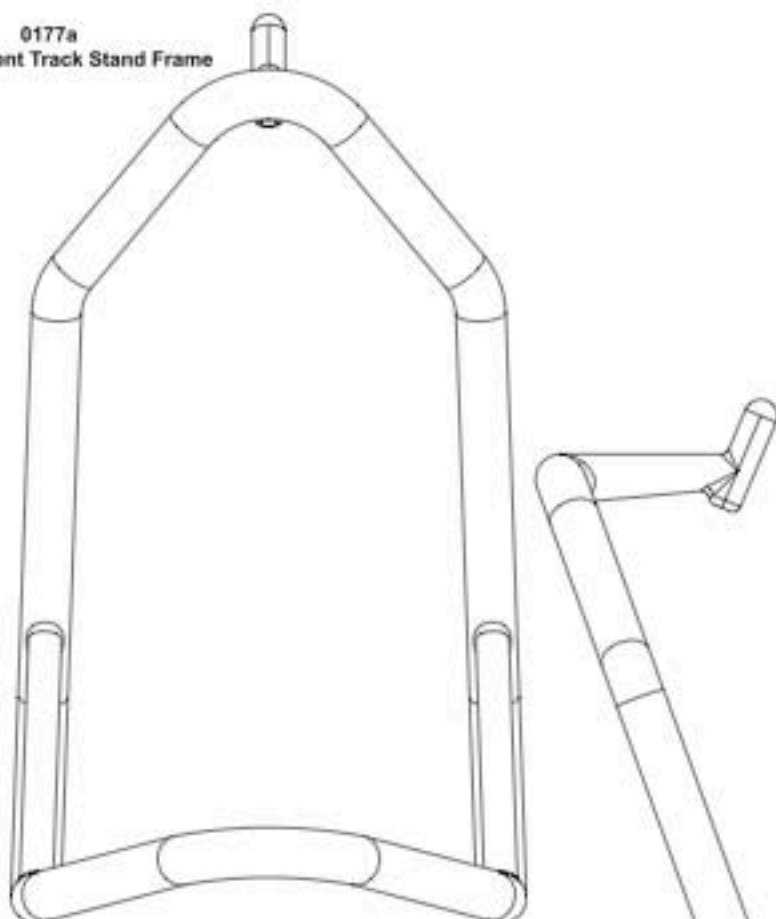

0177b  
Track Stand Wheels

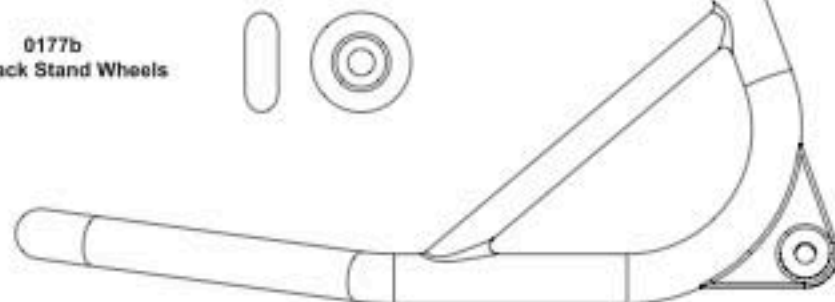

0177c  
Rear Track Stand Frame

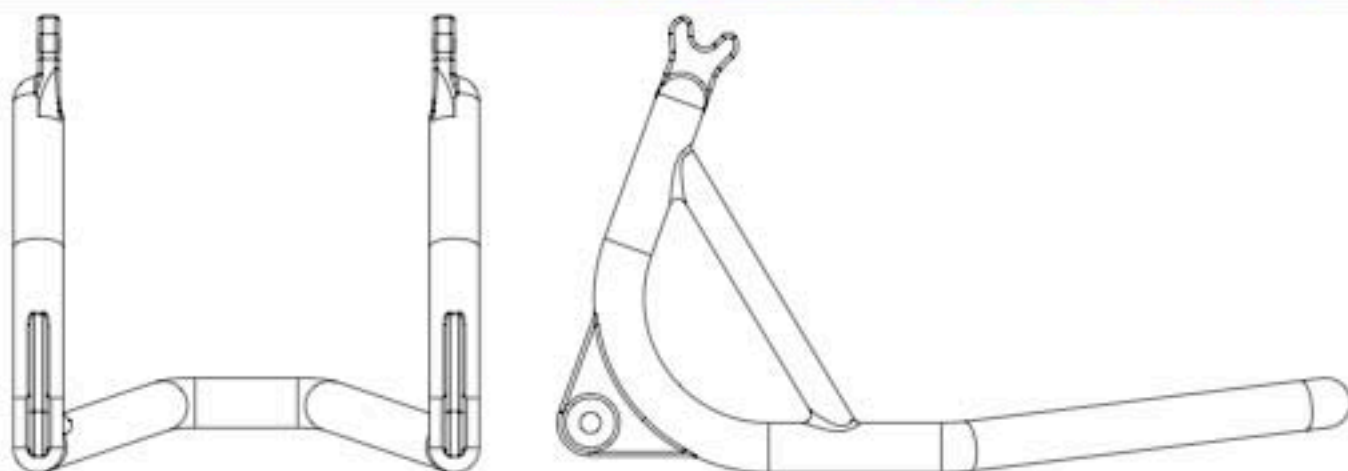

0179  
Nut Driver

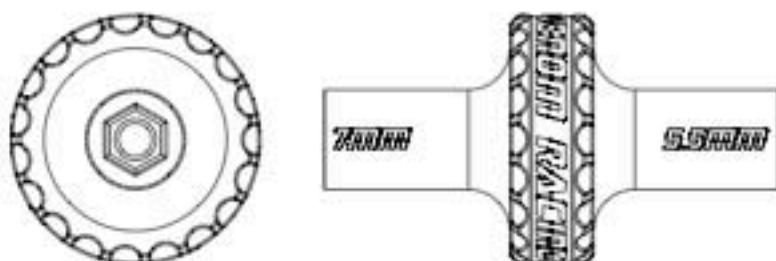

0180  
Open Ended Wrench



0183a  
Front Body Mount



0183b  
Tank Body Mount

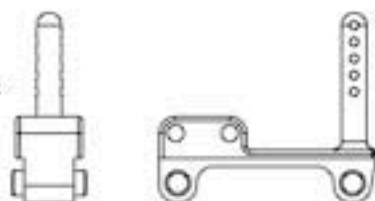

0183c  
Washer



0184  
Front Brake Caliper

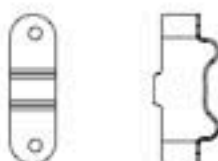

0185  
Front Fender

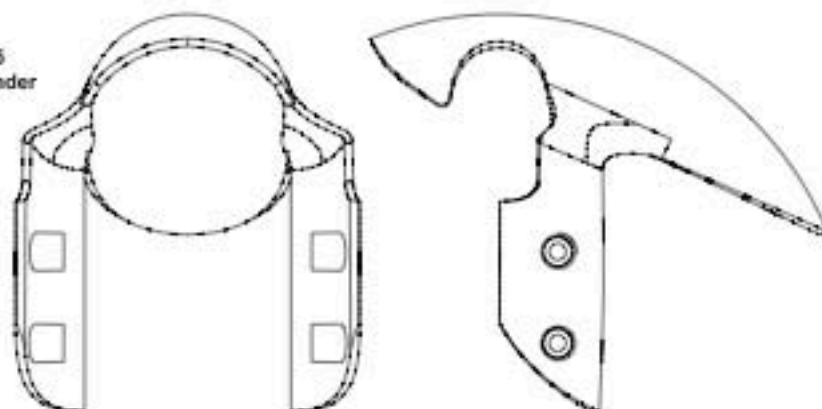

0186a  
Left Foot Peg



0186b  
Right Foot Peg





0187a  
Left Handle Bar

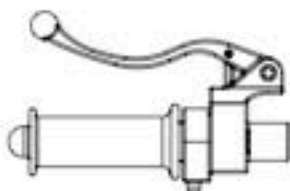

0187b  
Right Handle Bar

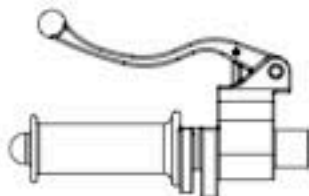

0188a  
Left Rear Wire Mount



0188b  
Right Rr Wire Mount



0188c  
Front Wire Mount Cap



0188d  
Lft Inner Wire Mount



0188e  
Rt Inner Wire Mount



0190a  
Steering Damper Shaft



0190b  
Steering Damper Tube



0194  
Rear Fender

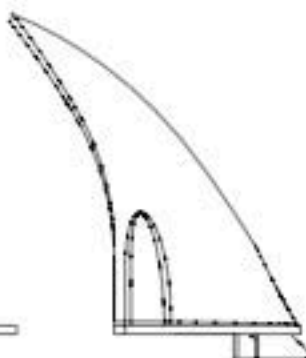
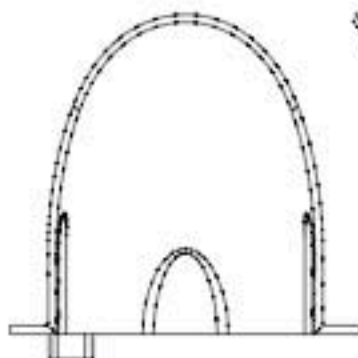

0195  
Rr Shock Lower Bushing



0196a  
Rr Shock Lower Pivot



0196b  
Rr Shock Upper Pivot



0197  
Rr Shock Spring Perch



0202  
Scale Exhaust

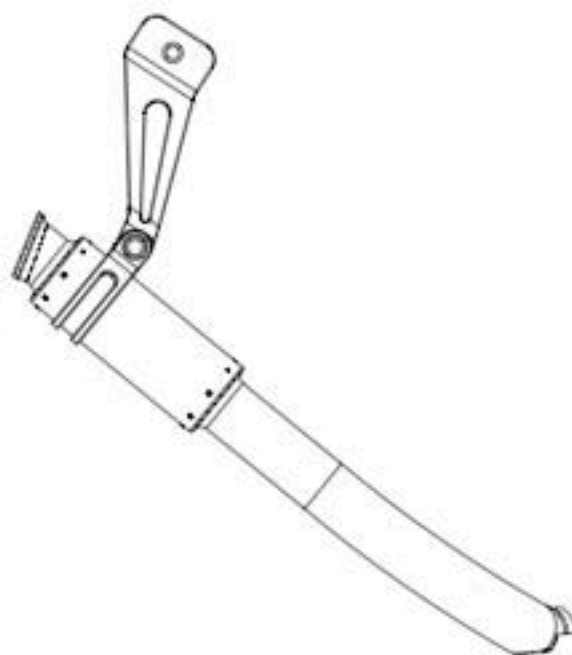
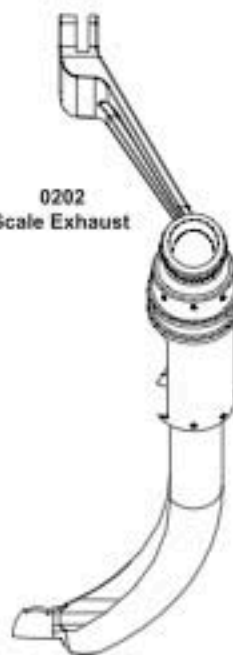

0208  
Center Chassis Standoff



0209a  
Fork Tube



0209b  
Lower Fork Cap



0213  
Motor Mount





0214  
Rear Shock Body

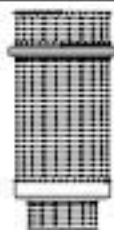

0226  
Rear Shock Spring



0215  
Rear Shock Lower Cap



0227  
Shock Pivot Shaft



0216  
Rear Shock Upper Cap



0228  
Shock Shaft



0230a  
Steering Link Spring



0230b  
Steering Link



0218  
Shock Collar



0230c  
Steering Ball End



0230d  
Steering Spring Collar



0219  
Spur Gear Hub

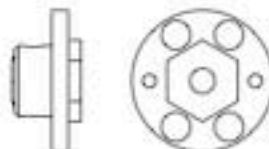

0230e  
Steering Link  
Servo Mount



0220  
Chain



0221  
Drive Shaft



0231  
Swing Arm Pin



0222  
Fork Shaft



0223a  
Front Wheel Axle



1435  
14T Pinion 0.5 MOD



0223b  
Rear Axle



0223c  
Front Axle Spacer



0234  
Front Sprocket Spacer



0223d  
Front Axle Spacer



0236a  
Threaded Pivot Ball

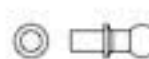

0224  
Guide Wire

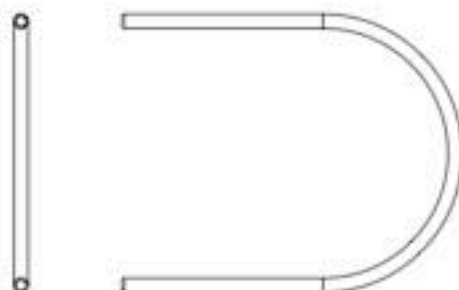

0236b  
Threaded Pivot Ball Short



0238  
11T Chain Sprocket

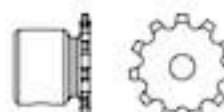

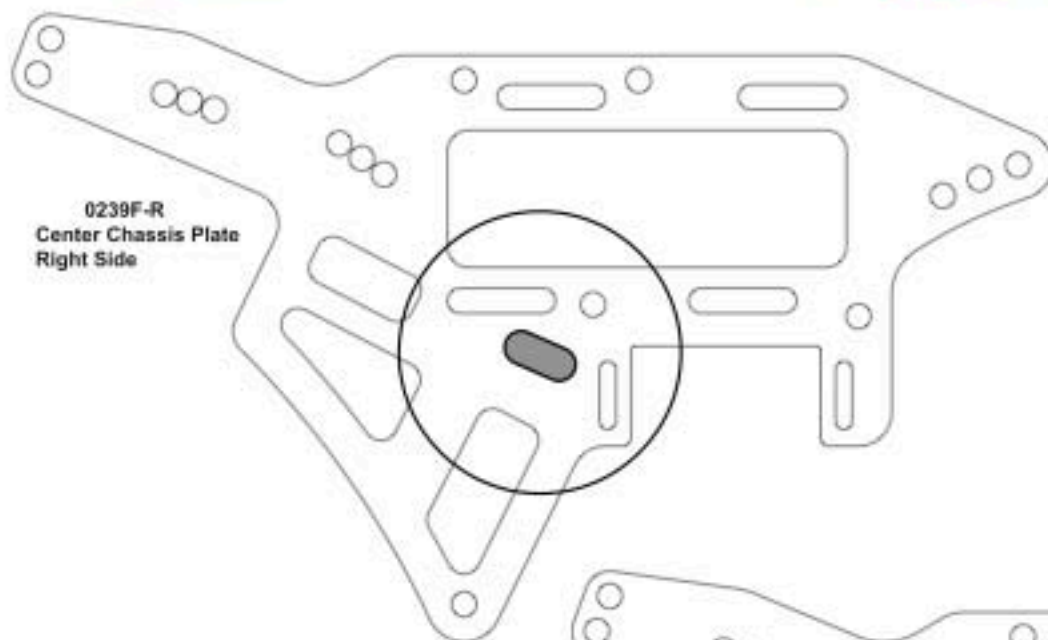

0239F-R  
Center Chassis Plate  
Right Side

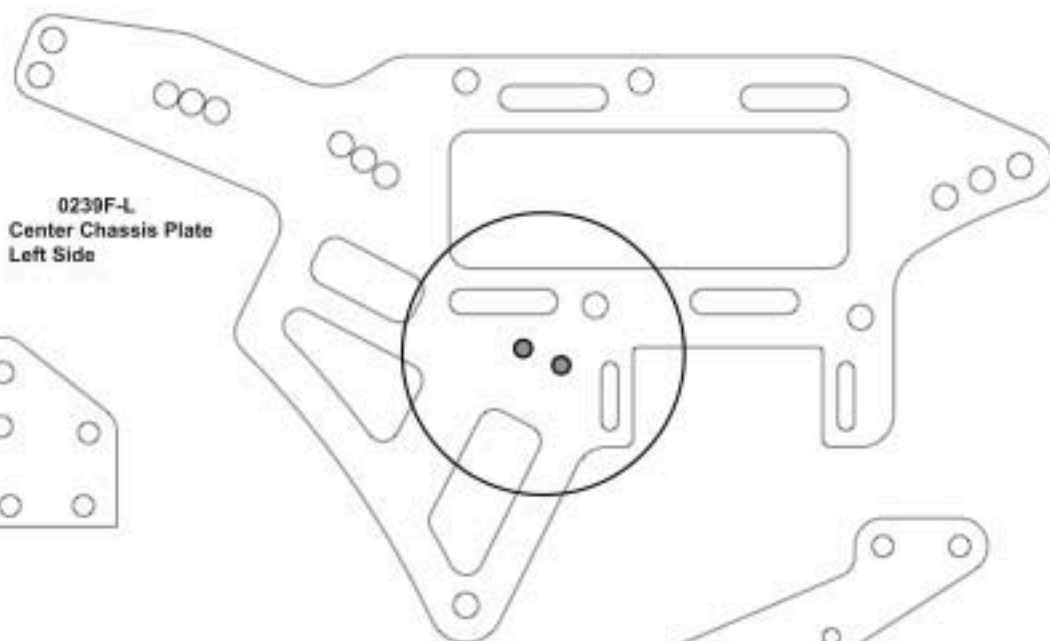

0239F-L  
Center Chassis Plate  
Left Side



0240F  
Lft Side Chassis Plate

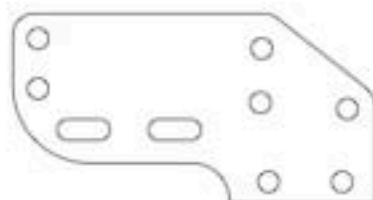

0242F  
Rt Side Chassis Plate

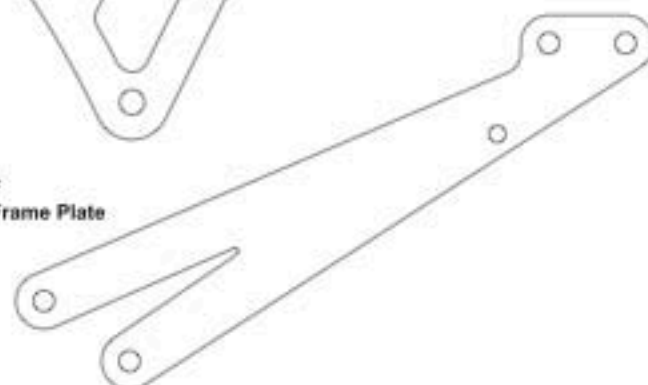

0241F  
Rear Sub Frame Plate





0268  
Flanged Steering Bushing



0272  
Shock Collar O-Ring



0270  
Battery Strap



0269  
Steering Stem Pin



0275  
Front Wheel Y Spoke



0273  
Fork Spring



0274  
Fork Spring Perch



0275  
Rear Wheel Y Spoke



0277-1  
1 Hole Rear Shock Piston



0283-2  
2 Slot Fork Piston



0285  
10x6x3mm Wheel Bearing



0277-2  
2 Hole Rear Shock Piston



0283-3  
3 Slot Fork Piston



0286  
Rear Shock O-Ring Seal



0277-3  
3 Hole Rear Shock Piston



0283-4  
4 Slot Fork Piston



0287  
O-Ring 5.8x8.9mm - GPV1



0277-4  
4 Hole Rear Shock Piston



0284  
6x3x2.5mm Bearing



0288  
Rubber Shock Bladder



0283-1  
1 Slot Fork Piston



0326  
Body Clip





1167V5  
Front Tire V5 Hard - GPV1  
17x10.5x57.5mm



1168V5  
Rear Tire V5 Hard - GPV1  
23x12.5x61.5mm



1176M  
Front Tire Insert Medium - GPV1



1177M  
Rear Tire Insert Medium - GPV1





## BUILD STEPS

### STEP 1

### OPTION PART

Replace 0170a with: 0327

Alloy Servo Mount Set

10052  
M2x6mm x4

10067  
M3x8mm x4

10095  
M2 Washer x4

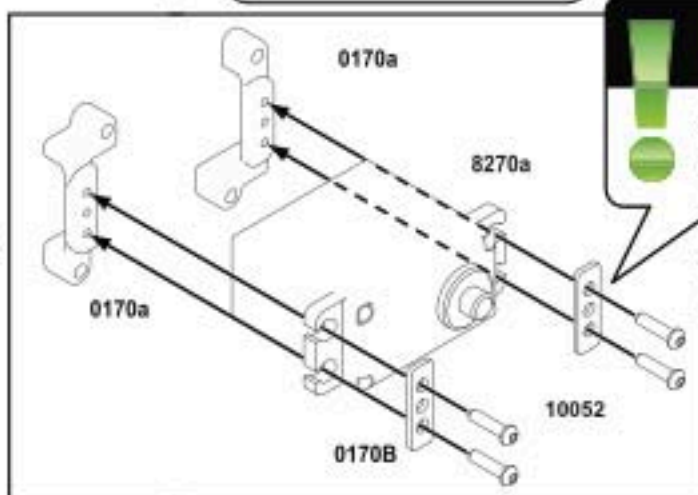

### BUILD NOTE

Some Servos may require the use of the 0267 kit supplied washers.

### BUILD NOTE

For the best fit and finish, use the proper size bottom tap to prethread the screw holes on hard plastic parts. Pre threading the holes will help prevent cross threading and striping the parts.

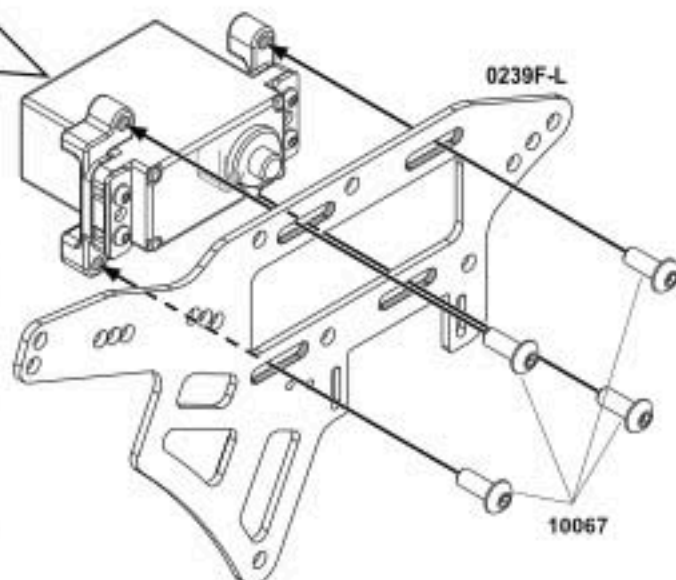

### STEP 2

0208 x2

0236 x1

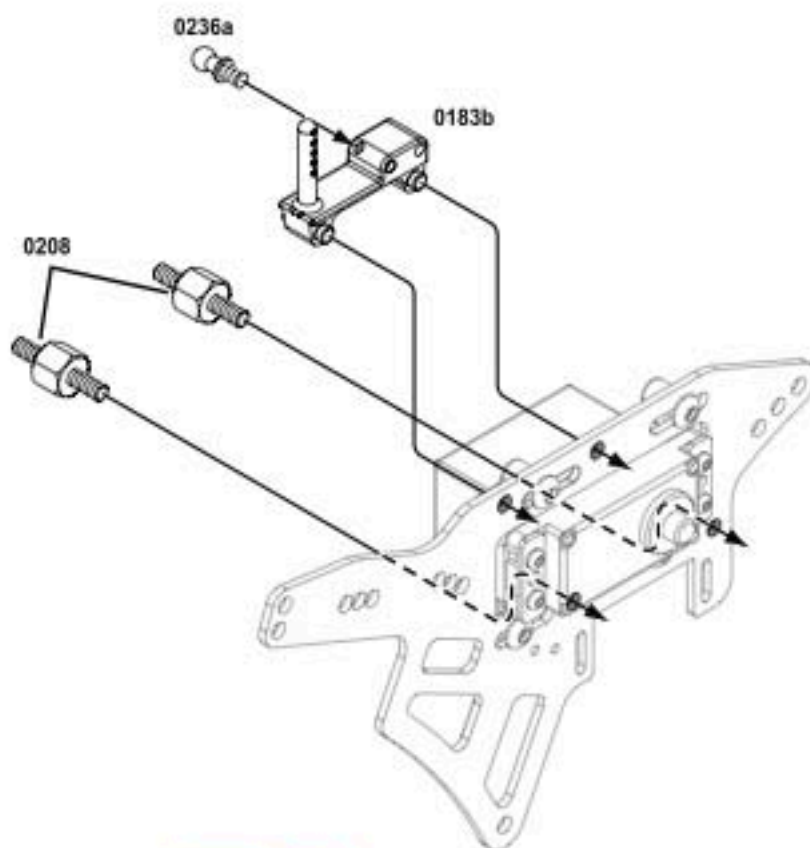

## STEP 3

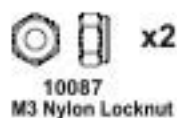

### OPTION PART

Replace 0157 with: 0329

Alloy Steering Stem Set or  
0323 Option Steering  
Stem (Plastic) GPV1.

### OPTION PART

If you are using the optional  
Brake Kit (0355) start  
installation now.

The lower edge of 0157 must be  
parallel to the lower edge of the chassis  
plates.

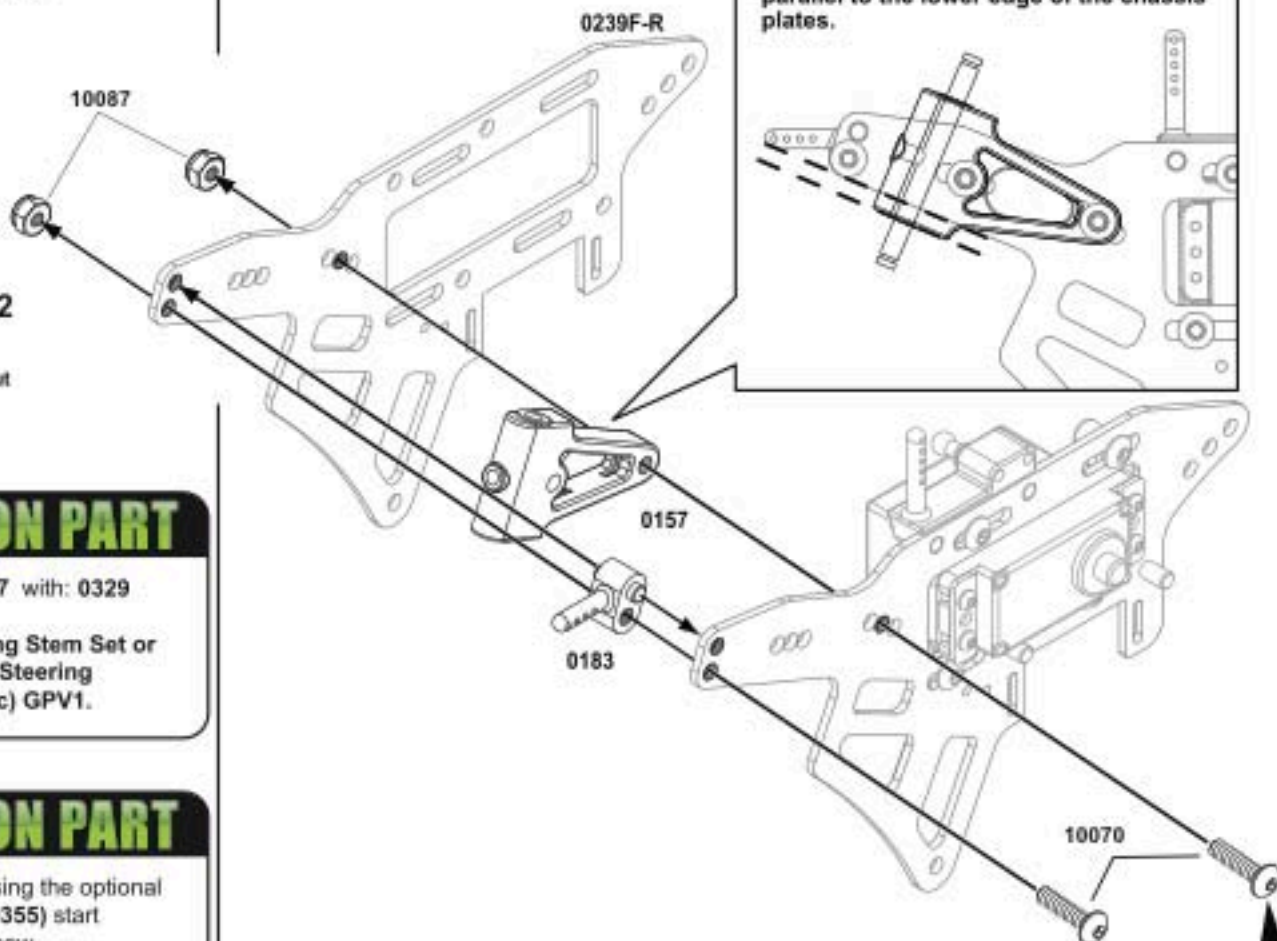

### BUILD NOTE

Do not fully tighten this screw as you  
will need to rotate the part in a future  
build step.

## STEP 4

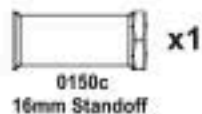
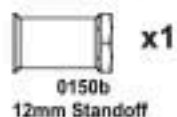
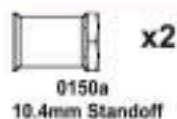

### OPTION PART

Replace 0150a,b,c,d  
with:  
0336  
Alloy Stand Off Set

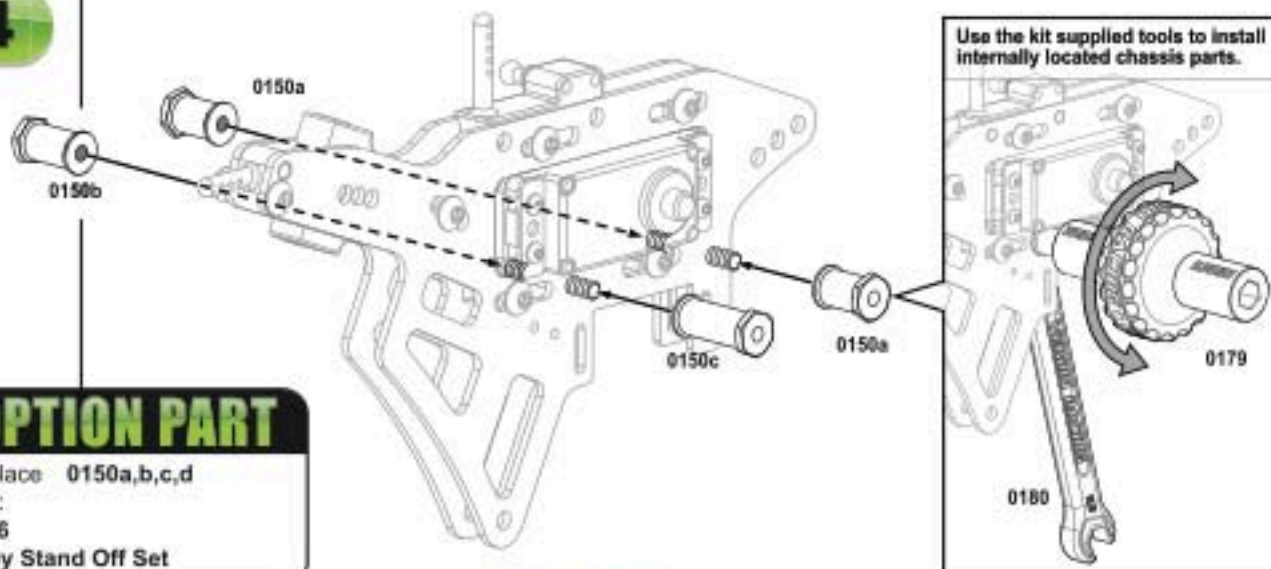

Use the kit supplied tools to install  
internally located chassis parts.



## STEP 5



x1

188b



x1

0188c



x1

0188e



x4

10066

M3x6mm

Right Side

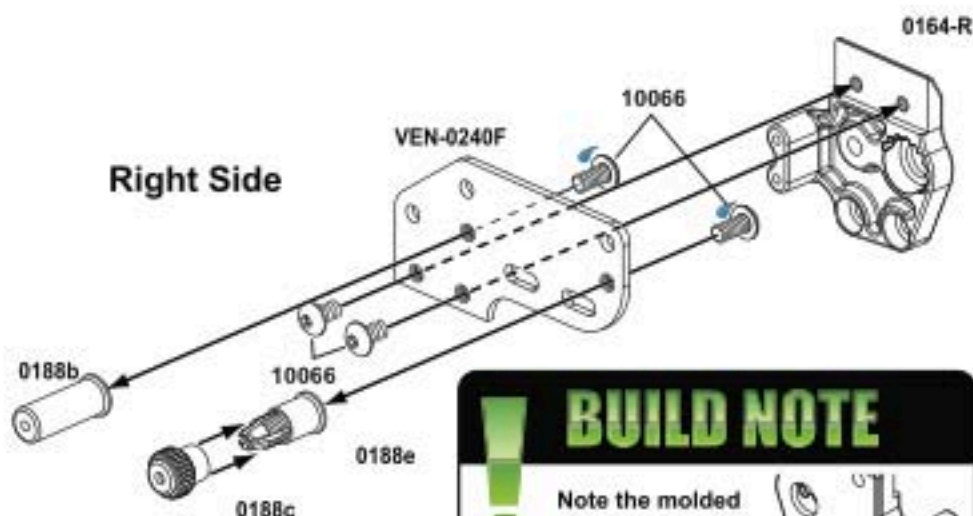

8885  
Venom Thread Lock

### OPTION PART

Replace 0164-R with: 0330

Alloy Chassis Block Set

### BUILD NOTE

Note the molded letter "R" denotes a right side part.

## STEP 6



x3

10066

M3x6mm



x1

10067

M3x8mm



x1

10045

M3x10mm



x1

10087

M3 Nylon Locknut

### OPTION PART

Replace 0168 with: 0329

Alloy Steering Stem Set

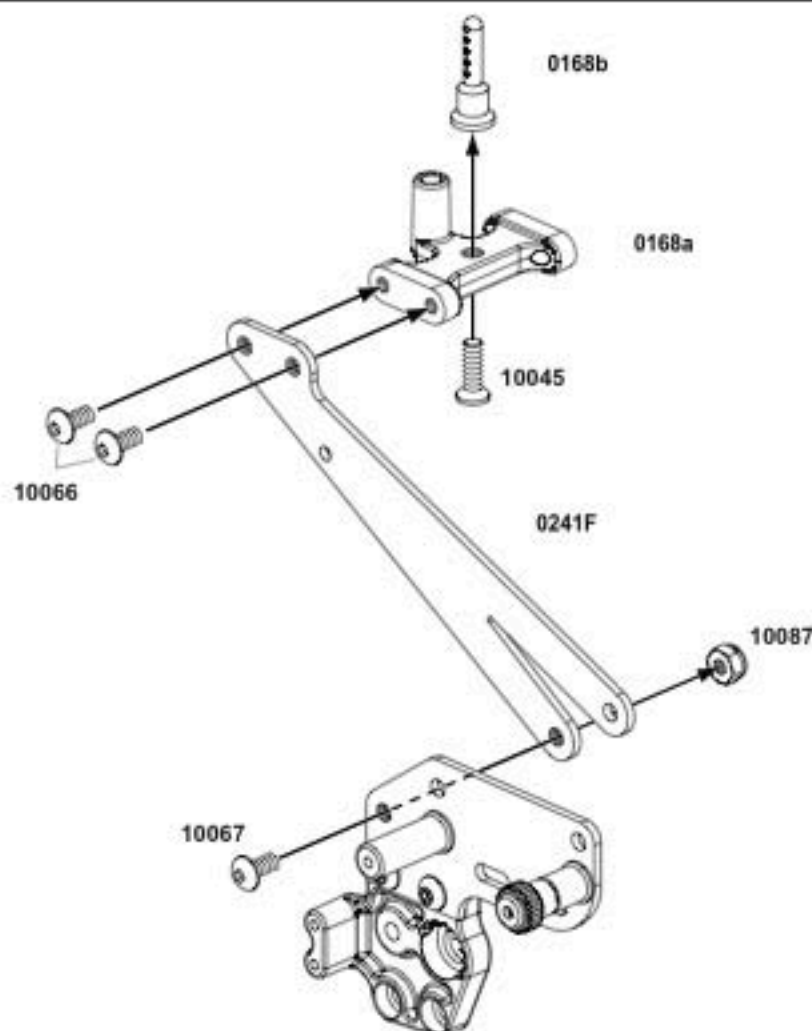

## STEP 7



x1



x1



x1



x2



x2



Venom Thread Lock

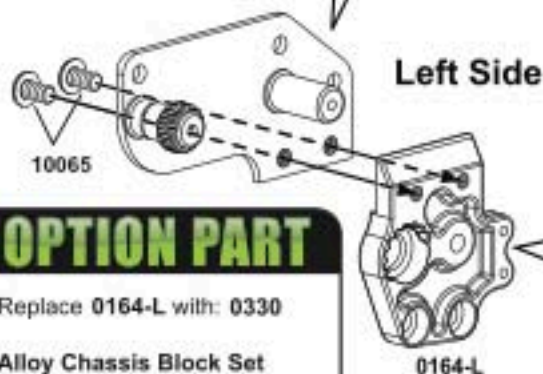
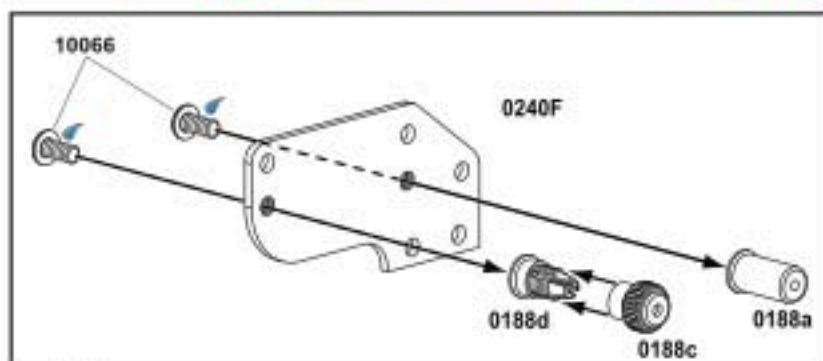

Left Side

### OPTION PART

Replace 0164-L with: 0330

Alloy Chassis Block Set

### BUILD NOTE

Note the molded letter "L" denotes a left side part.



## STEP 8



x2

0150d  
4mm Standoff



x2

10066  
M3x6mm

10067



x3

10067  
M3x8mm



x2

10069  
M3x12mm



x1

10070  
M3x14mm



x1

10087  
M3 Nylon Locknut

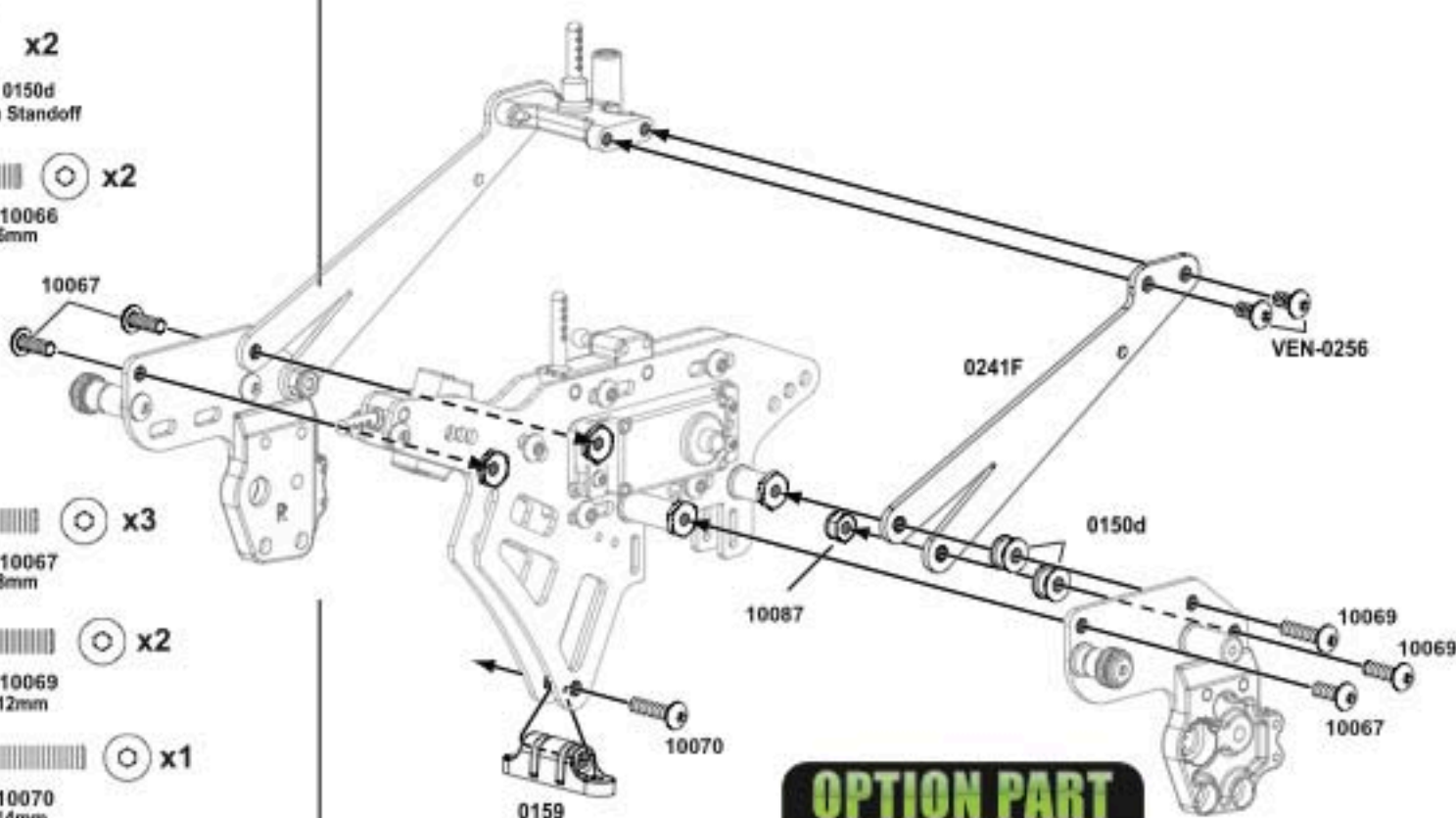

### OPTION PART

Replace 0159 with: 0331

Alloy Lower Cross Member Set



## STEP 9

  x1  
10037  
M2.5x6mm

  x1  
10045  
M3x10mm

  x1  
10087  
M3 Nylon Locknut

  x1  
10076  
M4x8mm

## OPTION PART

Replace 0174 with: 0331

Alloy Lower Cross Member Set

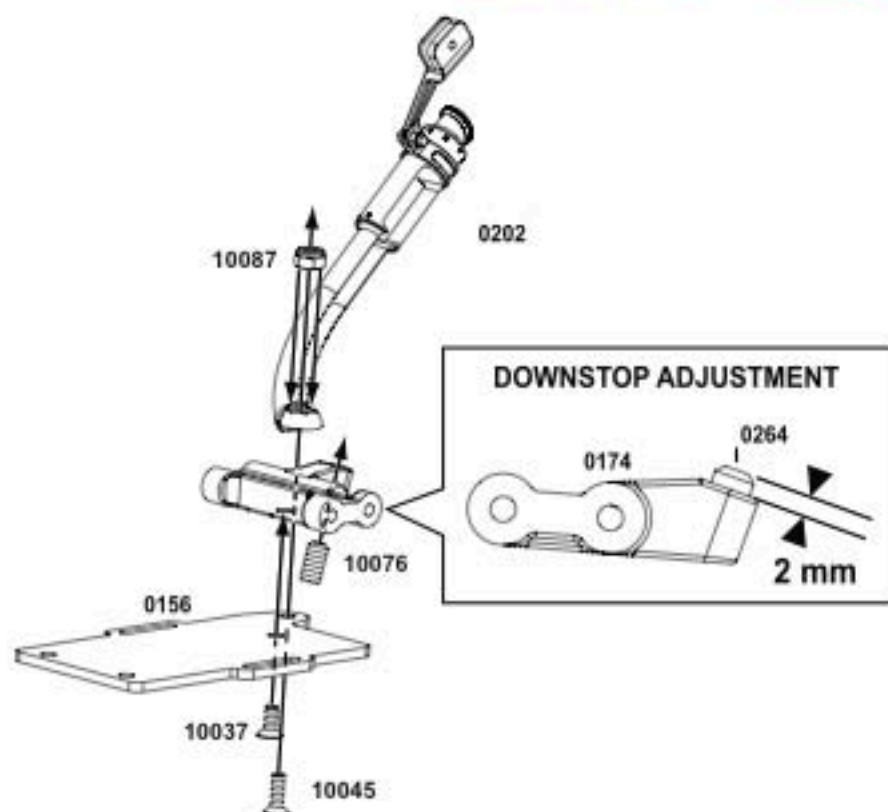

## STEP 10

  x1  
10052  
M2x6mm

  x2  
10037  
M2.5x6mm

  x1  
10066  
M3x6mm

  x3  
10067  
M3x8mm

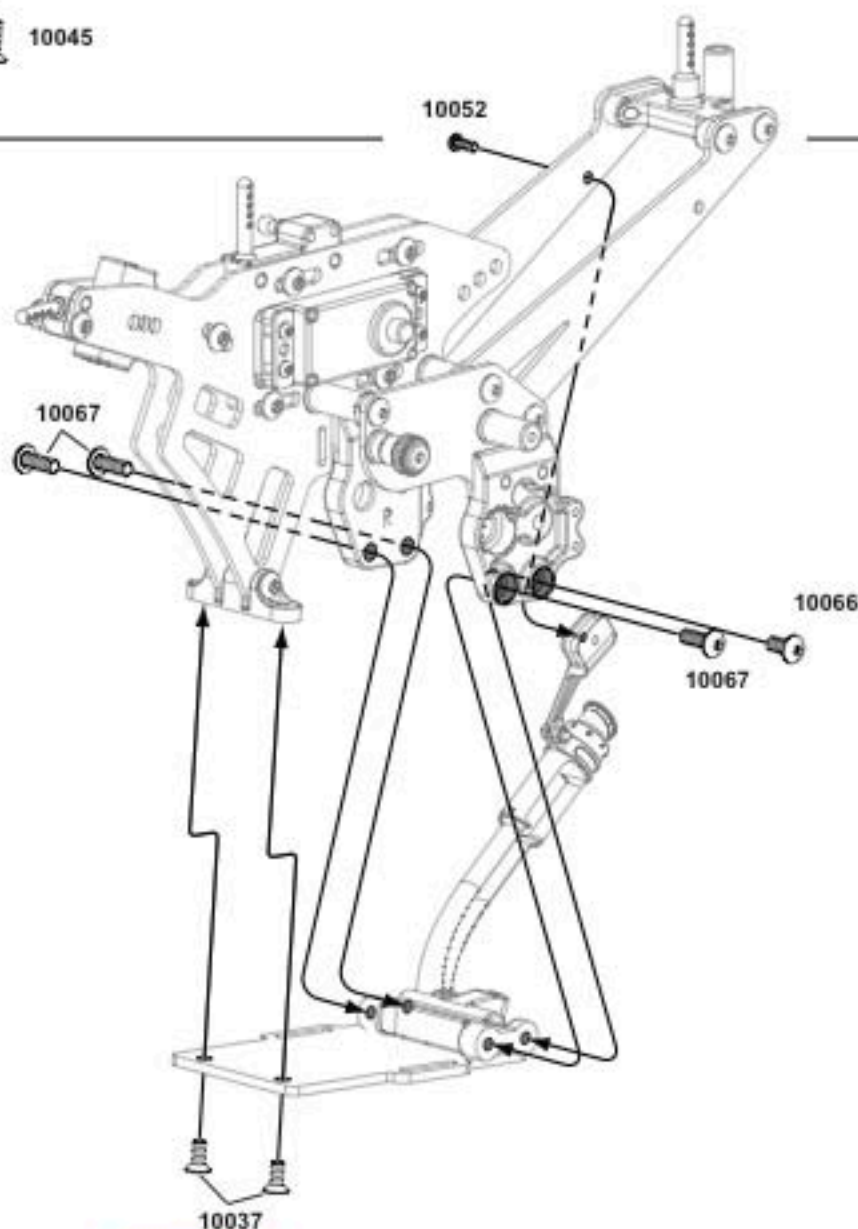

## STEP 11

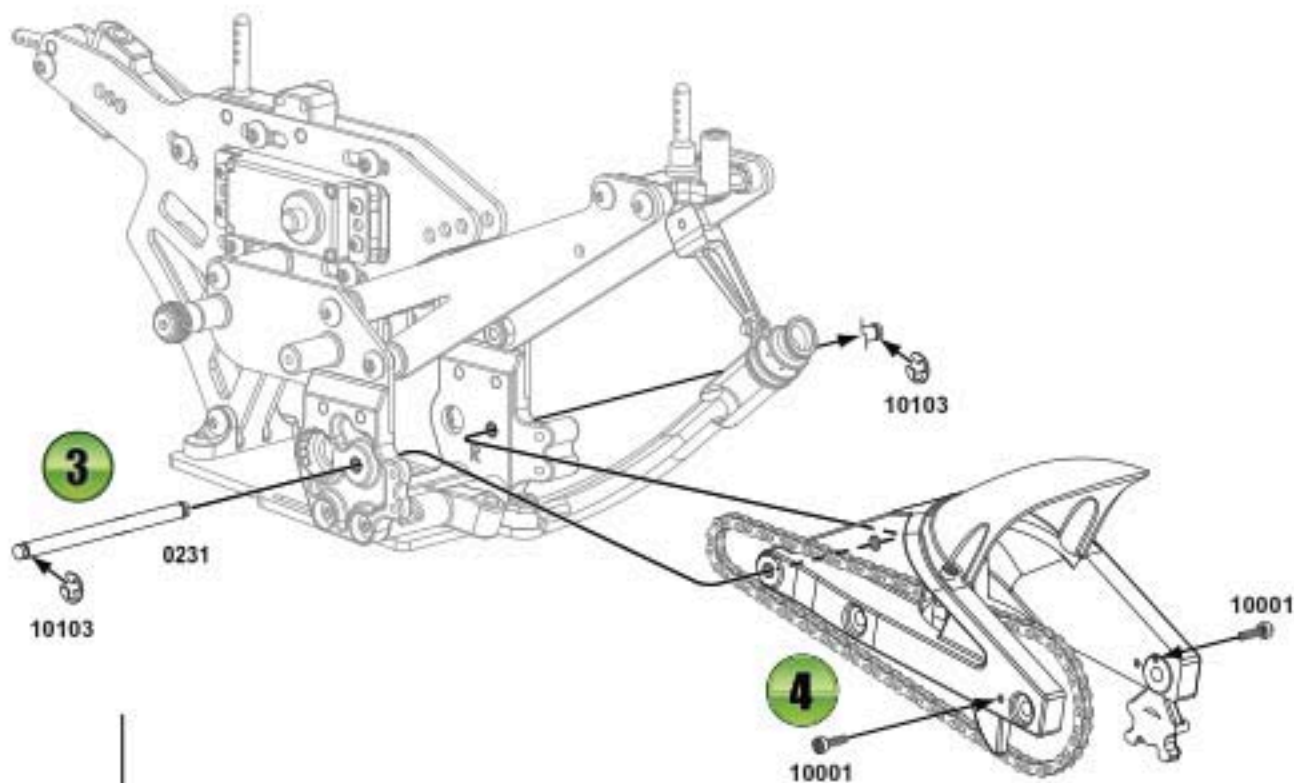
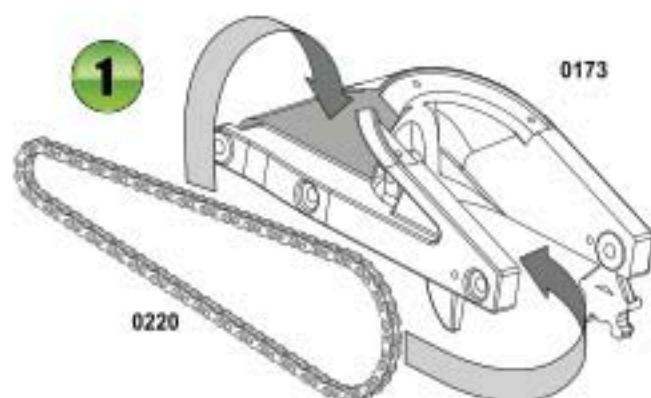



## STEP 12



x1



x1



x1



x1



11T Chain Sprocket



M3 E-Ring

x1



M2x4mm

x2



M3x3mm

x2



6x3x2.5mm

x2

### OPTION PART

Replace 0155 with: 0313

60T Spur Gear .5 Mod  
0314

62T Spur Gear .5 Mod

### BUILD NOTE

\* Tighten the set screw on the flat of the main shaft.

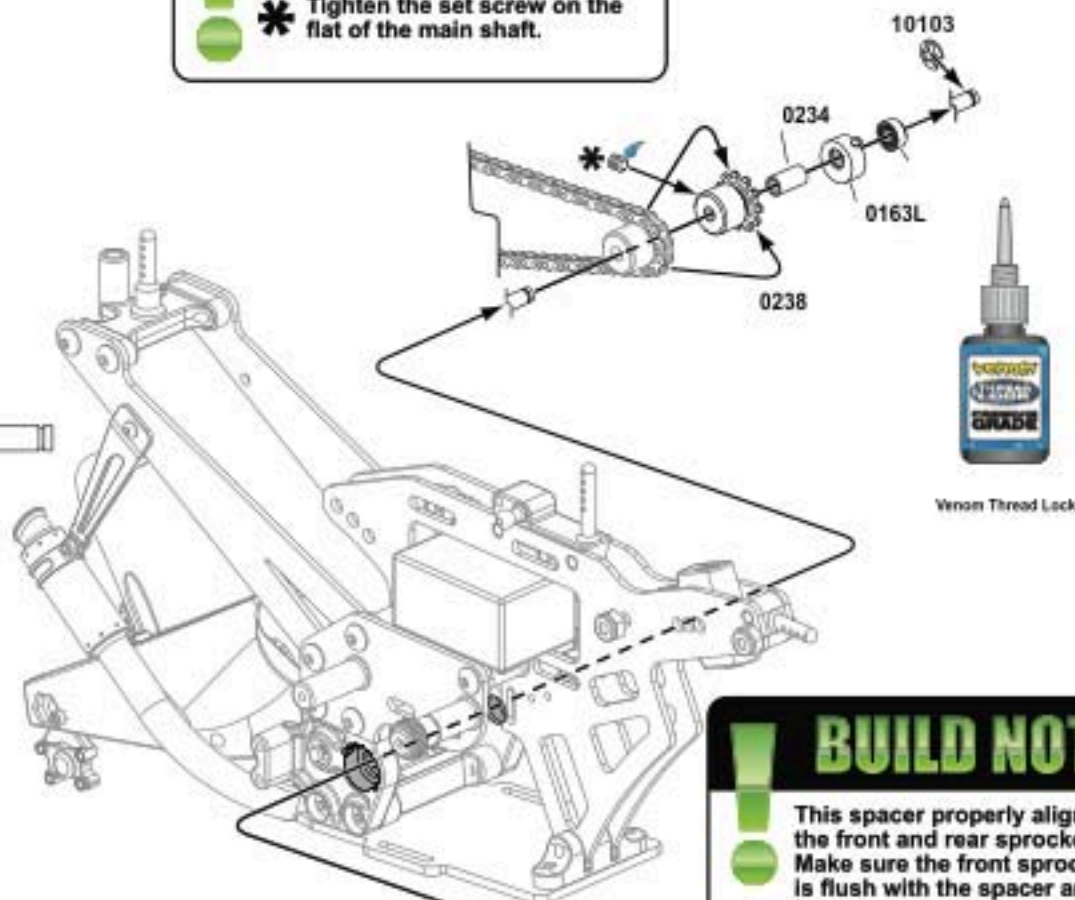

Venom Thread Lock

### BUILD NOTE

This spacer properly aligns the front and rear sprockets. Make sure the front sprocket is flush with the spacer and that the spacer is flush with the bearing, then tighten 0265.

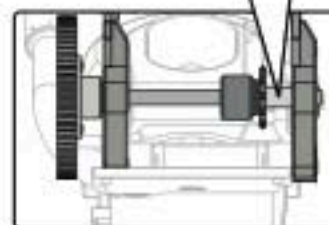

### BUILD NOTE



Chain Tension (Left Side View)

**NOTE:** Make sure the left and right tensioners are set evenly. Start with the middle setting and adjust the tension as needed.



## STEP 13



x2  
1435B  
14T Pinion



x4  
10065  
M3x5mm



x2  
10013  
M3x3mm

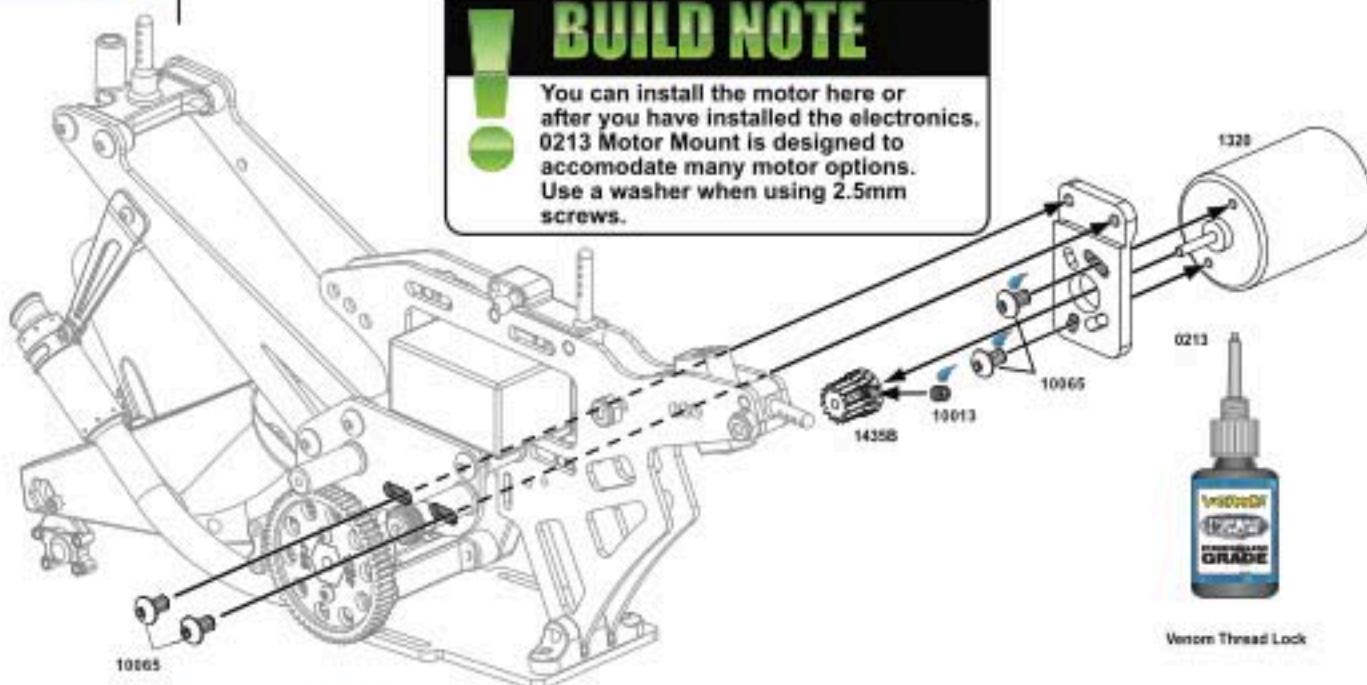

### BUILD NOTE

You can install the motor here or after you have installed the electronics. 0213 Motor Mount is designed to accommodate many motor options. Use a washer when using 2.5mm screws.

### BUILD NOTE

#### Proper Gear Mesh

When the gear mesh is set properly, there should be a small amount of free movement. If the mesh is too tight the gears will wear rapidly and the increased drag will cause a decrease in performance. If it is too loose, the gears will strip easily.

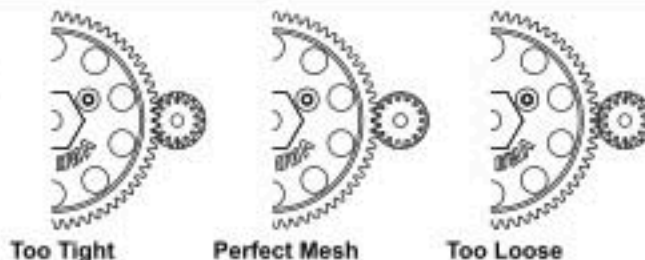

## STEP 14

### OPTION PART

Replace 0214 with: 0353  
Alloy Rear Shock-GPV-1

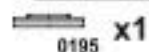

x1  
0195



x1  
0228

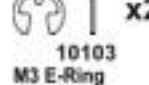

x2  
10103  
M3 E-Ring



x1  
10097  
M3 Washer



x2  
0286  
O-Ring

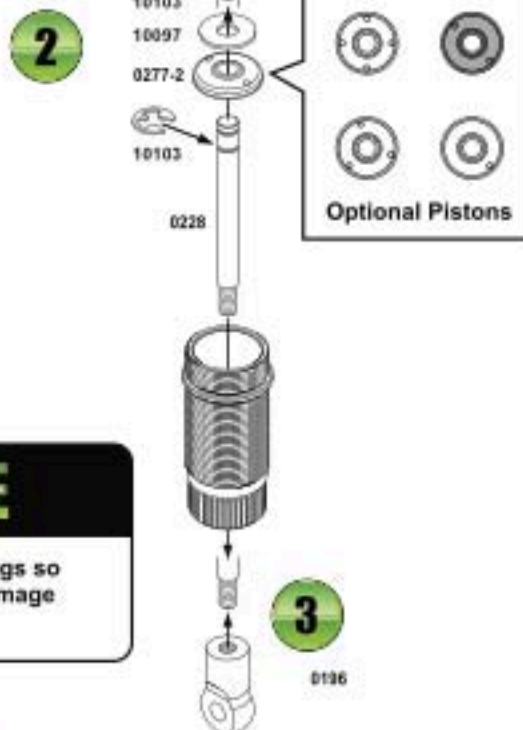

### BUILD NOTE

Add a drop of oil to the o-rings so the shock shaft does not damage them during assembly.



## STEP 15

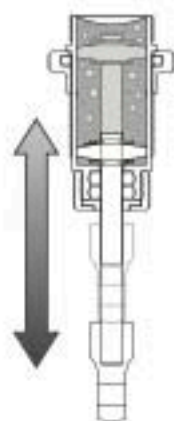
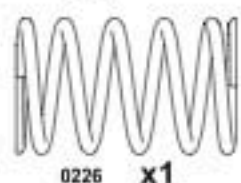
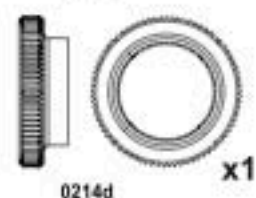
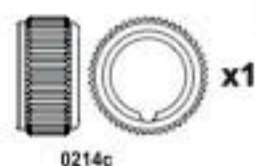

### BUILD NOTE

Caution! Move the shaft up and down **SLOWLY** to remove bubbles. Always wear eye protection to avoid accidents. Too much oil will prevent the piston from moving. Allow some oil to leak out.

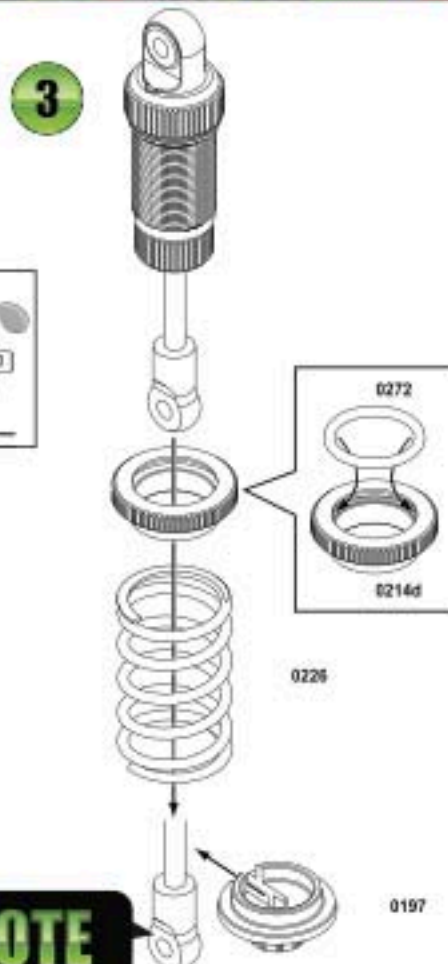
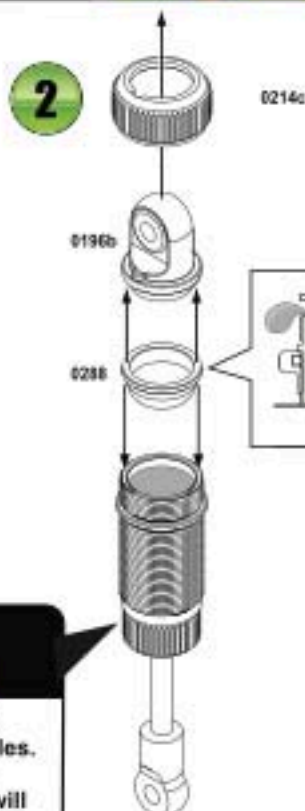

### BUILD NOTE

A properly built shock will rebound slowly when compressed without a spring.

## STEP 16

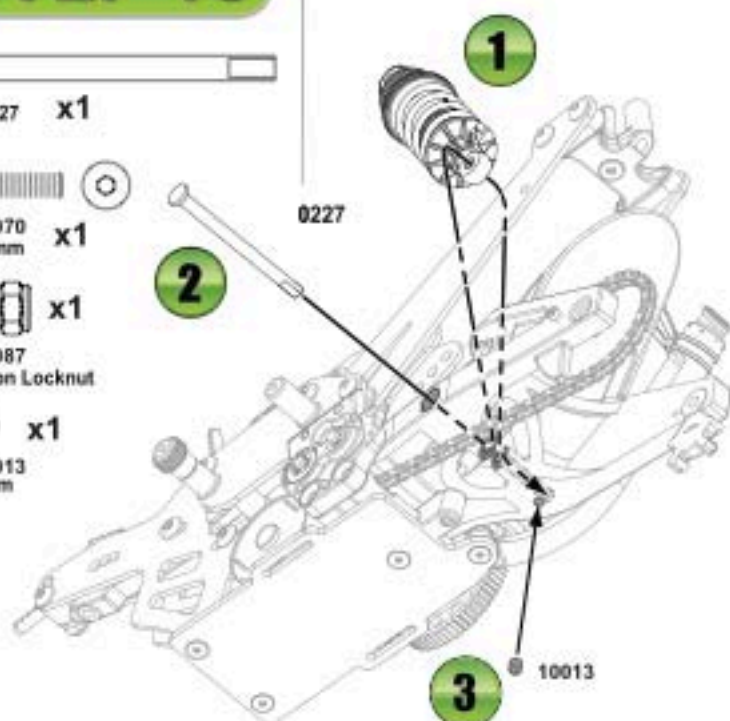
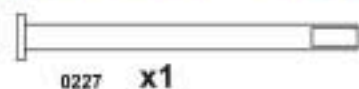

### BUILD NOTE

Do not over tighten 0263! The shock must be free enough to pivot.

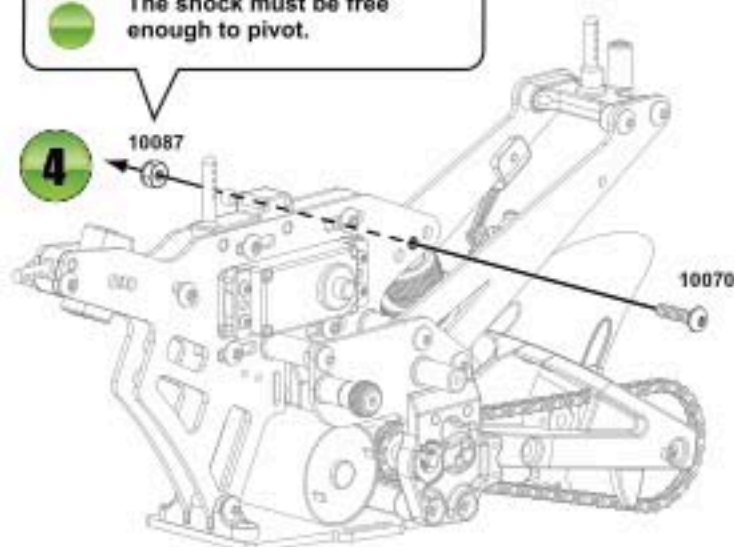

## STEP 17

### OPTION PART

Replace 0175 with: 0300

Alloy Triple Clamp Set

Replace 0268 with: 0339

Steering Bearing Set

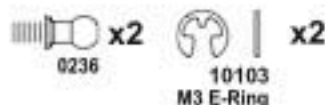

### BUILD NOTE

Tighten Both screws now.

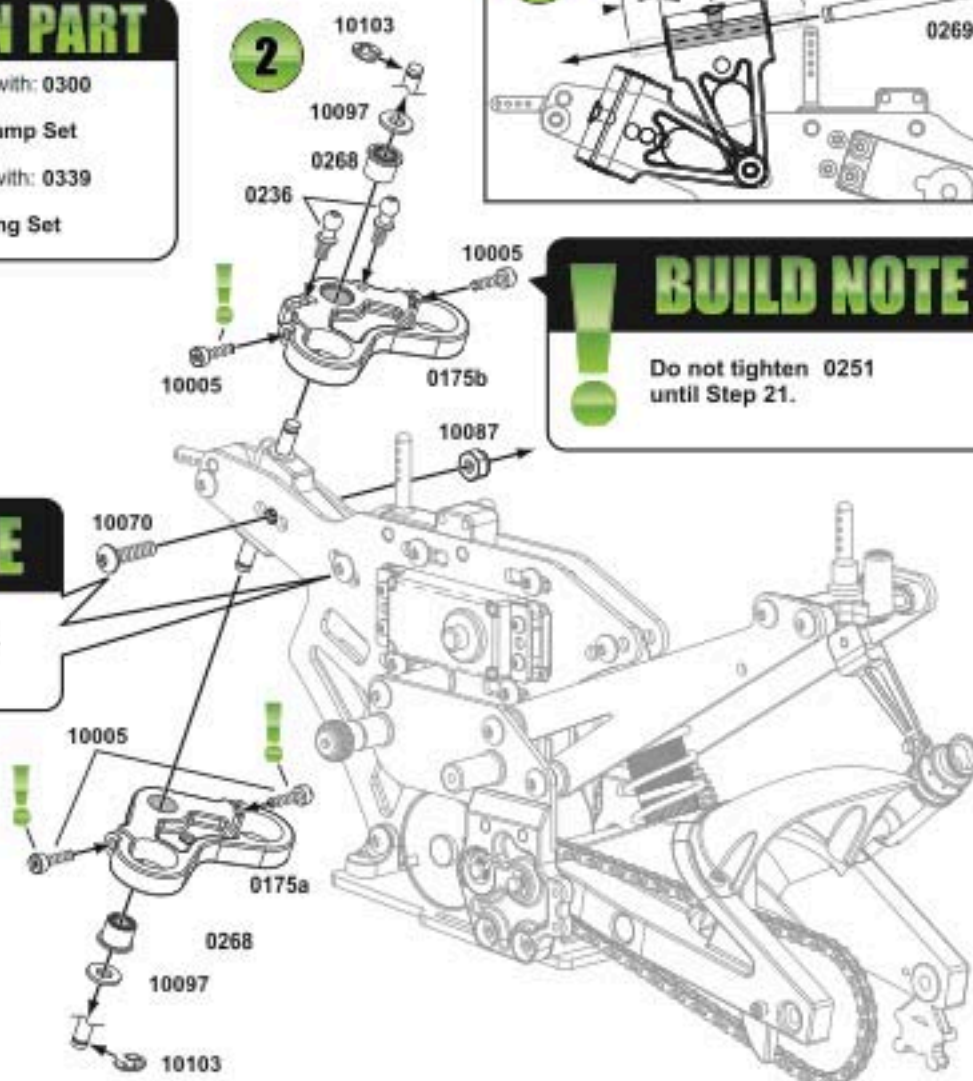
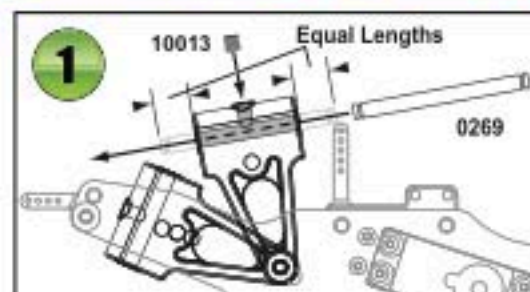

### BUILD NOTE

Do not tighten 0251 until Step 21.

## STEP 18

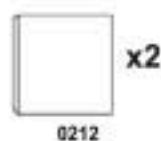
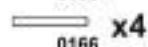

### 1 Build two fork assemblies.

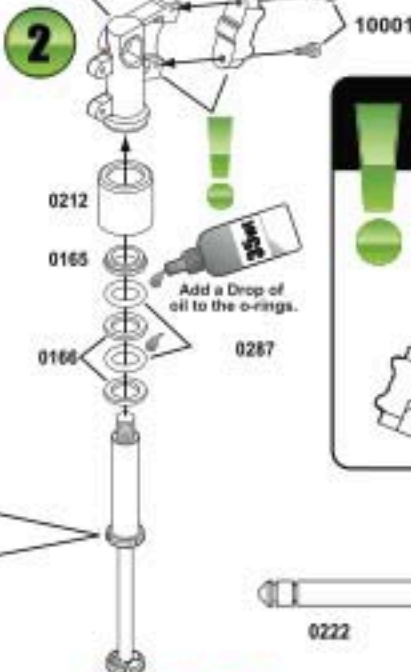
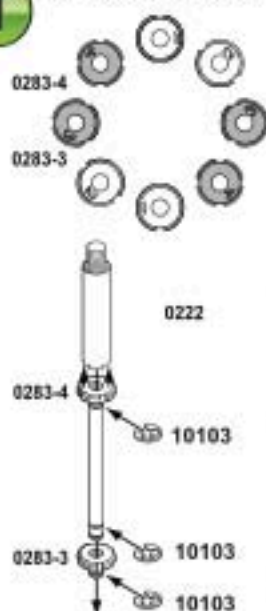

### BUILD NOTE

Note! There are different part numbers for the left and right fork lower legs. Flip the front brake calipers for the left and right so that the offset faces away from the front tire.

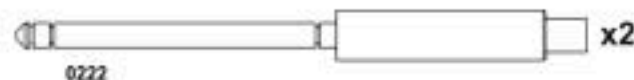



## STEP 19



0273



0274

### OPTION PART

0352  
Alloy Forks & Preload  
Adjustment - GPV1

#### OPTION TIRES:

Front Tire  
1167 V3 Medium  
1167 V1 Soft

Rear Tire  
1168 V3 Medium  
1168 V1 Soft

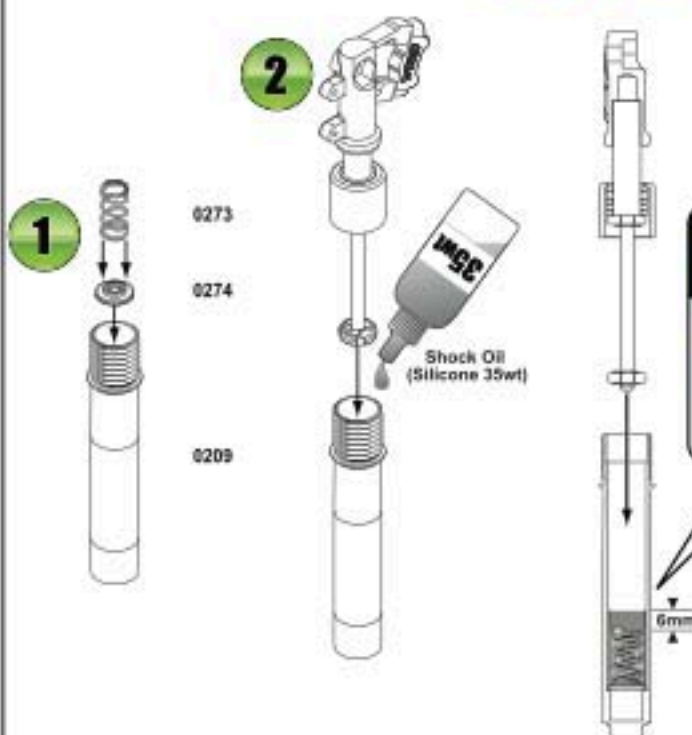

### BUILD NOTE

Fill the shock reservoir to cover the spring. You can experiment with different amounts of oil but too much oil will hydro lock the shock decreasing its dampening ability.

## STEP 20

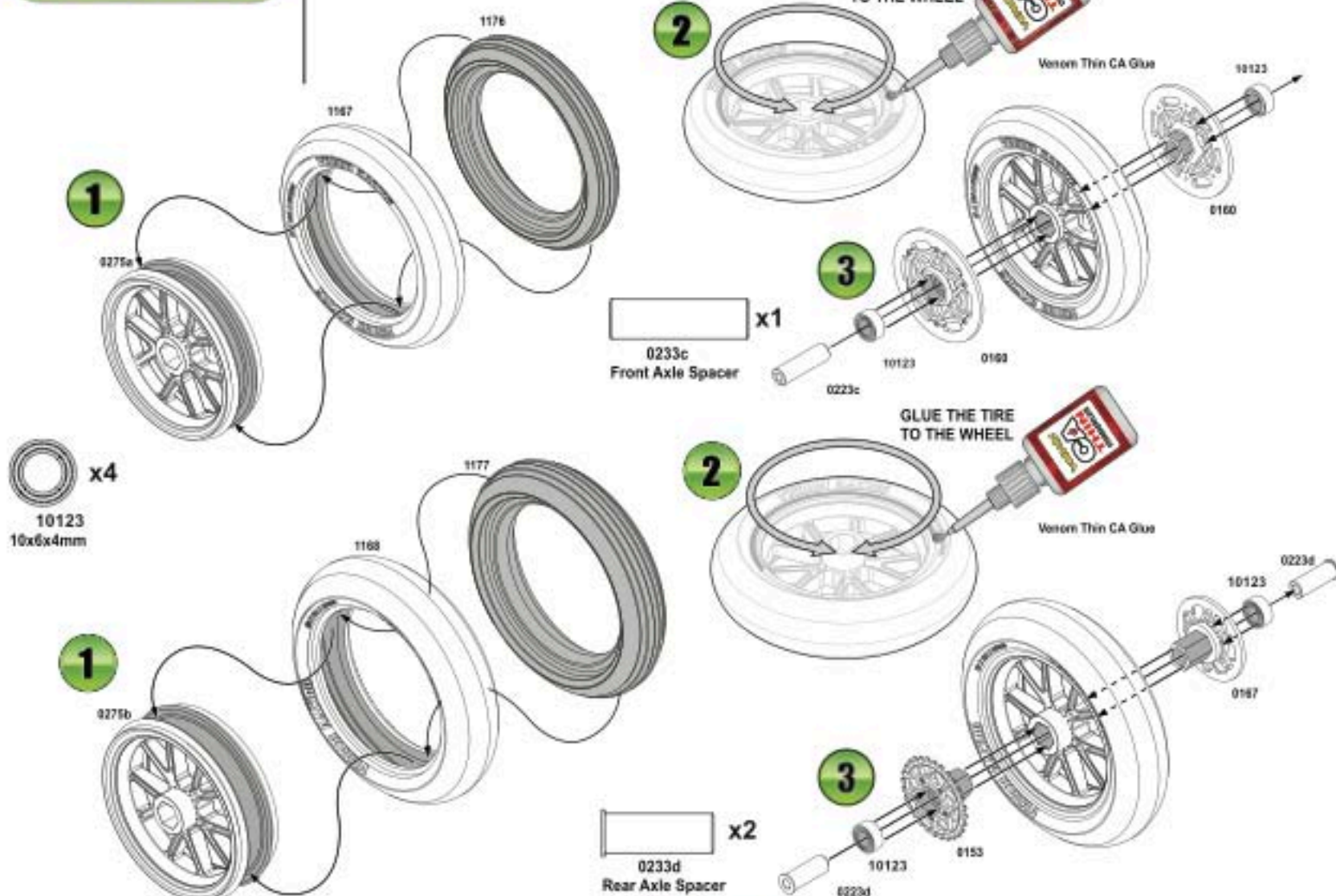

## STEP 21

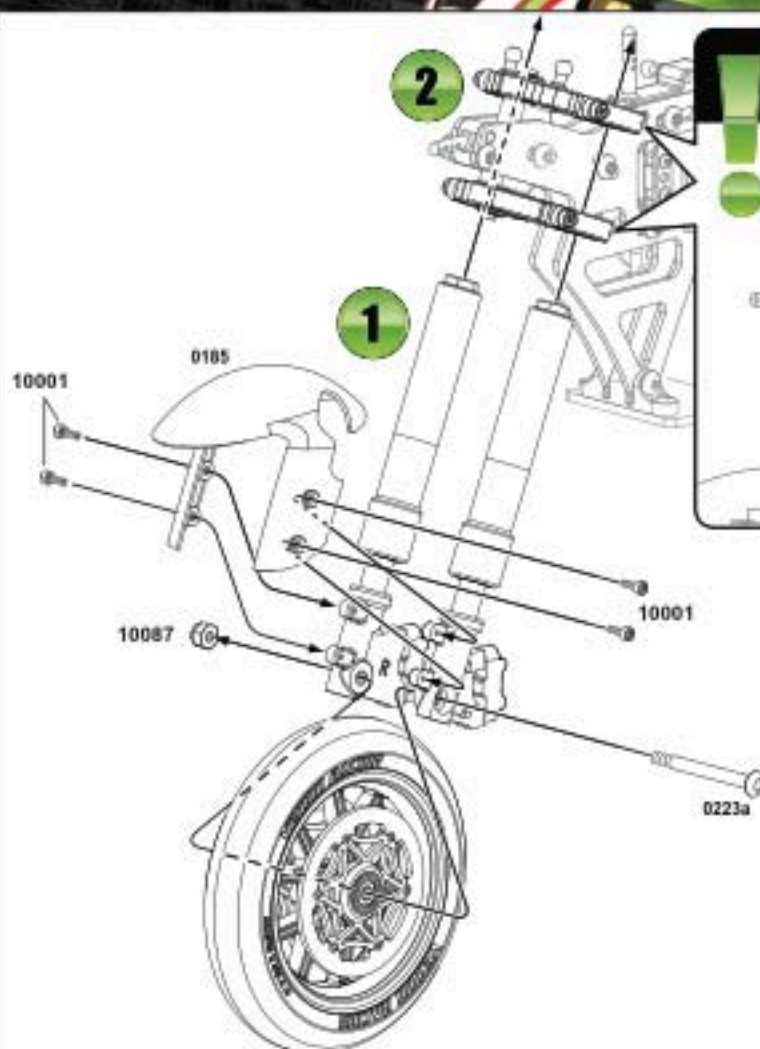

## BUILD NOTE

Make sure the fork tops are flush with the upper triple clamp before tightening 0251.

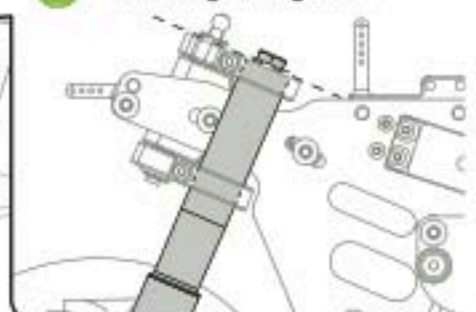

## STEP 22

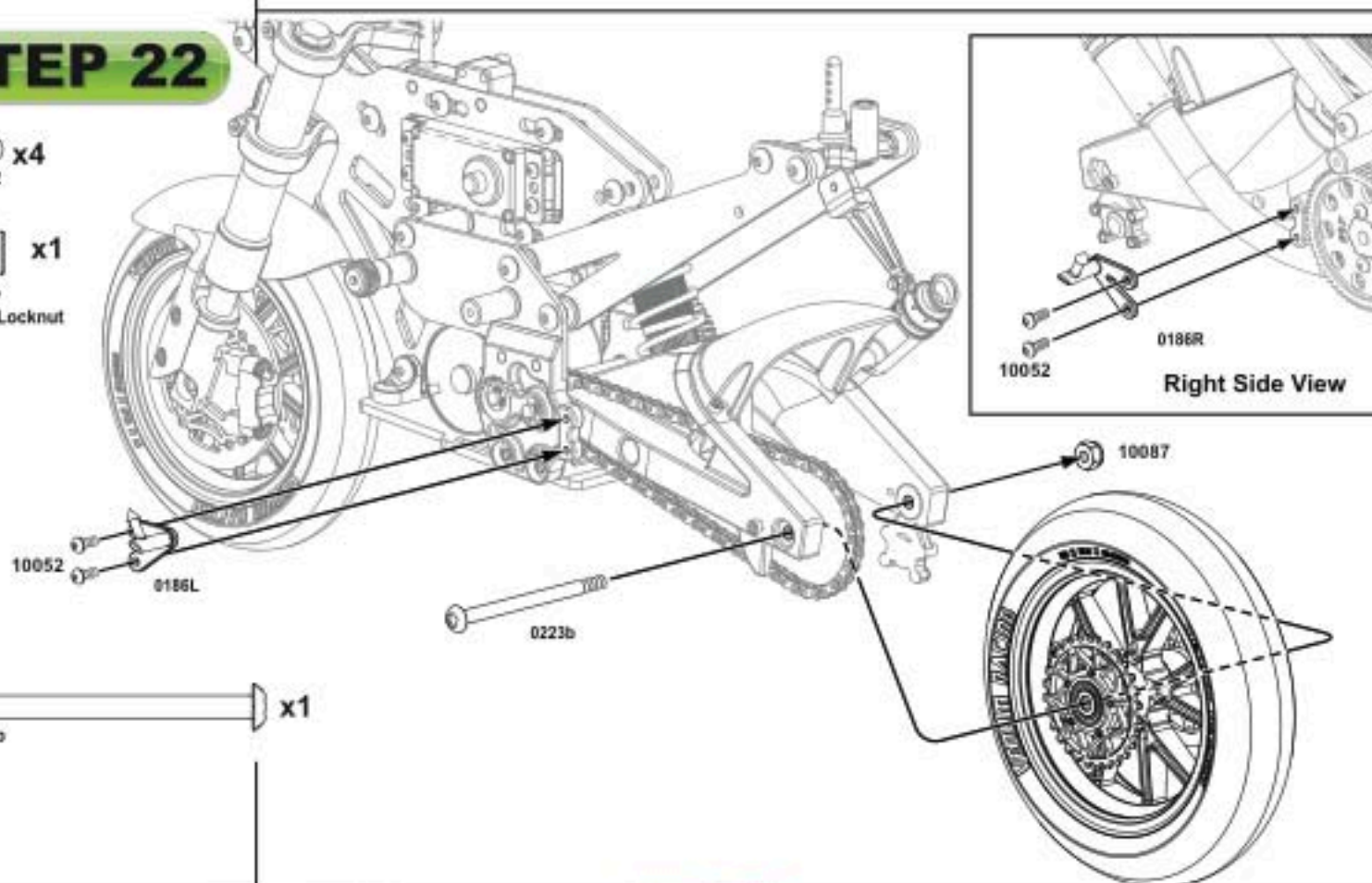
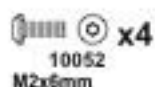



## STEP 23

x2  
0230d  
Steering Spring Collar

x2  
0230a

x2  
0266  
M2.5x3mm

x2  
0286

### BUILD NOTE

The length between the ball cups will vary depending on the servo. You can increase the effects of the steering damper by compressing the springs. Attach the ball cups and center the servo before tightening the set screws on the steering spring collars (0205).

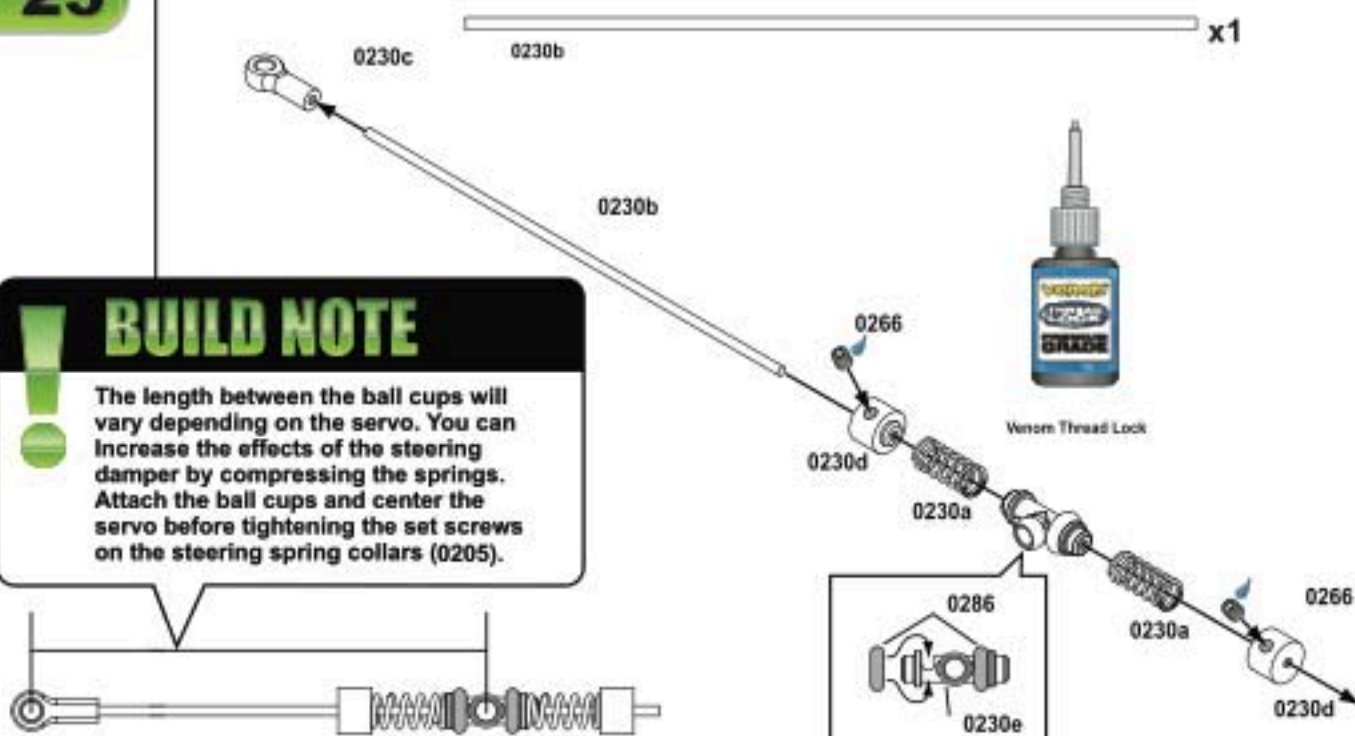

## STEP 24

x1  
0236b

x1  
10087  
M3 Nylon Locknut

### BUILD NOTE

**PRO TIP:** Bending the Guide Wires (0224) down will reduce the lean angle of the bike. It will also help you stand the bike back up after a minor tumble. While the bike is resting on the guide wire apply a small amount throttle to get the GPV-1 up and running.

### BUILD NOTE

Note! Please use the servo horn and screw that came with your servo or use 8270b.

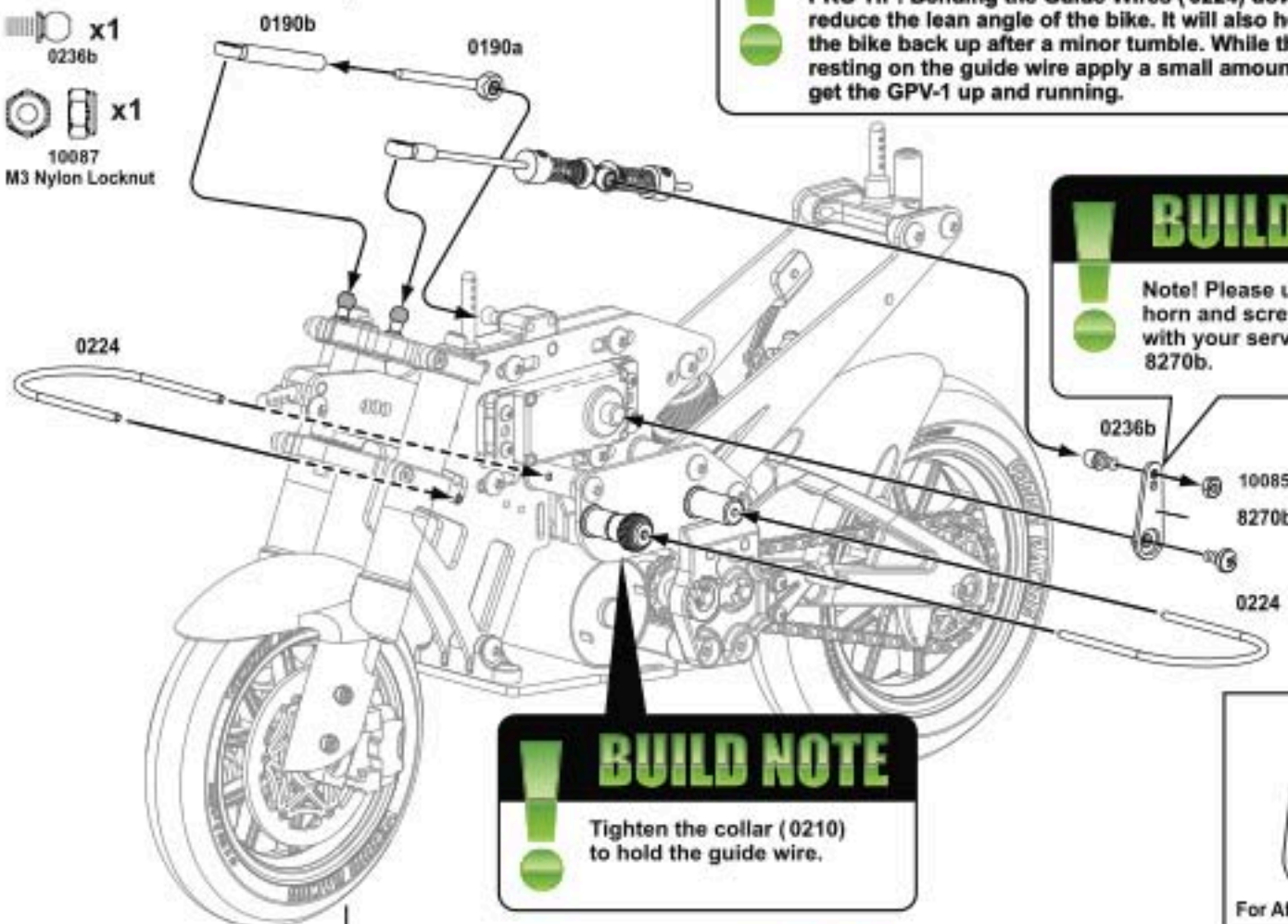

### BUILD NOTE

Tighten the collar (0210) to hold the guide wire.

15-17mm

For Aftermarket Servos



## STEP 25

### Electronics

Recommended Installation Locations

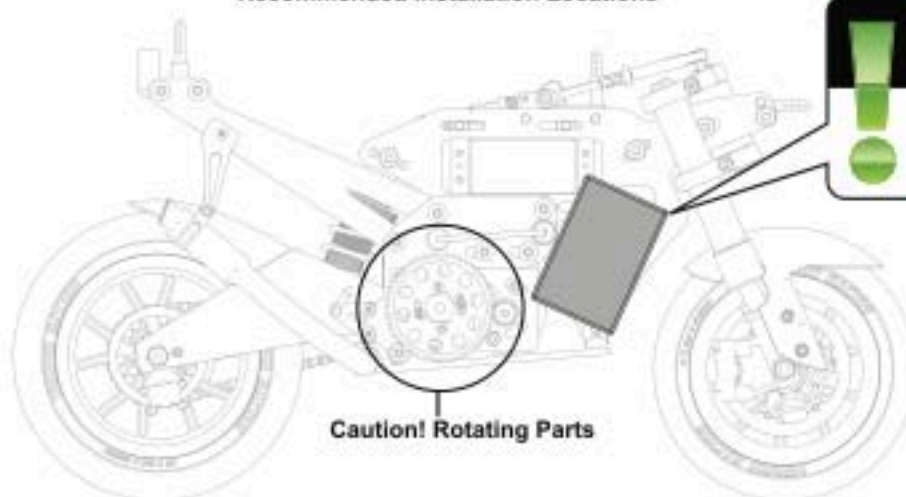

#### BUILD NOTE

Possible Receiver Location.  
Note: Route the wires through holes in the chassis.

#### BUILD NOTE

Possible ESC Location.

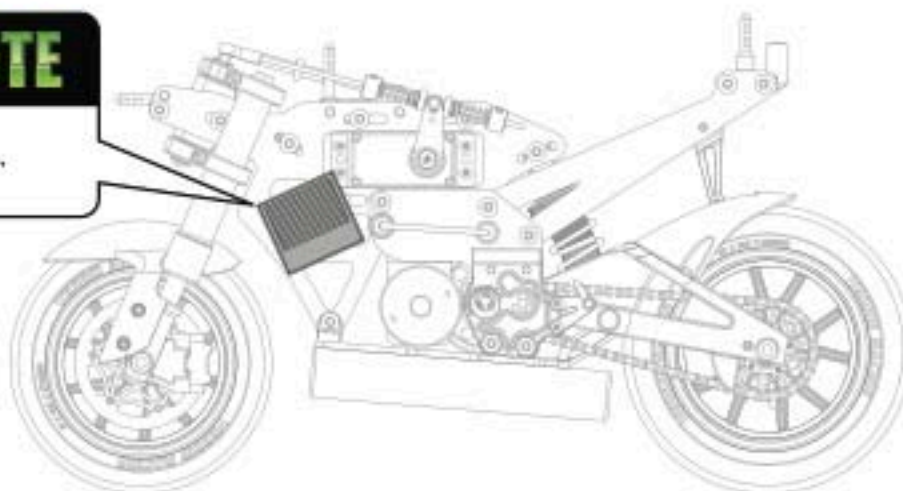

#### BUILD NOTE

Possible Receiver Location.  
Note: Route the wires through holes in the chassis.

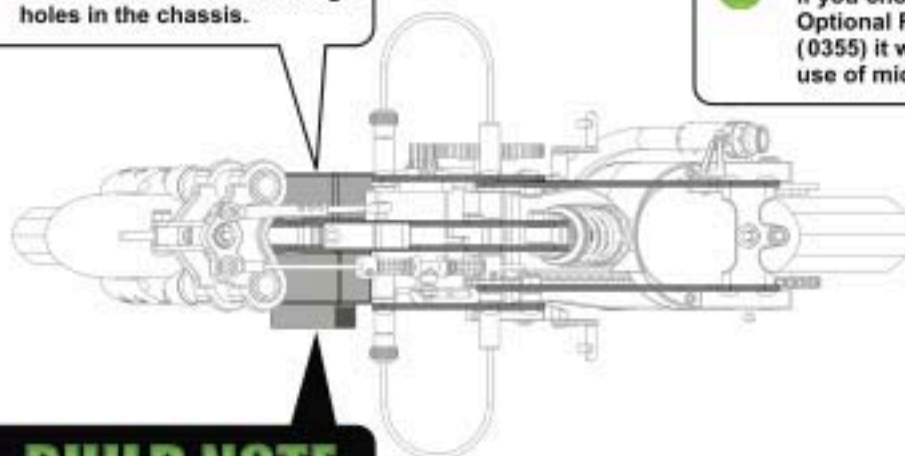

#### BUILD NOTE

The GPV-1 can accept most standard size electronics but if you choose to install the Optional Front Brake Kit (0355) it will require the use of micro electronics.

#### BUILD NOTE

Possible ESC Location.



## STEP 26

0270  
Battery Strap

### NiMH Battery Installation Instructions

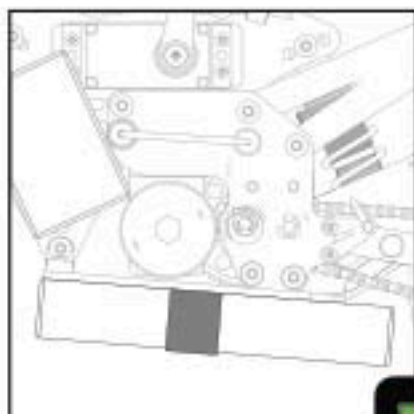
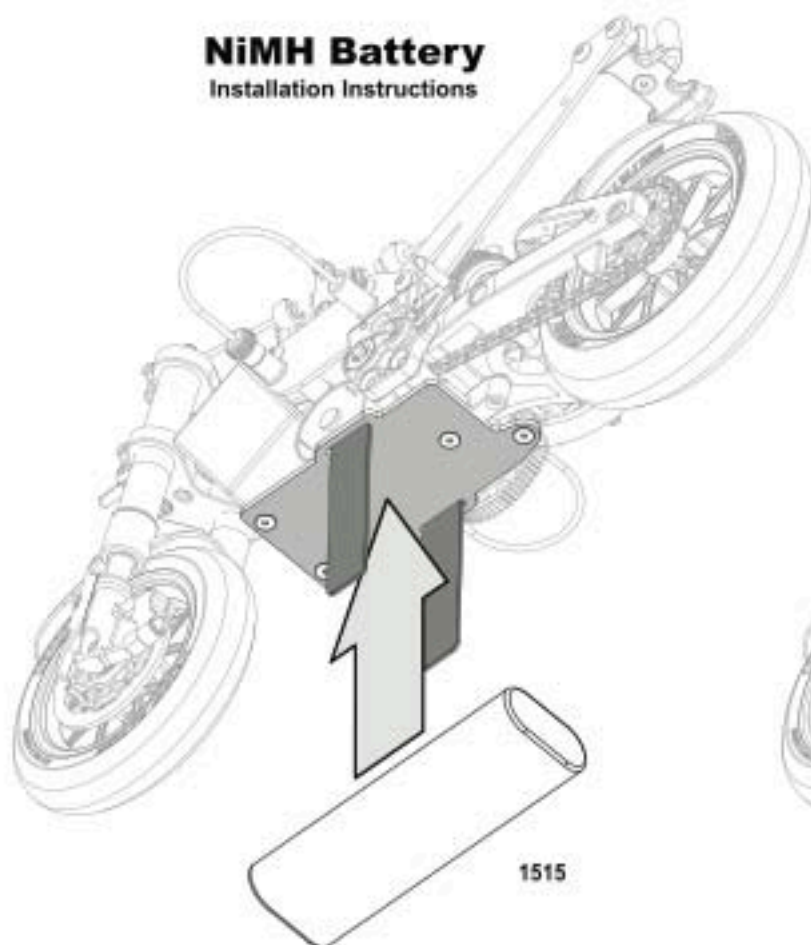

### LiPO Battery Installation Instructions

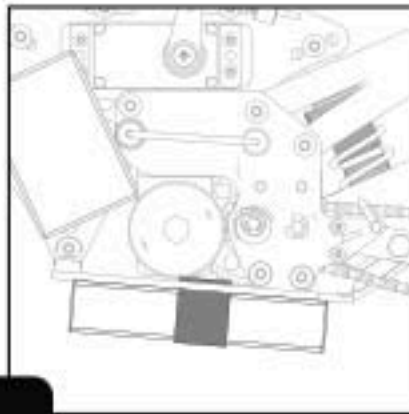
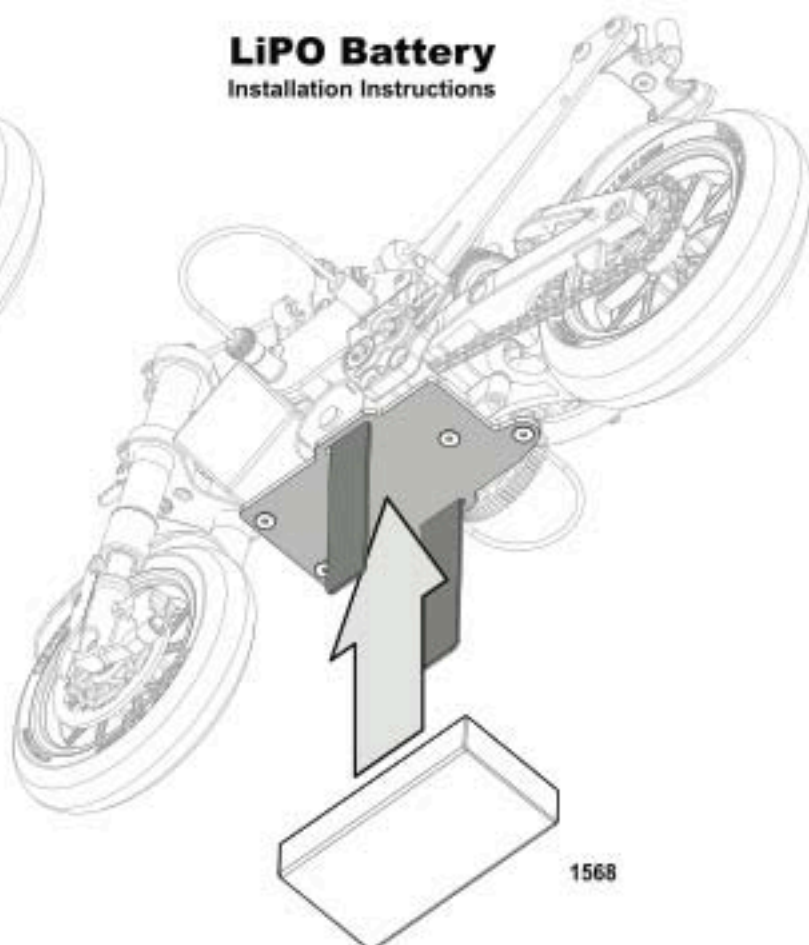

**TUNING TIP**  
Slide the battery forward or back to change the balance and handling of the GPV-1.



## STEP 27



x1

0182



x3

0286



x7

0326

Body Clip

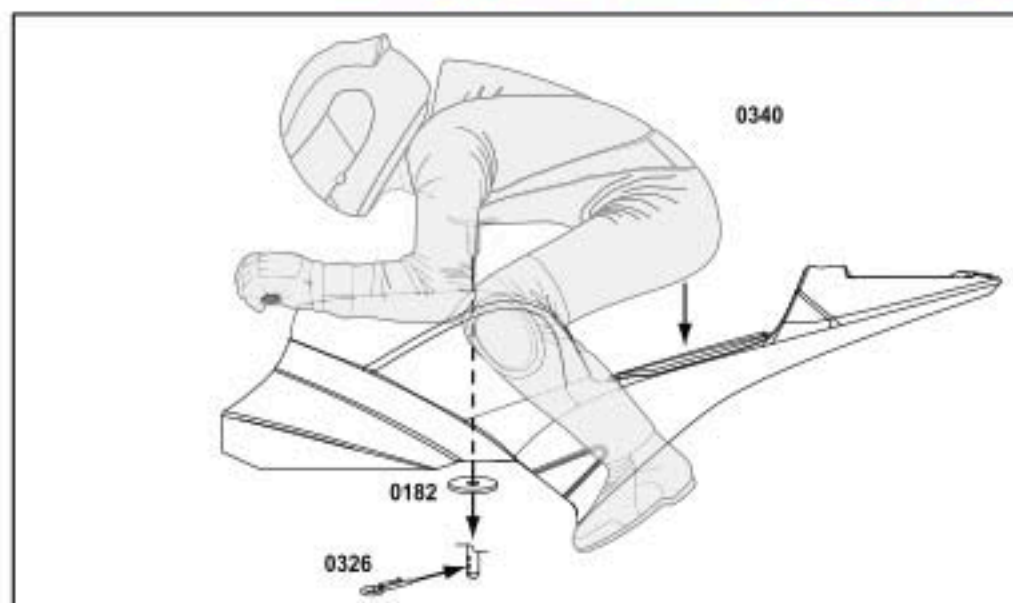

### BUILD NOTE

Remove both sides to attach the body.

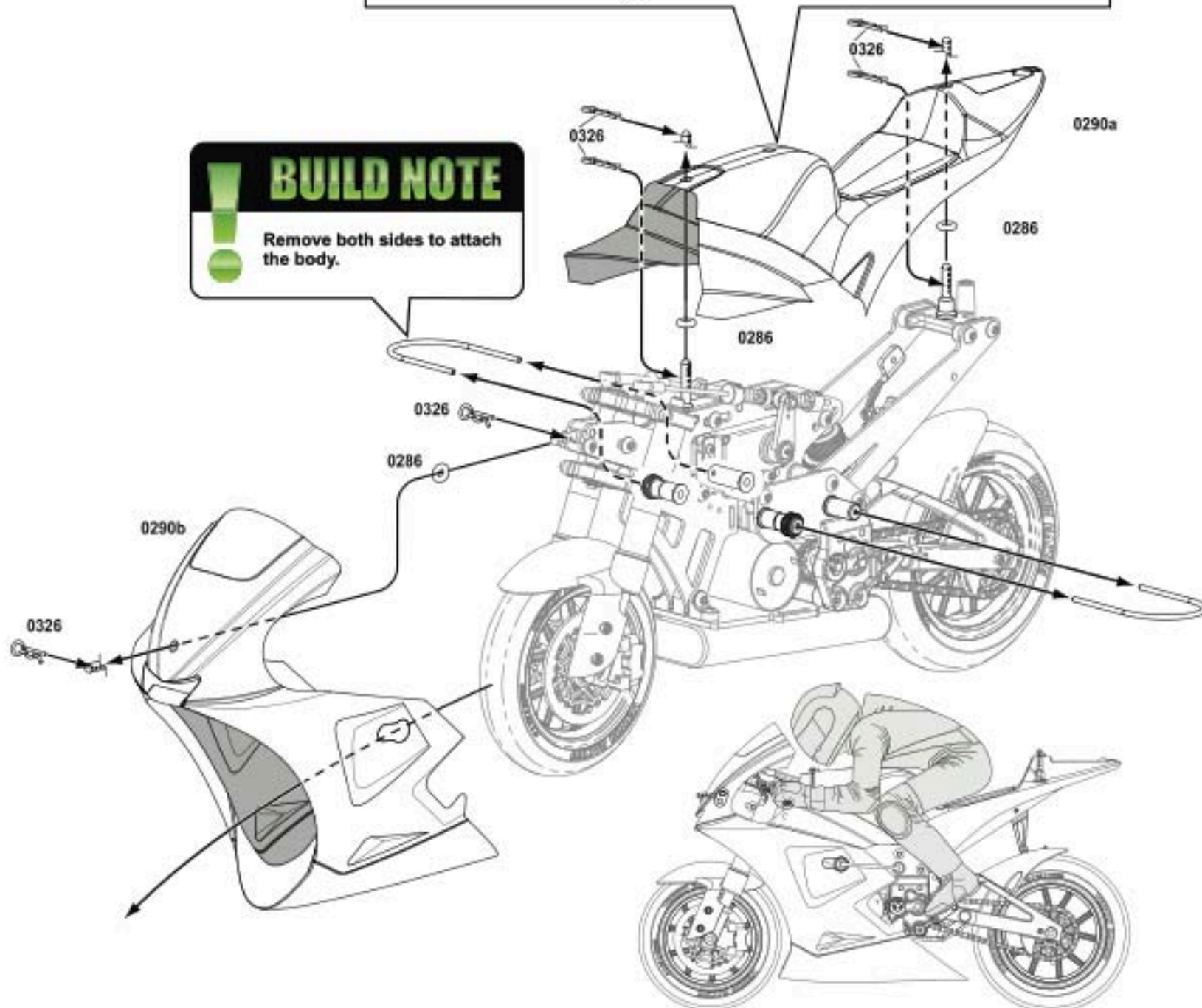



## STEP 28

 **x4**  
10067  
M3x8mm

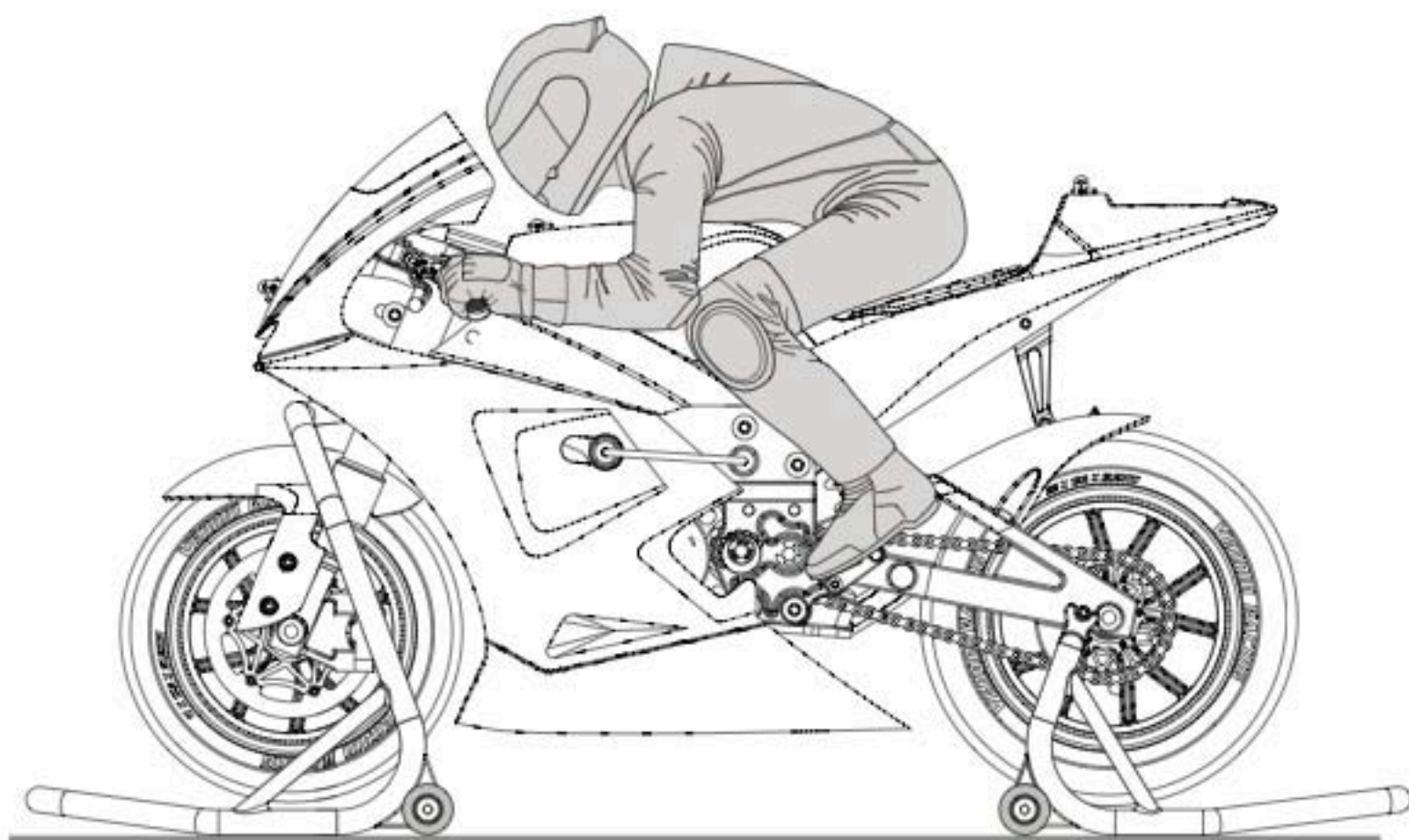
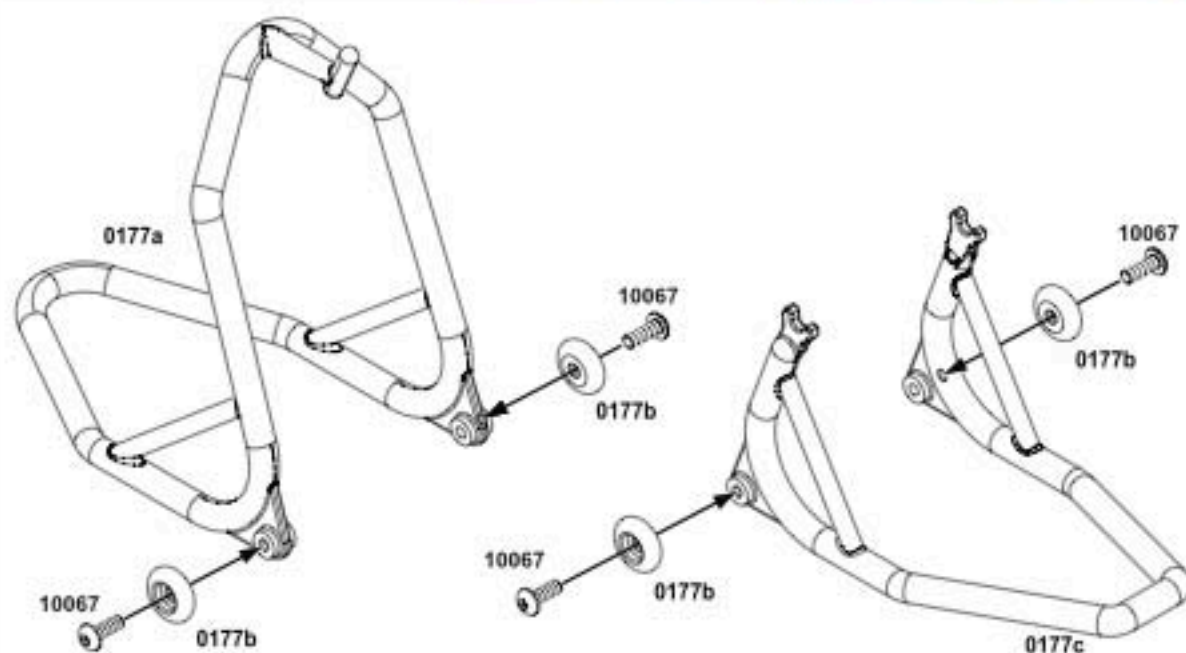

# GPV-1 Setup & Tuning Guide

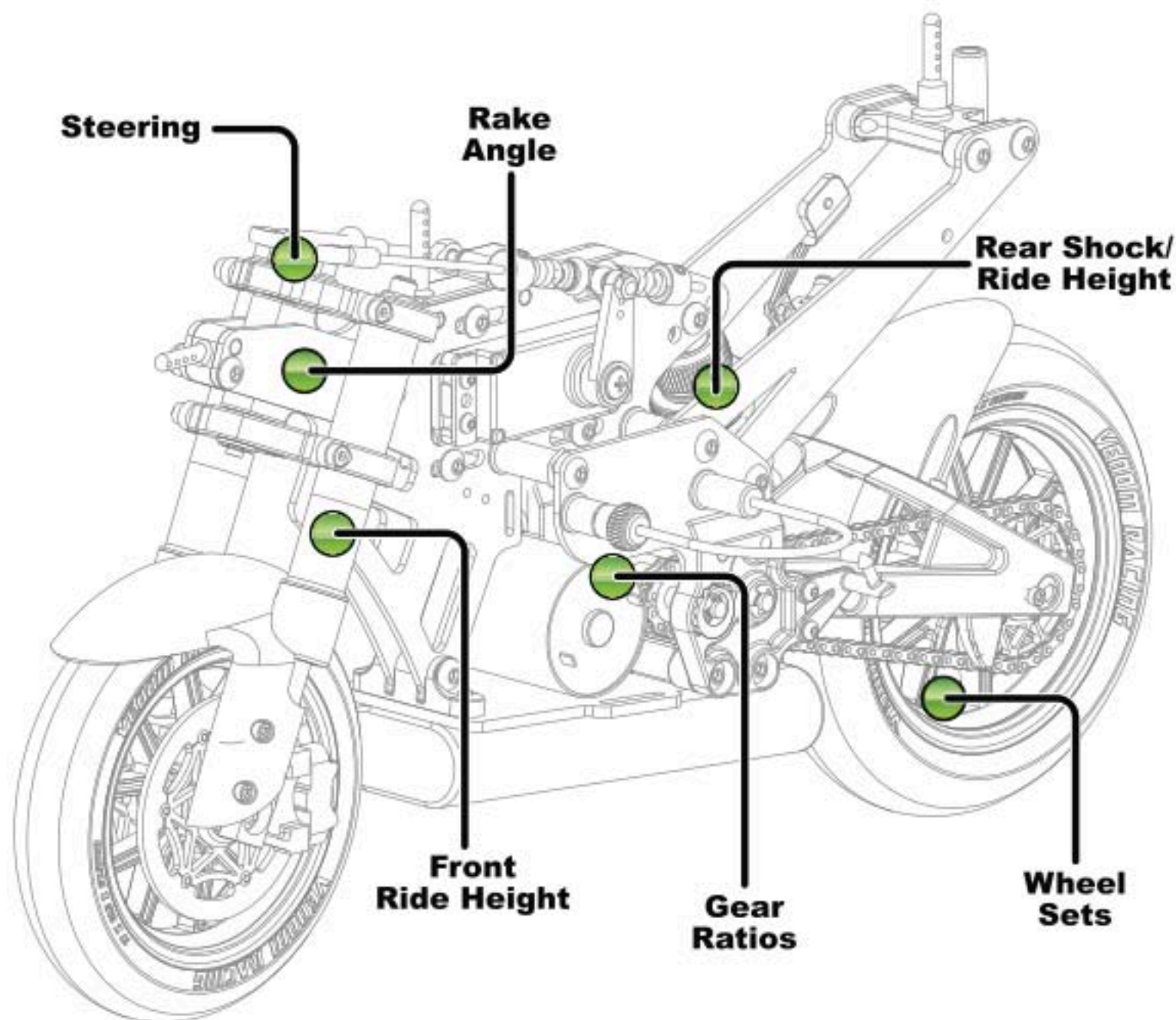

The Venom GPV-1 is the most advanced and most adjustable 1/8th Scale R/C Motorcycle on the market. As with any purpose built race machine, proper setup and tuning is one of the most important steps in extracting every possible ounce of performance. A proper setup can be the difference between a podium finish and an "also ran" finish. While the GPV-1 seems like a simple machine, there are a lot of little elements that can effect the overall performance. The following pages do not provide absolute settings but rather provide you with the tools necessary to fully understand what is happening with each adjustment. Using these setup guides in different combinations and amounts will help you tune and get the most out of your Venom GPV-1.

Team Venom



## RAKE ANGLE

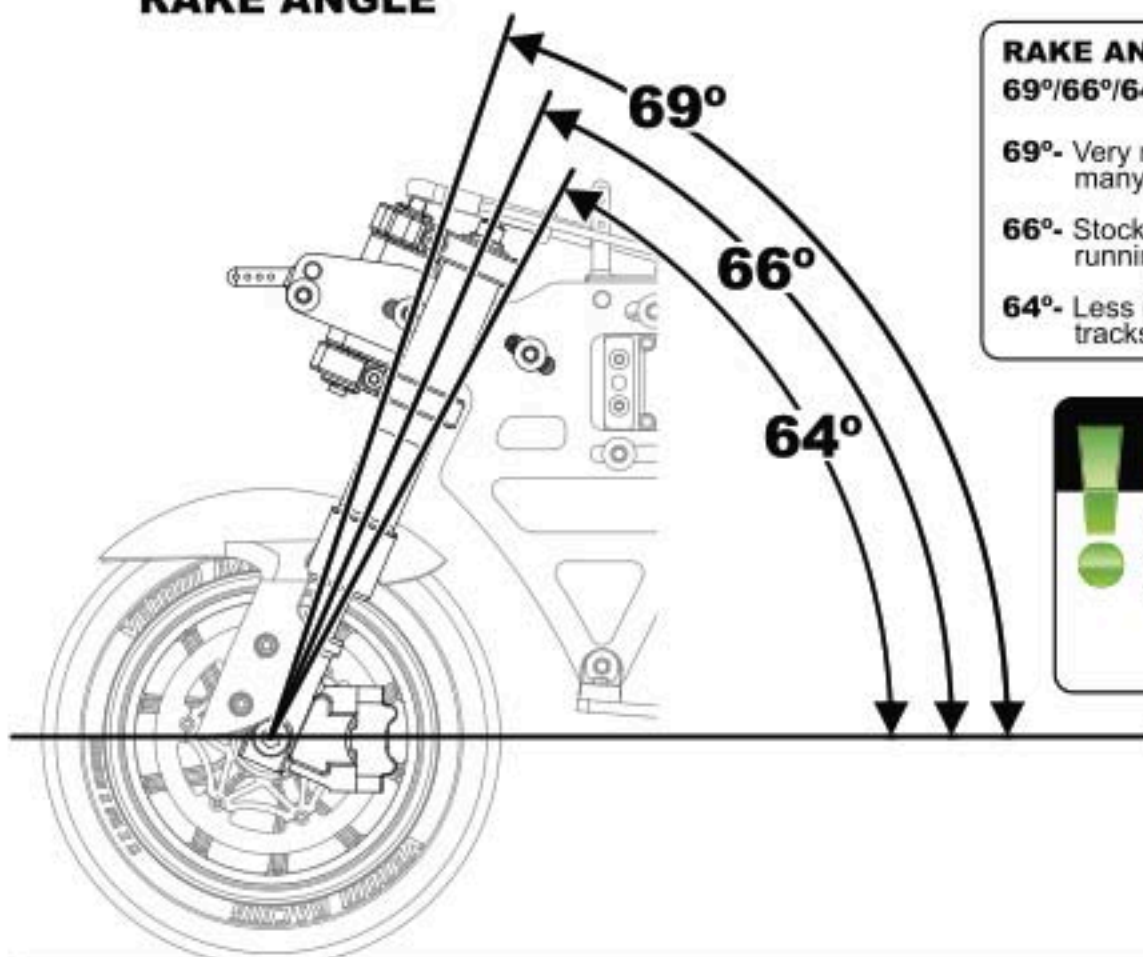

### RAKE ANGLE

69°/66°/64°

**69°**- Very responsive. Best for short tracks with many turns and low to medium speeds.

**66°**- Stock position. Most versatile for general running, medium speeds.

**64°**- Less responsive. More stable, best for big tracks and high speeds.

### BUILD NOTE

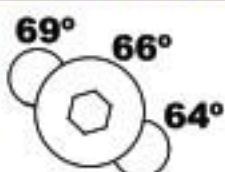

To adjust the rake angle, move both screw positions equally.

## WHEEL BASE

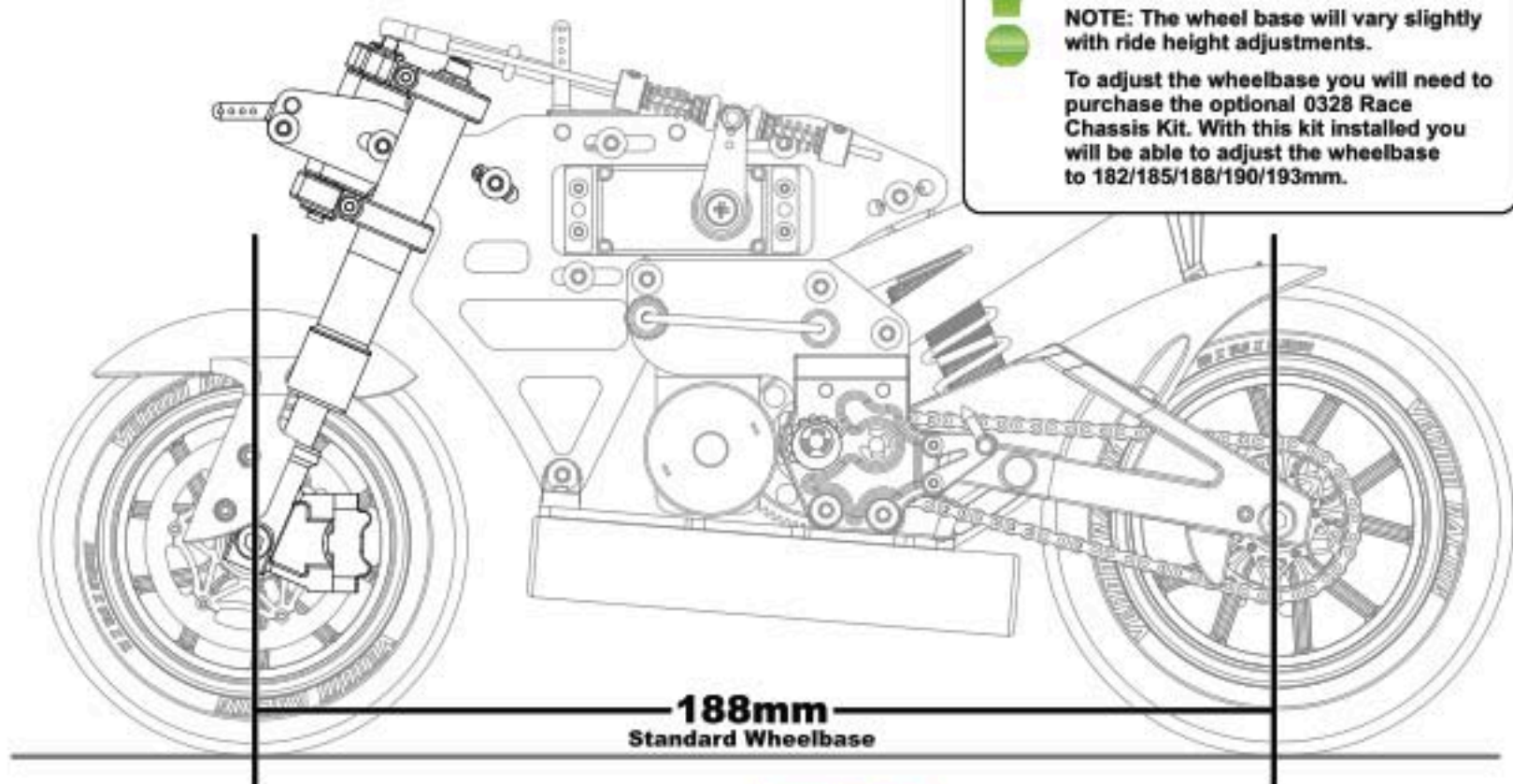

### BUILD NOTE

**NOTE:** The wheel base will vary slightly with ride height adjustments.

To adjust the wheelbase you will need to purchase the optional 0328 Race Chassis Kit. With this kit installed you will be able to adjust the wheelbase to 182/185/188/190/193mm.



## REAR SHOCK POSITION

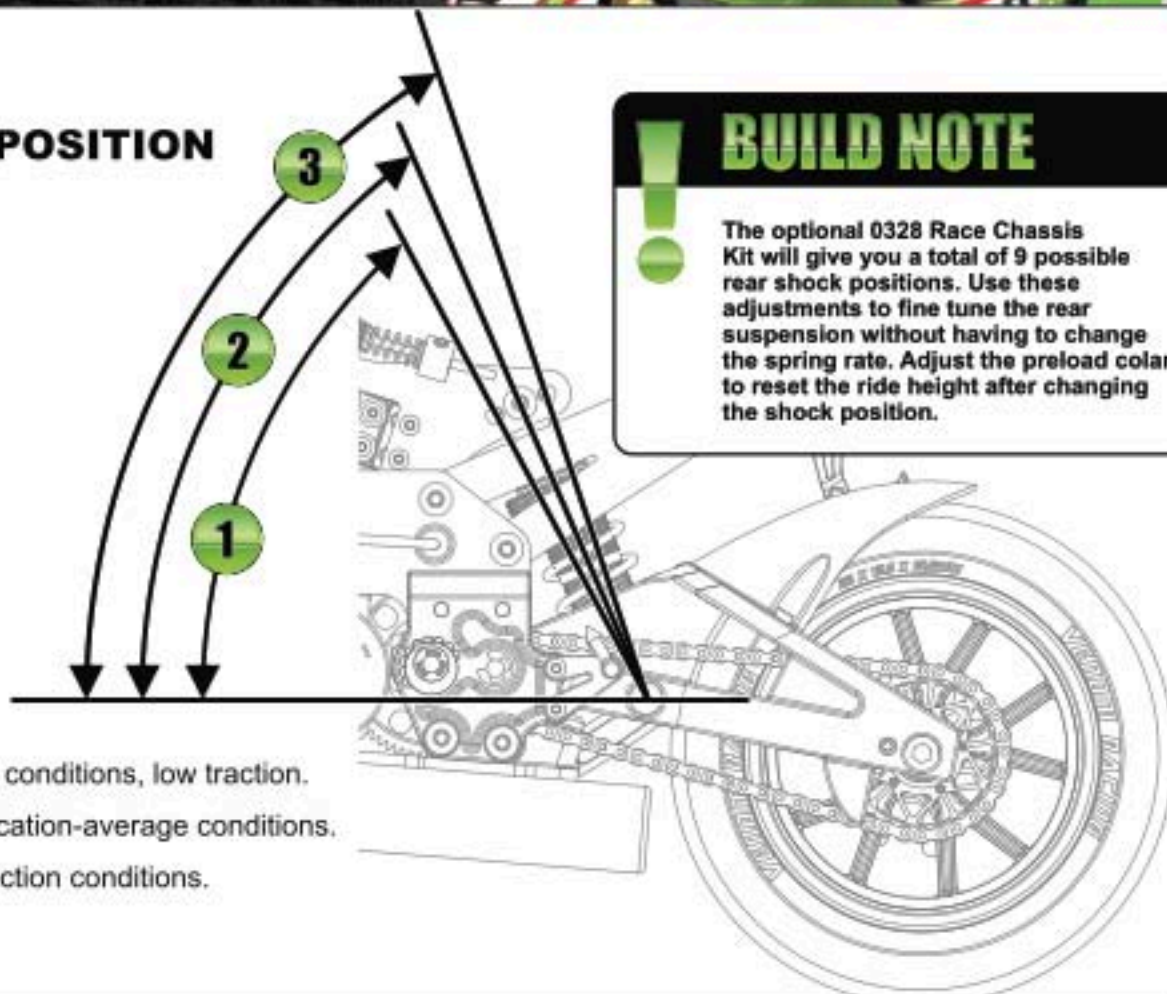

- 1 SOFT** - Slippery conditions, low traction.
- 2 MED** - Center location-average conditions.
- 3 HARD** - High traction conditions.

## STEERING PIVOT BALL POSITION

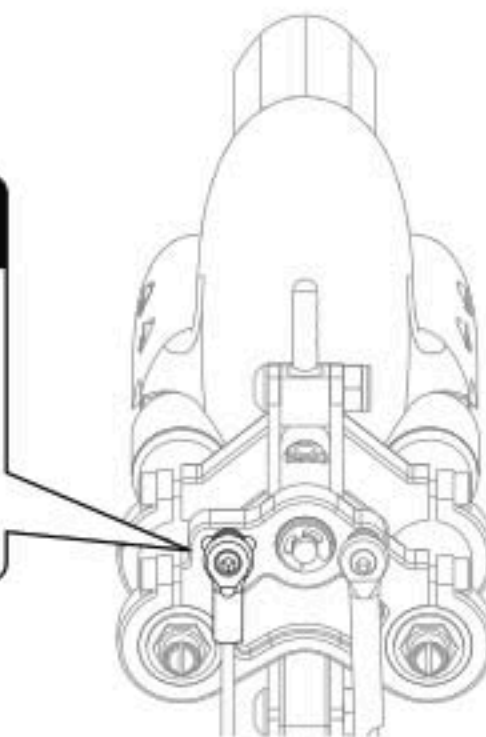
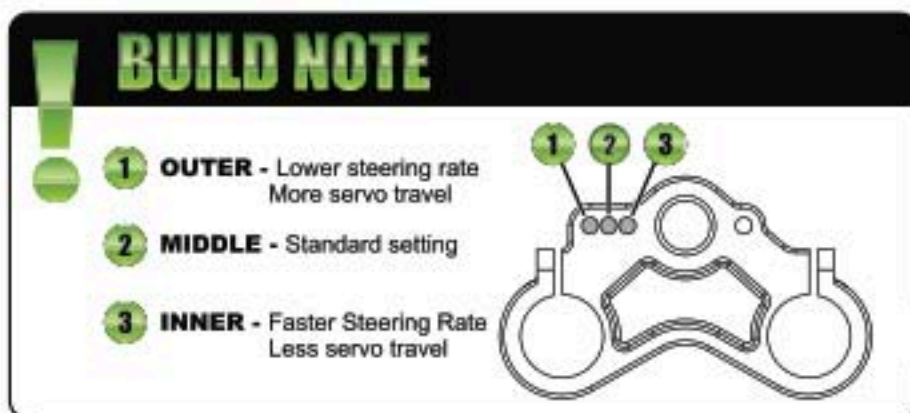



## GEAR RATIO

		SPUR GEAR		
		60	62	64
P I N I O N	12	5:1	5.16:1	5.33:1
	13	4.6:1	4.76:1	4.92:1
	14	4.2:1	4.42:1	4.57:1
	15	4:1	4.13:1	4.26:1

**GEAR RATIO x 2.6 = FDR**

Final Drive Ratio (Pinion/Wheel)

**EXAMPLE:**

$4.57 \times 2.6 = 11.88:1$  FDR

## SPEED CHART

MOTOR	BATTERY	NO LOAD RPM	PINION/ SPUR	ESTIMATED SPEED
FireBall 370	6 Cell	30,000	15/64	44.3k/h / 27.5mph
4000kv Brushless	2S LiPO	33,600	13/60	46.0k/h / 28.57mph
6000kv Brushless	2S LiPO	50,400	14/60	75.6k/h / 46.9mph
8000kv Brushless	2S LiPO	67,200	15/60	105.8k/h / 65.7mph

**Note:** All speeds are based on calculations. Actual speeds may vary depending on conditions. Using the formula below you can estimate your setup speed.

**Formulas to Calculate Estimated Speed (use in sequence):**

**Find these values first:**

Rear Tire Roll Out = 273mm

KV x Voltage = RPM (No Load RPM)

Pin/Spur Ratio x 2.6 = FDR

**Follow this sequence:**

$RPM \div FDR = \text{Wheel RPM (WRPM)}$

$WRPM \times \text{Rear Tire Roll Out} = \text{mm/min}$

$\text{mm/min} \div 1000 = \text{Meters per min (m/min)}$

$\text{m/min} \times 60 \text{ minutes} = \text{Meters/hour (m/hr)}$

$\text{m/hr} \div 1000 = \text{Kilometers per hour (k/h)}$

$\text{k/h} \times 0.621 = \text{Miles Per Hour (mph)}$

Subtract 20% from the estimated speed for a more realistic speed prediction.



## DROOP SCREW SETTING

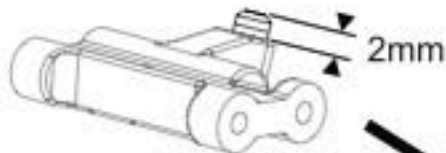

The Droop Screw limits the down travel of the swing arm. The stock setting has 2mm of exposed screw.  
**Note:** Droop settings can effect ride height adjustments.

**More Travel** = Good for loose surface conditions. More active suspension

**Less Travel** = Good for higher grip surface conditions. Less active suspension.

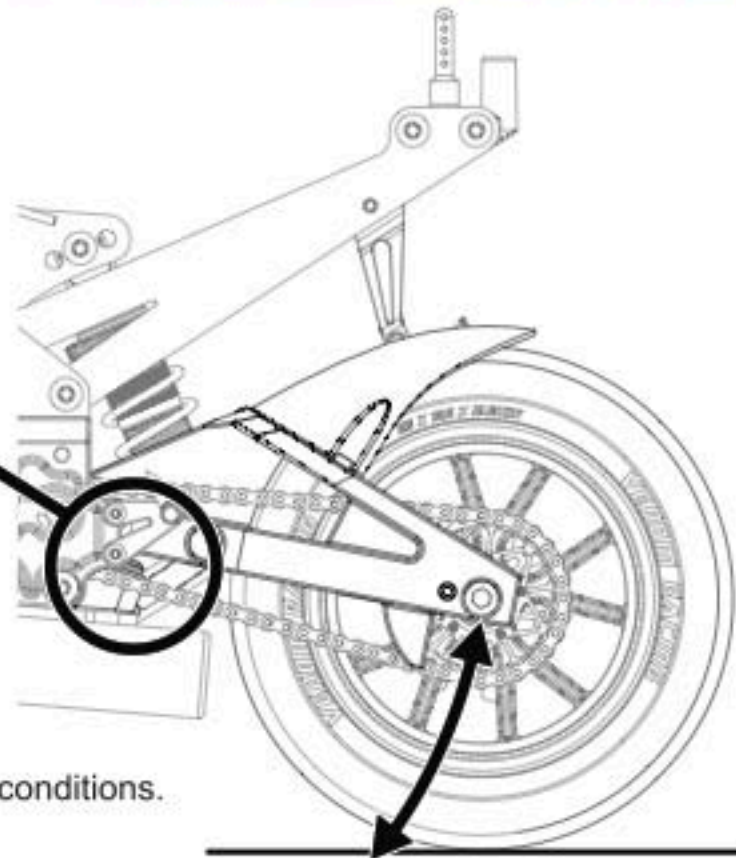

**NOTE:** The stock setting provides approximately 6mm of down travel.

## WHEEL SETS

Fine tune the responsiveness of the GPV-1 with different combinations of weighted wheel sets.

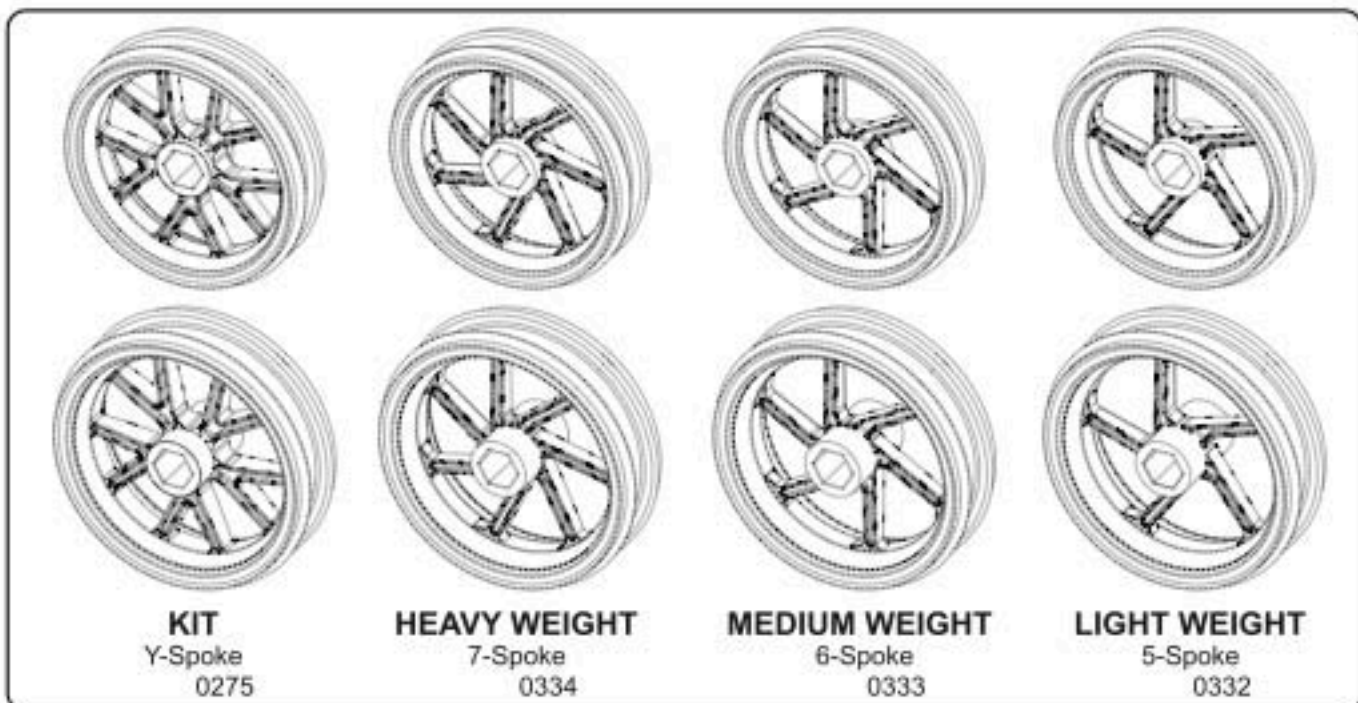

### NOTE:

The kit wheels are the heaviest and most stable wheel set available for the GPV-1. A lighter wheel set will be more agile and accelerate faster.



## RIDE HEIGHT SETTING

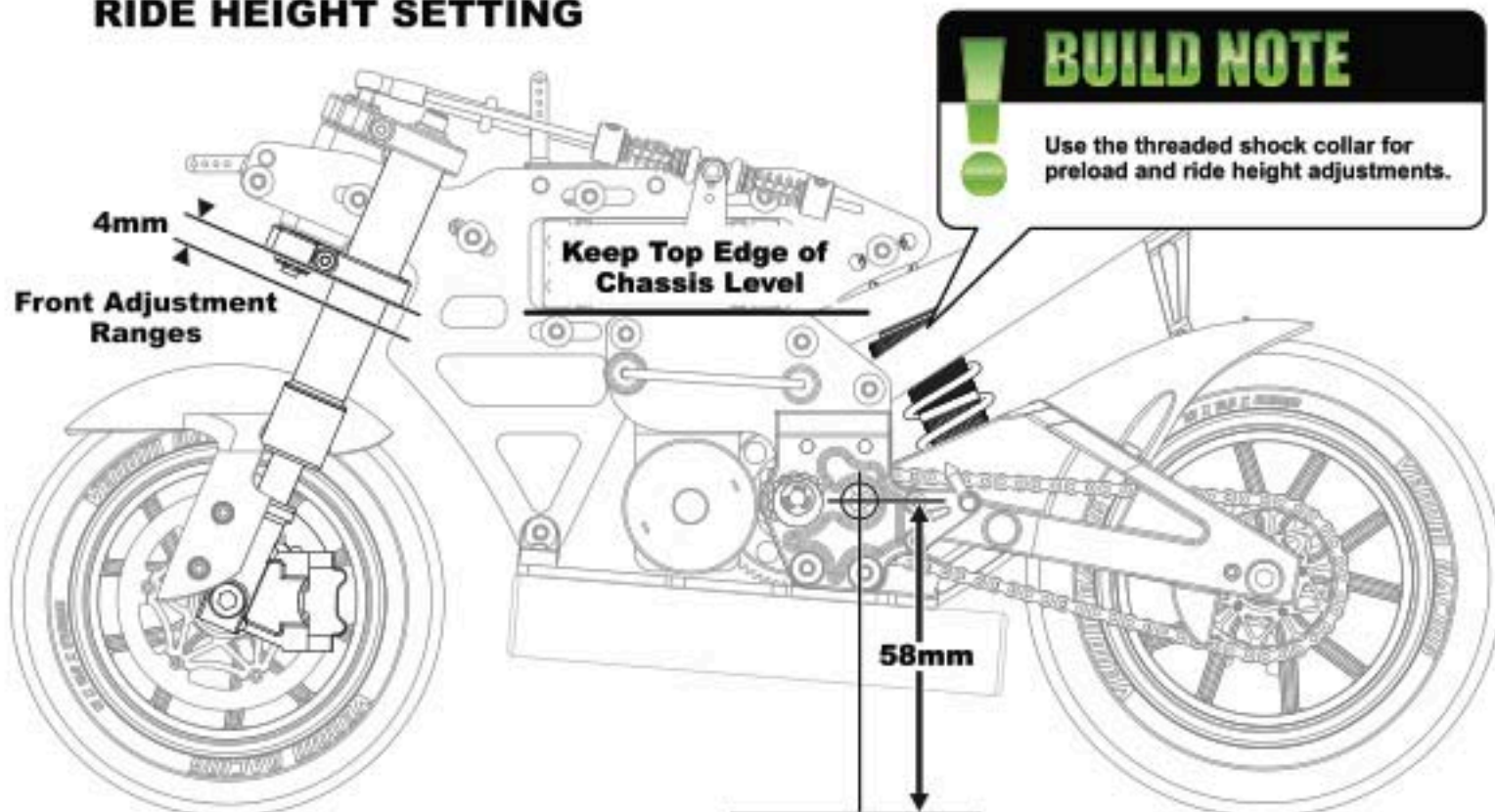

Rear shock angle, rake angle, and wheelbase adjustments can all effect the ride height of the GPV-1. The chassis should stay about 58mm from the swing arm pivot point to the ground for the most consistent handling characteristics. If the ride height is too low, the bodywork may drag on the ground during extreme lean angles making the bike unstable. When adjusting the ride height, make sure the top edges of the chassis remain parallel to the ground. Adjust the rear ride height using the threaded shock collar. The front ride height can be adjusted a total of 4mm by loosening the 0251 Cap Head Screws and sliding the front forks up or down. Remember to re-tighten the front fork cap head screws before running the GPV-1.

### BUILD NOTE

Raising the rear ride height alone will also change the rake angle. Lowering the front ride height in addition will change the rake angle even more. Consider this adjustment combination carefully to fine tune the steering response and performance of the GPV-1.



## Exploded View

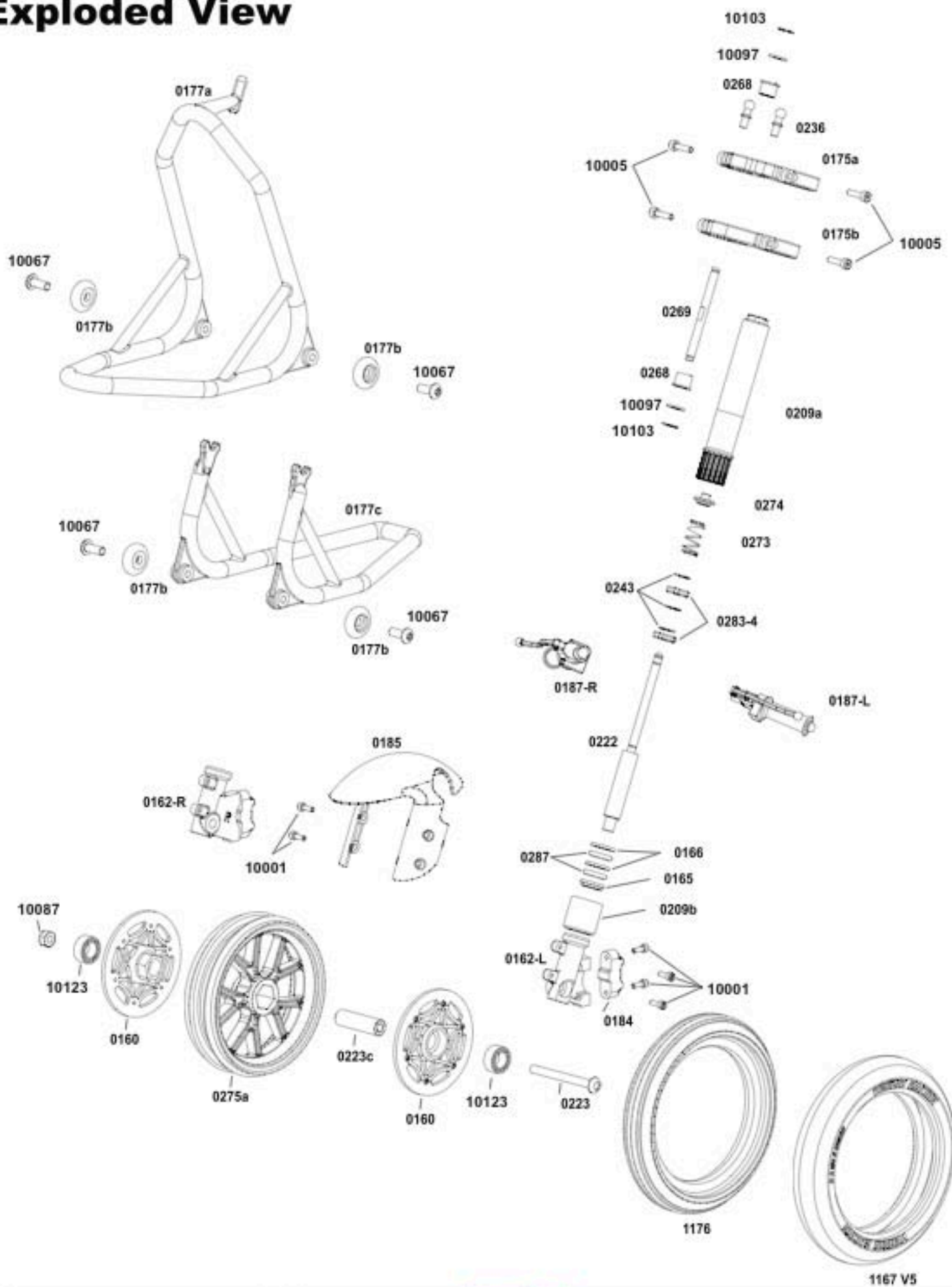





## Exploded View

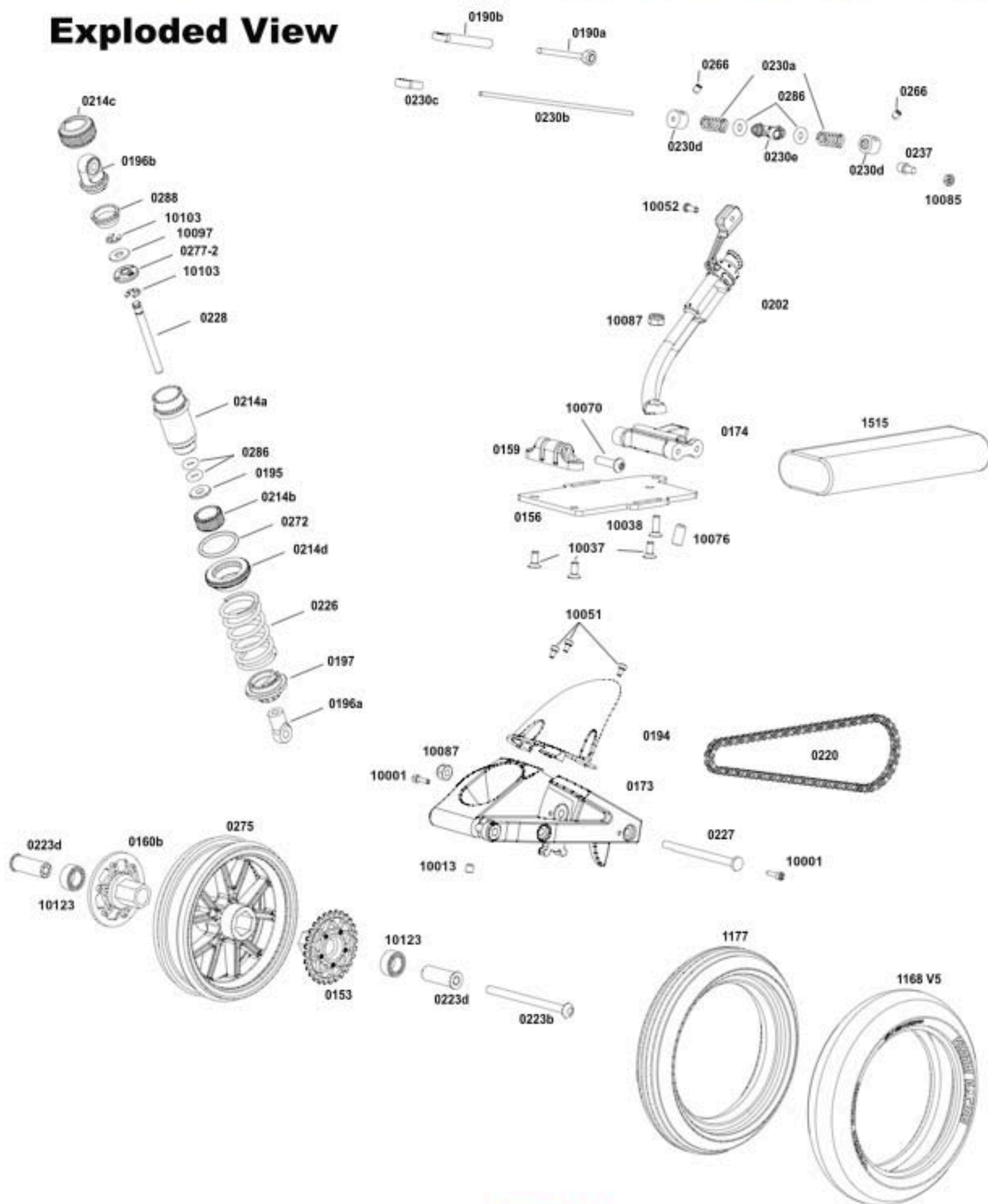



# PARTS LIST

## KIT PARTS

PART #	DESCRIPTION
0150	Chassis Standoff Set - GPV1
0153	28T Chain Sprocket - GPV1
0155	64T Spur 0.5M - GPV1
0156	Battery Plate RTR - GPV1
0157	Steering Stem RTR - GPV1
0159	Front Battery Tray Mount - GPV1
0160	Brake Rotors - GPV1
0162	Lower Fork Legs - GPV1
0163	L/R Chain Tensioners - GPV1
0164	Chassis Blocks - GPV1
0165	O-Ring Spacer Flanged - GPV1
0166	O-Ring Spacer Flat - GPV1
0168	Rear Cross Member/Body Post - GPV1
0170	Servo Mounts - GPV1
0173	Swing Arm - GPV1
0174	Swing Arm Stop - GPV1
0175	Triple Clamp Set - GPV1
0177	Track Stand Set - GPV1
0183	Body Mounts - GPV1
0184	Front Brake Caliper - GPV1
0185	Front Fender - GPV1
0186	Foot Pegs - GPV1
0187	Handlebars - GPV1
0188	Wire Mount Set - GPV1
0190	Steering Damper - GPV1
0194	Rear Fender - GPV1
0195	Rear Shock Lower Cap Bushing - GPV1
0196	Rear Shock Pivots - GPV1
0197	Rear Shock Spring Perch - GPV1
0202	Scale Exhaust - GPV1
0208	Center Chassis Standoff - GPV1
0209	Fork Tubes - GPV1
0213	Motor Mount - GPV1
0214	Rear Shock Body and Caps - GPV1
0219	Spur Gear Hub - GPV1
0220	Chain - GPV1
0221	Drive Shaft - GPV1
0222	Fork Shaft - GPV1
0223	Axles and Spacers - GPV1
0224	Guide Wire - GPV1
0226	Rear Shock Spring - GPV1
0227	Shock Pivot Shaft - GPV1
0228	Shock Shaft - GPV1
0230	Steering Link Assembly - GPV1
0231	Swing Arm Pin - GPV1
0232	Hardware Kit - GPV1
0234	Front Sprocket Spacer - GPV1
0236	Threaded Pivot Ball - GPV1
0238	11T Chain Sprocket - GPV1
0239F	Center Chassis Plate - GPV1
0240F	Chassis Side Plates RTR - GPV1
0241F	Rear Sub Frame Plate RTR - GPV1
0268	Flanged Steering Bushing - GPV1
0269	Steering Stem Pin - GPV1
0270	Battery Strap - GPV1
0273	Fork Spring - GPV1
0275	Wheel Set Y Spoke - GPV1
0277	Shock Pistons - GPV1
0283	Fork Pistons - GPV1
0284	6X3X2.5MM Bearing - GPV1
0285	10X6X3MM Wheel Bearing - GPV1
0286	Rear Shock O-Ring (3pcs) - GPV1
0287	O-Ring 5.8ID X 8.9OD - GPV1
0288	Rubber Shock Bladder - GPV1
0290-02	Body Set Blue - GPV1
0290-03	Body Set Green - GPV1
0290-04	Body Set Orange - GPV1
0290-05	Body Set Red - GPV1
0290-06	Body Set White - GPV1

PART #	DESCRIPTION
0290-07	Body Set Yellow - GPV1
0326	Body Clip (5pcs) - GPV1
0340-02	Rider Figure Green - GPV1
0340-03	Rider Figure Black - GPV1
0340-04	Rider Figure Red - GPV1
0654	6-Cell NiMH Wall Charger
1167V5	Front Tire V5 Hard - GPV1
1168V5	Rear Tire V5 Hard - GPV1
1176M	Front Tire Insert (Med) - GPV1
1177M	Rear Tire Insert (Med) - GPV1
1320	Fireball Micro 370 Motor
1381	V-Series 18R 160amp Brushed ESC
1515	1200mah 6Cell 2/3A 7.2V NiMH Battery
8178	Venom 3-Ch FM Transmitter & RX
8269-01	Venom Crystal Set Ch 1 - 26.995MHz
8269-02	Venom Crystal Set Ch 2 - 27.045MHz
8269-03	Venom Crystal Set Ch 3 - 27.095MHz
8269-04	Venom Crystal Set Ch 4 - 27.145MHz
8269-05	Venom Crystal Set Ch 5 - 27.195MHz
8269-06	Venom Crystal Set Ch 6 - 27.255MHz
8270	Venom Mini Servo 308
8271	Venom Micro Brake Servo 140

## OPTION PARTS

### PART #DESCRIPTION

0290-01	Body Set Clear - GPV1
0300	Alloy Triple Clamp Set - GPV1
0313	60T Spur Gear .5M - GPV1
0314	62T Spur Gear .5M - GPV1
0323	Option Steering Stem (Plastic) - GPV1
0327	Alloy Servo Mount Set - GPV1
0328	Race Chassis Kit - GPV1
0329	Alloy Steering Stem Set - GPV1
0330	Alloy Chassis Block Set - GPV1
0331	Alloy Lower Cross Member Set - GPV1
0332	Wheel Set A (5 spoke) - GPV1
0333	Wheel Set B (6 spoke) - GPV1
0334	Wheel Set C (7 spoke) - GPV1
0336	Alloy Standoff Set - GPV1
0338	Titanium Screw Set - GPV1
0339	Steering Bearing Set - GPV1
0340-01	Rider Figure White - GPV1
0352	Alloy Forks & Preload Adjustment - GPV1
0353	Alloy Rear Shock - GPV1
0355	Brake Kit - GPV1
0356	Brake Cable Bracket - GPV1
0357	Brake Cables - GPV1
0358	Lower Fork Legs-BK - GPV1
0359	Calipers-Brake Kit - GPV1
0360	Brake Cable Clevis - GPV1
0361	Rotor Hub - GPV1
0362	Brake Pads - GPV1
1167V1	Front Tire V1 Soft - GPV1
1167V3	Front Tire V3 Med - GPV1
1168V1	Rear Tire V1Soft - GPV1
1168V3	Rear Tire V3 Med - GPV1
1364	V-Series V20L Brushless Motor
1550	10C 7.4v 1250Mah 2-Cell LiPO Battery
1551	10C 11.4v 1250Mah 2-Cell LiPO Battery







## Setup Sheet

\* Denotes Factory Setting

Name: \_\_\_\_\_ Date: \_\_\_\_\_

Track: \_\_\_\_\_ Track Condition: \_\_\_\_\_ Air/ Track Temp: \_\_\_\_\_ / \_\_\_\_\_

**Rake Angle** \*

☐ 64.0°  
☐ 66.5°  
☐ 69.0°

**Shock Angle**

☐ 1 Soft  
☐ 2  
☐ 3  
☐ 4  
☐ 5 Medium \*  
☐ 6  
☐ 7  
☐ 8  
☐ 9 Hard

**Front Ride Height**

-4mm ☐  
-3mm ☐  
-2mm ☐  
-1mm ☐  
\*0mm ☐

**Wheel Base**

☐ 180mm  
☐ 182mm  
☐ 185mm \*  
☐ 190mm  
☐ 193mm

**Chassis**  
RTR ☐  
Race ☐

**Rear Ride Height**  
\*127mm

**Steering Rate**

S = Slow  
M = Medium  
F = Fast

☐ S ☐ M ☐ F

☐ Bushing  
☐ Bearing

**Suspension**

**Forks**  
Oil Weight: \_\_\_\_\_  
Piston Top: \_\_\_\_\_  
Piston Btm: \_\_\_\_\_  
Spring: \_\_\_\_\_  
Preload: \_\_\_\_\_

**Rear Shock**  
Oil Weight: \_\_\_\_\_  
Piston Top: \_\_\_\_\_  
Spring: \_\_\_\_\_  
Preload: \_\_\_\_\_

**Steering Damper**  
Grease: Y N  
O-ring: 1 2 3

**Battery**  
Size: \_\_\_\_\_  
Type: \_\_\_\_\_  
Pos: Fwd Mid Bk

**Droop**  
\_\_\_\_\_ mm  
\*2 mm

**Tires** Fr: \_\_\_\_\_ Rr: \_\_\_\_\_  
**Insert** Fr: \_\_\_\_\_ Rr: \_\_\_\_\_

**Wheel Set**

Front:	Kit	Rear:	Kit
Heavy		Heavy	
Medium		Medium	
Light		Light	

**Gear Ratio**

		SPUR GEAR		
		60	62	64
PINION	12	5:1	5.16:1	5.33:1
	13	4.6:1	4.76:1	4.92:1
	14	4.2:1	4.42:1	4.57:1
	15	4:1	4.13:1	4.26:1

**Electronics**  
Servo: \_\_\_\_\_  
Rec: \_\_\_\_\_  
ESC: \_\_\_\_\_  
Motor: \_\_\_\_\_

**Option Parts**  
1) \_\_\_\_\_ 3) \_\_\_\_\_  
2) \_\_\_\_\_ 4) \_\_\_\_\_







# GPV-1 PRO

## WARRANTY, SERVICE AND SUPPORT

Thank you for purchasing the GPV-1™. We want to assure you that your model is backed by first-class customer service and support.

If you have questions or concerns about your GPV-1™, simply call us at 800.705.0620, Monday – Friday, 9:00am to 4:00pm Pacific Standard Time. You can also e-mail us at [customerservice@venom-group.com](mailto:customerservice@venom-group.com). For hands on service and faster access to replacement parts, please visit your local hobby shop.

### Venom Group™ Limited Warranty

Venom™ products are warranted to be free of material and workmanship defects for a period of 30 days\* from date of purchase for all electronic components and 90 days\* for all non-electronic components. If a component is defective or was not correctly made, Venom™ will, at its sole discretion, repair or replace the item free of charge. This warranty does not cover normal wear and tear, crash damage, modifications, failure to perform routine maintenance, or any damages arising as a result of improper use.

The GPV-1™ is a hobby-class model™ and not a "toy". Because this product is intended to be used over a wide range of operating conditions and situations, Venom Group™ does not offer any warranty, express or implied, that covers damage caused by normal use or wear, or cover or imply how long any component of the GPV-1™ will last before requiring replacement due to wear or breakage.

Any and all warranty coverage does not cover replacement of parts and components damaged by water, neglect, improper use, chemical damage, crash damage, unauthorized modification or the use of any non Venom™ product in association with the GPV-1™.

**A dated & itemized sales receipt must accompany any product returned for warranty work.**

### Repair

For all non-warranty repairs, Venom Group™ charges \$20/hr plus the cost of the replacement parts and \$10 for return shipping to US/Canada or \$30 International.

When sending in a product for warranty and/or repair, please follow these steps:

- 1) Call Venom Group™ Customer Service at 800-705-0620 to receive a Return Merchandise Authorization Number (RMA #).
- 2) Include a short summary of the problem.
- 3) Include your return address, \*\*\*We can NOT return ship to PO Boxes\*\*\*.
- 4) Include a daytime telephone number and/or e-mail address.
- 5) When preparing the GPV-1™ for shipment, please use the following guidelines to assist us in expediting your repair and keeping any repair costs for you to a minimum:
  - Remove all batteries from the GPV-1™.
  - Remove any non Venom™ after-market parts.
  - Package all items in original box as arranged upon purchase.
  - If you are sending loose items, please seal them in a bag to avoid loss. Make sure to secure all parts to prevent further damage.
  - Ship your package "Insured" and ask for "Delivery Confirmation" with a tracking number. Venom Group™ will not be responsible for lost or damaged packages in transit to us.

## WARNING

Venom Group™ and its affiliates, partners and subsidiaries cannot control the use, application or installation of this product and shall not be held liable for any property damage or personal injury resulting from the improper use of this product or failure to follow the supplied instructions.

By the act of using this product, the user accepts all resulting liability. In no case will Venom Group™ liability be greater than the actual purchase price of the product.

## CONTACT

Venom Group International  
14028 N. Ohio Street  
Rathdrum Idaho 83858

Australia  
PO Box 7325  
Alexandria NSW 2015

Customer Service  
800.705.0620  
208.762.0620 (Outside USA)  
[customerservice@venom-group.com](mailto:customerservice@venom-group.com)





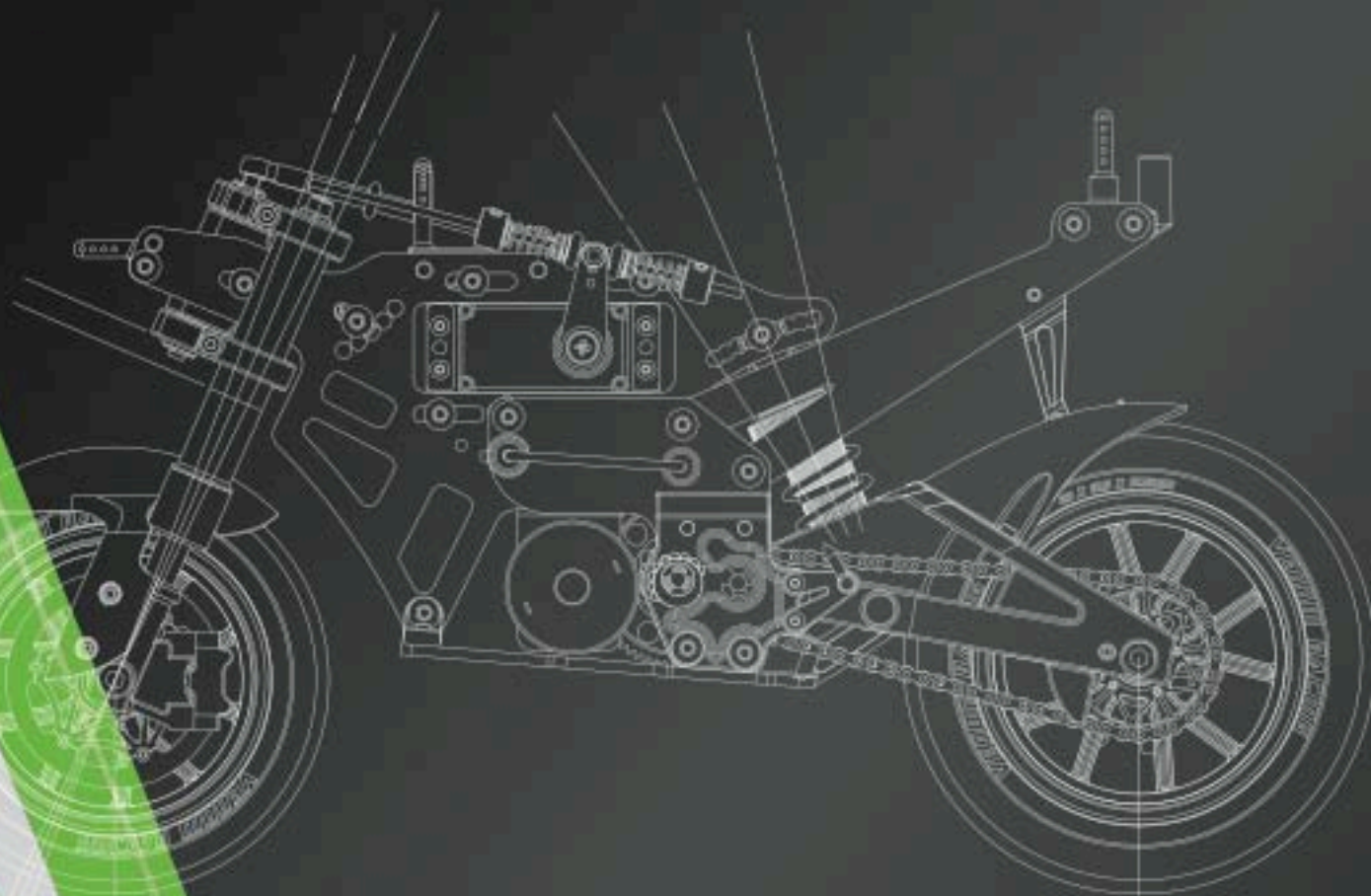

#### **Notice of Rights**

All rights reserved. No part of this manual may be reproduced or transmitted in any form by any means, electronic, mechanical, photocopying, recording, or otherwise, without the prior written permission of Venom Group™. For information on getting permission for reprints and excerpts, contact [customerservice@venom-group.com](mailto:customerservice@venom-group.com).

#### **Notice of Liability**

The information in this manual is distributed on an "As Is" basis, without warranty. While every precaution has been taken in the preparation of the manual, Venom Group™ does not have any liability to any person or entity with respect to any loss or damage caused or alleged to be caused directly or indirectly by the instructions contained in this manual or by the products described in it.

**Venom Group International**  
14028 N. Ohio Street  
Rathdrum Idaho 83858

**Australia**  
PO Box 7325  
Alexandria NSW 2015

**Customer Service**  
800.705.0620  
208.762.0620 (Outside USA)  
[customerservice@venom-group.com](mailto:customerservice@venom-group.com)

**[WWW.VENOM-GROUP.COM](http://WWW.VENOM-GROUP.COM)**  
[WWW.VENOM-GROUP.COM](http://WWW.VENOM-GROUP.COM)