

# ***DM-ONE-SPEC***

## ***1/8th SCALE NITRO PRO TOURING***

### ***INSTRUCTION MANUAL***



**INCLUDES UNPAINTED  
PF8GT PROTOFORM BODY**



- 2 SPEED TRANSMISSION
- PIVOT BALL SUSPENSION
- FRONT & REAR SWAY BARS
- 13mm HARD ANODIZED SHOCKS
- CNC LIGHTENED CHASSIS
- FRONT UNIVERSALS

BLANK

# MUST READ THIS BEFORE RUNNING

Running a nitro kit is fun and easy, but to make this a safe and good experience you must observe a few rules. This kit is extremely fast, easily over 40MPH, and can seriously injure someone if you are not careful.

## **Where to run car?**

- Any running area you choose must be dry. Do not run car near any water or wet dirt.
- Do not run on public streets. It is very easy to have the car run over or damaged by hitting the curb.
- Do not operate car in tight confined places. The car is very fast and will easily hit something.
- Do not run near people or animals. The car is very fast and will too easily hit someone.
- Due to noise, you will want to consider the surrounding area when operating the car.
- Do not operate the car at night. You will not be able to drive it without hitting something.
- Do not operate the car indoors. Engine exhaust is not healthy.

## **Glow Fuel**

- Glow fuel is poisonous!
- Glow fuel is flammable!
- Do not leave in fuel bottle with lid off at any time.
- Do not use any fuel other than glow fuel in this engine.

## **First Time Starting the Engine**

Caution! When starting engine make sure the following is observed.

- Set engine Master needle to 3 turns (rich setting)
- Do not do this alone, get an experienced friend to help at first.
- Fill fuel tank, try not to spill fuel. Do not spill fuel on receiver
- Hold car off the ground, so it will not runaway when first starts
- Turn on Radio and check the linkage before starting engine.
- Turn on car receiver battery switch.
- Always have an air filter on the carburetor to keep dirt out of engine.

## **Engine Break-in**

- See Engine Page.

## **Emergency Stopping Engine When Running**

- Remove air filter and cover carb. intake.
- Squeeze fuel line and hold until engine stops.
- With a rag, cover exhaust outlet.

## **Storing Car After Running**

- Remove fuel from tank and fuel lines
- Turn off radio in car
- Put a few drops of after run in engine to keep it from rusting.

- Clean oil and dirt from chassis with a degreaser like Simple Green.

## **Precautions**

- This kit is not a toy. Always run car with a second person as a spotter and pitman.
- Hot Parts - The pipe, manifold, engine and head are very hot and will cause burns.
- Rotating Parts - Keep hands away from the drive train, wheels, and engine when engine is running.
- Radio - Check batteries life before running the car. If radio does not have full control of the car with steering and/or throttle/brake do not run until corrected. Failure to correct this will result in possible injury and damage to the car or property.
- Glow fuel - **Do not** leave the glow fuel unattended with the lid off. Fuel contains Methanol and Nitro Methane both are flammable and poisonous.
- Store fuel in cool ventilated location. Refer the glow fuel label for additional precautions.
- Car Fuel tank - Never store fuel in car tank, it will ruin the engine if left in tank.
- Always turn off the car BEFORE turning off radio.
- DAMAGE DUE CAR RUN AWAY IS NOT A WARRANTY ISSUE.

**IF YOU DO NOT BREAK-IN ENGINE CORRECTLY, MAINLY AT LOW RPM, YOU WILL BREAK THE CONNECTING ROD!**

**FAILURE TO NOT READ AND FOLLOW BREAK-IN ENGINE INSTRUCTIONS WILL VOID WARRANTY!**

**CHECK RADIO SETTING, LINKAGE BEFORE STARTING.**



# REQUIRED FOR OPERATION

## THINGS NEED BESIDES THE KIT

### 3.5 cc (21 Class) ENGINE REAR EXHAUST

OFNA/Picco  
P-9R EVO  
#51219



Note: Pro kit does not include engine!



Glow Fuel  
20%



Off-Road Starter Box, 12V motor  
# 10250 - 1/8 scale Starter Box  
# 10253 - 1/8 scale Starter Box w/ Panel  
Off-Road Starter Box, two 550 motors  
# 10248 - 1/8 scale Starter Box  
# 10249 - 1/8 scale Starter Box, RTR  
Optional Parts  
# 92571 - Power Panel Glow Heater  
# 92572 - Cable for Glow Plug



Bottle's with spout  
# 10160 - large 500cc  
# 10161 - large 500 cc Auto Stop  
# 10162 - small 250cc  
# 10164 - CNC spout 500CC  
# 10167 - CNC spout 800CC



Glow Plug Long Heat with Battery & Charger  
# 10215....\$27.95  
(please note OFNA Glow Heats available)

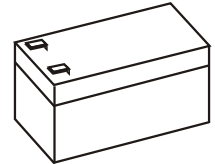

12V Battery for Starter Box  
(must have)



AA Batteries ( 12 pcs ) for radio

## RADIO CONTROL UNIT



Note: Carefully read the instruction manual of your  
2 channel radio controller before using.

### SUITABLE SERVO SIZE

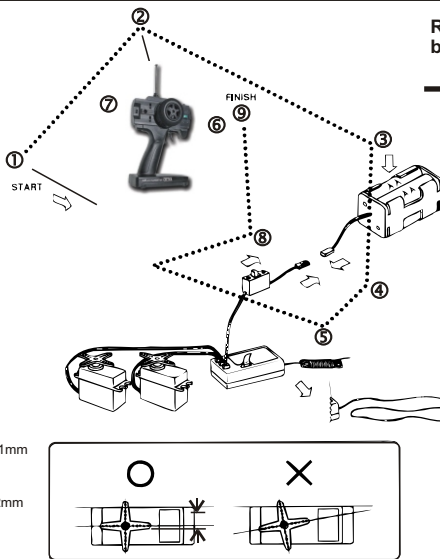
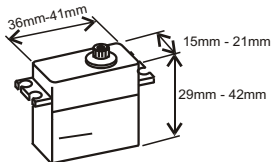

Radio must be set at neutral position  
before installing in the kit.

### SEQUENCE TO SET NEUTRAL

- ① Install AA batteries in Radio.
- ② Extend the antenna.(Transmitter)
- ③ Install batteries into Car receiver .
- ④ After installing the battery, connect the battery box.
- ⑤ Extend the antenna. (Receiver)
- ⑥ Set the trim-lever at center.
- ⑦ Turn on the switch. (Transmitter)
- ⑧ Turn on the switch. (Receiver)
- ⑨ Make sure the servos are in command.
- ⑩ When the operation stick is in neutral, servo horns must be in neutral as will. \*Adjustment can be made by re-installing the servo horn.
- ⑪ Turn off the switch. (Receiver)
- ⑫ Turn off the switch. (Transmitter)
- ⑬ Retract the antenna. (Transmitter)

### More Optional Parts . . .

#10202 NiHm Battery Hump  
Pack .. \$34.95



# 10214 NiHm Battery Pack  
Charger.. \$7.95



# 51007 OFNA/Picco Glow  
Plug .. \$13.95



## TOOLS NOT INCLUDED IN KIT

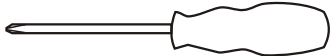

Phillips Type Screw Drivers ( L )

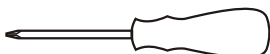

Phillips Type Screw Drivers ( S )

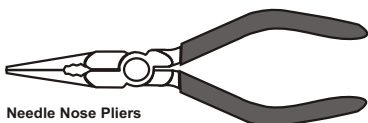

Needle Nose Pliers



Knife



Cutter

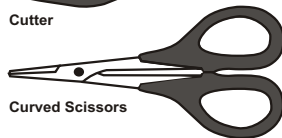

Curved Scissors

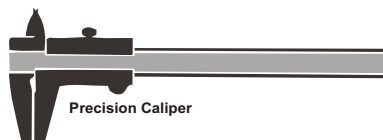

Precision Caliper



Brush



Cross Wrench



Instant Cement



Masking Tape



Paints

## INCLUDED WITH KIT

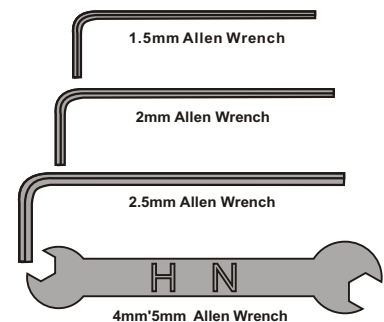



# PLASTIC PARTS FOR USE

40533  
FRONT AND REAR GEAR BOX

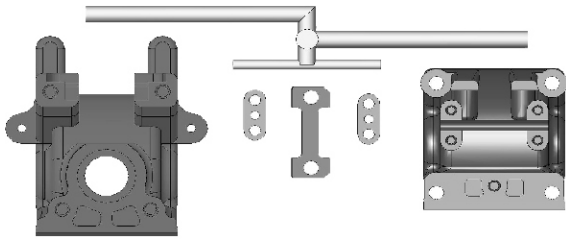

40538  
DIFF. CASE

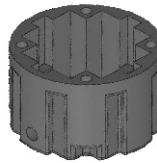

40537  
REAR UPPER ARM

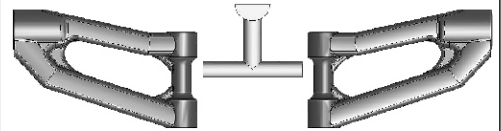

40717  
FRONT AND REAR LOWER ARM

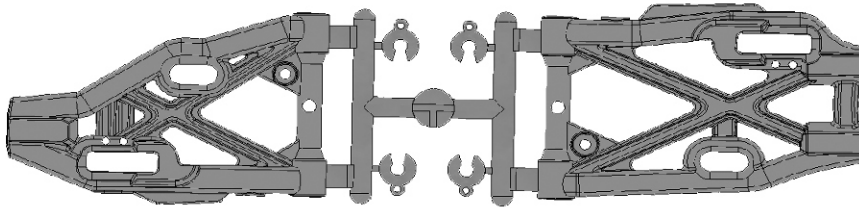

40718  
FRONT KNUCKLE ARM

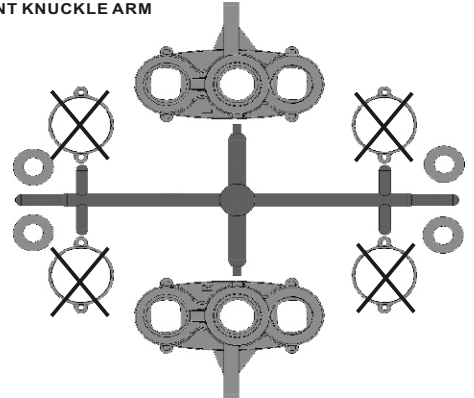

40716  
FRONT UPPER ARM

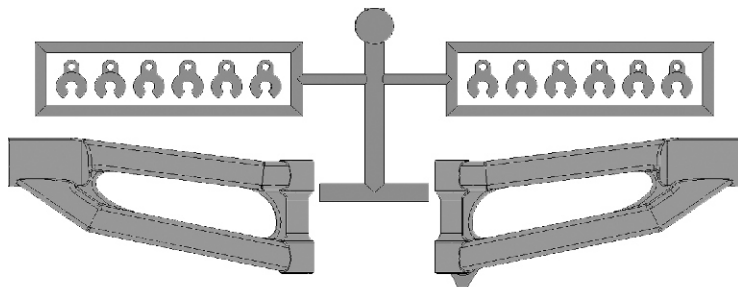

31304  
REAR UPPER RIGHT

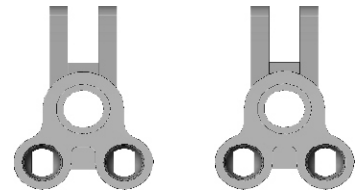

40643  
SHOCK PLASTIC



Parts For  
Not Use

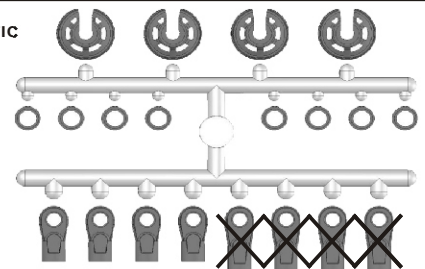

40721  
FRONT BUMPER

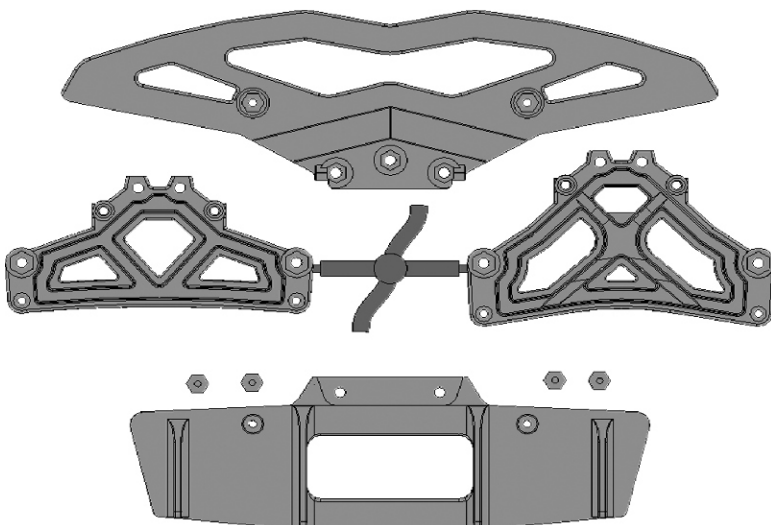

30800  
Throttle Linkage Plastic

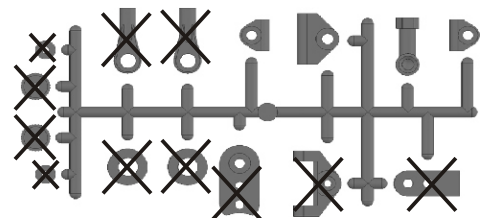

40040  
CENTER DIFF. MOUNT PLASTIC PARTS

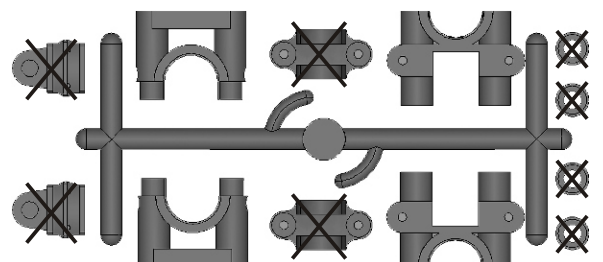

# PLASTIC PARTS FOR USE

40541  
RECEIVER BOX

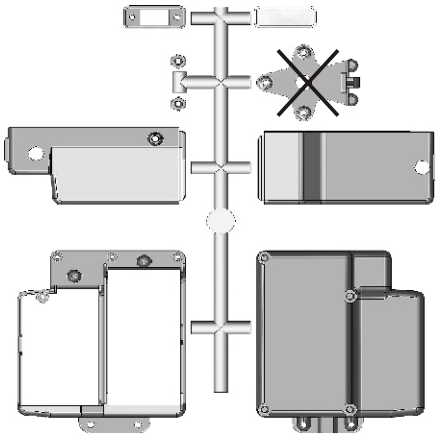

40539  
SERVO SAVER

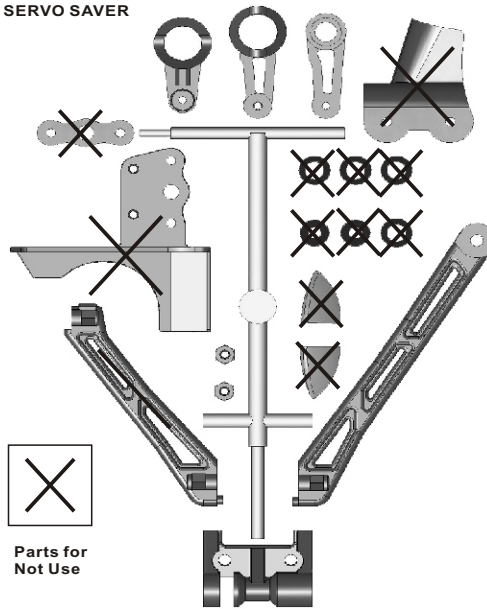

40722  
EXHAUST GAS DEFLECTOR

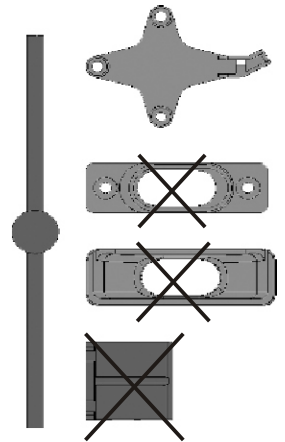

40735  
EXHAUST PIPE DETAIL PARTS  
AND BACK MIRROR

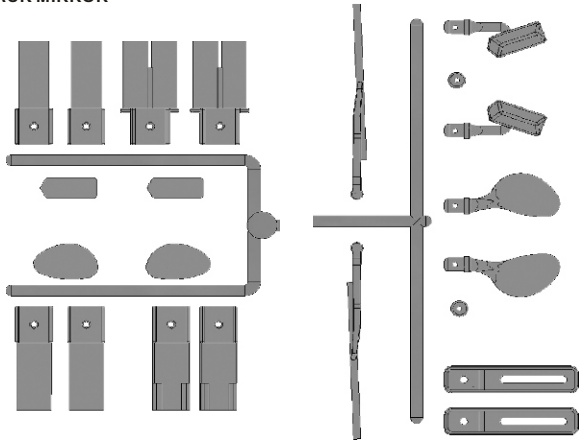

40719  
ARM HOLDER

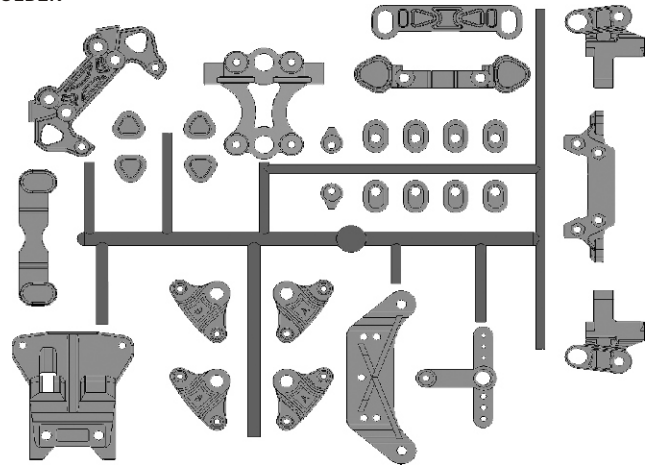

40720  
SIDE IMPACT BUMPER AND BODY POST

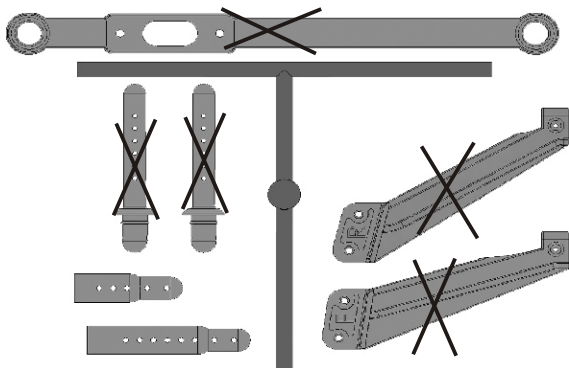

40734  
REAR WING AND WING MOUNT

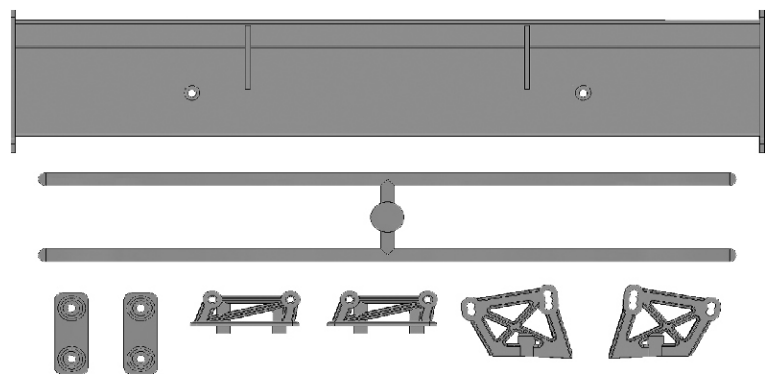

## SYMBOL USED THROUGHOUT THE INSTRUCTION MANUAL



Parts Bag Used



Degrease With  
Motor Spray



Do Not  
Over Tighten



Tighten



Ensure  
Free  
Movement



Contact Adhesive



Apply Screw  
Cement



Apply Oil



Apply Grease



True-To-Scale



Clockwise  
Rotation



Anti-clockwise  
Rotation

## 1 ASSEMBLY OF THE FRONT SHOCKS

\*Assemble 2 seats for front

Step 1

Step 2

\*Fit the o-ring into groove before assembly.

Step 3

\*Be careful not to damage shock shaft.

Step 4

Fill the shocks with oil #80.

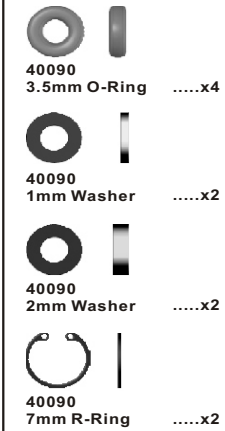

- 1.Pull down piston and pour oil into shock cylinder.
- 2.To remove air bubbles by slowly moving piston up and down.
- 3.Pull down piston, attach pressure top and shock oil overflow with tissue paper.

Step 5

Step 6

### CORRECT SHOCK ASSEMBLY

Carefully screw the shock shaft into the bottom of the plastic ball and until the distance between the ball end and the shock is 14mm.  
N.B. Do not over tighten as the plastic will strip.



## 2 ASSEMBLY OF THE REAR SHOCKS

\*Assemble 2 seats for rear

Step 1

Step 2

\*Fit the o-ring into groove before assembly.

Step 3

\*Be careful not to damage shock shaft.

Step 4

Fill the shocks with oil #80.

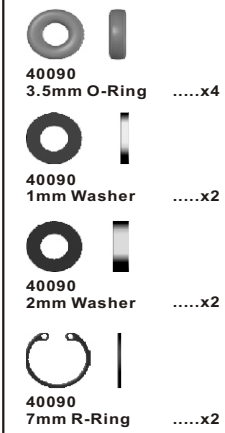

- 1.Pull down piston and pour oil into shock cylinder.
- 2.To remove air bubbles by slowly moving piston up and down.
- 3.Pull down piston, attach pressure top and shock oil overflow with tissue paper.

Step 5

Step 6

### CORRECT SHOCK ASSEMBLY

Carefully screw the shock shaft into the bottom of the plastic ball and until the distance between the ball end and the shock is 32mm.  
N.B. Do not over tighten as the plastic will strip.





#### 4 ASSEMBLY OF THE FRONT AND REAR DIFF.

Builds two differentials for front and rear.



NO.2

Step 1

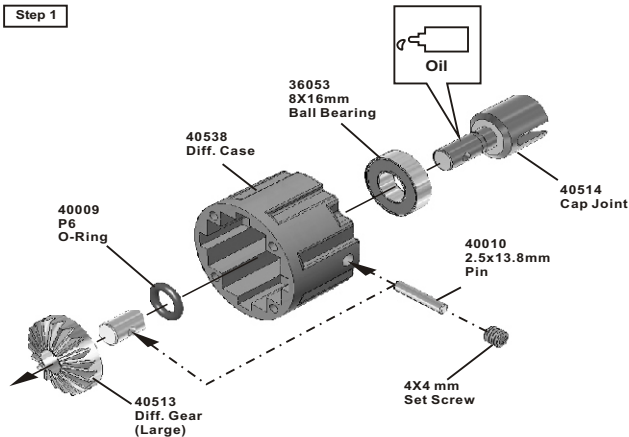
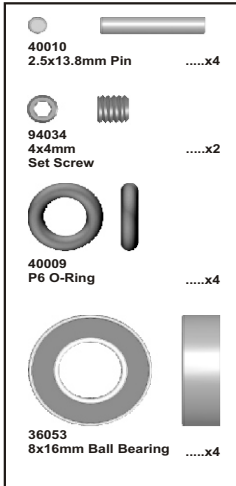

Step 2

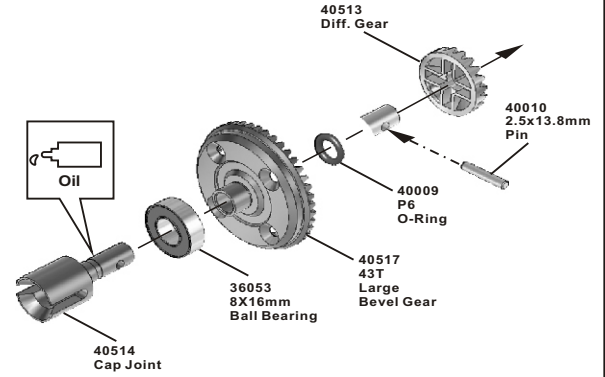

#### 5 ASSEMBLY OF THE FRONT AND REAR DIFF.

Builds two differentials for front and rear.



NO.1  
NO.12

Step 1

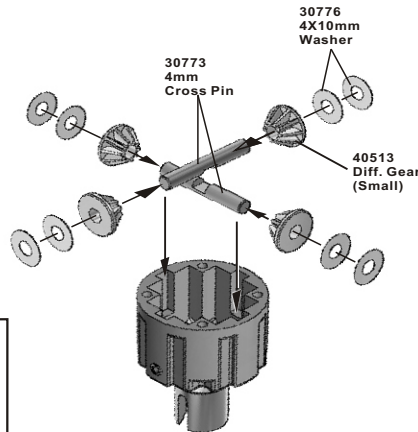
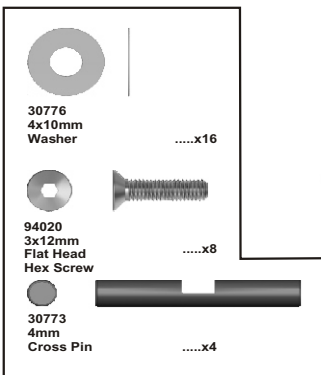

NB. It is very important to remove the 30776 washer if the gear mesh is too tight.

Step 2

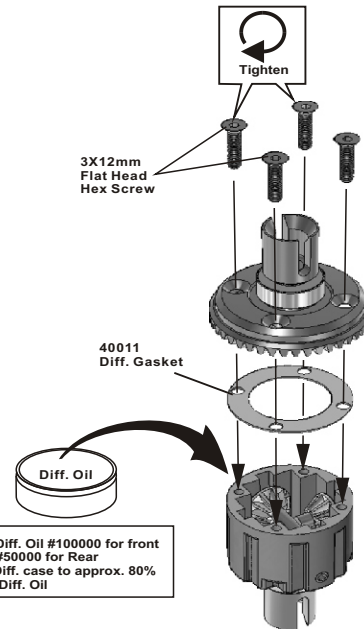

\*Put the Diff. Oil #100000 for front and the #50000 for Rear  
\*Fill the Diff. case to approx. 80% with the Diff. Oil

Tight the diff screws in this order.

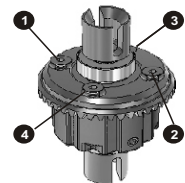

#### 6 ASSEMBLY OF THE FRONT AND REAR GEAR CASE

Builds two gear case for front and rear.



NO.2  
NO.4  
NO.5

Step 1

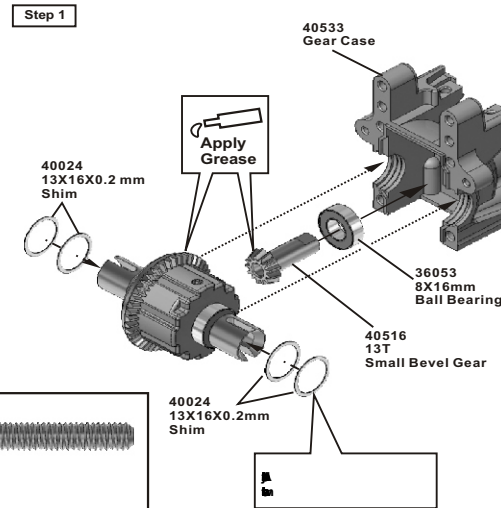
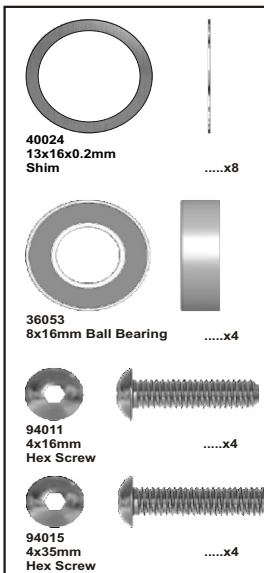

Step 2

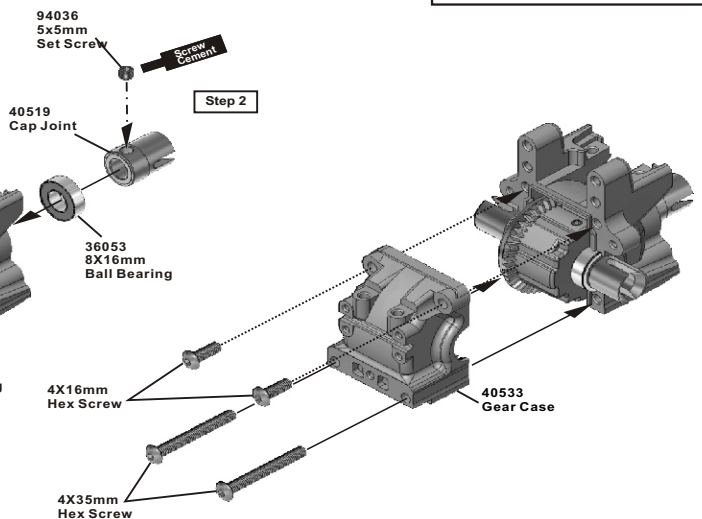

## 7 ASSEMBLY OF THE SERVO SAVER



NO.3

Step 1

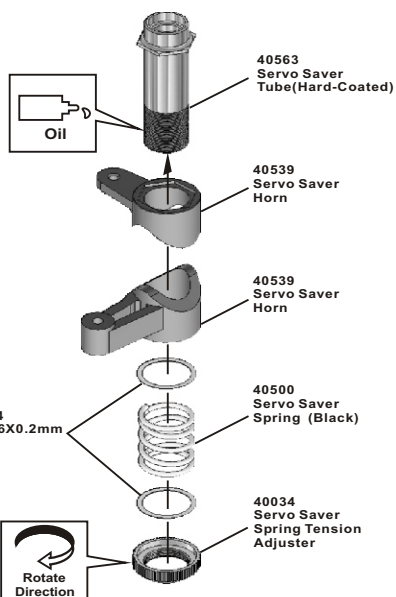
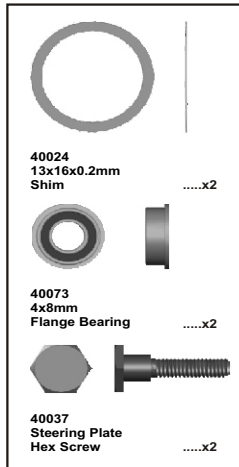

Step 2

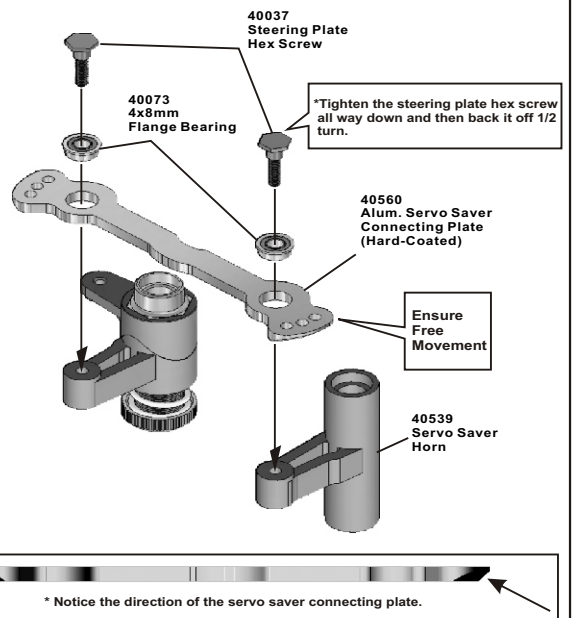

## 8 ASSEMBLY OF THE SERVO SAVER

Step 1

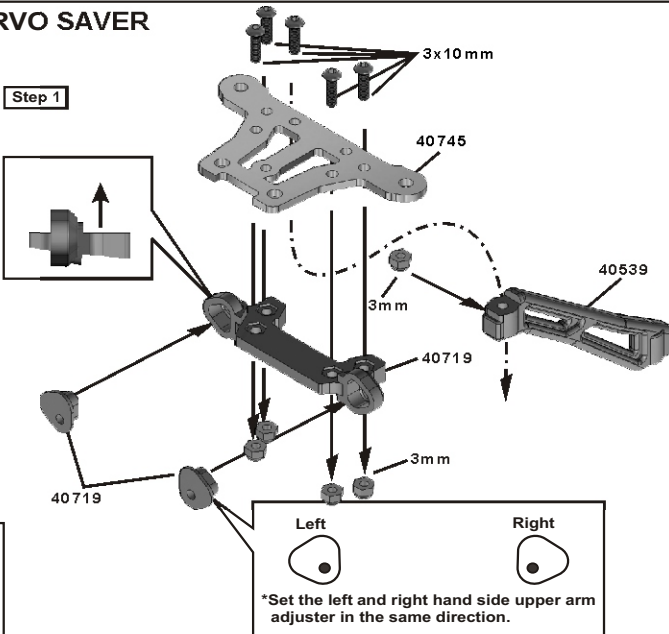
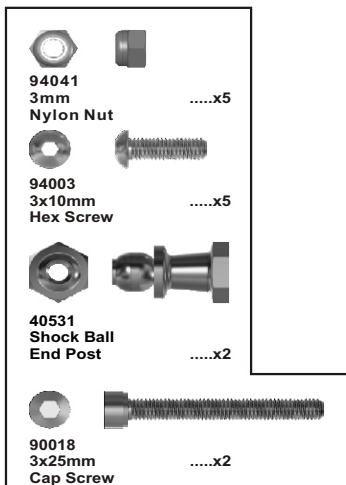

Step 2

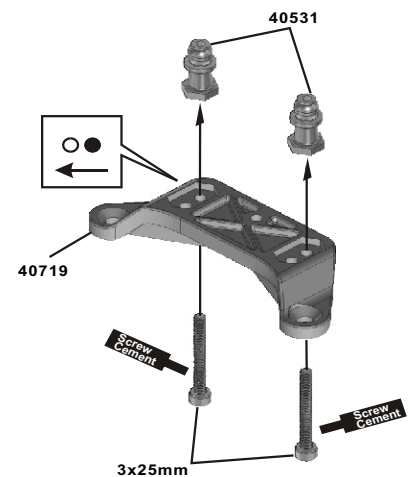

## 9 ASSEMBLY OF THE SERVO SAVER



NO.3

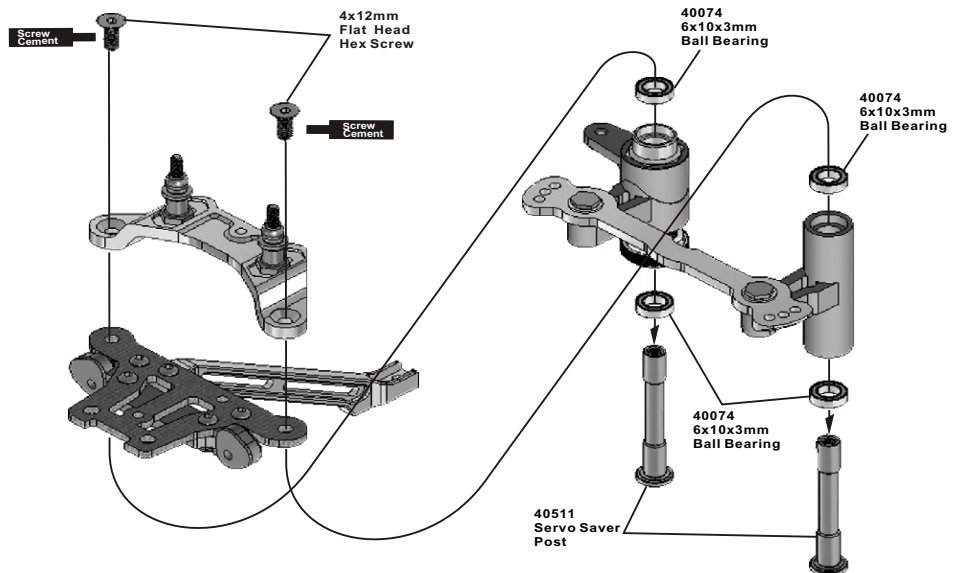
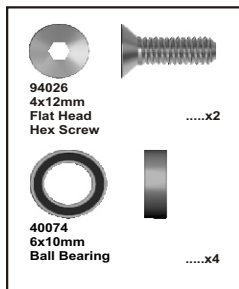

## 10 ASSEMBLY OF THE STEERING TIE-ROD

Assembly of the right and left hand side are the same.

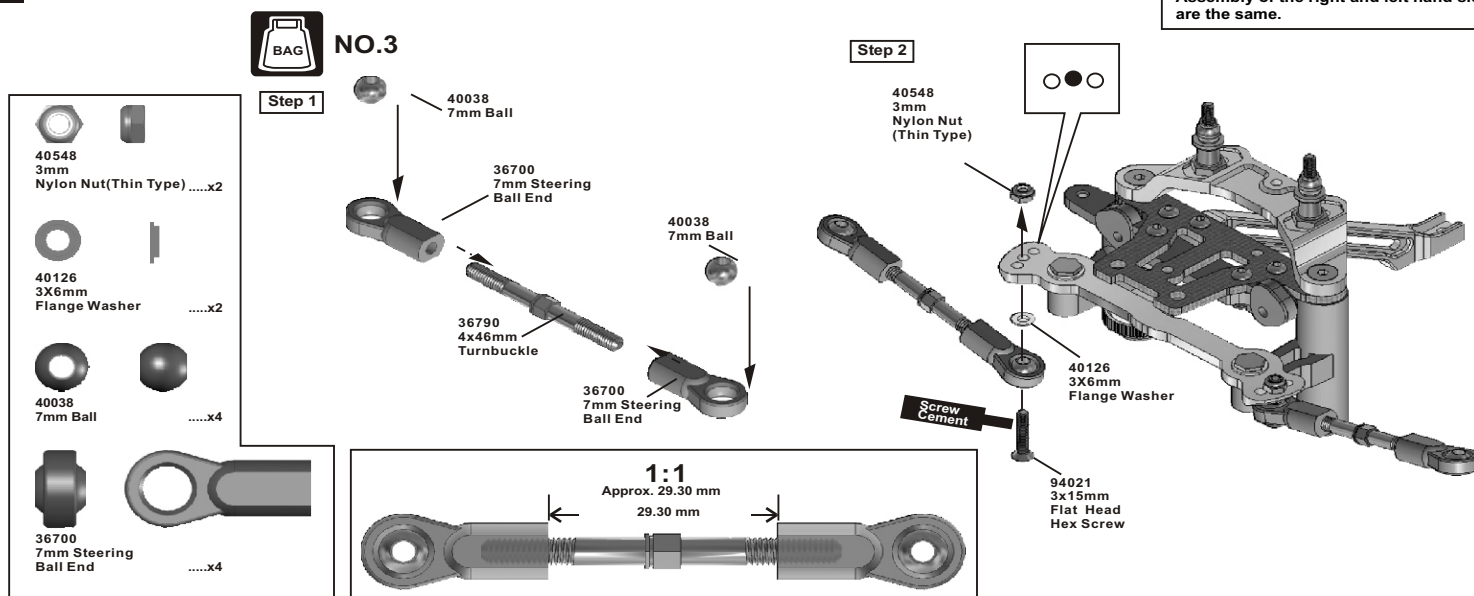

## 11 ASSEMBLY OF THE SERVO SAVER AND FRONT UPPER ARMS

Assembly of the right and left hand side are the same.

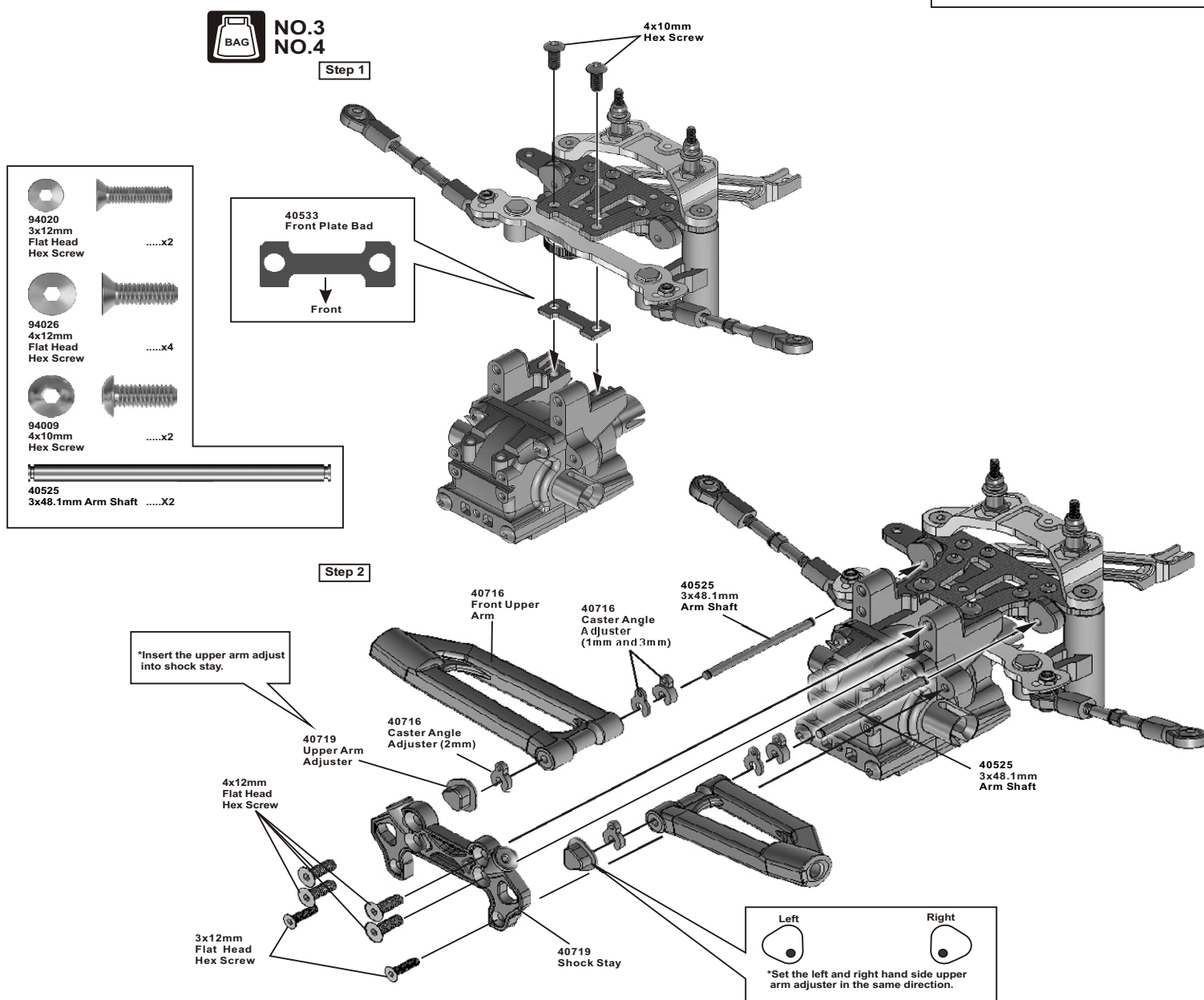



## 12 ASSEMBLY OF THE FRONT SHOCK STAY



NO.4

Assembly of the right and left hand side are the same.

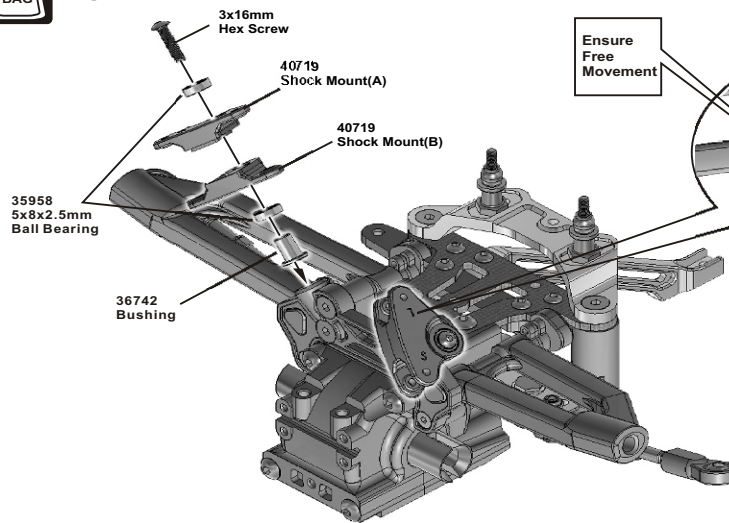
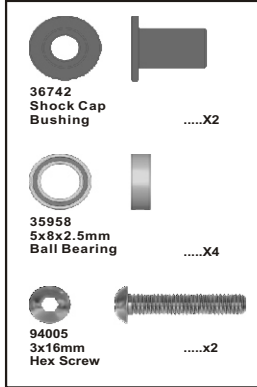

## 13 ASSEMBLY OF THE FRONT SHOCKS ONTO SHOCK STAY



NO.1

Assembly of the right and left hand side are the same.

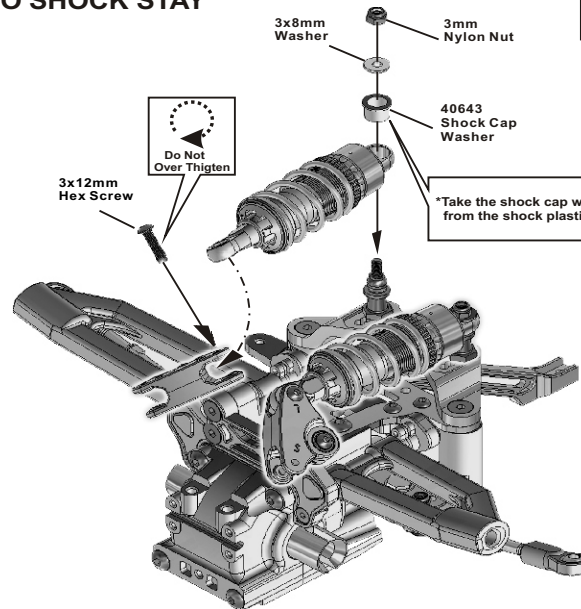
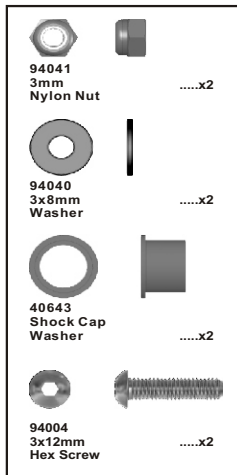

## 14 ASSEMBLY OF THE REAR SHOCK STAY AND UPPER ARMS

Assembly for both right and left side.

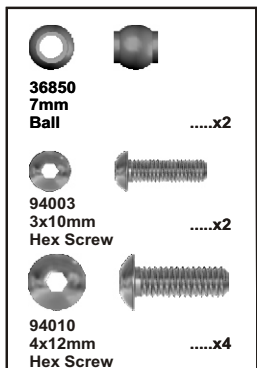

Step 1

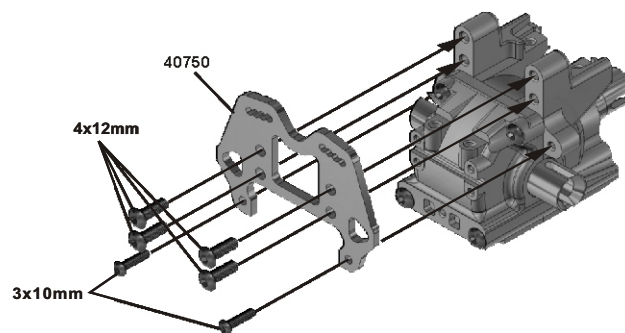

Step 2

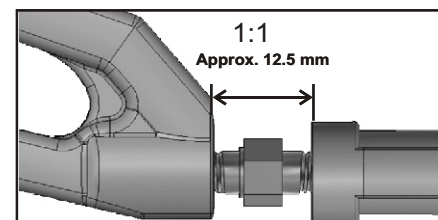
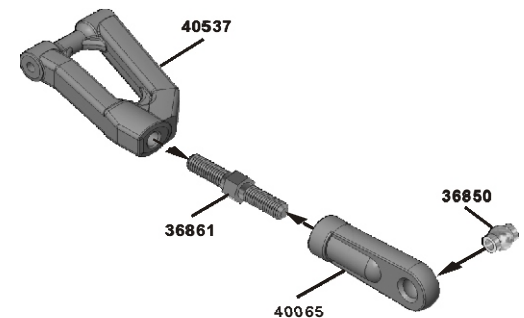

## 15 ASSEMBLY OF THE REAR UPPER ARMS

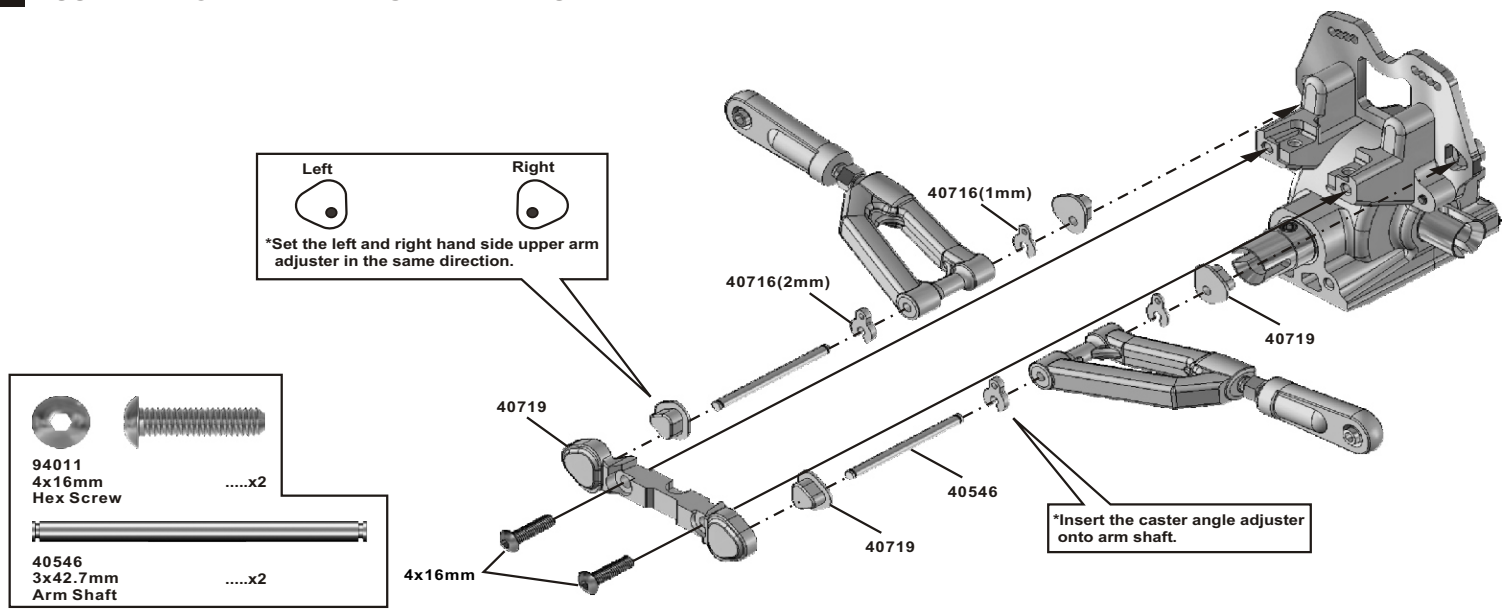

## 16 ASSEMBLY OF THE REAR BRACE

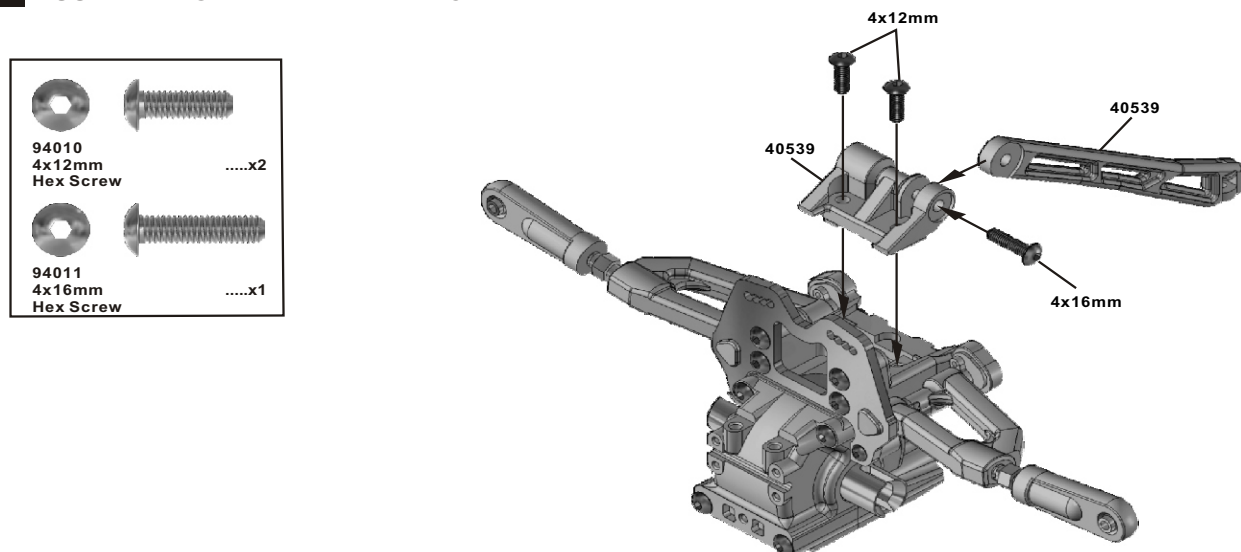

## 17 ASSEMBLY OF THE TWO SPEED GEARS

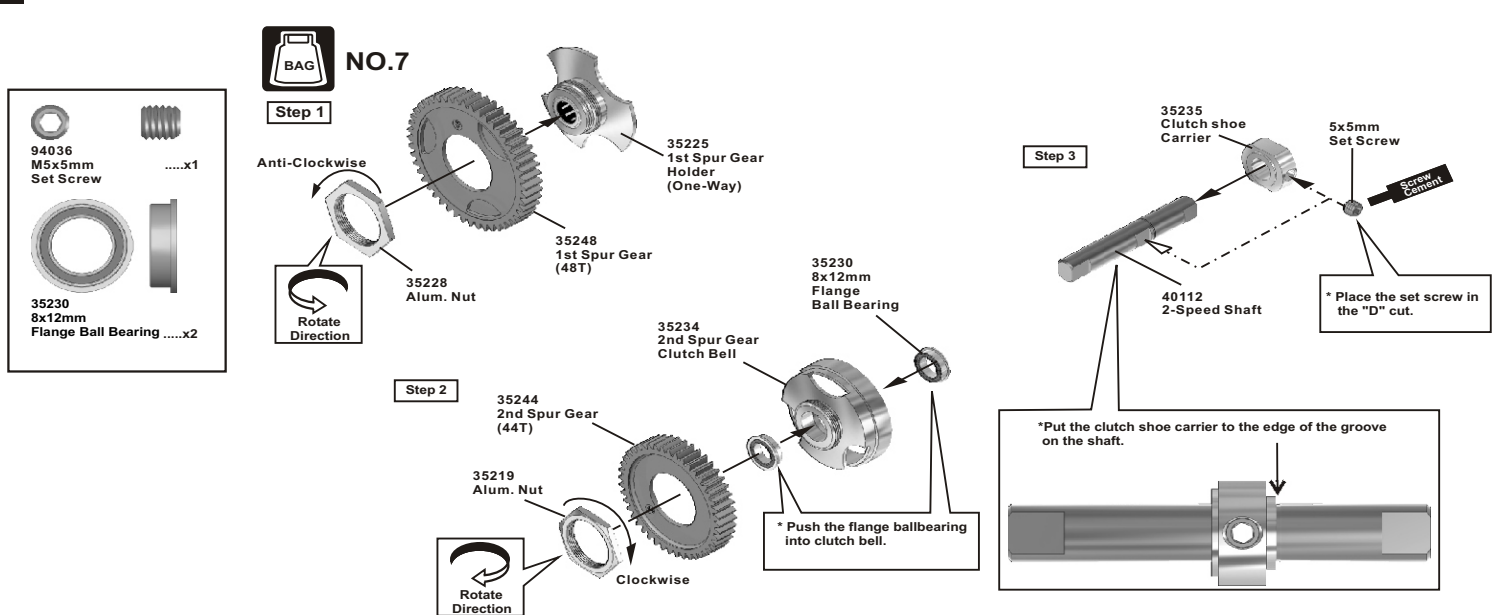

## 18 ASSEMBLY OF THE TWO SPEED TRANSMISSION



NO.7

Step 1

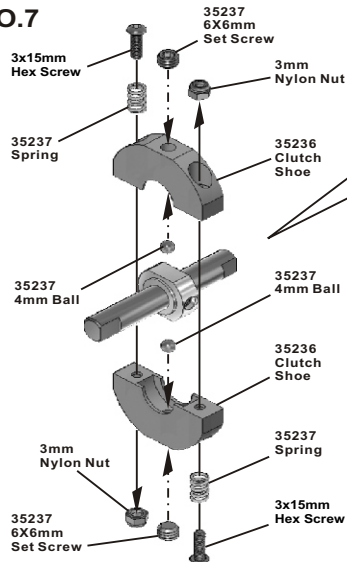
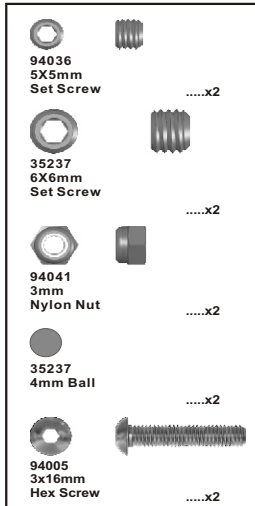

\*Screw the 3x15mm screw into the bottom and back off 5 turns.

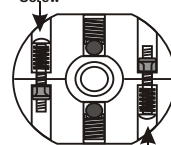

Step 2

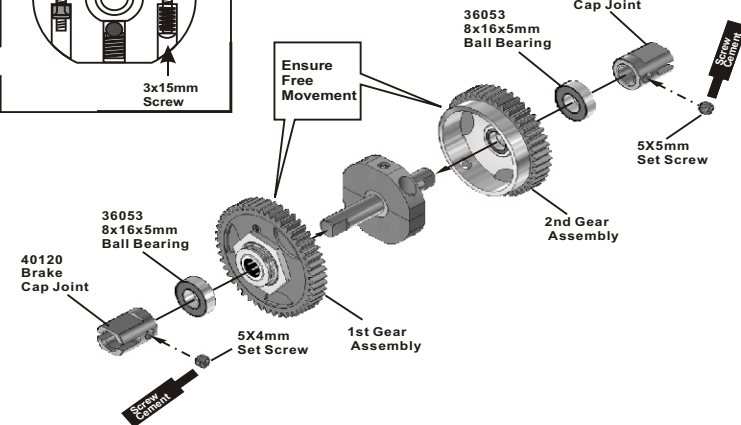

## 19 ASSEMBLY OF THE TWO SPEED TRANSMISSION INTO THE CENTER MOUNT



NO.7

Step 1

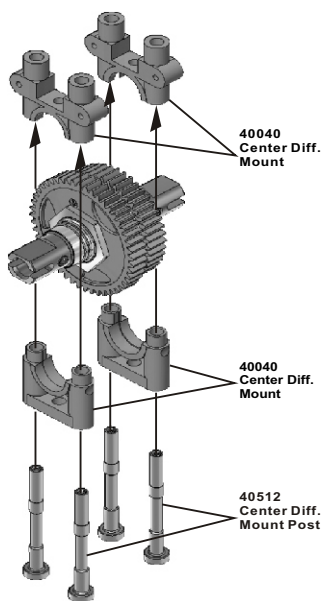
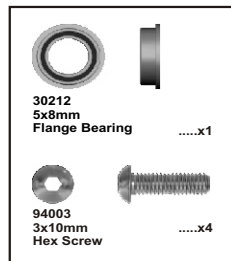

Step 2

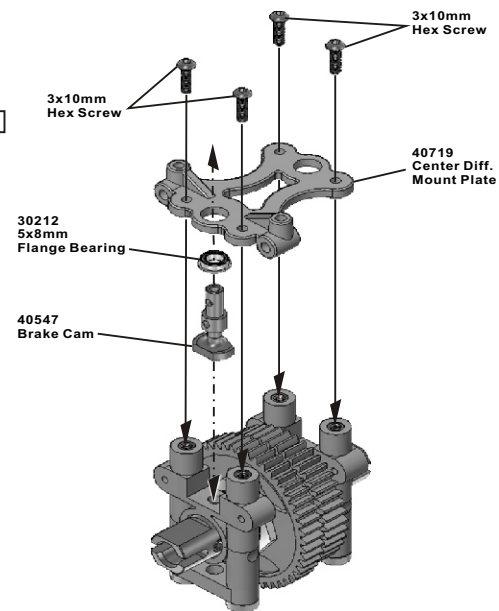

## 20 ASSEMBLY OF THE BRAKE AND CENTER DIFF. MOUNT



NO.7

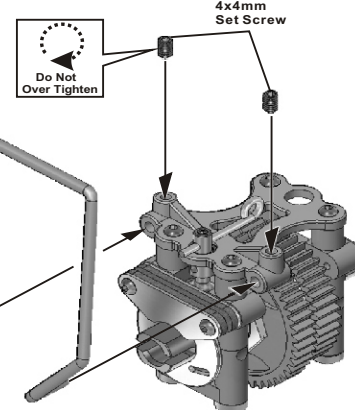
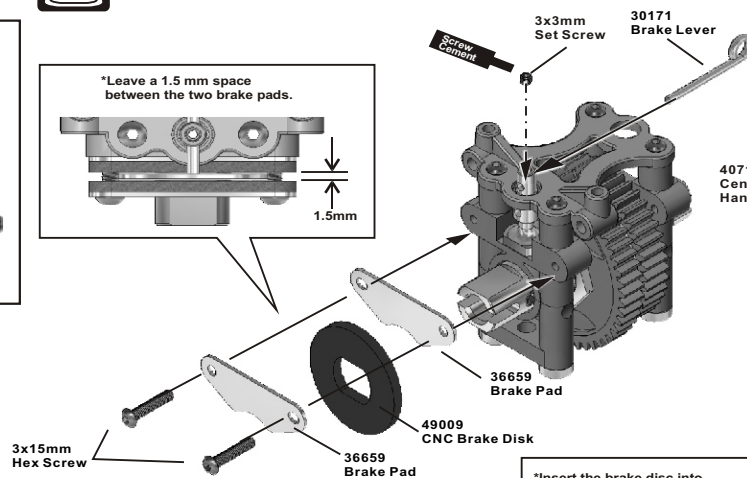
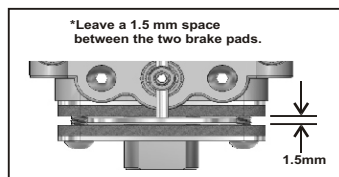
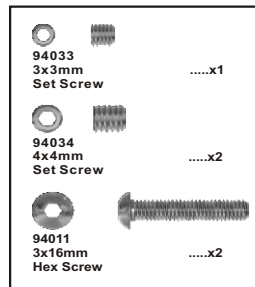



## 21 ASSEMBLY OF THE ARM HOLDER ONTO CHASSIS



NO.4  
NO.5

94027  
4x16mm  
Flat Head  
Hex Screw  
.....x8

\*set the arm holder adjuster to the same direction.



\*set the arm holder adjuster to the same direction.

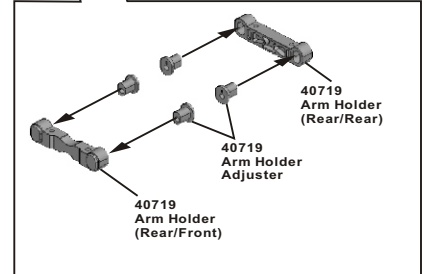
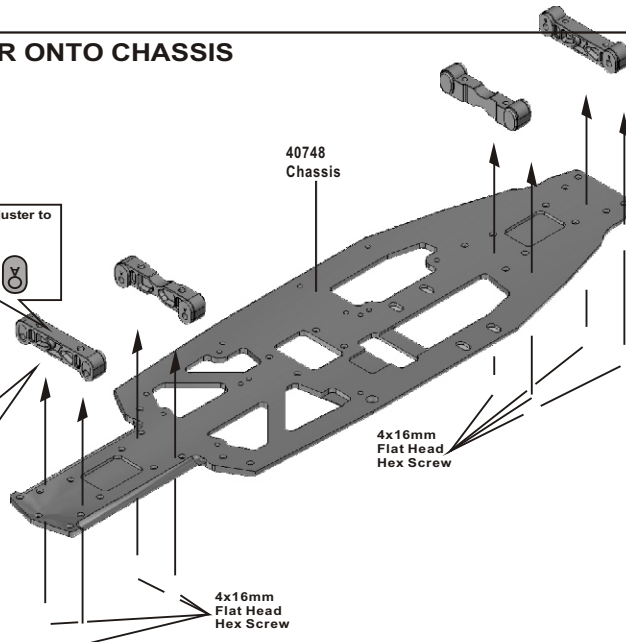
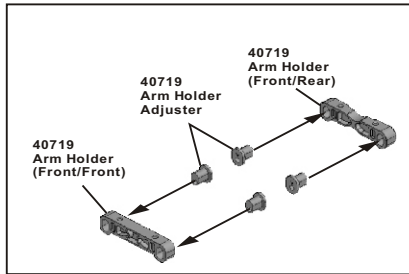

## 22 ASSEMBLY OF THE FRONT LOWER ARMS

8



NO.6

Step 1

94035  
3x8mm  
Set Screw  
.....x2

36870  
4x10mm  
Set Screw  
.....x2

94005  
3x16mm  
Hex Screw  
.....x2

94006  
3x18mm  
Hex Screw  
.....x4

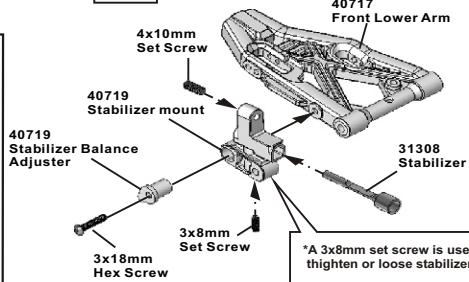

\*A 3x8mm set screw is use for tighten or loose stabilizer.

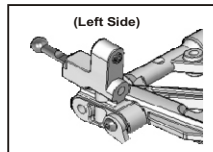
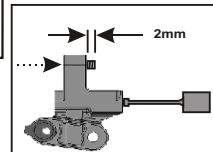

Step 2

Assembly of the right and left hand side are the same.

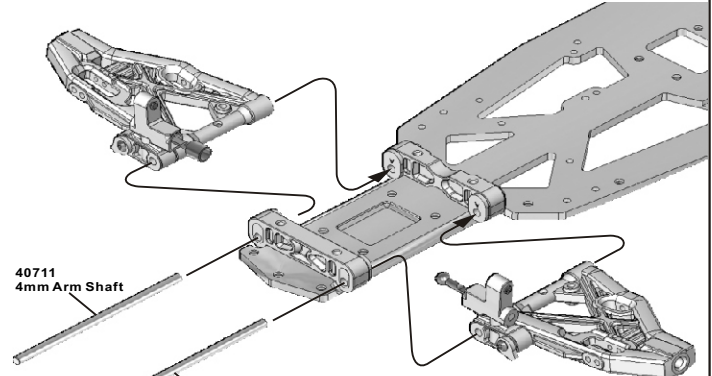

\*Keep stabilizer ball in the center. Turn stabilizer adjuster to adjust the stabilizer to the same angle.

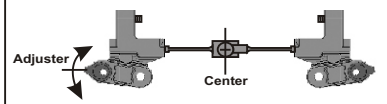

## 23 ASSEMBLY OF THE REAR LOWER ARMS



NO.6

Step 1

94035  
3x8mm  
Set Screw  
.....x2

36870  
4x10mm  
Set Screw  
.....x2

94005  
3x15mm  
Hex Screw  
.....x2

94006  
3x18mm  
Hex Screw  
.....x4

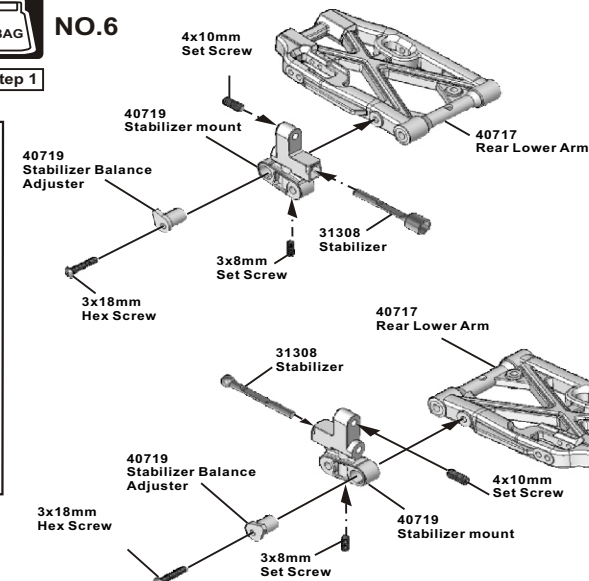

Step 2

Assembly of the right and left hand side are the same.

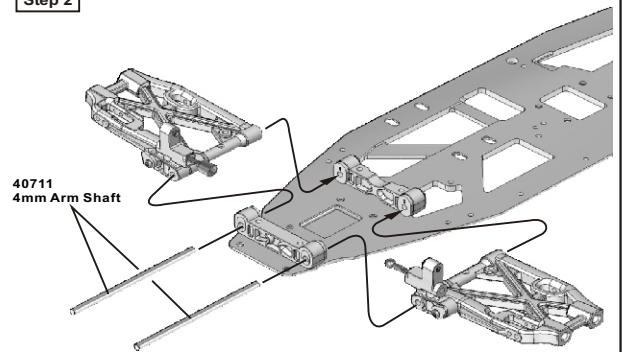

\*Keep stabilizer ball in the center. Turn stabilizer adjuster to adjust the stabilizer to the same angle.

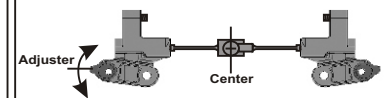
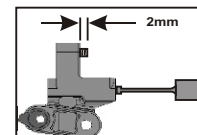

## 24 ASSEMBLY OF THE FRONT AND REAR GEAR BOX ONTO THE CHASSIS

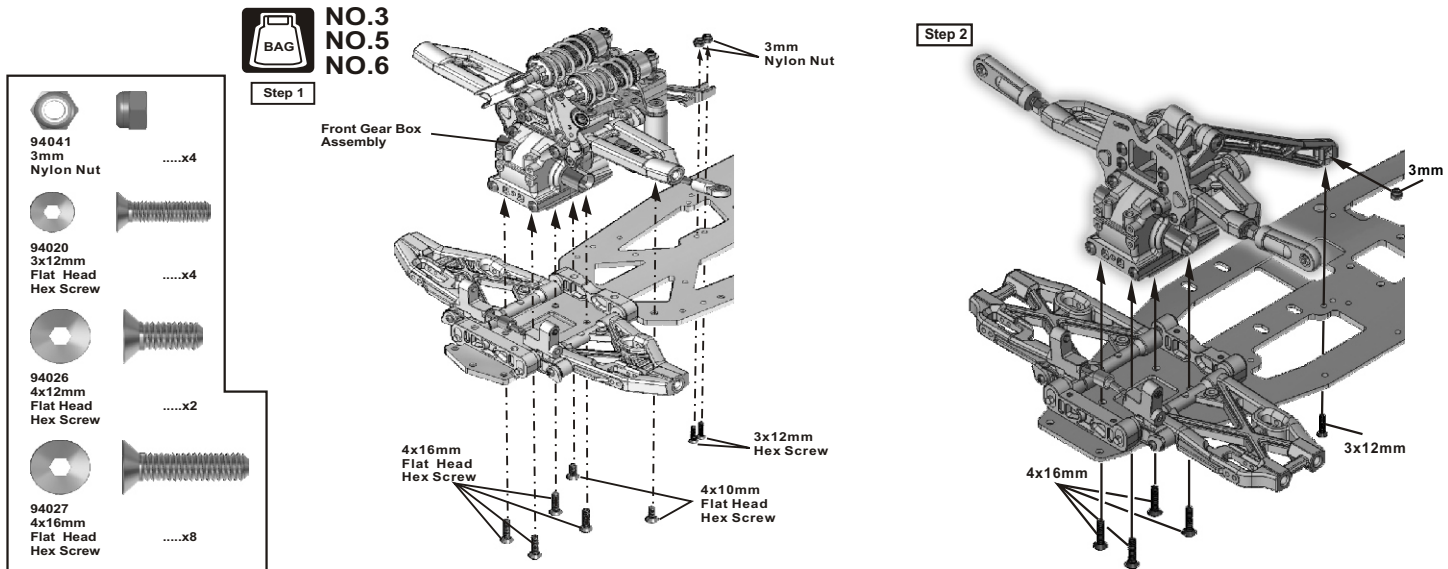

## 25 ASSEMBLY OF THE FRONT KNUCKLE ARMS

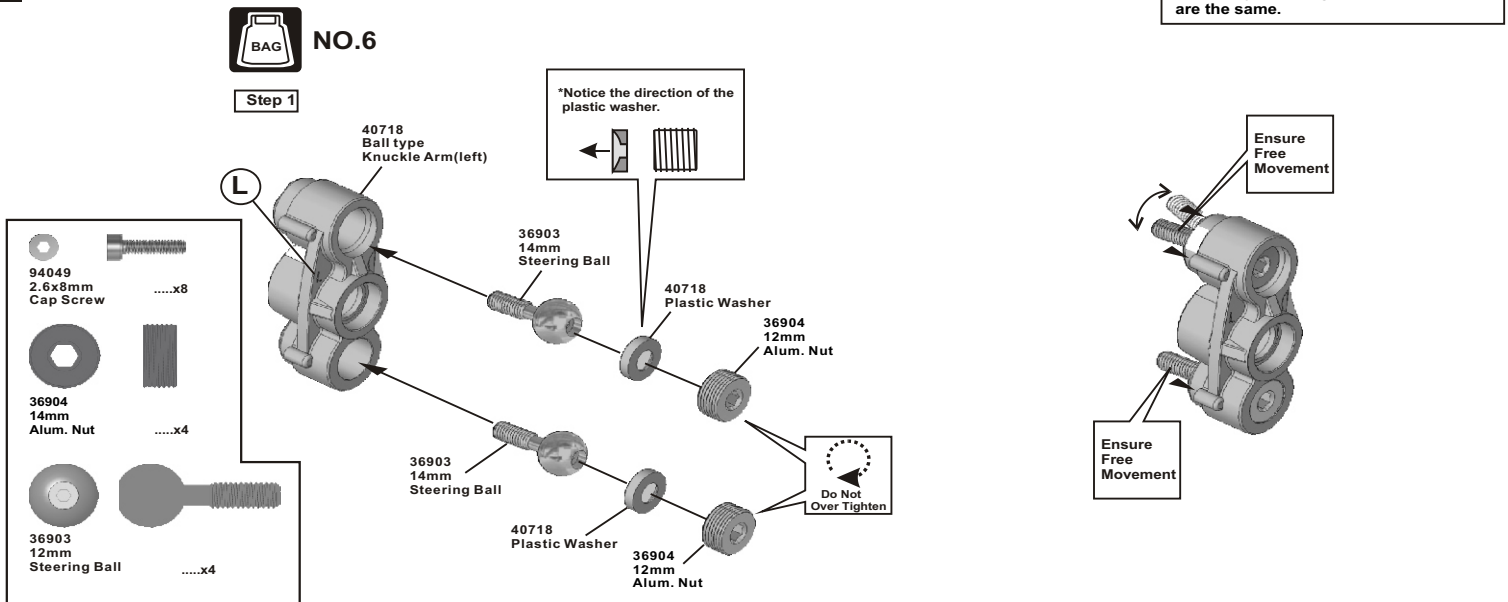

## 26 ASSEMBLY OF THE FRONT KNUCKLE AND FRONT SUSPENSION ARMS

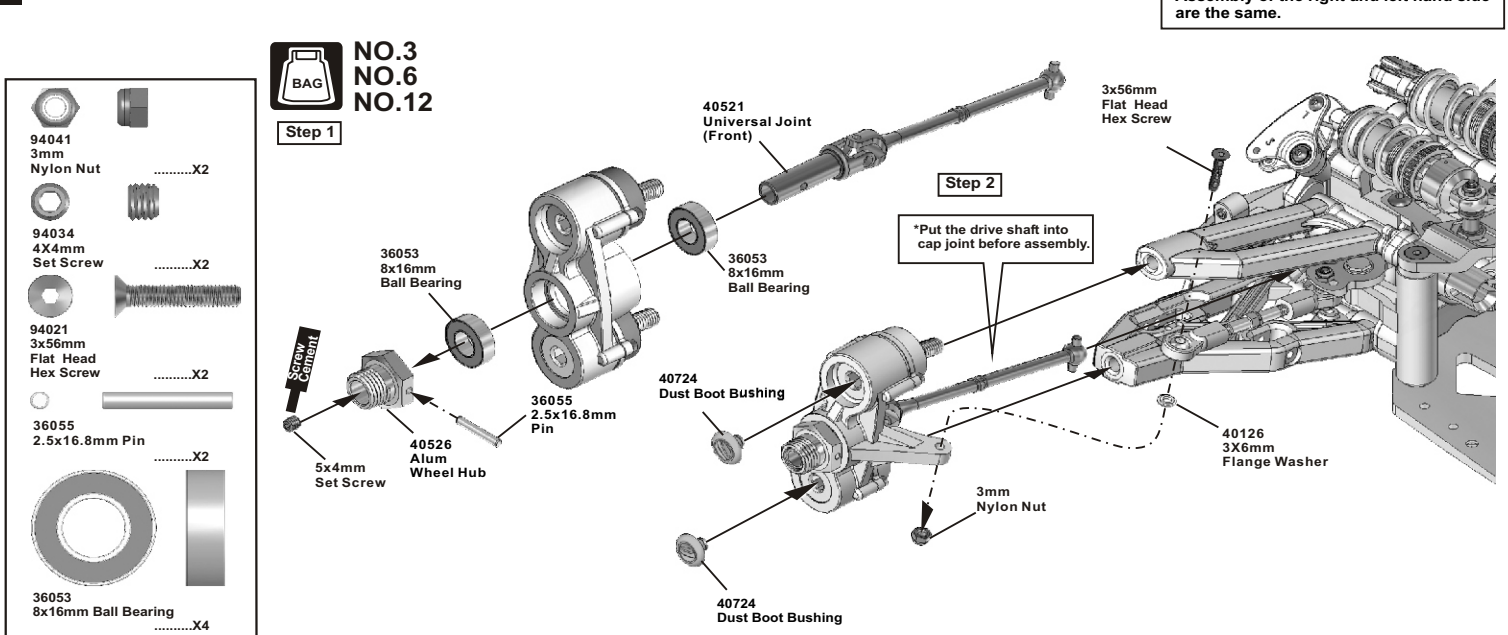

## 27 ASSEMBLY OF THE FRONT PUSH RODS

Assembly for both right and left side.

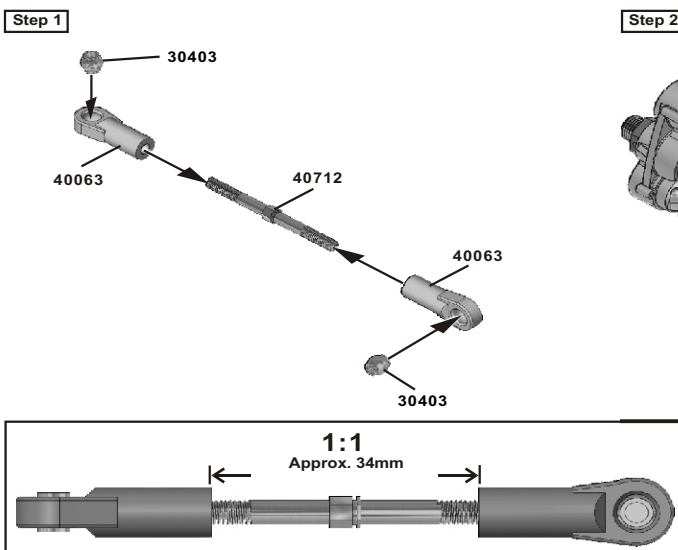
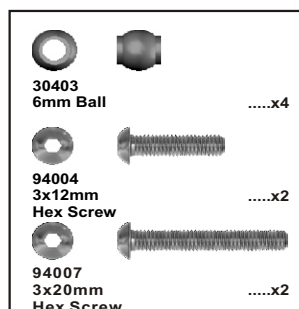

## 28 ASSEMBLY OF THE REAR WHEEL HUB

Assembly for both right and left side.

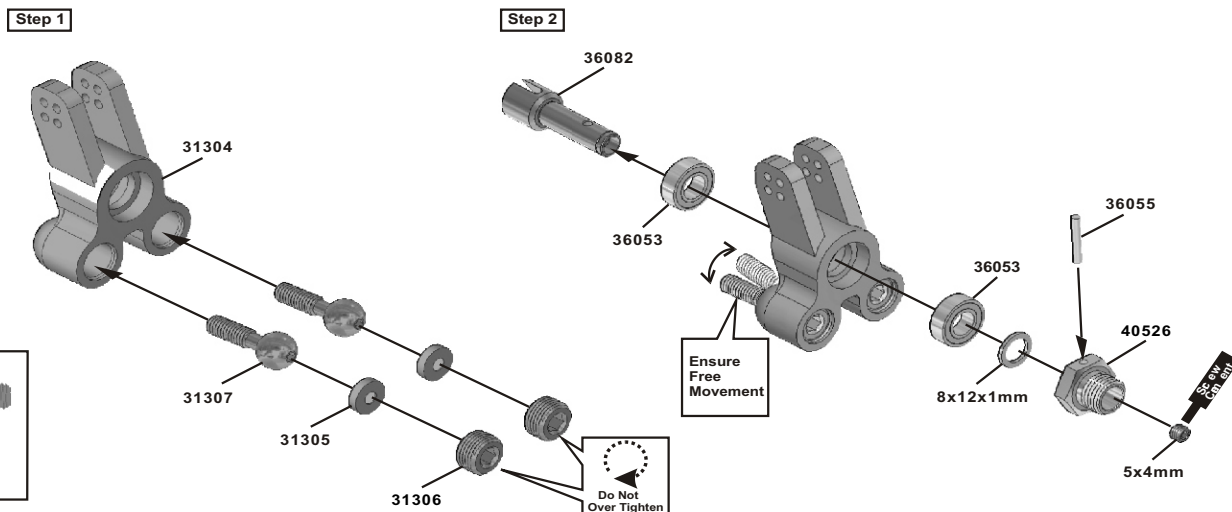
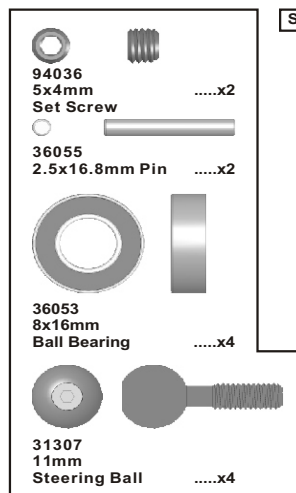

## 29 ASSEMBLY OF THE REAR SUSPENSION ARMS

Assembly for both right and left side.

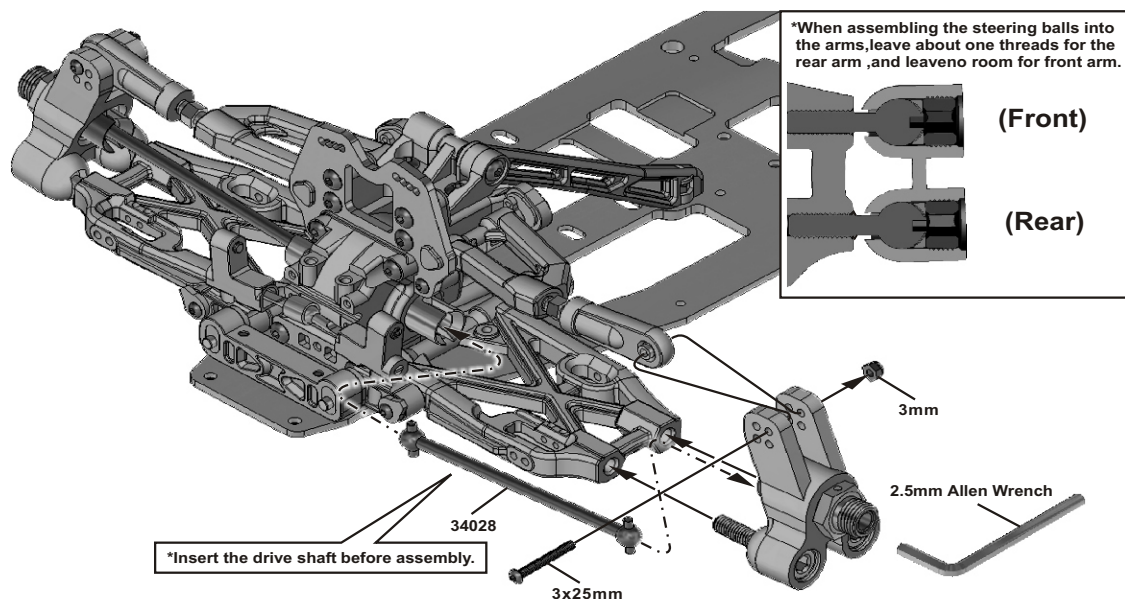
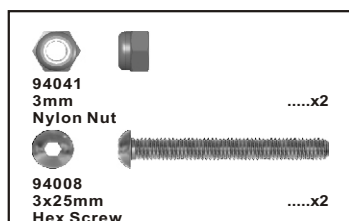



### 30 ASSEMBLY OF THE REAR SHOCK ABSORBER

Assembly for both right and left side.

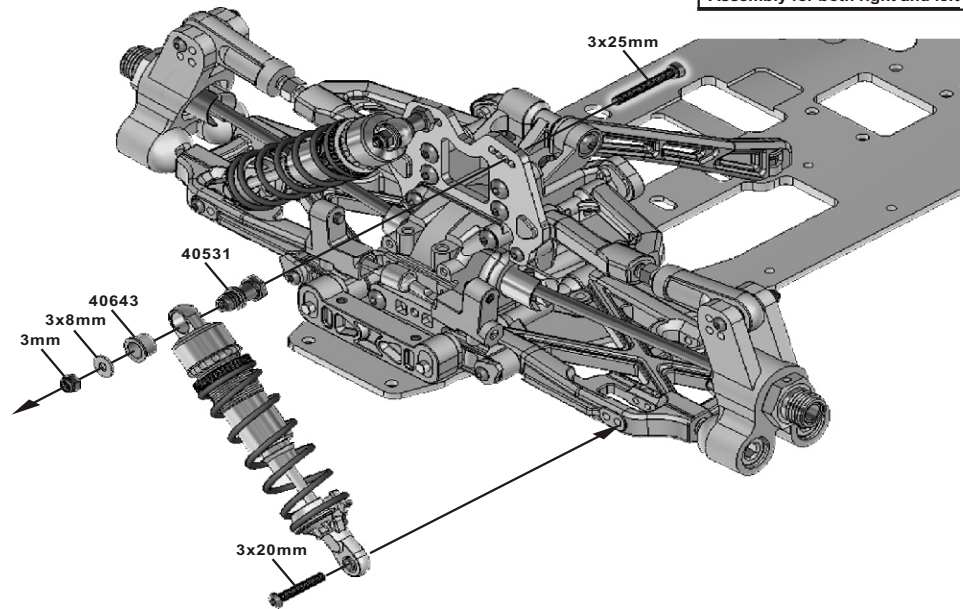
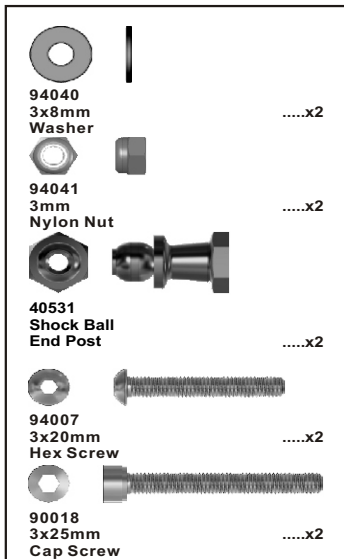

### 31 ASSEMBLY OF THE TWO SPEED TRANSMISSION ONTO THE CHASSIS

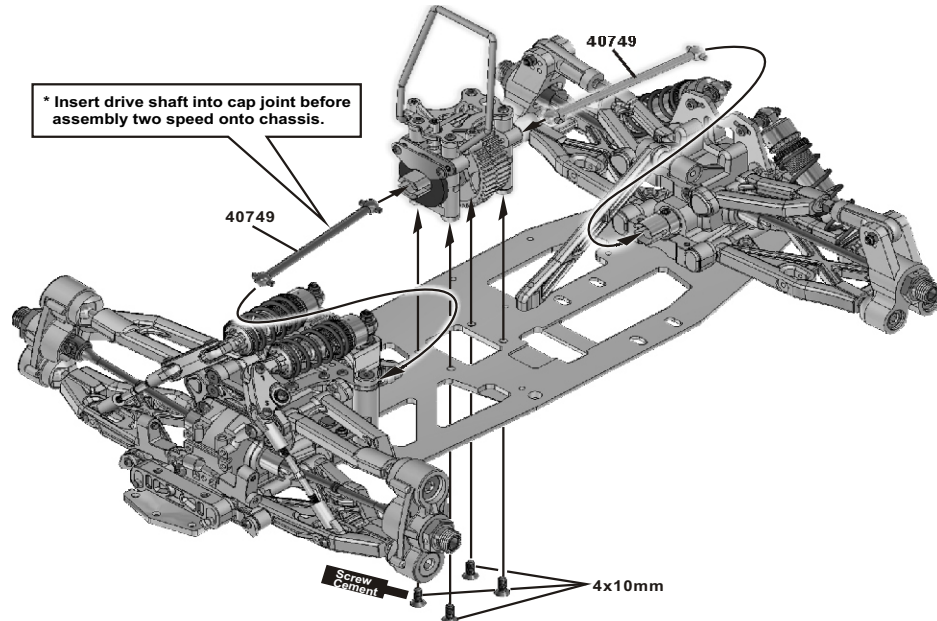
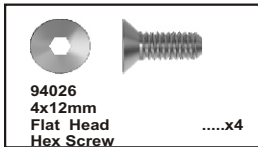

### 32 ASSEMBLY OF THE CLUTCH



NO.10

Step 1

Step 2

\* Only use the 10091 pilot shaft for threaded crank shaft engine.

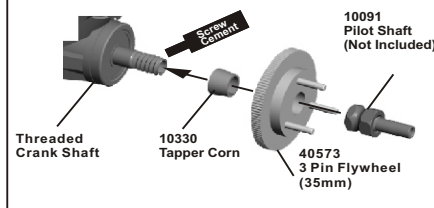

40573 3 Pin Flywheel (35mm)

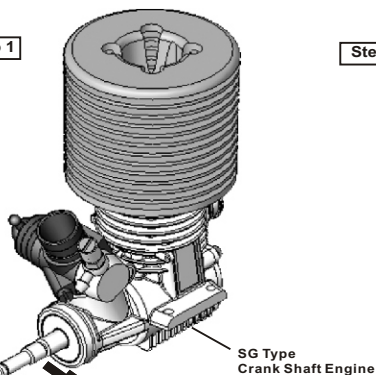

\* Fit the flywheel using a pair of the plier and cross wrench.

\* Place the clutch shoes with the clutch springs over the 3 pins of the flywheel.  
\* Using a phillips screw driver or needle nose pliers and bend the small end if the clutch spring behind the pilot shaft #174D or #180D than press down.

10101 Clutch Spring

10010 Clutch Shoes

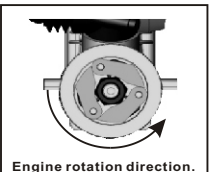



### 33 ASSEMBLY OF THE CLUTCH

**BAG NO.10**

- 10099 3x7mm Washer .....x1
- 10099 5x8x0.3mm Washer .....x3
- 35958 5x8mm Ball Bearing .....x1
- 34110 5x10x4mm Ball Bearing .....x1
- 10099 3x5mm Cap Screw .....x1

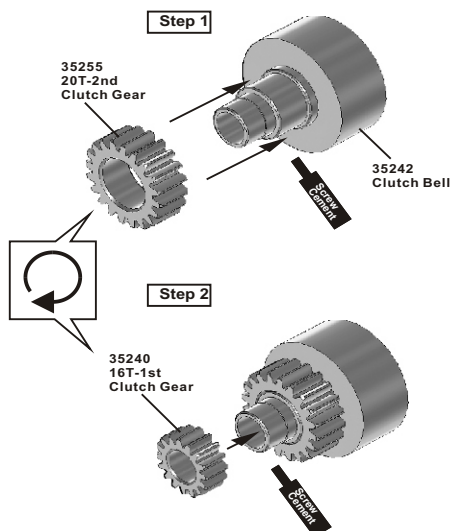

### 34 ASSEMBLY OF THE MANIFOLD AND MUFFLER

**BAG NO.10**

- 94038 3x12mm Cap Screw .....x4

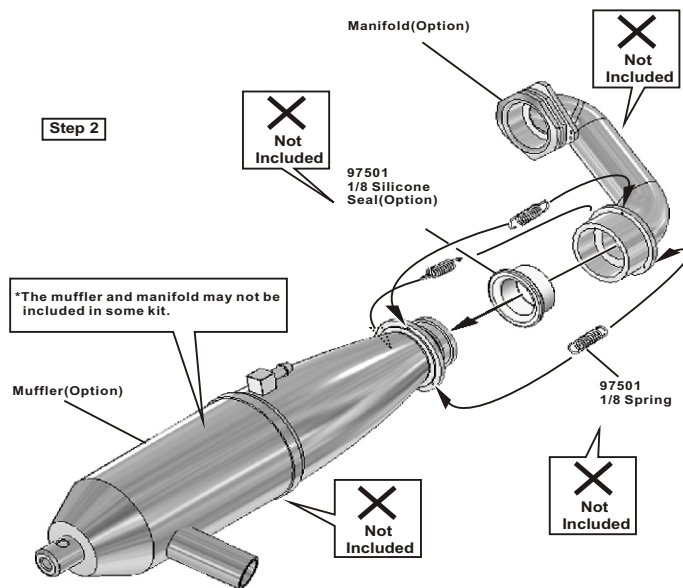
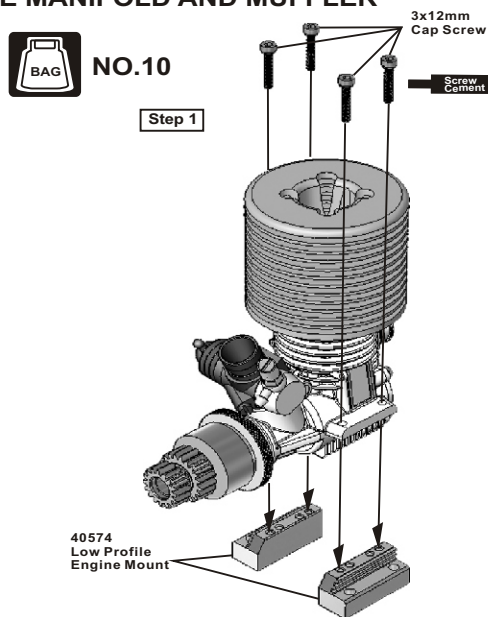

### 35 ASSEMBLY OF THE ENGINE ONTO THE CHASSIS

- 94038 3x12mm Cap Screw .....x4
- 10114 5mm Engine Mount Screw .....x4

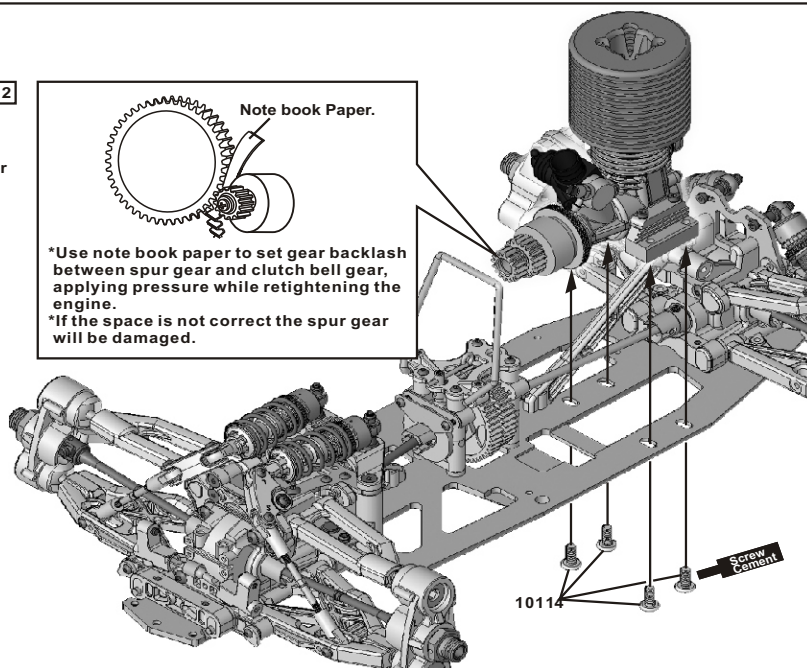
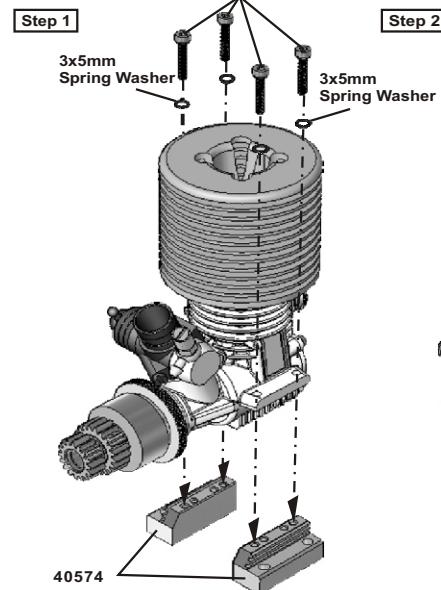

### 37 ASSEMBLY OF THE MANIFOLD ONTO THE ENGINE

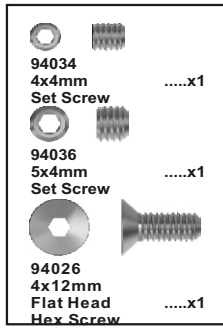

Step 1

\*The muffler and manifold may not included from different kit.

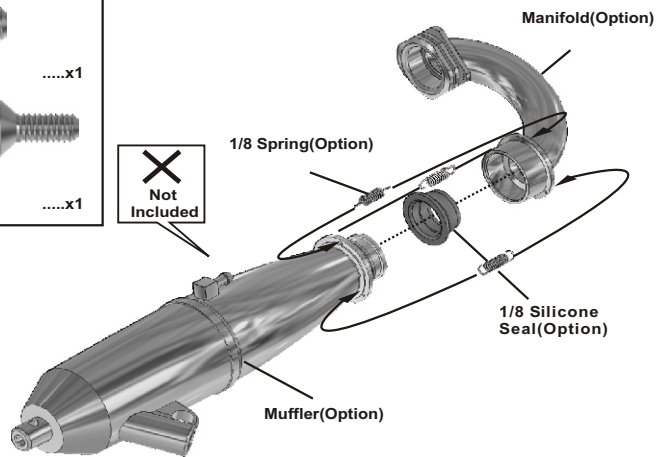

Step 2

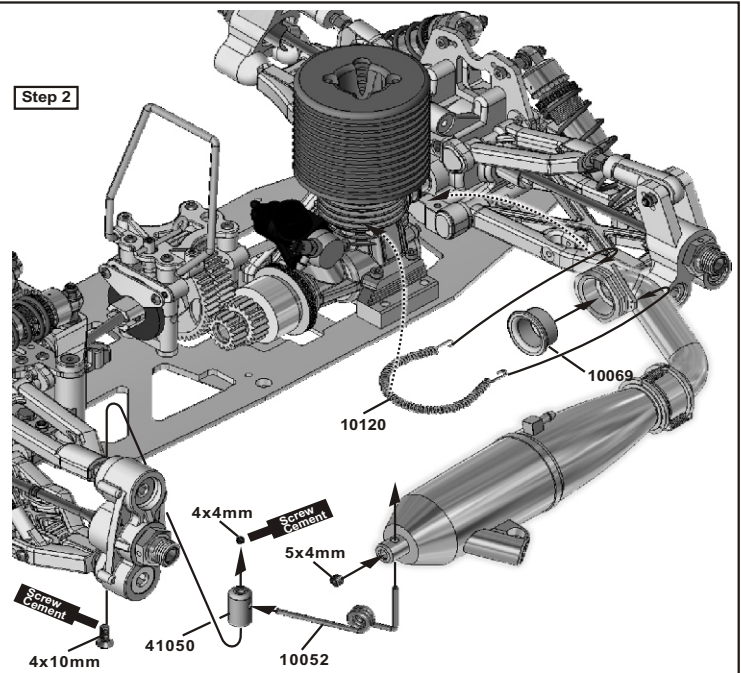

### 39 ASSEMBLY OF THE FUEL TANK ONTO THE CHASSIS <sup>12</sup>



NO.3  
NO.11

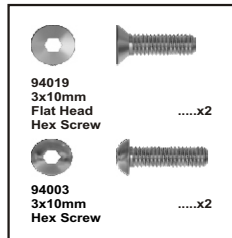

Step 1

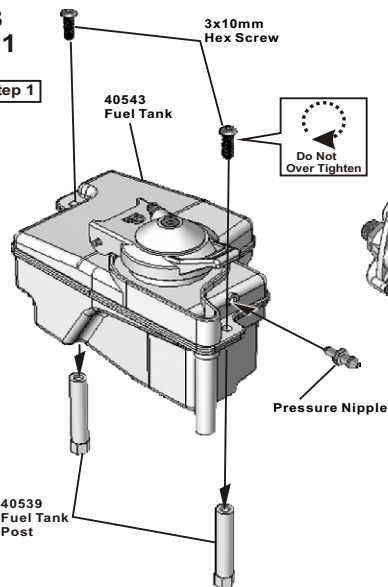

Step 2

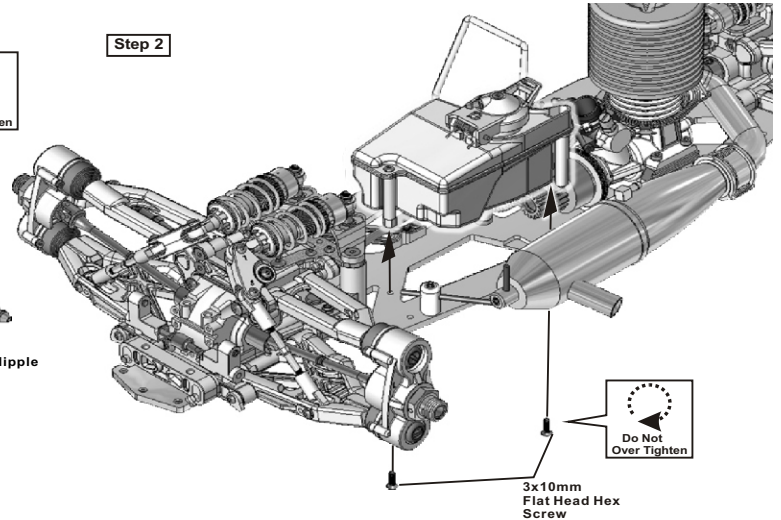

### 40 ASSEMBLY OF THE RADIO TRAY



NO.9

Step 1

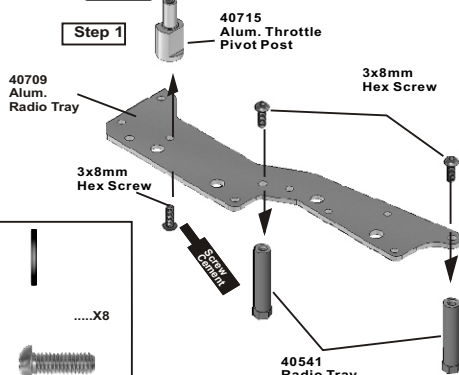

Step 2

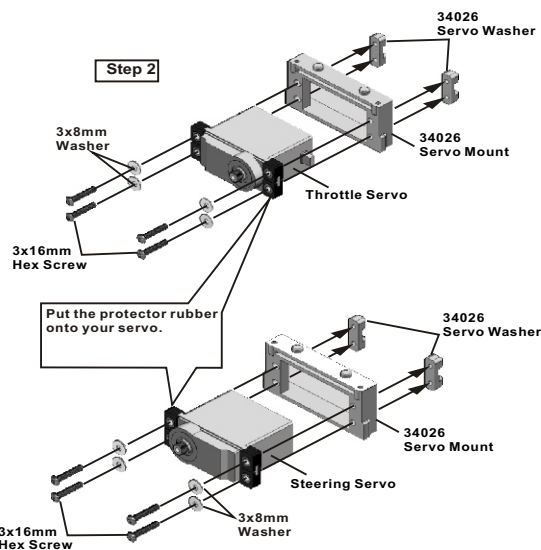

Step 3

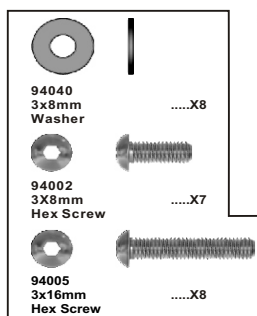
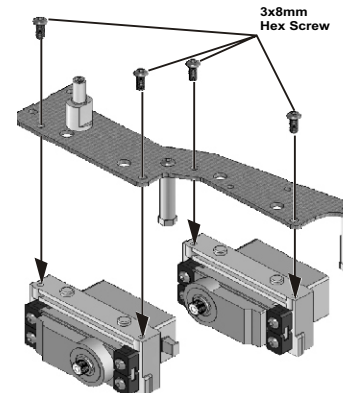

## 41 ASSEMBLY OF THE RADIO TRAY AND RECEIVER BOX



NO.9

Step 1

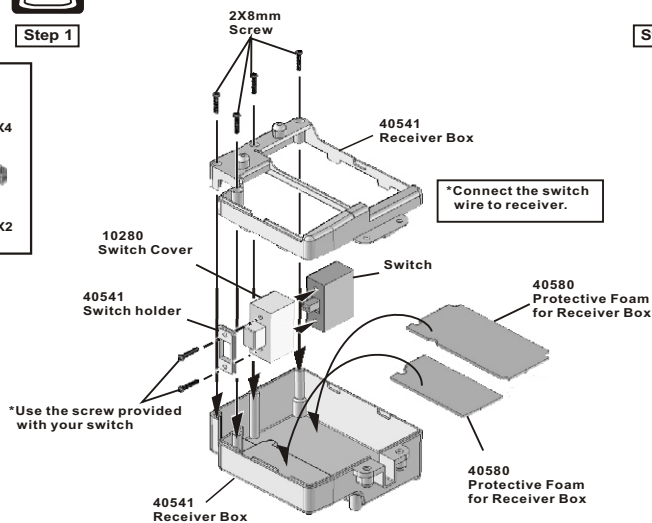
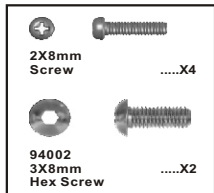

Step 2

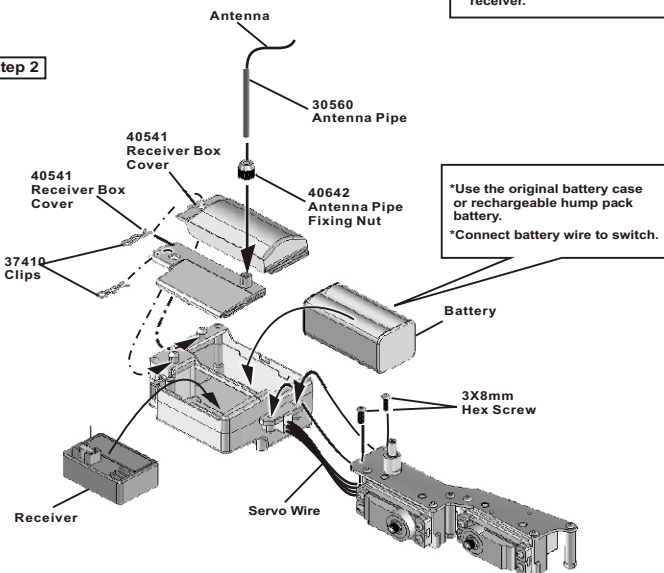

## 42 ASSEMBLY OF THE THROTTLE LINKAGE



NO.9

Step 1

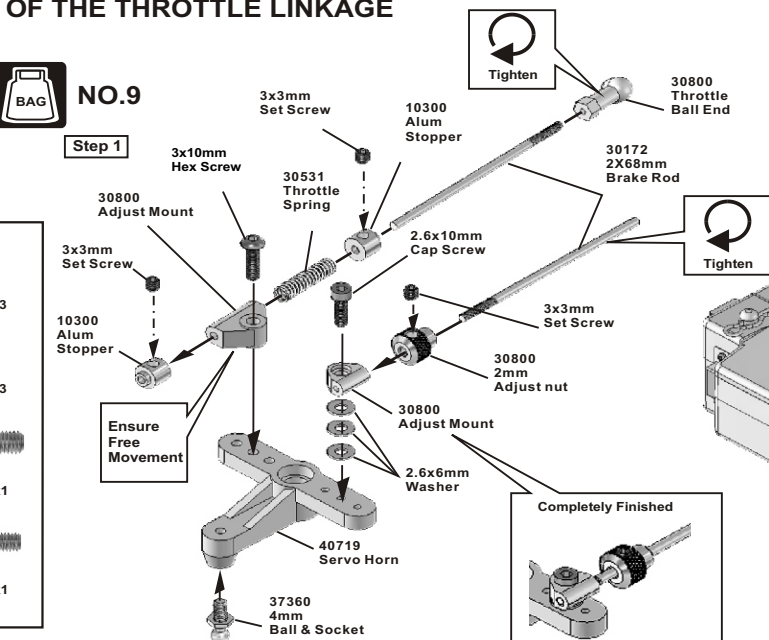
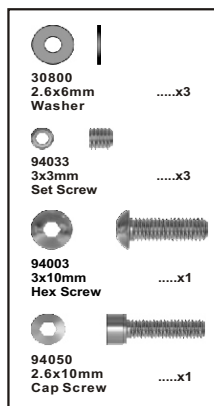

Step 2

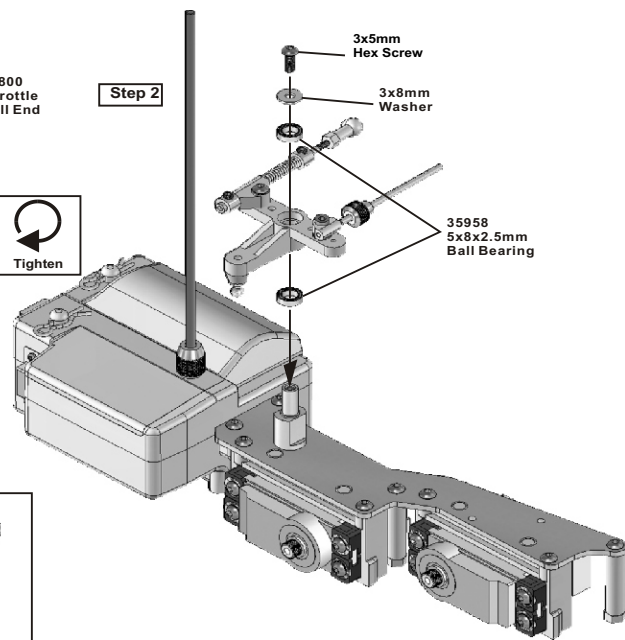

## 43 ASSEMBLY OF THE THROTTLE LINKAGE INTO SERVO



NO.9

Cut off the servo saver as shown.

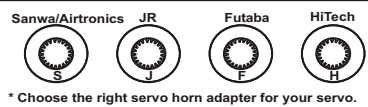
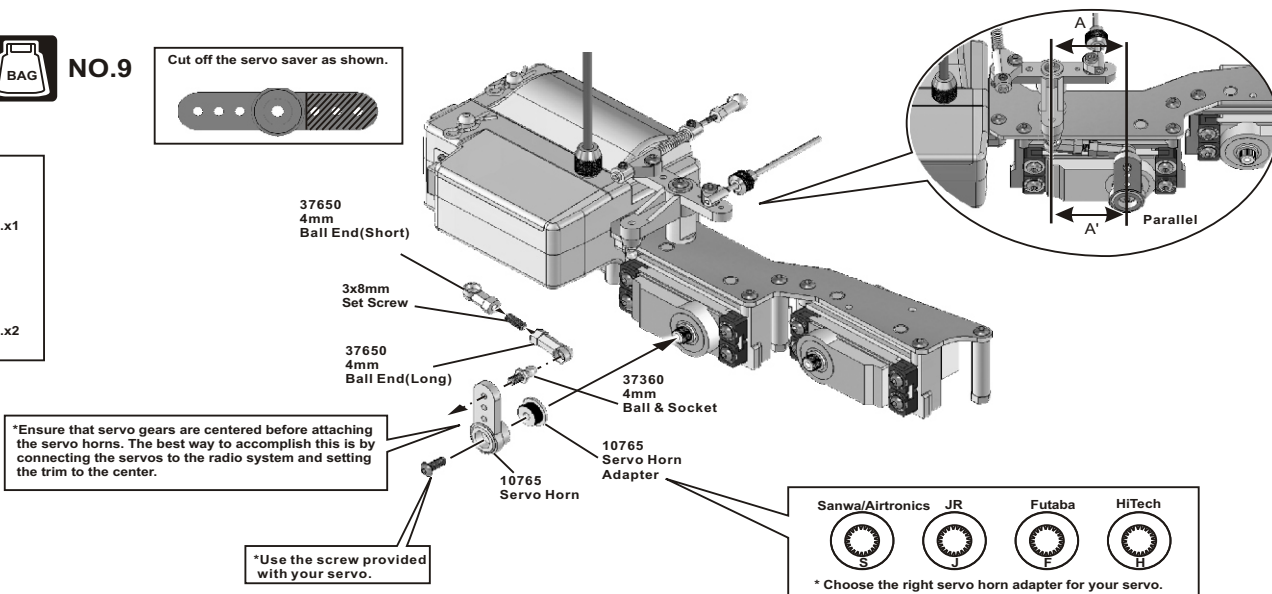
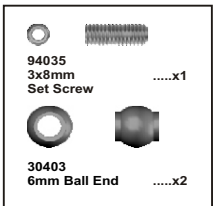
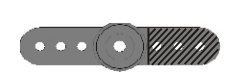



## 44 ASSEMBLY OF THE STEERING ROD AND RADIO TRAY ONTO THE CHASSIS



NO.9

Step 1

Step 2



30403 6mm Ball End .....x1

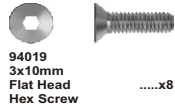

94019 3x10mm Flat Head Hex Screw .....x8



94004 3x12mm Hex Screw .....x1



30401 Plastic Ball End .....x2

\*Use the screw provided with your servo.

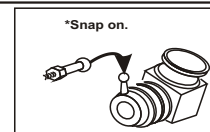
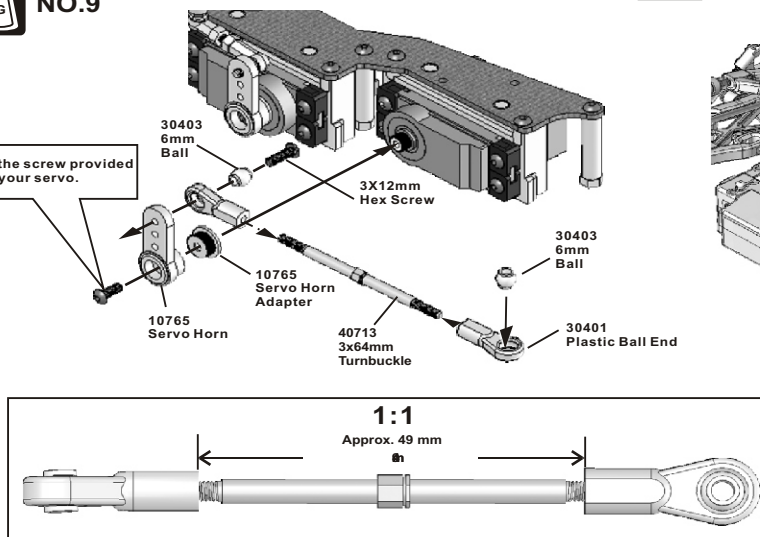

\*Snap on.

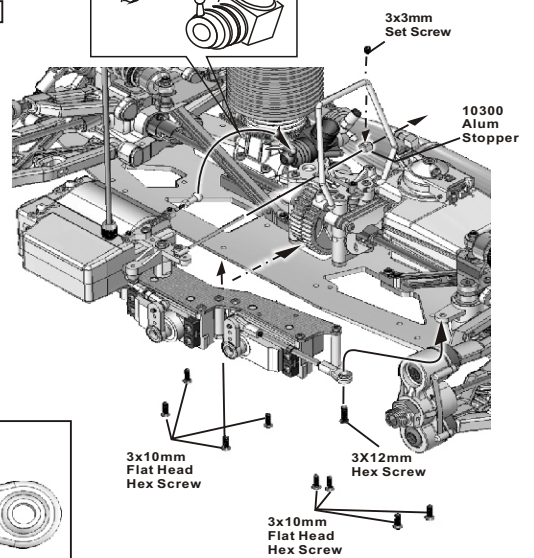

## 45 ASSEMBLY OF THE FRONT BUMPER



NO.8

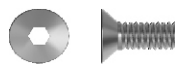

94026 4x12mm Flat Head Hex Screw .....x3

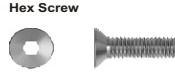

94020 3x12mm Flat Head Hex Screw .....x2



94042 4mm Nylon Nut .....x3

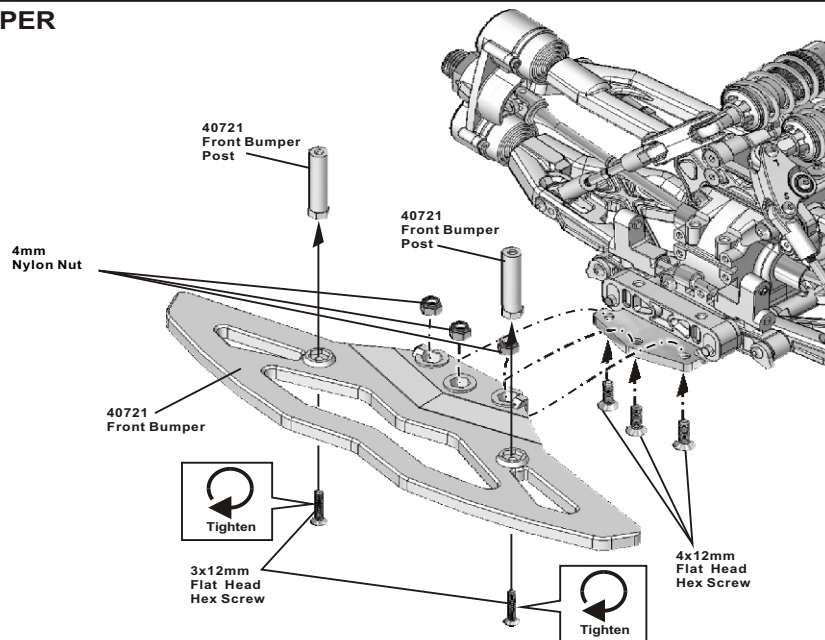

## 46 ASSEMBLY OF THE FRONT BUMPER



NO.8

Step 1

Step 2

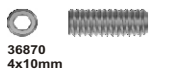

36870 4x10mm Set Screw .....x2



94026 4x12mm Flat Head Hex Screw .....x2

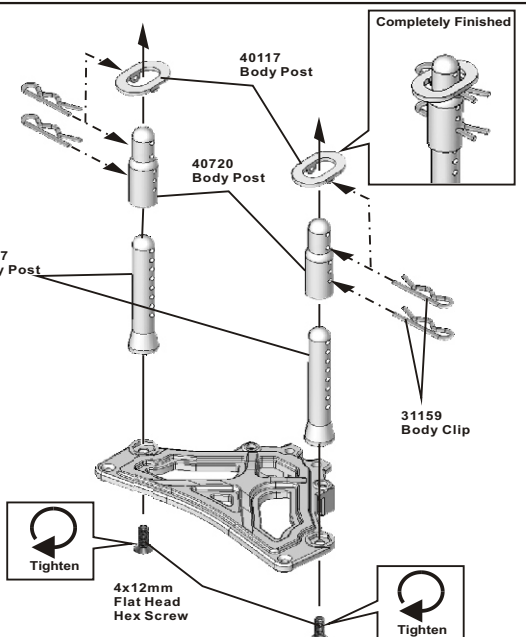
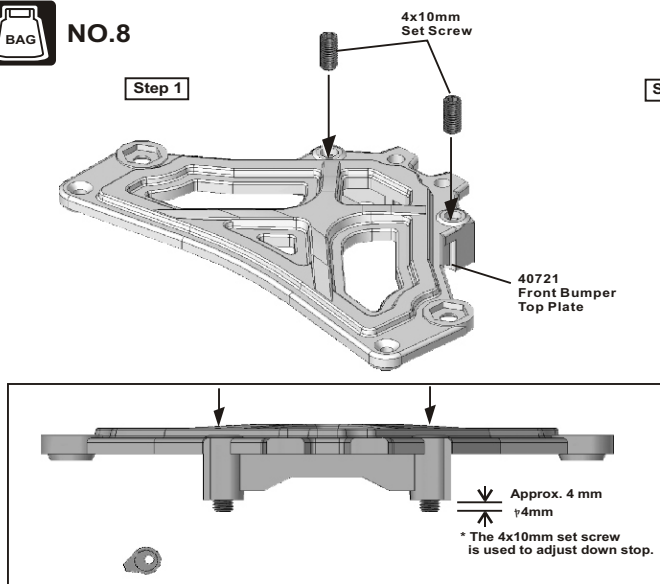



## 47 ASSEMBLY OF THE FRONT AND REAR BUMPER



NO.8

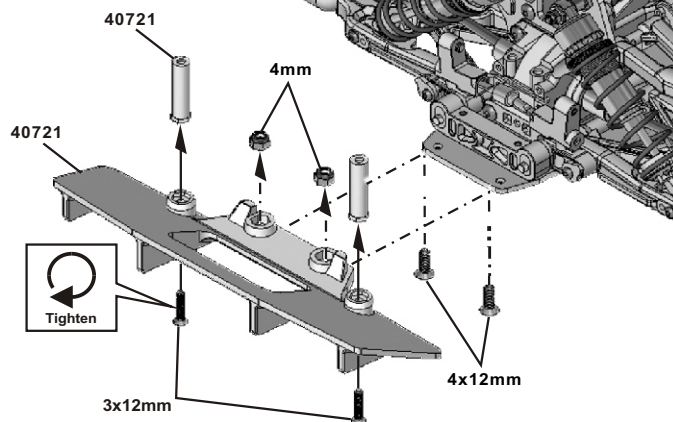
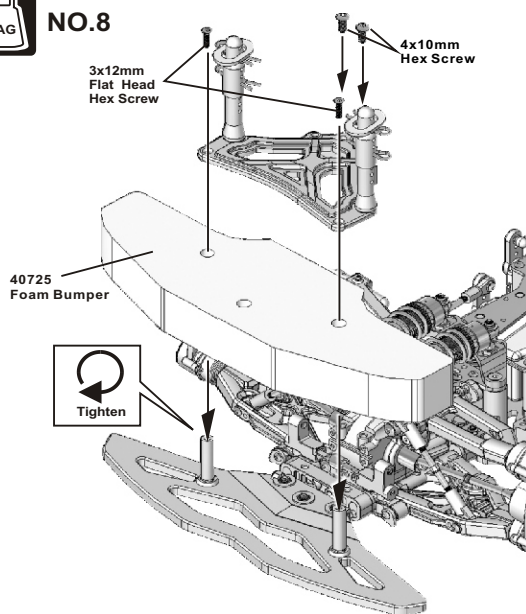
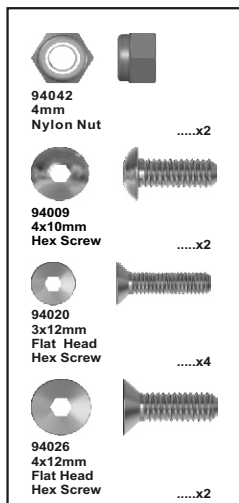

## 48 ASSEMBLY OF THE BODY AND PAINTING.

- ① Cut out the body as shown.

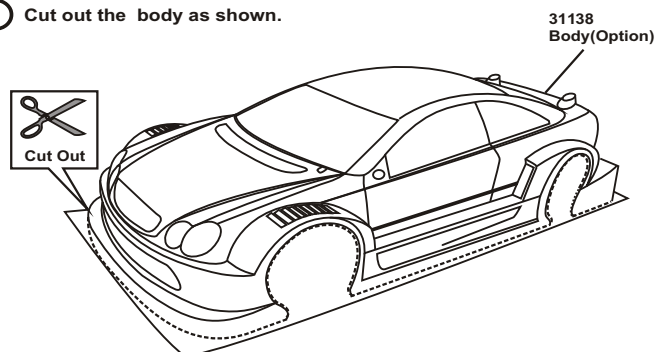

- ② Before cutting and making holes on the body, put the unpainted body on the chassis to confirm the mounting position and location for holes and cutouts.

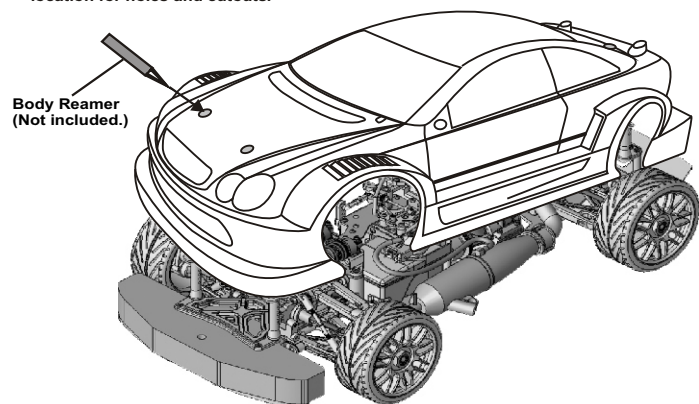

- ③ Making two holes on the front and two holes on the rear for body posts.

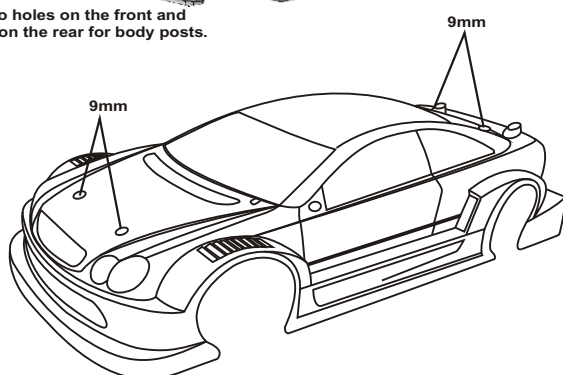

- ④ Use a neutral detergent to remove any dirt and oil.

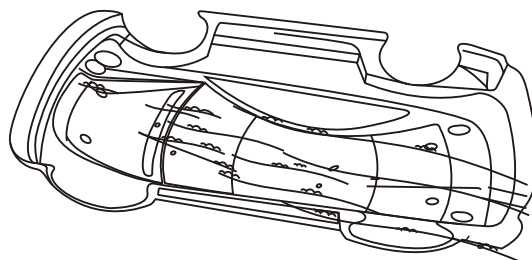

- ⑤ Mask the windows from the inside with masking tape.

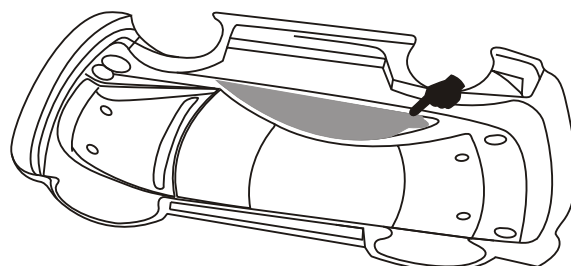

- ⑥ Paint the body with polycarbonate spray paints.

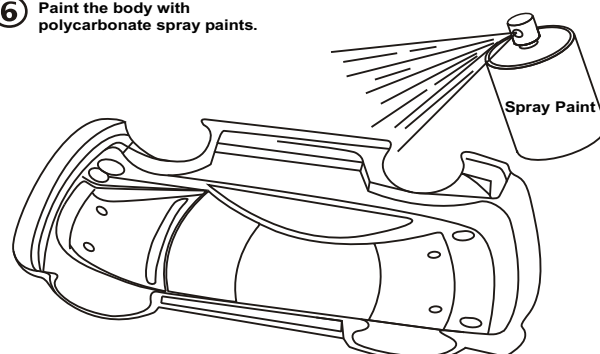

## 49 ASSEMBLY OF THE ONTO FRONT KNUCKLE AND REAR HUB

Step 1

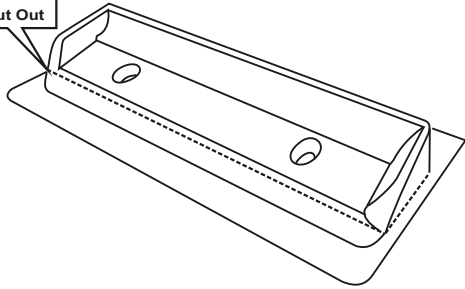

Step 2

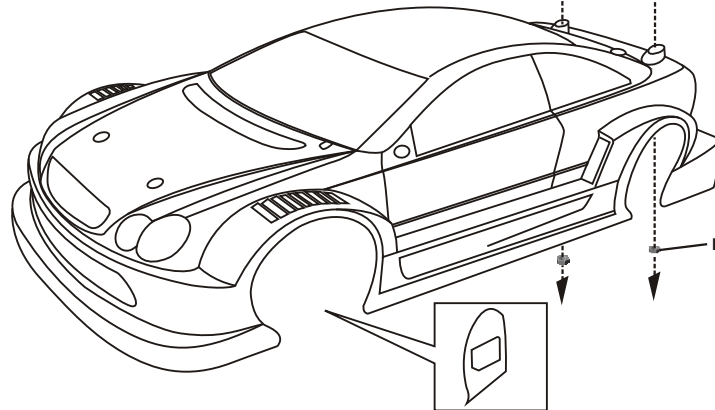

Take off the doubleside paper before assembly.

Side Plate

Doubleside Tape

Nylon Screw



Doubleside Tape

Side Plate

Nylon Nut

## 50 ASSEMBLY OF THE AIR FILTER



NO.11

\*Apply filter oil to the foam before use.

38400 Air Filter

Nylon Strap

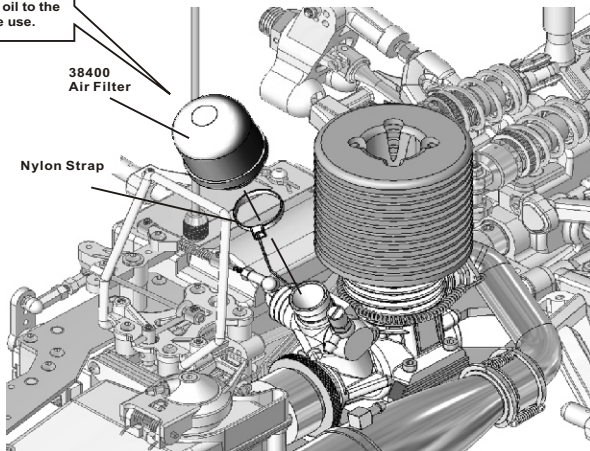

\*Notice the direction and make two left and right hand side tires are the same.  
\*Check the rotation direction before gluing.

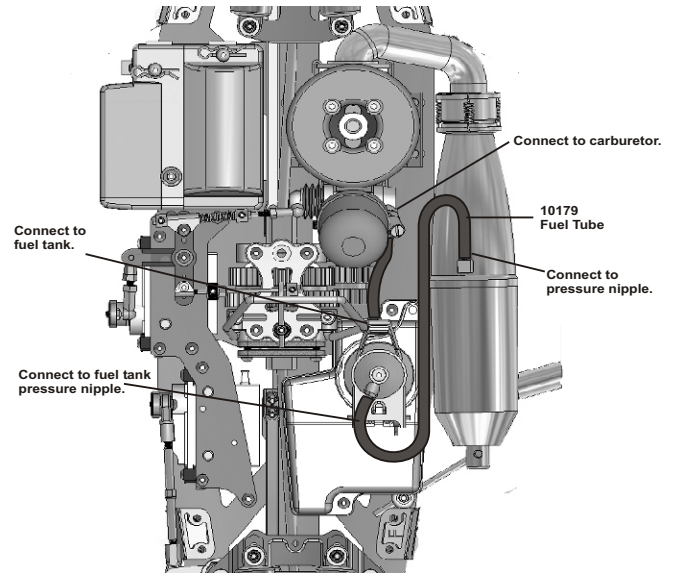

Connect to fuel tank.

Connect to fuel tank pressure nipple.

Connect to carburetor.

10179 Fuel Tube

Connect to pressure nipple.

## 51 ASSEMBLY OF THE TIRES AND WHEELS

(Left Hand Side)

\*Notice the direction of the tires.

86052 Tire



86059 Inner Sponge (Wide)

86059 Inner Sponge (Narrow)

86023 Wheel

\*Notice the direction of the tires. Make two the same for the left and 2 for the right.  
Check the rotation direction before gluing.

(Right Hand Side)

\*Notice the direction of the tires.



\*Pull back the tire bead slightly and spot glue in four spots as shown. When dry, glue the rest of the wheel between the spots. Repeat the procedure on the other side of the wheel until fully glued.

INSTANT GLUE

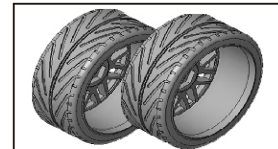
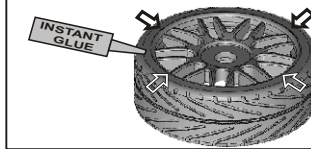
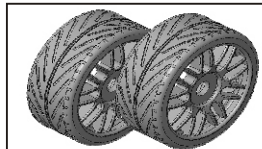

## 52 ASSEMBLY OF THE WHEELS ONTO THE FRONT KNUCKLE AND REAR HUB

Assembly for both right and left side.

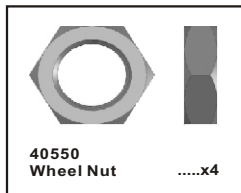

Step 1

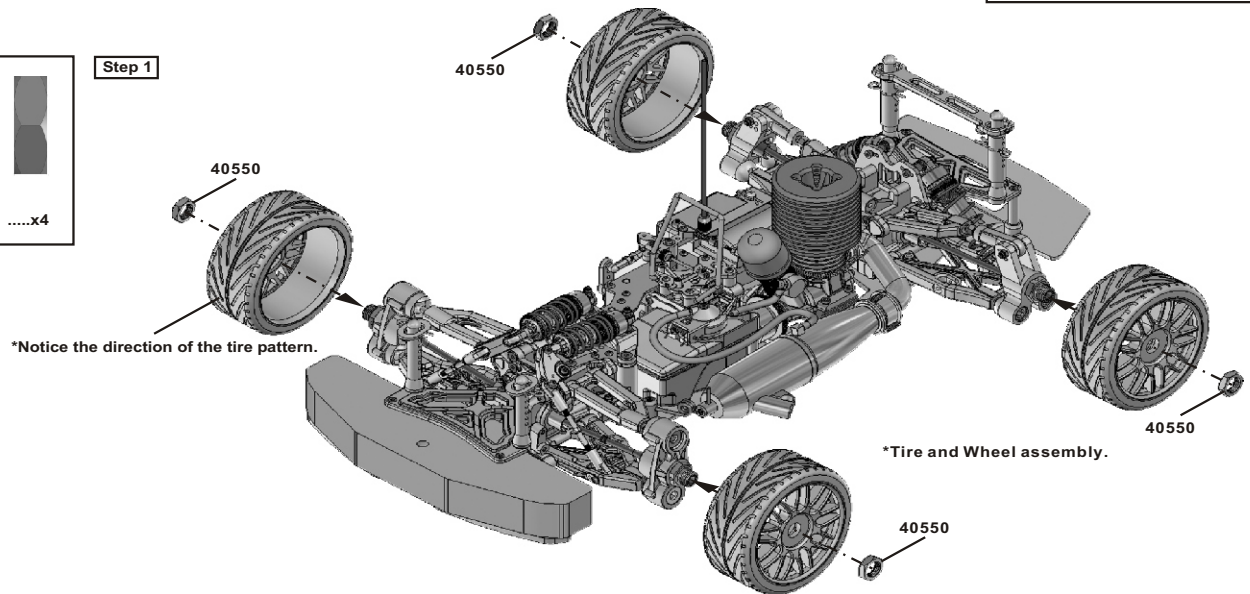

## 53 MOUNTING BODY

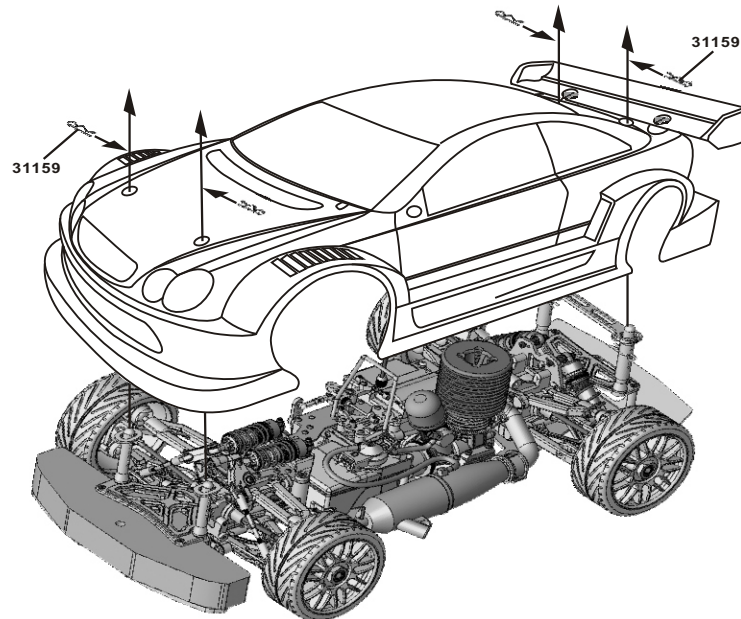



### How to start the engine:

1. Turn on transmitter and then receiver.
2. Fill fuel tank with fuel bottle.
3. Connect 1.2V glow plug igniter .
4. Start engine with a 12V starter .  
( Notice the direction of the starter.)
5. After the engine has started, remove the 1.2V glow plug igniter .

\* Follow the engine manufacturer instruction manuals regarding engine set-up, carburetor and maintenance.

### A 12V Starter Box ( Not Included)



10250 - Starter Box 1/8 scale  
On/Off-Road.

### Glow Plug (Not Included)

51007



Normal Plug

51006



Turbo Plug

\*There are 2 types of glow plugs available "NORMAL" or "Turbo" depending on the type of the engine.

### 1.2V Glow Plug Igniter and Charger (Not Included)

10215 - Glow Heater, Extra Long  
W/Charger.



\*To start the car, attach a glow plug igniter to the glow plug, and use either a 12V electric starter or starter box applied to the flywheel exposed through the chassis.

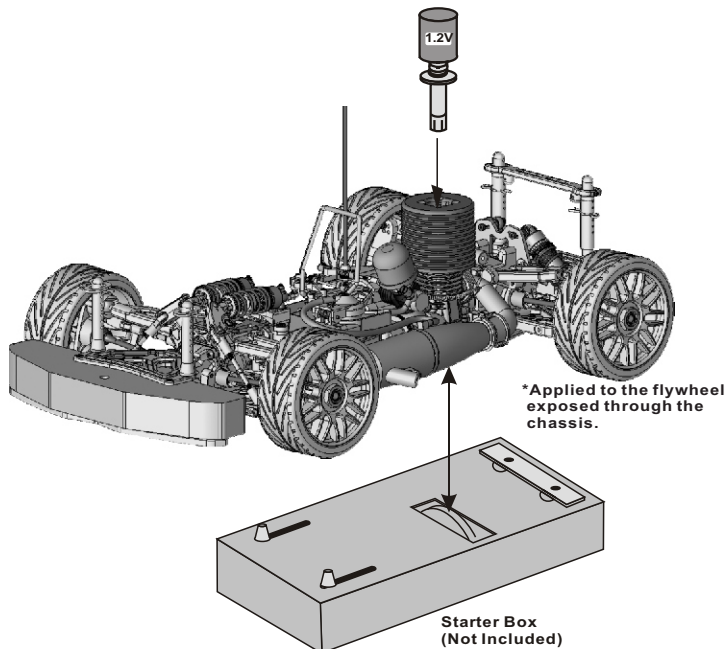
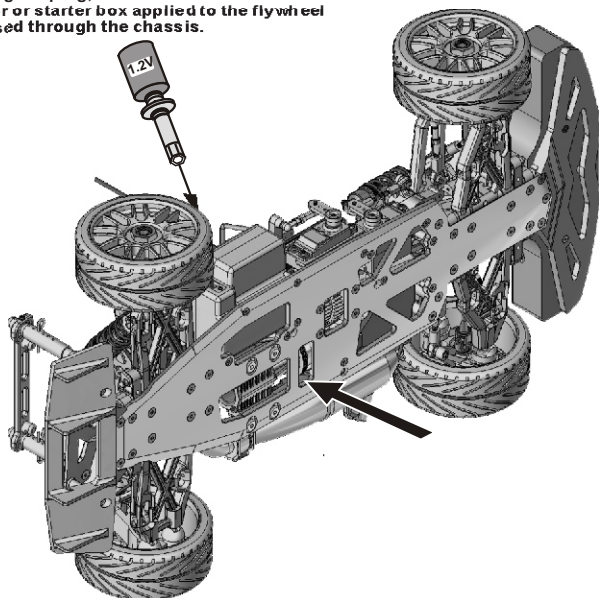

\*Applied to the flywheel  
exposed through the  
chassis.

Starter Box  
(Not Included)

## ADJUSTING THE SHIFT POINT

Adjust the engine before adjusting the clutch shift timing.  
Adjust the engine as per engine instruction manual.

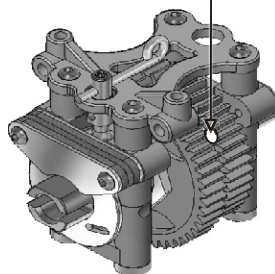
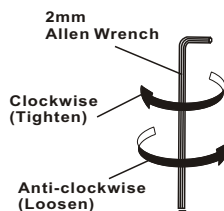
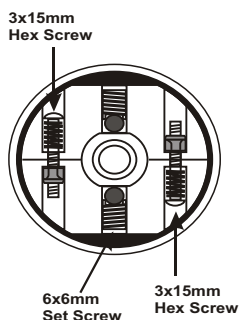

### SHIFT UP TIMING ADJUSTMENT

1. Once the engine adjustments have been completed, proceed to the adjustment of the clutch shoe shift timing.  
(Using a 2mm allen wrench to adjust the clutch shoe on either side.)

Note: Clockwise-----Shift timing will become later.  
Counterclockwise---Shift timing will become quicker.

2. Adjust the clutch shift timing for your track conditions.  
As you tighten (Clockwise) the 3x15mm screw, the shift timing will become slower.  
As you loosen (Counterclockwise ) the 3x15mm screw, the shift timing will become quicker.
3. Set the shift timing to the track conditions while the car is running.

### 2 SPEED GEAR RATION COMBINATIONS

2 speed transmission allows the car to have more punch out of the corners and higher top speed. We offer many different pinion and spur gear combinations which can be used for different tracks.

Spur Gear	Clutch Gear (4 tooth different)			Torque	Speed
	15T-19T	16T-20T	17T-21T		
49T/45T	←		→		
48T/44T					



# SETTING GUIDE

## FRONT TOE-IN AND TOE-OUT SETTING

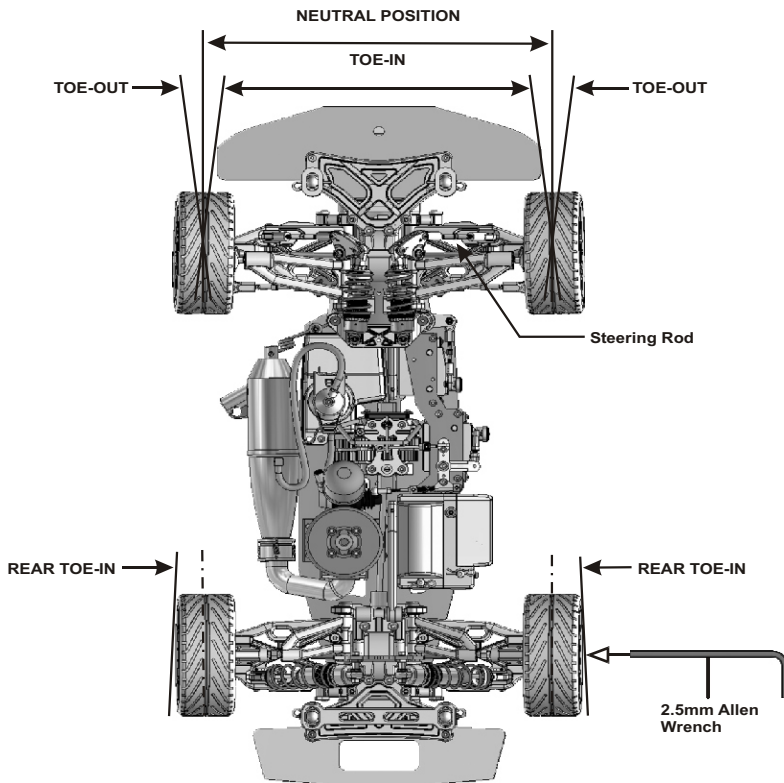

**Use a 2.5mm allen wrench to adjust toe-in for front and rear.**

(Front) Adjust the length of the front steering rod to change the toe angle.

Making the steering rod longer will make the front tires become toe-in.  
Response will be slower and will over steer.

Making the steering rod shorter will make the front tires become toe-out.  
Response will be quicker and will under steer.

**We recommended adjusting the front toe-out to 1.5 degrees.**

(Rear) Adjust the length of the rear hub (12mm ball/rear) to change the toe angle.

Making the 12mm ball longer will make the rear tires toe-in.  
Response will be under steer.

Making the 12mm ball shorter will make the rear tires toe-out.  
Response will be over steer.

**We recommended adjusting the rear toe-in to 2 degrees.**

## FRONT AND REAR CAMBER ANGLE SETTING

Note: Place the model car on a flat surface. Raise the chassis to it's maximum clearance before the wheels leave the ground.  
Adjust the length of the front and rear upper arms so that the wheels are right angles to the ground.

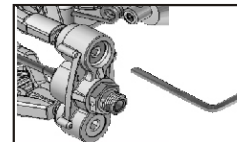

\*Use 2.5mm hex wrench to adjust upper arm ball in front.

(FRONT)

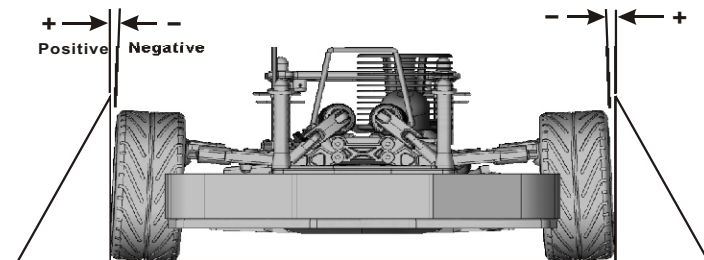

The front camber adjustment can be made by moving the 14mm steering ball at the front upper arms on knuckles, clockwise or anticlockwise.  
**We suggest using 1.5 degree of negative camber for the front.**

(REAR)

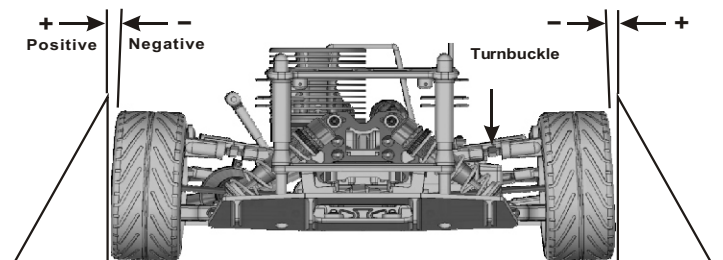

Adjust the length of the turnbuckle on the rear upper arms can be change the rear camber.  
**We suggest using 2 degree of negative camber for the rear.**

## FRONT AND REAR SHOCK ANGLE SETTING

(FRONT)

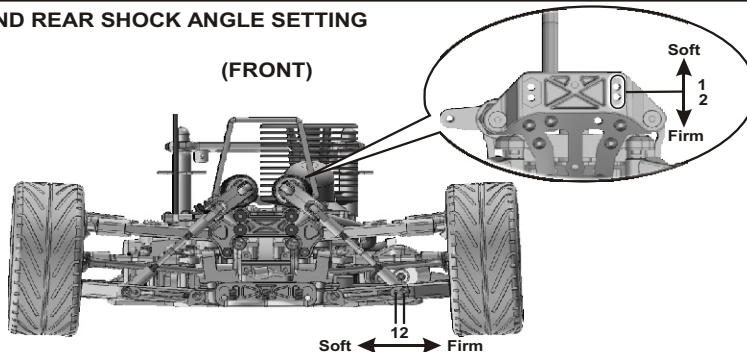

Firm front suspension, less steering.  
Soft front suspension, more steering.

(REAR)

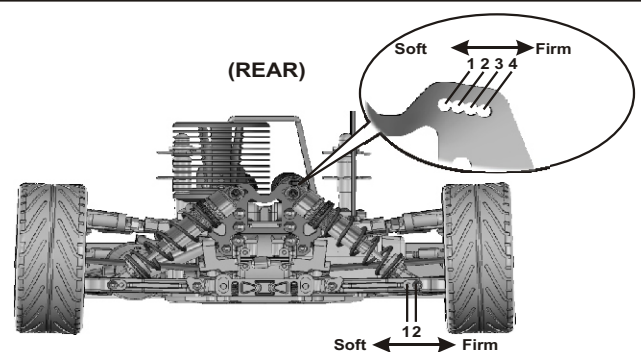

Firm rear suspension, over steering.  
Soft rear suspension, under steering.

# 34303 DMI-SPEC PRO PARTS LIST

OFNA	Description	RETAIL	OFNA	Description	RETAIL
10010	3 Shoe Clutch carbon	13.95	40065	Rear Upper Ball End	4.95
10040	3 Pin Flywheel .21 Corn Type	14.95	40073	Bearing, 4x8 Flange	12.95
10052	Spring Muffler Stay	4.95	40074	6x10 Ball Bearing	17.95
10069	Exhaust Connector	6.95	40090	Shock Repair Kit	7.95
10098	Pilot Shaft, SG Type	4.95	40112	2-Speed Shaft	9.95
10101	Clutch Spring	4.95	40117	1/8 Truck Body Mount	10.95
10114	Engine Mount Screw, 5mm Hex	7.95	40120	8mm Cap Joint for Brake	11.95
10120	Manifold Spring	4.95	40126	3x6x2.5 Flange Washer	3.95
10179	Fuel Tube (45cm)	1.95	40500	Servo Saver Spring (Black)	3.95
10185	Silicone Joint Tube Black	4.95	40511	Servo Saver Post	6.95
10270	Fuel Tube Clips	3.95	40512	Center Diff. Mount Post	13.95
10282	Switch Cover, Black	3.95	40513	Diff. Gear (small & large )	16.95
10300	Alum. Stopper	4.95	40514	Cap Joint for Diff.	13.95
10330	Cone, 7mm Brass Tapper	2.95	40516	Steel Bevel Gear 13T (Small)	14.95
10765	Universal Servo Horn	8.95	40517	Steel Bevel Gear 43T (Large)	38.95
30171	Brake Lever	1.95	40519	Cap Joint	9.95
30172	Brake Rod	1.50	40521	Universal Joint, Front	44.95
30212	5x8x2.5 Frange Bearing	5.95	40522	Rear Drive Shaft	19.95
30401	6mm Ball End (Plastic)	2.95	40525	Rear Lower Arm Shaft (3x48.1mm)	6.95
30401	Plastic Parts Set for Damper	2.95	40526	17mm Wheel Hub	11.95
30403	6mm Ball & Socket	4.95	40531	Shock Ball End Post/one- piece/Top	9.95
30531	Throttle Spring	2.95	40533	Gear Case	11.95
30560	Antenna Pipe	2.95	40537	Front Upper Arms	6.95
30773	4mm Cross Pin	3.95	40538	Diff. Case (F&R)	9.95
30776	4x10x0.2 Washer	1.95	40539	Servo Saver & Center Bracer	11.95
30800	2mm Brake Adjust Nut	6.95	40541	Receiver Box	14.95
30800	Throttle Linkage Plastic	6.95	40543	Fuel Tank	16.95
31159	Body Clips	4.95	40546	Front Arm Shaft 3x42.7mm	11.95
31304	Rear Hub (Ball Type)	10.95	40547	Brake Cam	8.95
31305	Plastic Washer for Ball	8.95	40548	M3 Nylon Nut (Thin Type)	1.95
31306	12mm Alum. Hex Screw	8.95	40549	Muffler Stay	4.95
31307	11mm Ball & Screw	8.95	40550	17mm Wheel Nut	4.95
31308	Stablizer (Steel) (L&R)	10.95	40560	Servo Saver Connecting Plate	12.50
31991	Manifold, 21 W /Spring, Polished	25.95	40563	Alum. Servo Saver Tube	9.95
31994	Pipe, 9.5mm DM-1 RTR Polished	54.95	40568	Graphite Front Plate	31.95
34026	Servo Fixing (Lay down)	7.95	40580	Protect Foam for Receiver Box	1.95
34028	Dog Bone, 100mm, ULTRA X-1	15.95	40633	Shock Cap, 13mm	18.95
34110	Ball Bearing 5X10X4	6.95	40634	Shock Spring Adjuster	9.95
35219	Alum. Nut (clockwise)	2.95	40635	Shock Shaft Dust Covers	5.95
35225	1st Spur Gear Holder (one-way)	26.95	40636	15x1 O-Ring	3.95
35228	Alum. Nut (anti-clockwise)	2.95	40637	Dust Felt for Shock Absorber	1.95
35230	8 x 12 Flange Bearing	12.95	40638	Shock Piston, 13mm	7.95
35234	2nd Spur Gear Clutch Bell	24.95	40640	Shock Pressure Top, Orange	5.95
35235	Clutch Shoe Carrier	5.95	40642	Antenna Pipe Fixing Nut	2.95
35236	Clutch Shoe	14.95	40643	Plastic Shock Parts Set	9.95
35237	Spring	9.95	40674	Engine Mount Tall For Pullstart	18.95
35237	4mm Ball	9.95	40694	CNC 7075 Chassis Brace, F&R	59.95
35237	6x6mm Set Screw	9.95	40708	Chassis 6061 DM1 RTR	89.95
35240	Clutch Gear (1st) 16T	11.95	40709	Radio Tray Alum. DM1 RTR	12.95
35242	Clutch Bell	24.95	40710	Center Drive Shaft 120mm	19.95
35244	44T 2nd Spur Gear	7.95	40711	4x90mm Arm Shaft	7.95
35248	48T 1st Spur Gear	7.95	40712	3.5x48mm Turnbuckle	9.95
35255	Clutch Gear (2nd) 20T	11.95	40713	3x64mm Turnbuckle	9.95
35958	5x8x2.5 Ball Bearing	3.95	40714	Center Handle Bar	3.95
36053	8x16 Ball Bearing	12.95	40715	Throttle Connecting Alum. Post	7.95
36055	2.5x17 Pins	3.95	40716	Rear Upper Arms	9.95
36660	Brake Pads, 4PCS.	3.95	40717	Front & Rear Lower Arms	19.95
36661	Brake Pad Washers, 4PCS.	3.95	40718	Ball Type Knuckle Arms (L&R)	19.95
36700	Steering 7mm Ball	6.95	40719	Arm Holder Plastic	15.95
36742	Servo Saver Bushing	1.95	40720	Body Side Bumper	9.95
36790	4x46 Turnbuckle	10.95	40721	Front & Rear Bumper	19.95
36850	7mm Ball	3.95	40722	Exhaust Connector	7.95
36861	5x35 Turnbuckle	6.95	40723	Dust Proof Cover	7.95
36903	Steering Ball 14mm	7.95	40724	Rubber Bushing for Hex Screw	4.95
36904	14mm Alum. Nut	9.95	40725	Foam Bumper	14.95
37360	4mm Ball & Socket	4.95	40731	CNC Alum Shock Stay, F	39.95
37410	Body Pin (S)	3.95	40734	Wing & Wing Stay Unit	12.95
37650	4mm Plastic Ball Joint	6.95	40735	Real Muffler & Back Mirror	14.95
38400	1/10 Air Filter	9.95	40736	DM-1 Shock Shaft	7.95
40009	P-6 O-Ring	2.95	40737	Shock Body, 13mm	24.95
40010	2.5x13.8 pin	2.95	40738	DM-1 Shock Spring Front (Red), Soft	14.95
40011	Diff. Gaskets	3.95	40745	Alum. Front Plate Black	7.95
40024	Diff Bevel Gear Shim 13x16x0.2mm	2.95	40746	Alum. Servo Saver Cnt. Plate Black	9.95
40034	Alum. Servo Saver Ring Adjuster	5.95	40748	CHASSIS, 6061 DM1 SPEC	99.95
40037	Steering Plate Hex Screws	5.95	40749	CENTER DR SHFT DM1S 88.5/104mm	19.95
40038	7mm Balls (Black)	9.95	40750	SHOCK TOWER RR ALUM DM1 SPEC	14.95
40040	Center Diff Mount (plastic)	4.95	40751	SPRINGS, REAR RED DM1 SPEC	9.95
40042	Brake Discs, Steel 4Pcs.	10.95	86023	1/8 Mesh Wheels (Black)	19.95
40044	Spring, Brake Separators, 8 Pcs.	5.95	86052	1/8 Radial Tire	19.95
40060	M2.5 Nylon Nut	4.95	86059	GTP Inner Sponge (L&S)	9.95





## OWNER'S REGISTRATION CARD

OFNA Racing congratulates you on your purchase of our fine OFNA Product. With proper maintenance and handling this kit will provide many hours of enjoyment.

The registration card should be filled out and mailed to OFNA Racing within 10 days of purchase date.

In the event that the kit is incomplete or component parts are broken due to error in manufacturer, contact your dealer from which you purchased the kit for replacement part or call OFNA at (949) 586-2910 for your nearest dealer location. Other items such as radio and engine other covered by individual warranties.

### IMPORTANT!

Please print or type, filling in the information listed below and mail immediately

### MAIL TO:

OFNA RACING  
7 VANDERBILT  
IRVINE, CA. 92618  
TEL: (949) 586-2910



### REGISTRATION CARD

Write in Your Model Name and Part Number



RACER'S NAME \_\_\_\_\_ TEL: (     ) \_\_\_\_\_

ADDRESS \_\_\_\_\_

CITY \_\_\_\_\_ STATE \_\_\_\_\_ ZIP \_\_\_\_\_

DEALER'S NAME \_\_\_\_\_ TEL: (     ) \_\_\_\_\_

ADDRESS \_\_\_\_\_

CITY \_\_\_\_\_ STATE \_\_\_\_\_ ZIP \_\_\_\_\_

**OFNA**  
**7 Vanderbilt**  
**Irvine, Ca. 92618**