

DM-ONE PRO TOURING

60+
mph



X-SIZE NITRO SEDAN

4WD
FOUR WHEEL DRIVE

INSTRUCTION MANUAL

Features:

- *High impact large front bumper and foam bumper.
- *CNC machined steel transmission bevel gears.
- *CNC machined aluminium front shock mount.
- *CNC machined aluminium rear shock mount with heat sink.
- *Low C. G. lay-down steering servo and throttle servo mount.
- *Front and rear push rod suspension design.
- *Threaded lay-down 13mm big bore shocks for front and rear.
- *Adjustable ackerman steering geometry design.
- *Graphite front plate.
- *Graphite low centre of gravity radio tray.
- *Front pivot ball suspension with dust boot covers.
- *Rear pivot ball uprights for quick geometry changes.
- *Spring steel universal joints for front and rear.
- *Adjustable blade type sway bar for front and rear.
- *Adjustable down-stop and up-stop suspension design.
- *CNC machined 7075-T6 hard coated chassis brace.
- *Quick release centre differential mount design.
- *Convenient carry handle in the centre of the car.
- *Changeable roll centre design for front and rear suspension.
- *CNC machined steel brake discs.
- *Special semi-metallic brake pads.
- *Shoe type 2 speed transmission.
- *CNC machined clutch bell with screw-on changeable gears.
- *CNC machined 7075-T6 aluminium, milled out slim line chassis.
- *Secure transponder mount.
- *High flow air filter for maximum engine protection.
- *Side body mounts and body protector.
- *Rear air flow diffuser creates more down force.
- *Exhaust deflector design to protect the inside of the body.
- *Chrome exhaust pipe detail parts.
- *High grip radial tires on 17mm hex wheels.
- *Choice of different body designs.

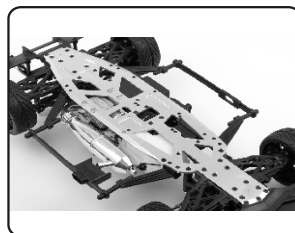
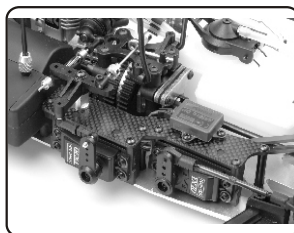
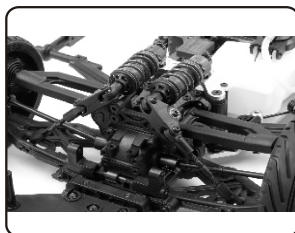

ADDITIONAL PARTS NEEDED

- *Radio System
- *.21 - .28 Engine
- *Batteries 8 AA for Radio
- *Receiver Batteries (10202 Hump Pack)
- *Model Fuel 20% Nitro
- *Paint for Lexan Bodies
- *CA Glue

THIS IS NOT A TOY !

This kit is extremely fast, and can easily go over 40mph and can seriously injure someone. If you are under 18 years of age have an adult supervision.

MODEL SHOWN MAY BE PROTOTYPE AND MAY VARY SLIGHTLY FROM KIT. SPECIFICATIONS ARE SUBJECT TO CHANGE WITHOUT PRIOR NOTICE.

BLANK

MUST READ THIS BEFORE RUNNING

Running a nitro kit is fun and easy, but to make this a safe and good experience you must observe a few rules. This kit is extremely fast, easily over 40MPH, and can seriously injure someone if you are not careful.

Where to run car?

- Any running area you choose must be dry. Do not run car near any water or wet dirt.
- Do not run on public streets. It is very easy to have the car run over or damaged by hitting the curb.
- Do not operate car in tight confined places. The car is very fast and will easily hit something.
- Do not run near people or animals. The car is very fast and will too easily hit someone.
- Due noise, you will want to consider the surrounding area when operating the car.
- Do not operate the car at night. You will not be able to drive it without hitting something.
- Do not operate the car indoors. Engine exhaust is not healthy.

Glow Fuel

- Glow fuel is poisonous!
- Glow fuel is flammable!
- Do not leave in fuel bottle with lid off at any time.
- Do not use any fuel other than glow fuel in this engine.

First Time Starting the Engine

Caution! When starting engine make sure the following is observed.

- Set engine Master needle to 3 turns (rich setting)
- Do not do this alone, get an experienced friend to help at first.
- Fill fuel tank, try not to spill fuel. Do not spill fuel on receiver
- Hold car off the ground, so it will not runaway when first starts
- Turn on Radio and check the linkage before starting engine.
- Turn on car receiver battery switch.
- Always have an air filter on the carburetor to keep dirt out.

Engine Break-in

- See Engine Page.

Emergency Stopping Engine When Running

- Remove air filter and cover carb. intake.
- Squeeze fuel line and hold until engine stops.
- With a rag, cover exhaust outlet.

Storing Car After Running

- Remove fuel from tank and fuel lines
- Turn off radio in car
- Put a few drops of after run in engine to keep it from rusting.

- Clean oil and dirt from chassis with a degreaser.

Precautions

- This kit is not a toy. Always run car with a second person as a spotter and pitman.
- Hot Parts - The pipe, manifold, engine and head are very hot and will cause burns.
- Rotating Parts - Keep hands away from the drive train, wheels, and engine when engine is running.
- Radio - Check batteries life before running the car. If radio does not have full control of the car with steering and/or throttle/brake do not run until corrected. Failure to correct this will result in possible injury and damage to the car or property.
- Glow fuel - Do not leave the glow fuel unattended with the Lid off. Fuel contains Methanol and Nitro Methane and is flammable and poisonous.

Store fuel in cool ventilated location. Refer the glow fuel label for additional precautions.

- Car Fuel tank - Never store fuel in car tank, it will ruin the engine if left in tank.

- Always turn off the car BEFORE turning off radio.

- DAMAGE DUE TO CAR RUN AWAY IS NOT A WARRANTY ISSUE.

IF YOU DO NOT BREAK-IN ENGINE CORRECTLY, MAINLY AT LOW RPM, YOU WILL BREAK THE CONNECTING ROD!

FAILURE TO NOT READ AND FOLLOW BREAK-IN ENGINE INSTRUCTIONS WILL VOID WARRANTY!

REQUIRED FOR OPERATION

THINGS NEED BESIDES THE KIT

3.5 cc (21 Class) ENGINE REAR EXHAUST

OFNA/Picco
P-9R EVO
#51219



Note: Pro kit does not include engine!

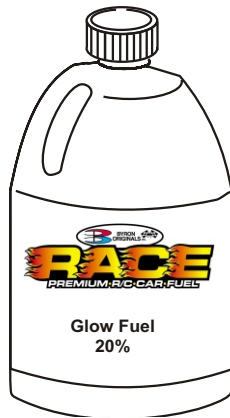

Glow Fuel
20%



Off-Road Starter Box, 12V motor
10250 - 1/8 scale Starter Box
10253 - 1/8 scale Starter Box w/ Panel
Off-Road Starter Box, two 550 motors
10248 - 1/8 scale Starter Box
10249 - 1/8 scale Starter Box, RTR
Optional Parts
92571 - Power Panel Glow Heater
92572 - Cable for Glow Plug



Bottle's with spout
10160 - large 500cc
10161 - large 500 ccAuto Stop
10162 - small 250cc
10164 - CNC spout 500CC
10167 - CNC spout 800CC



Glow Plug Long Heat with Battery & Charger
10215....\$27.95
(please note OFNA Glow Heats available)

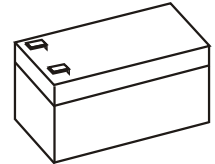

12V Battery for Starter Box
(must have)

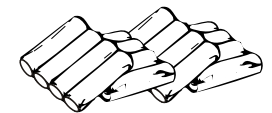

AA Batteries (12 pcs) for radio

RADIO CONTROL UNIT



Note: Carefully read the instruction manual of your
2 channel radio controller before using.

SUITABLE SERVO SIZE

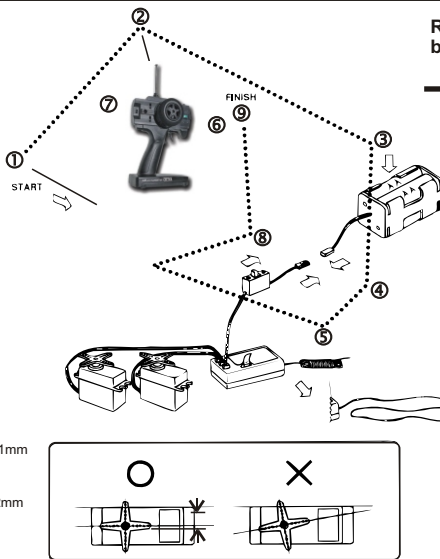
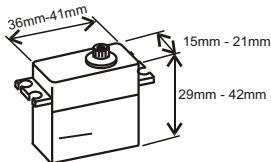

Radio must be set at neutral position
before installing in the kit.

SEQUENCE TO SET NEUTRAL

- ① Install AA batteries in Radio.
- ② Extend the antenna.(Transmitter)
- ③ Install batteries into Car receiver .
- ④ After installing the battery, connect the battery box.
- ⑤ Extend the antenna. (Receiver)
- ⑥ Set the trim-lever at center.
- ⑦ Turn on the switch. (Transmitter)
- ⑧ Turn on the switch. (Receiver)
- ⑨ Make sure the servos are in command.
- ⑩ When the operation stick is in neutral, servo horns must be in neutral as will. *Adjustment can be made by re-installing the servo horn.
- ⑪ Turn off the switch. (Receiver)
- ⑫ Turn off the switch. (Transmitter)
- ⑬ Retract the antenna. (Transmitter)

More Optional Parts . . .

#10202 NiHm Battery Hump
Pack .. \$34.95



10214 NiHm Battery Pack
Charger.. \$7.95



51007 OFNA/Picco Glow
Plug .. \$4.95



TOOLS NOT INCLUDED IN KIT

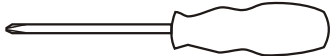

Phillips Type Screw Drivers (L)

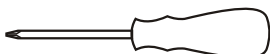

Phillips Type Screw Drivers (S)

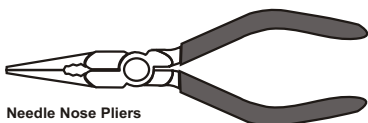

Needle Nose Pliers



Knife

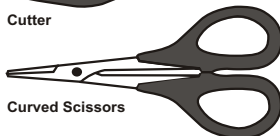
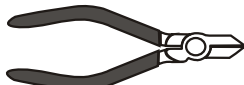

Curved Scissors

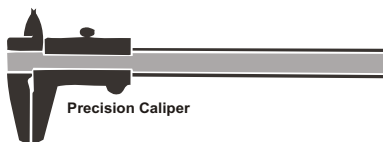

Precision Caliper



Brush



Cross Wrench



Instant Cement

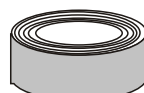

Masking Tape



Paints

INCLUDED WITH KIT



Shock Oil
80WT

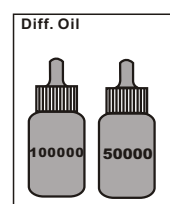

Diff. Oil

100000

50000

1.5mm Allen Wrench

2mm Allen Wrench

2.5mm Allen Wrench

4mm*5mm Allen Wrench

PLASTIC PARTS FOR USE

**40533
FRONT AND REAR GEAR BOX**

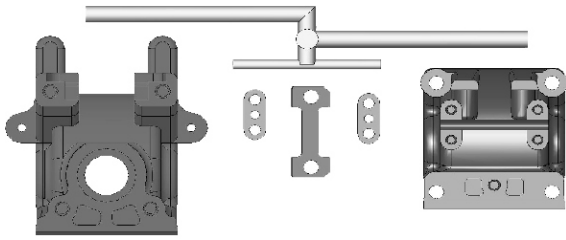

**40538
DIFF. CASE**

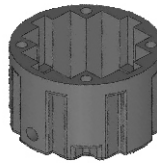

**40537
REAR UPPER ARM**

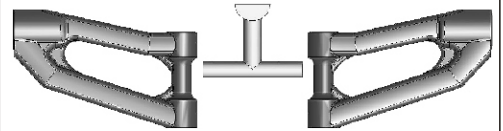

**40717
FRONT AND REAR LOWER ARM**

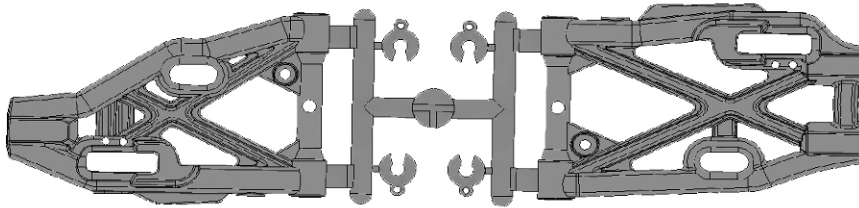

**40718
FRONT KNUCKLE ARM**

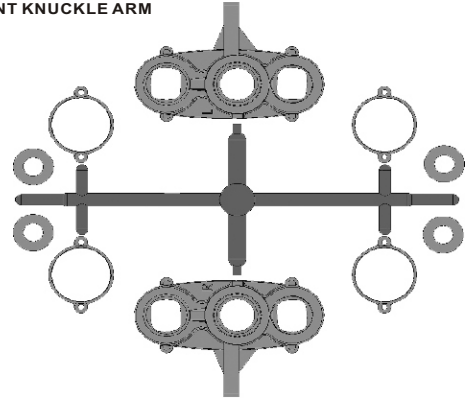

**40716
FRONT UPPER ARM**

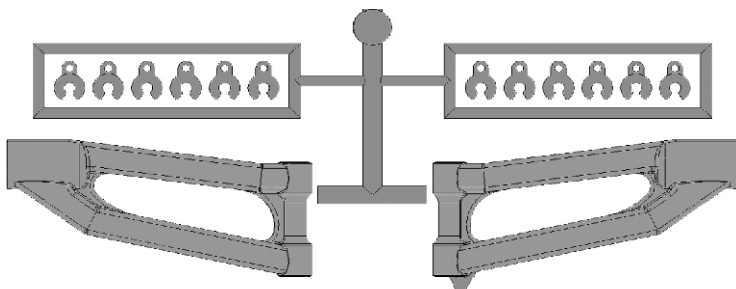

**31304
REAR UPPER RIGHT**

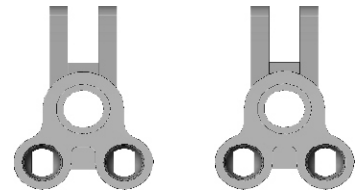

**40643
SHOCK PLASTIC**



Parts For
Not Use

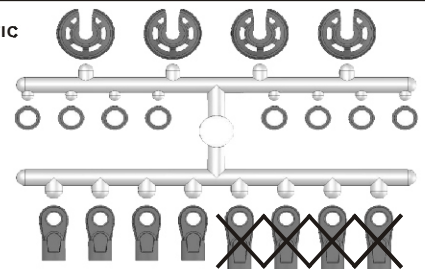

**40721
FRONT BUMPER**

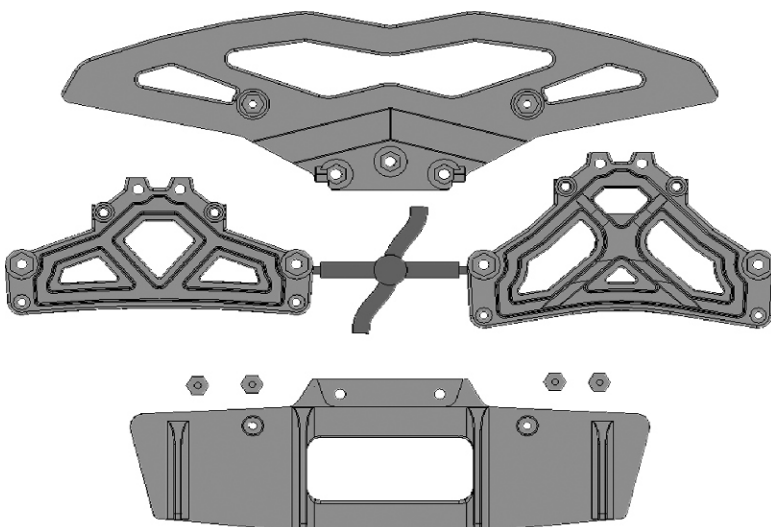

**30800
Throttle Linkage Plastic**

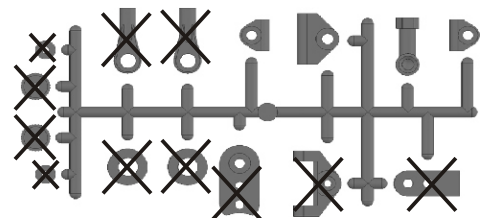

**40040
CENTER DIFF. MOUNT PLASTIC PARTS**

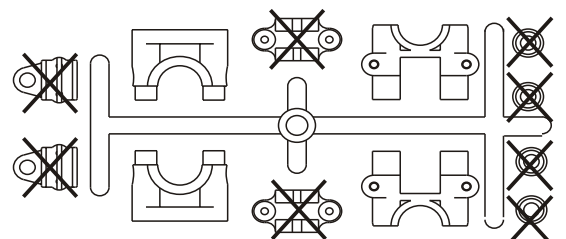

PLASTIC PARTS FOR USE

40541
RECEIVER BOX

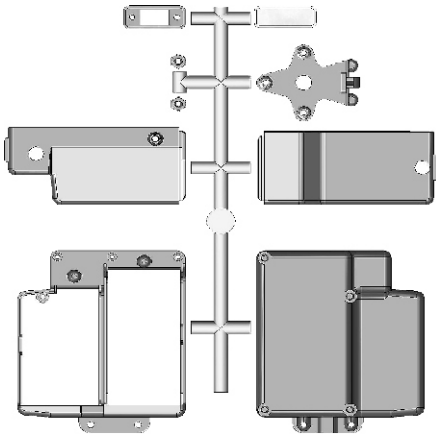

40539
SERVO SAVER

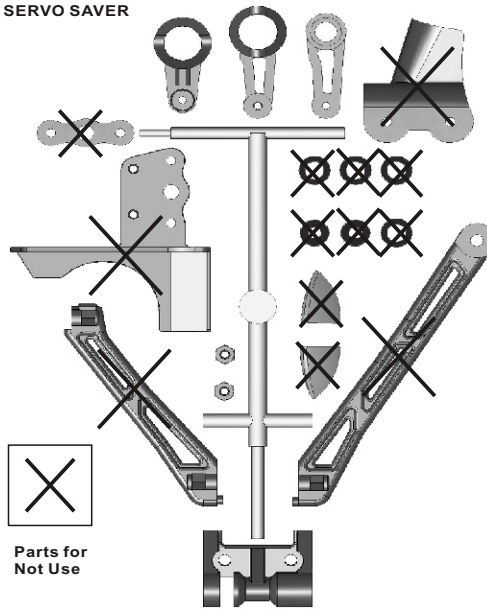

40722
EXHAUST GAS DEFLECTOR

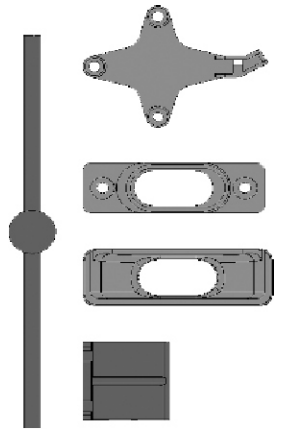

40735
EXHAUST PIPE DETAIL PARTS
AND BACK MIRROR

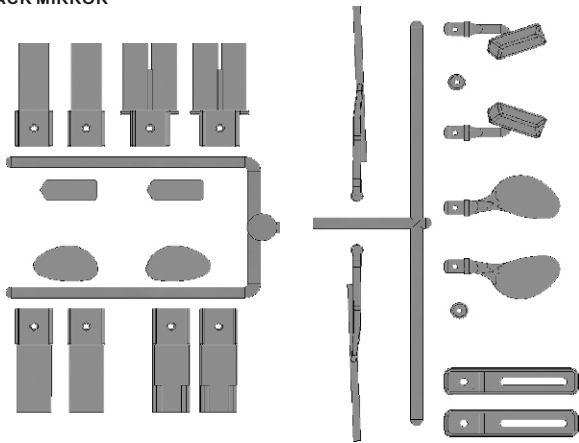

40719
ARM HOLDER

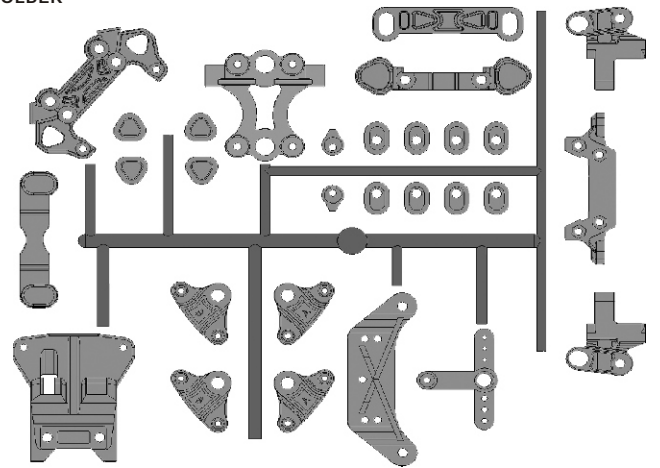

40720
SIDE IMPACT BUMPER AND BODY POST

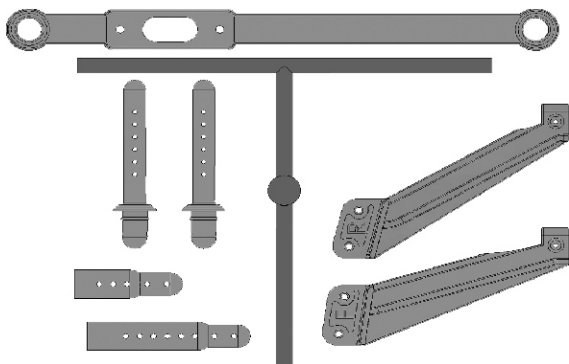

40734
REAR WING AND WING MOUNT

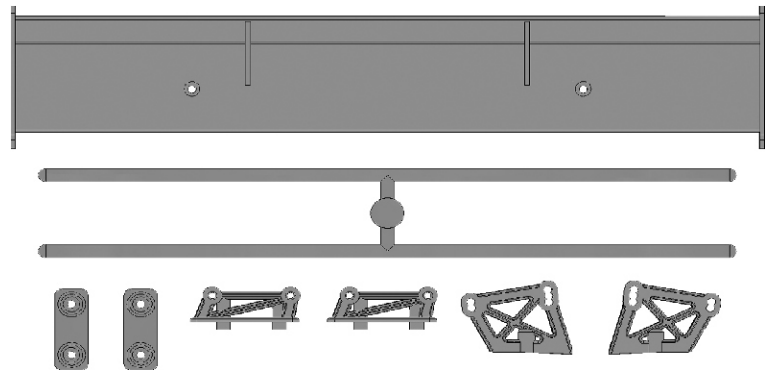

SYMBOL USED THROUGHOUT THE INSTRUCTION MANUAL



Parts Bag Used



Degrease With
Motor Spray



Do Not
Over Tighten



Tighten



Ensure
Free
Movement



Contact Adhesive



Apply Screw
Cement



Apply Oil



Apply Grease



True-To-Scale



Clockwise
Rotation



Anti-clockwise
Rotation

1 ASSEMBLY OF THE FRONT AND REAR SHOCKS

Make 4 shocks for Front and Rear.



NO.1

Step 1

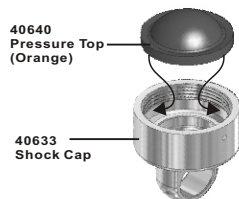

Step 2

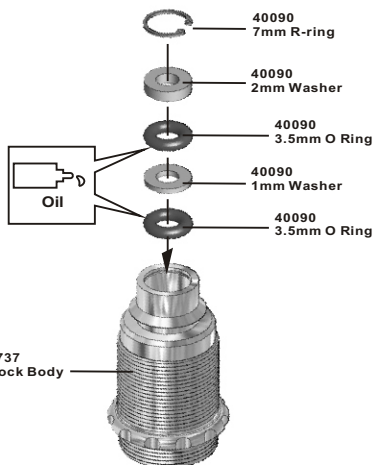

Step 2

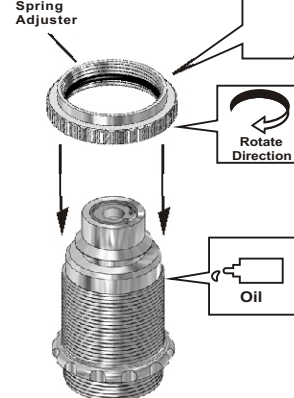

Fit the o-ring into groove before assembly.



2 ASSEMBLY OF THE SHOCK SHAFT



NO.1
NO.12

- 40060 2.5mm Nylon Nutx4
- 30403 6mm Ballx4
- 2.6x5mm Washerx8

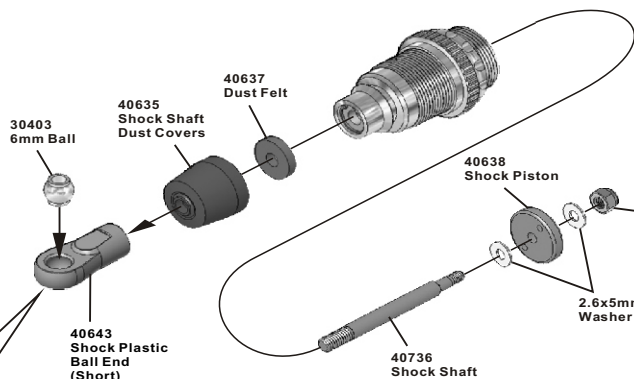

1. Pull down piston and pour oil into shock cylinder to approx 90%.
2. To remove air bubbles by slowly moving piston up and down.

Fill the shocks with oil.

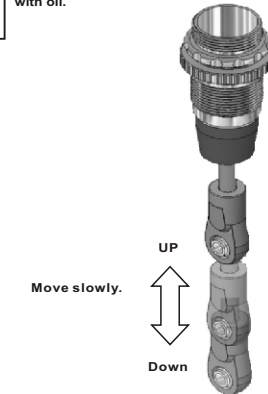

Do not over tighten the 2.5 mm nylon nut.

Move slowly.



3 ASSEMBLY OF THE SHOCK CAP AND SPRING



NO.1

Step 1

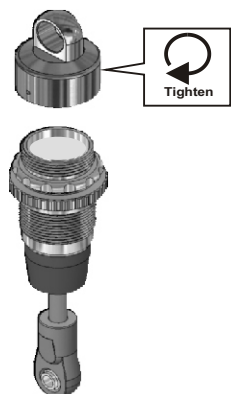

1. Pull down piston, attach pressure top and shock oil overflow with tissue paper.



*Total length for 84mm.

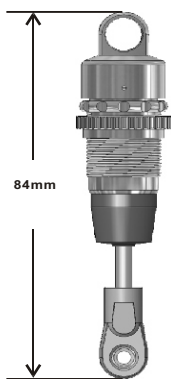

Step 2

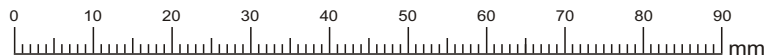
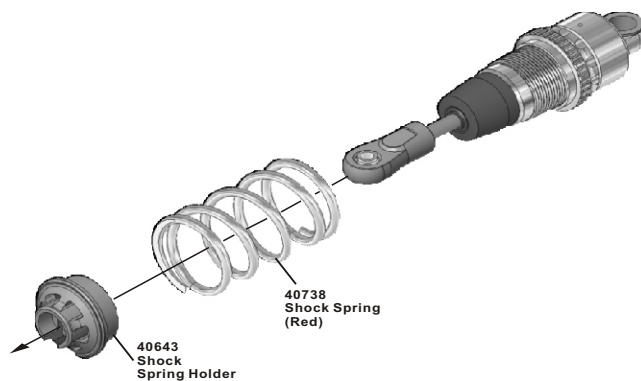

4 ASSEMBLY OF THE FRONT AND REAR DIFF.

Builds two differentials for front and rear.



NO.2

Step 1

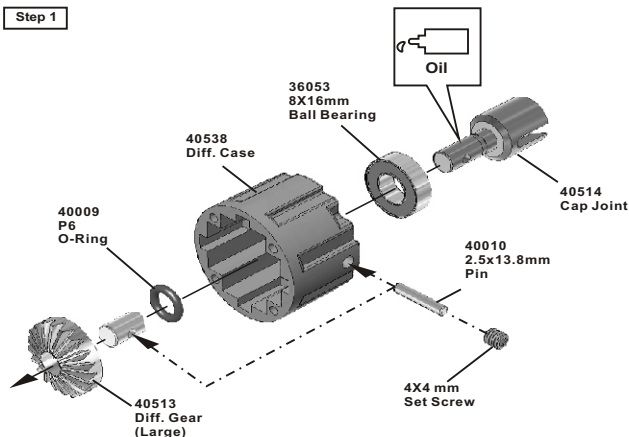
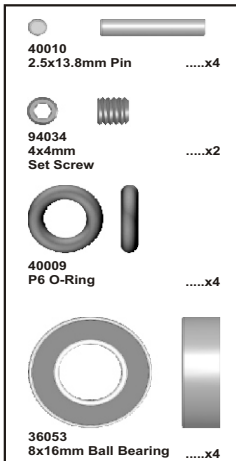

Step 2

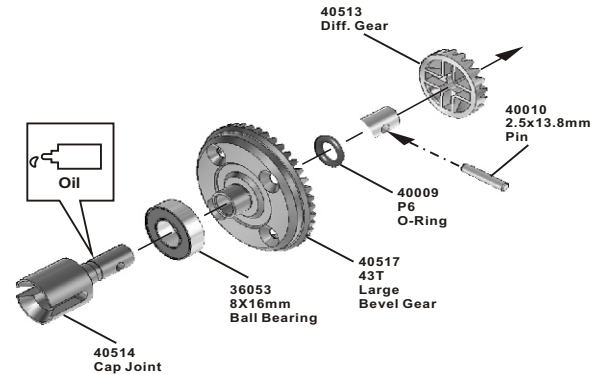

5 ASSEMBLY OF THE FRONT AND REAR DIFF.

Builds two differentials for front and rear.



NO.1
NO.12

Step 1

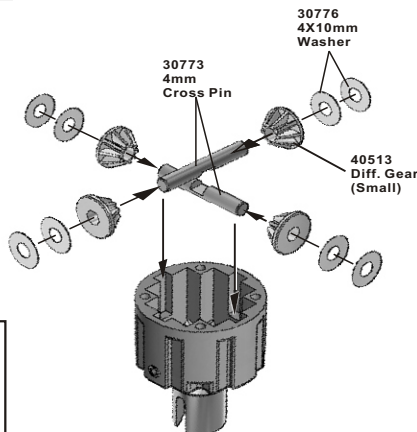
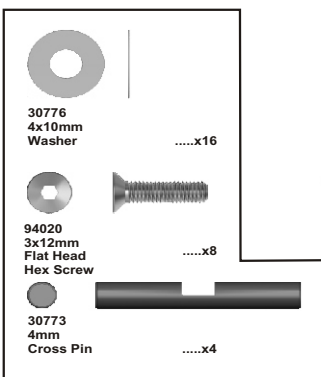

NB. It is very important to remove the 30776 washer if the gear mesh is too tight.

Step 2

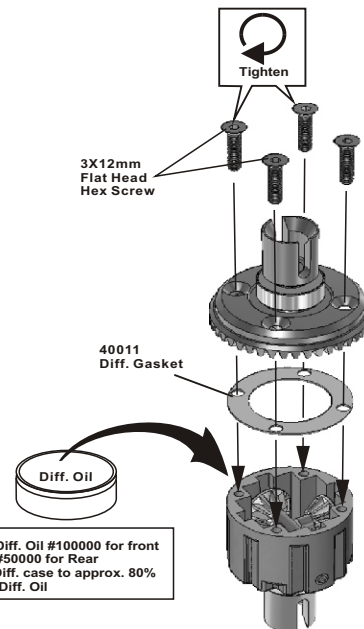

*Put the Diff. Oil #100000 for front and the #50000 for Rear
*Fill the Diff. case to approx. 80% with the Diff. Oil

Tight the diff screws in this order.

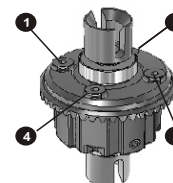

6 ASSEMBLY OF THE FRONT AND REAR GEAR CASE

Builds two gear case for front and rear.



NO.2
NO.4
NO.5

Step 1

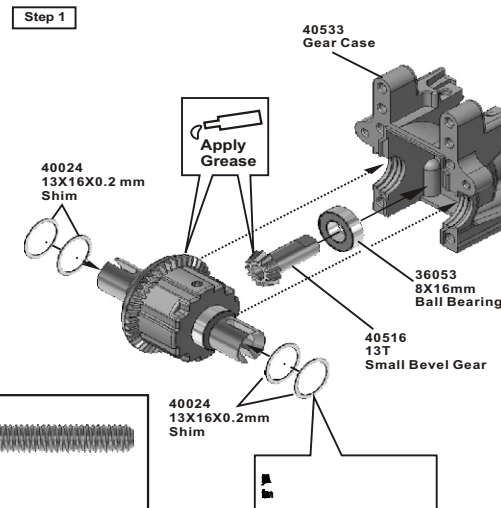
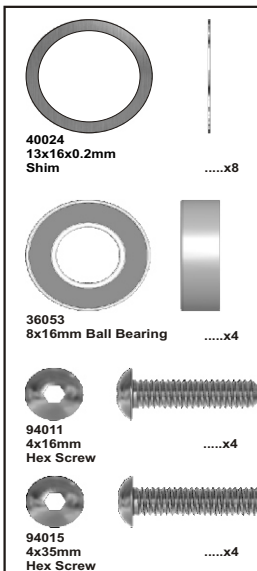

Step 2

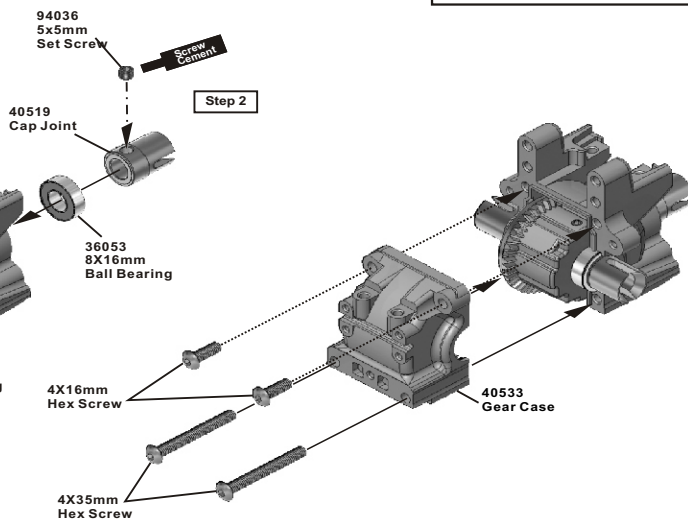

7 ASSEMBLY OF THE SERVO SAVER



NO.3

Step 1

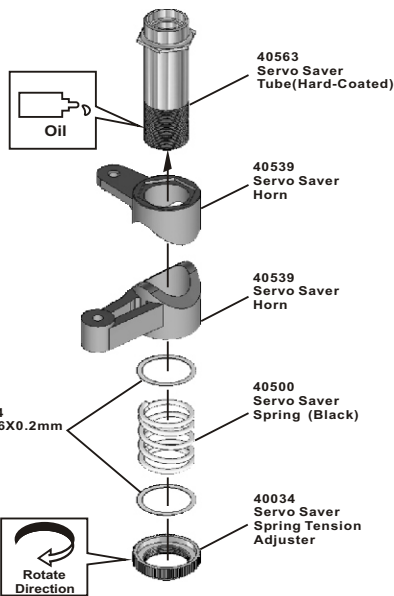
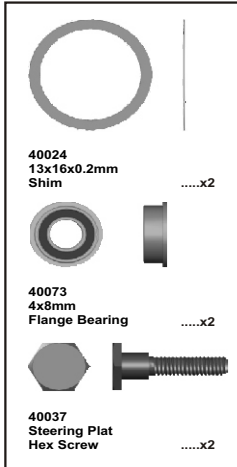

Step 2

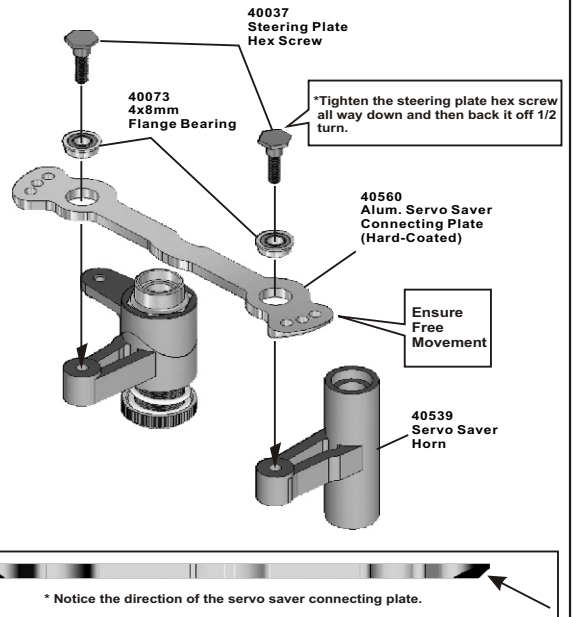

8 ASSEMBLY OF THE SERVO SAVER



NO.3

Step 1

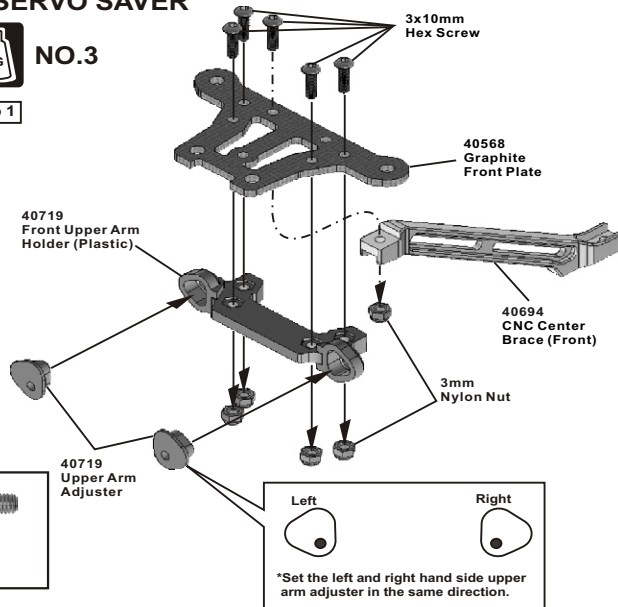

Step 2

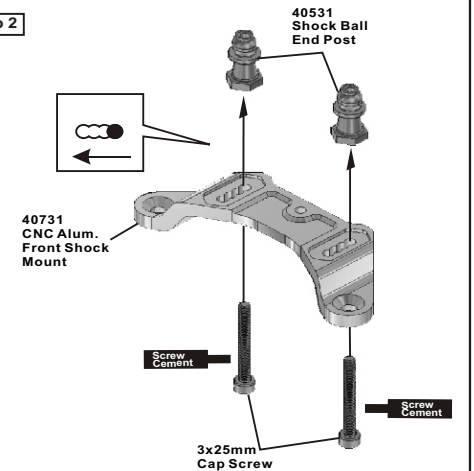

9 ASSEMBLY OF THE SERVO SAVER



NO.3

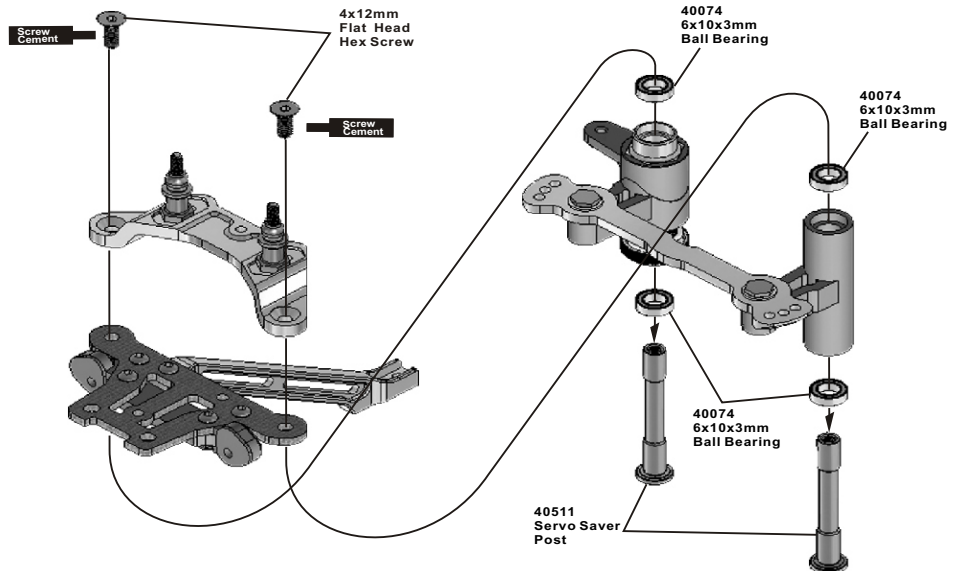
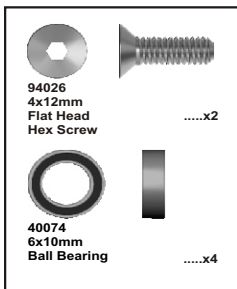

10 ASSEMBLY OF THE STEERING TIE-ROD

Assembly of the right and left hand side are the same.

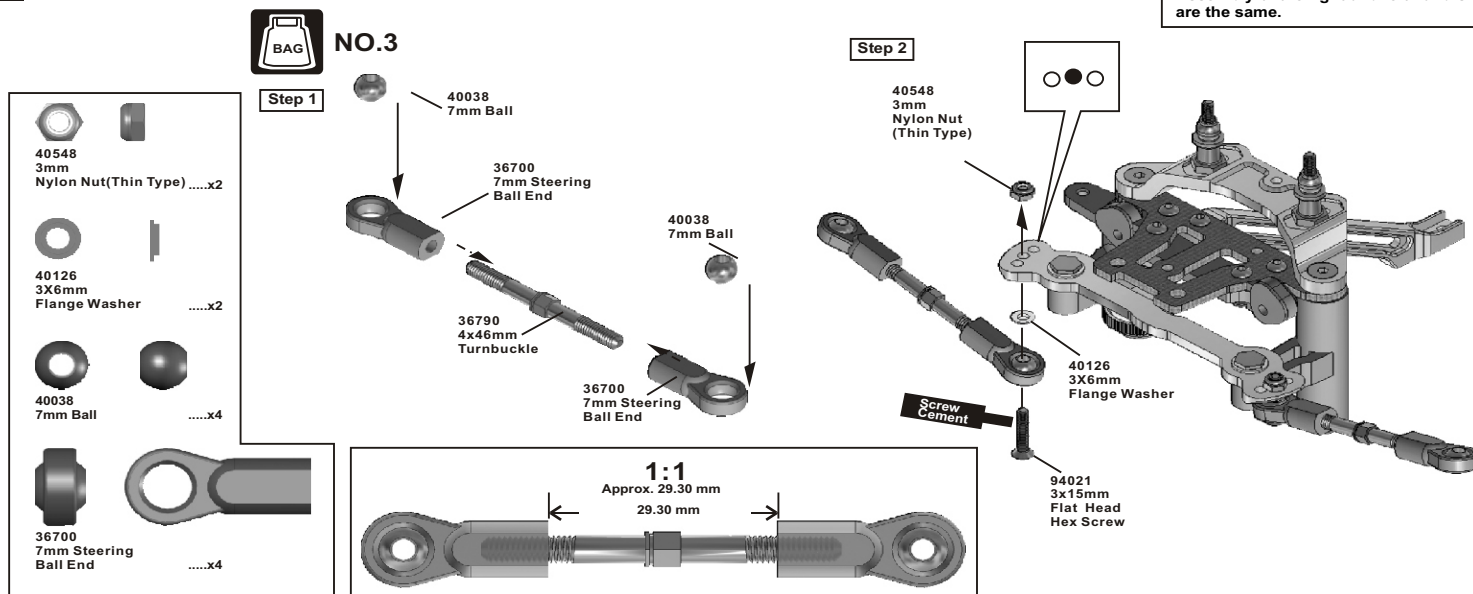

11 ASSEMBLY OF THE SERVO SAVER AND FRONT UPPER ARMS

Assembly of the right and left hand side are the same.

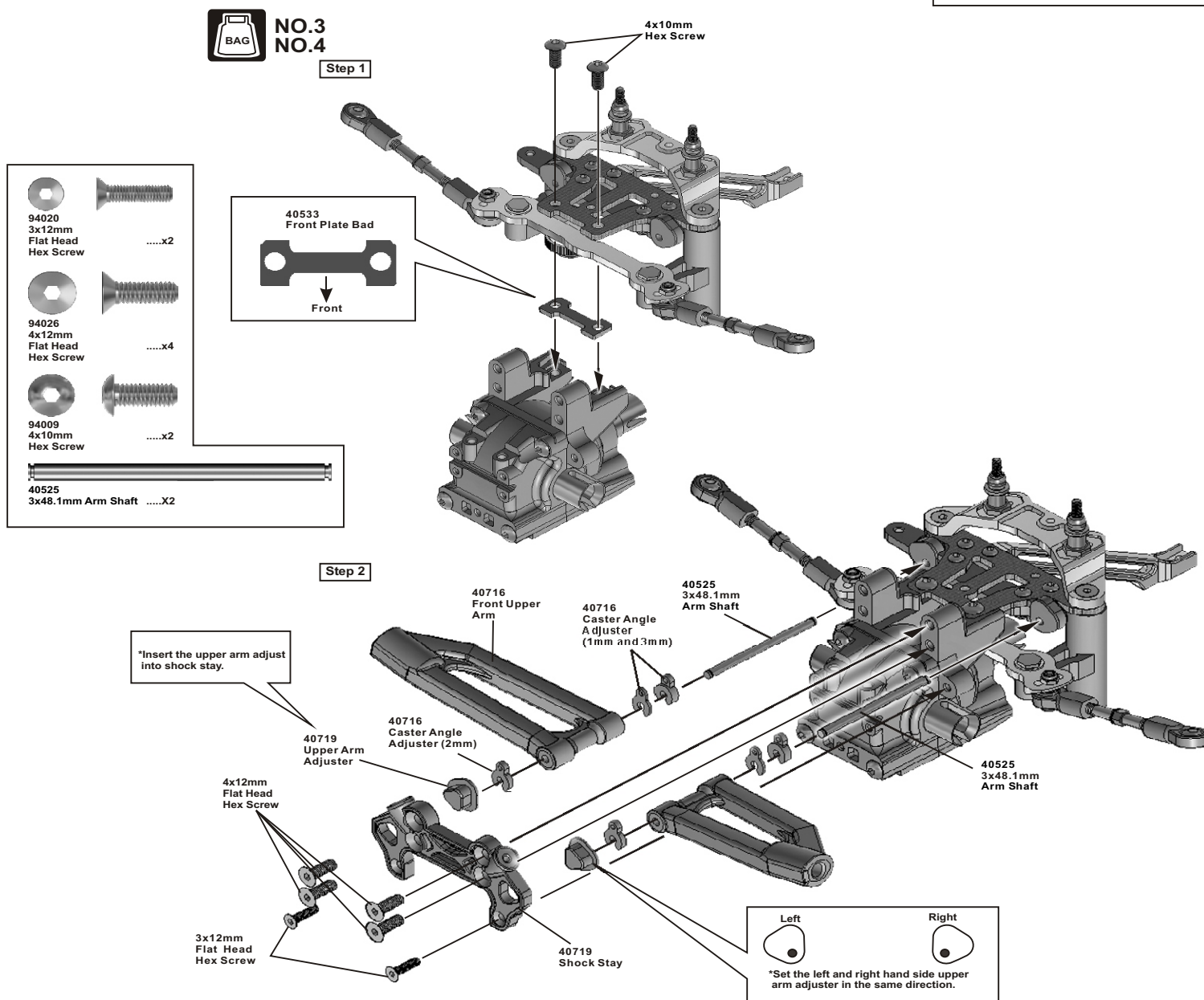

12 ASSEMBLY OF THE FRONT SHOCK STAY



NO.4

Assembly of the right and left hand side are the same.

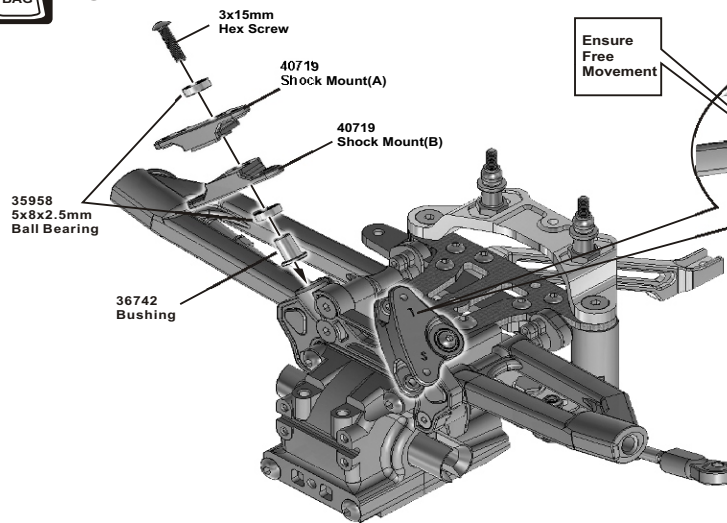
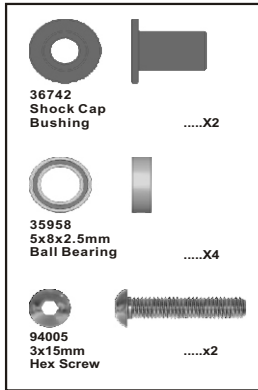

13 ASSEMBLY OF THE FRONT SHOCKS ONTO SHOCK STAY



NO.1

Assembly of the right and left hand side are the same.

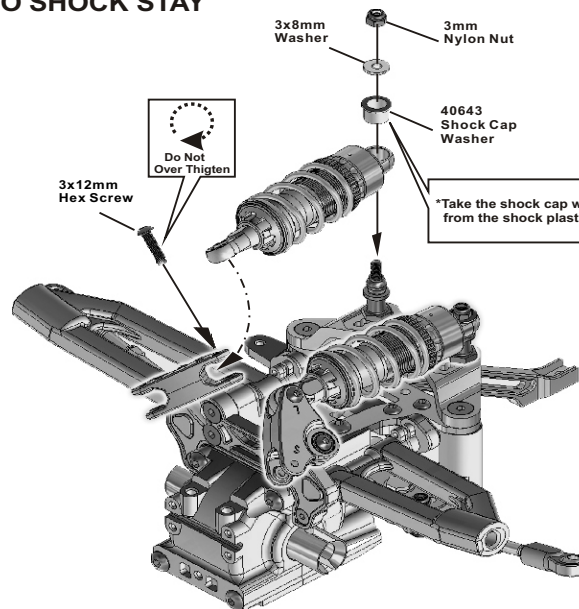
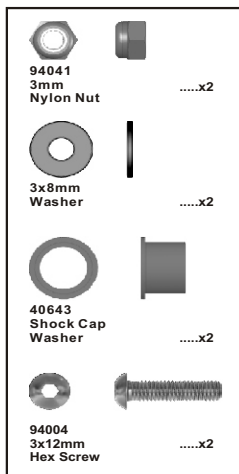

14 ASSEMBLY OF THE REAR UPPER ARMS



NO.5

Assembly of the right and left hand side are the same.

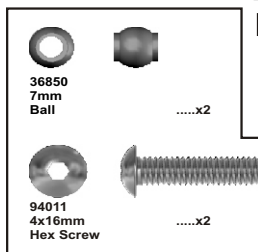

Step 1

Step 2

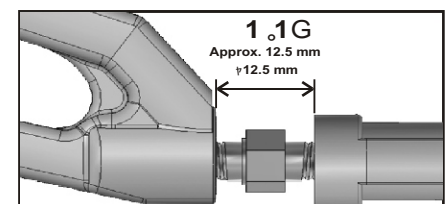
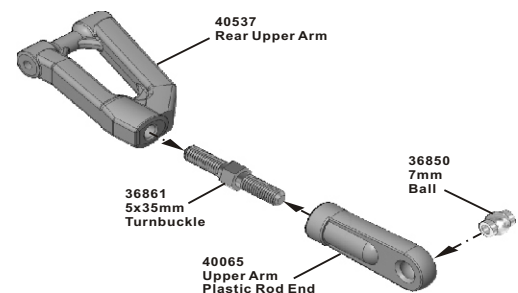
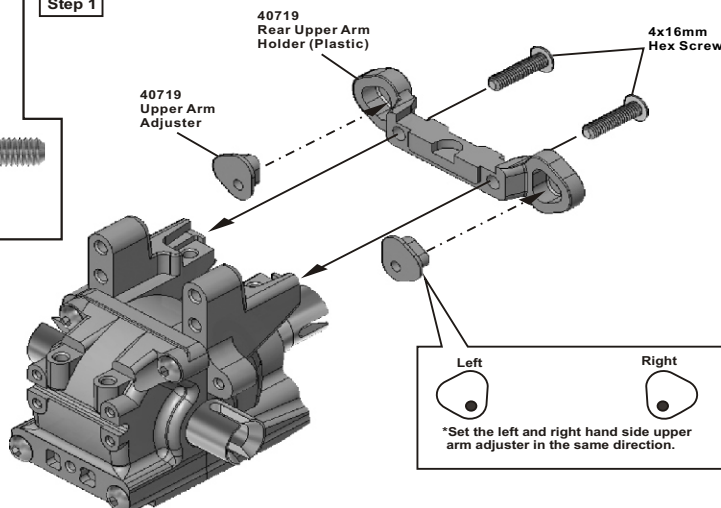

15 ASSEMBLY OF THE REAR UPPER ARMS

Assembly of the right and left hand side are the same.



NO.5

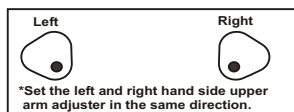
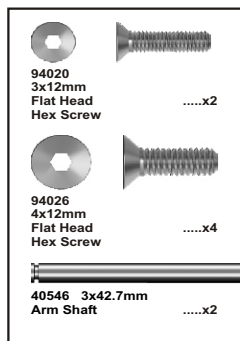

*Insert the caster angle adjuster onto arm shaft.

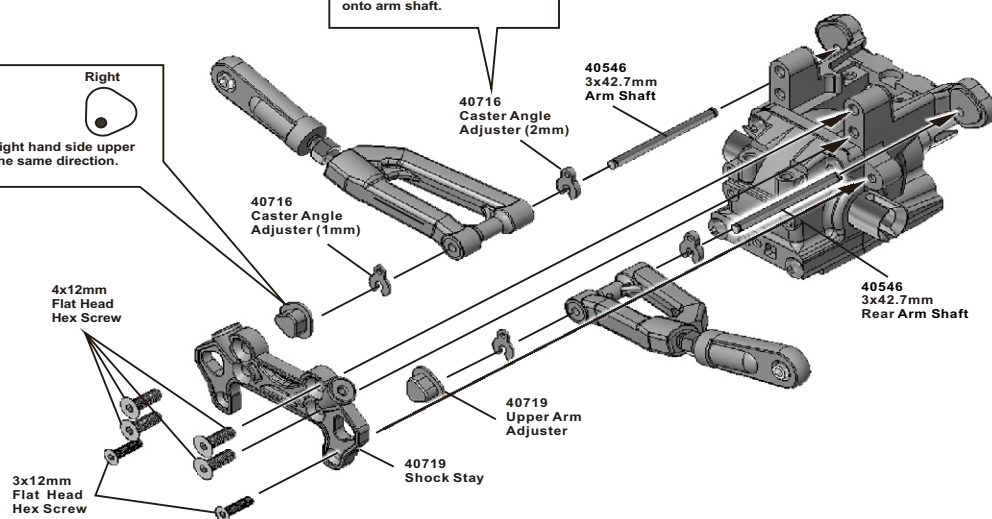

16 ASSEMBLY OF THE REAR SHOCK MOUNT



NO.5

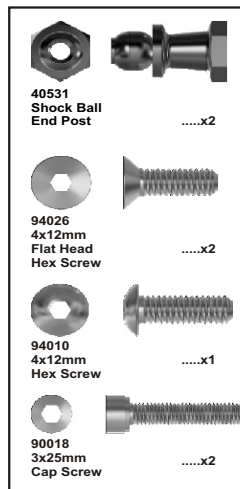

Step 1

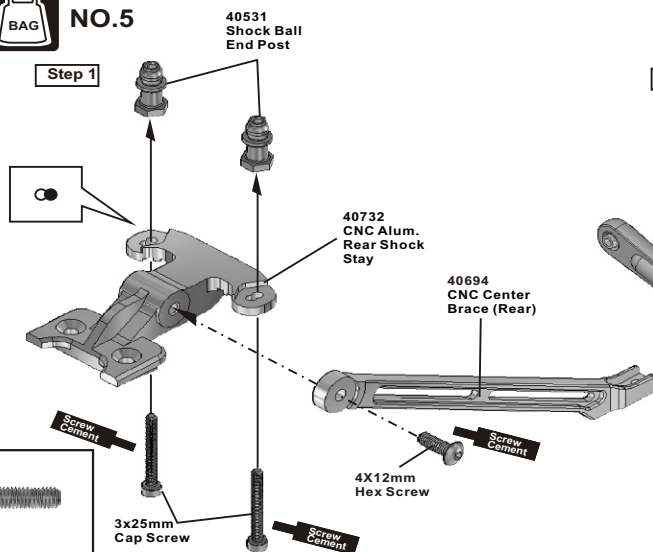

Step 2

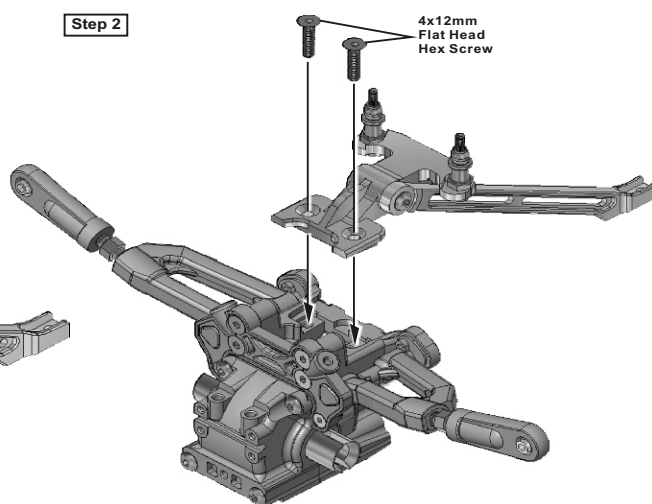

17 ASSEMBLY OF THE REAR SHOCK STAY

Assembly of the right and left hand side are the same.



NO.5

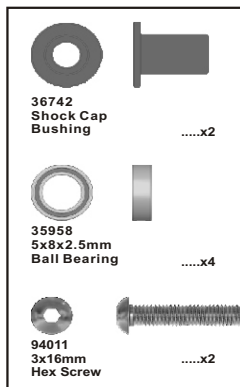

3x15mm Hex Screw



40719 Shock Mount(A)
40719 Shock Mount(B)
35958 5x8x2.5mm Ball Bearing
36742 Shock Cap Bushing

Ensure Free Movement

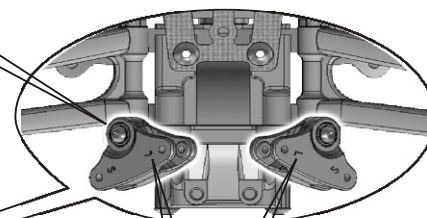

Notice "L" make are for the inside.

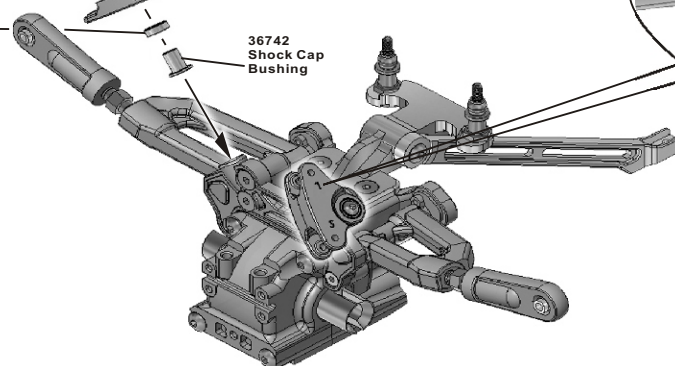

Assembly of the right and left hand side are the same.

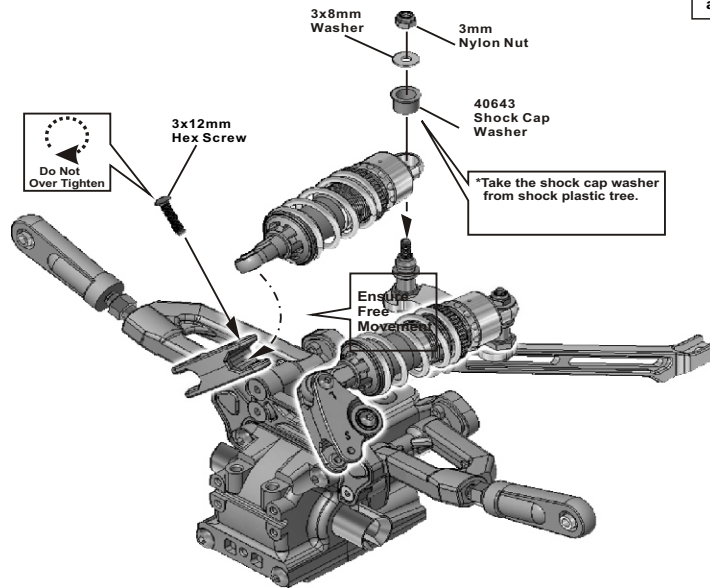

NO.7

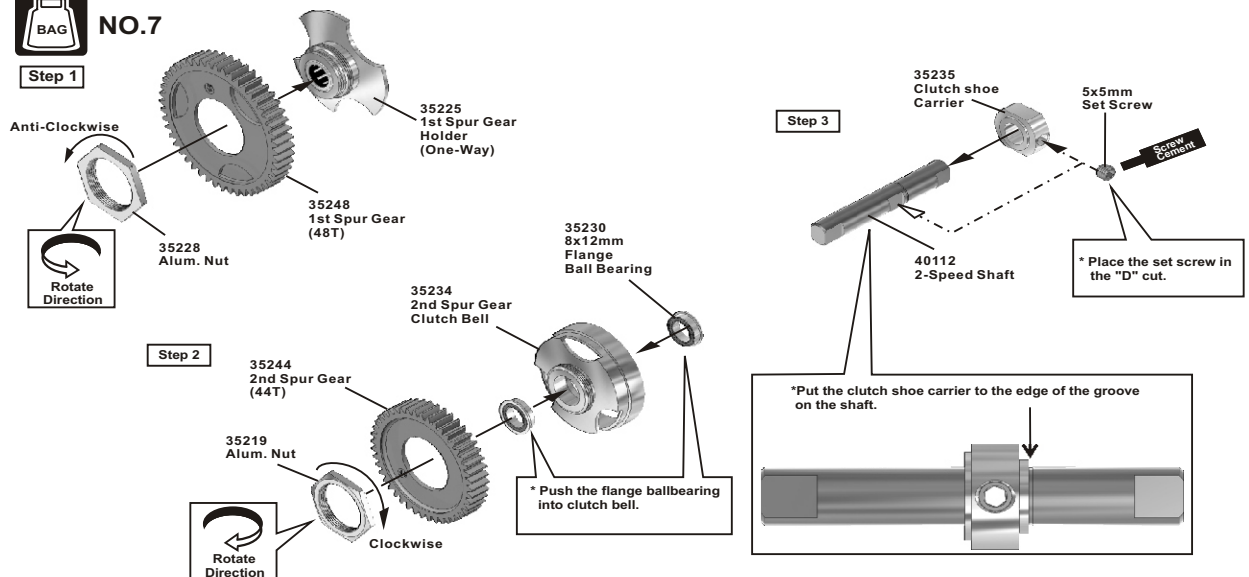

NO.7

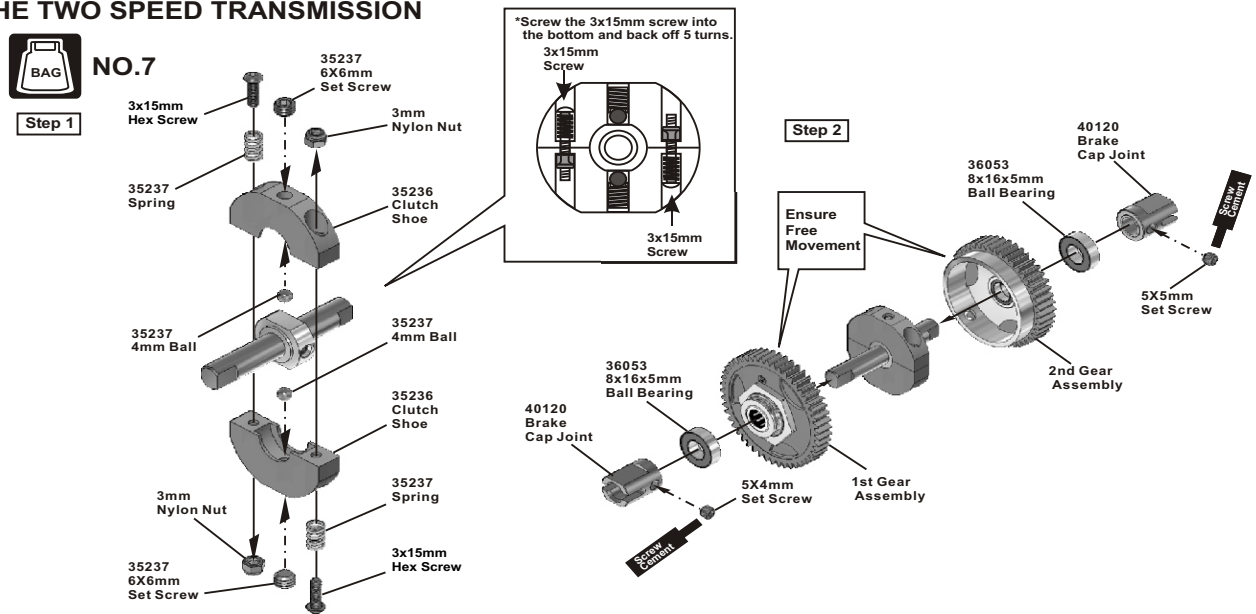

21 ASSEMBLY OF THE TWO SPEED TRANSMISSION INTO THE CENTER MOUNT

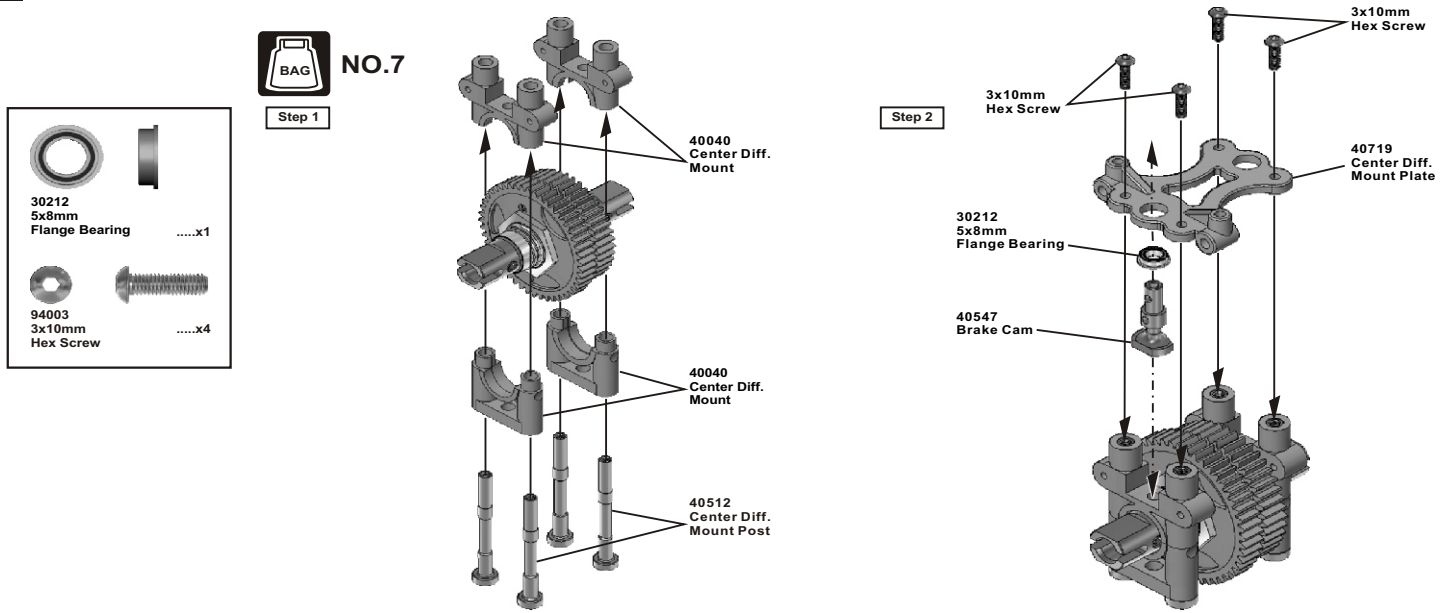

22 ASSEMBLY OF THE BRAKE AND CENTER DIFF. MOUNT

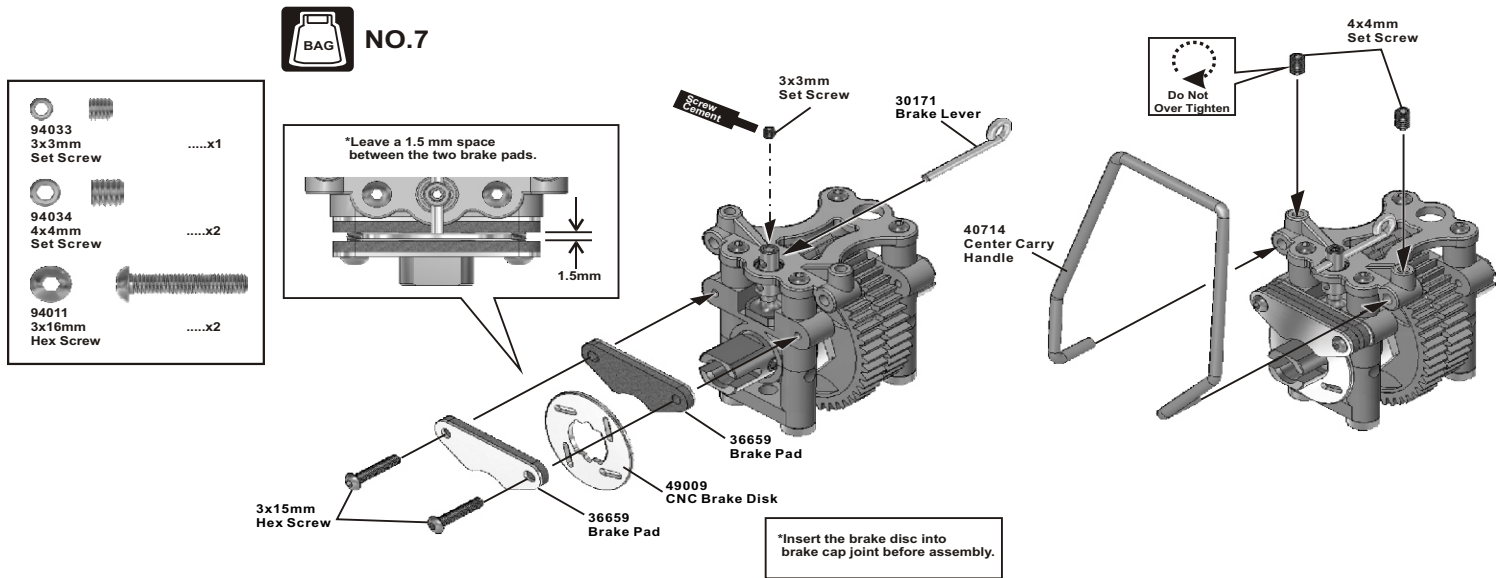

23 ASSEMBLY OF THE ARM HOLDER ONTO CHASSIS

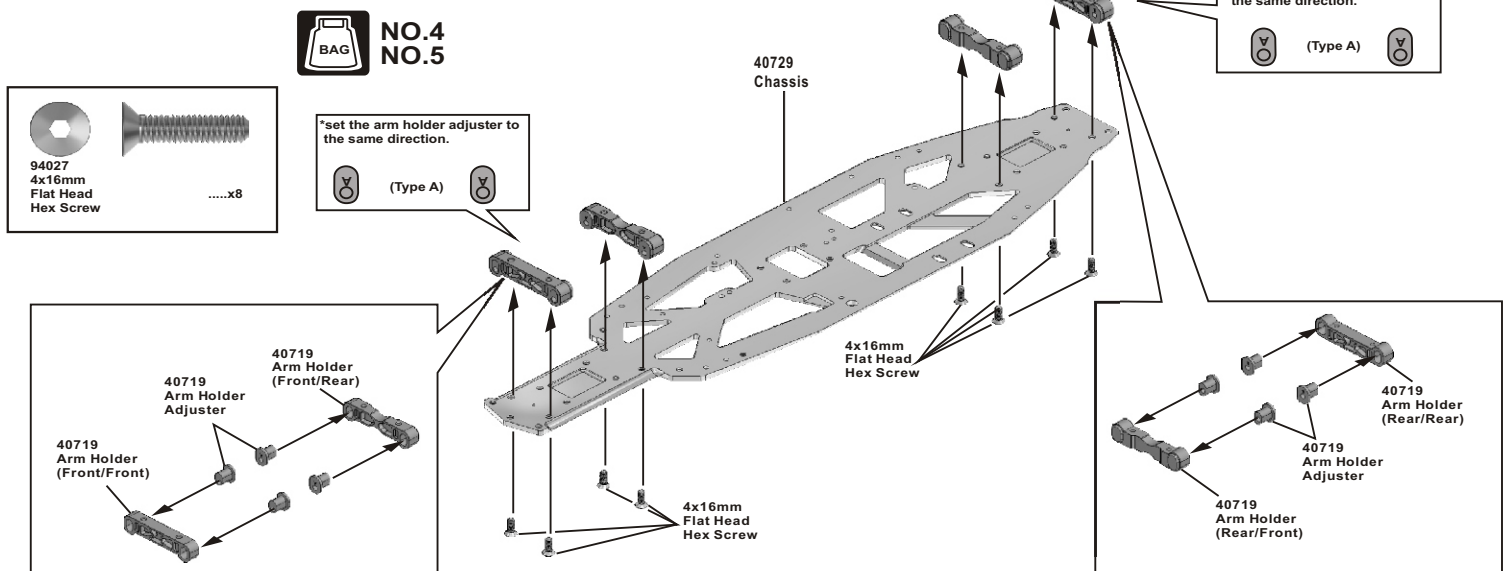

24 ASSEMBLY OF THE FRONT LOWER ARMS



NO.6

Step 1

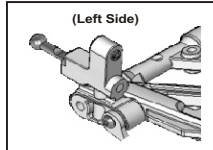
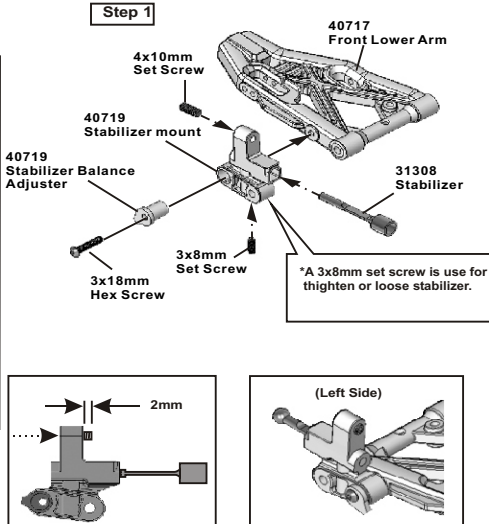
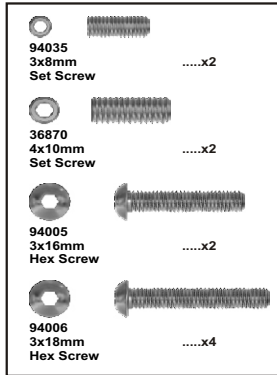

Step 2

Assembly of the right and left hand side are the same.

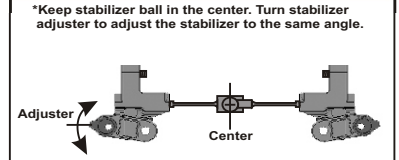
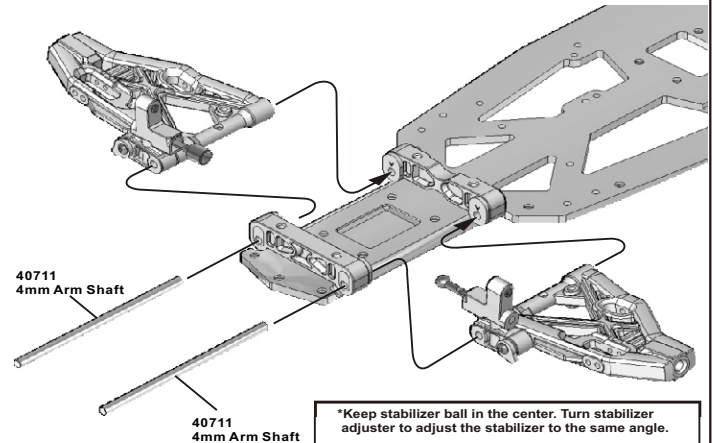

25 ASSEMBLY OF THE REAR LOWER ARMS



NO.6

Step 1

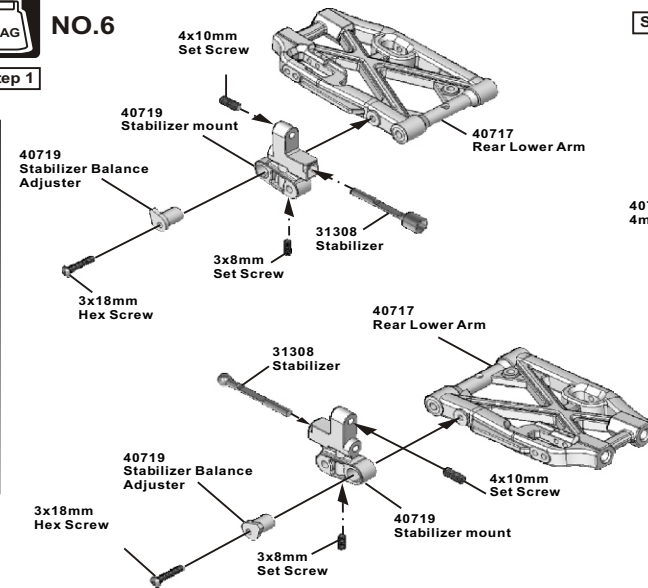
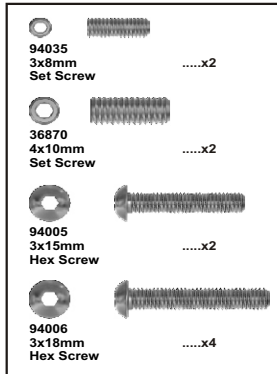

Step 2

Assembly of the right and left hand side are the same.

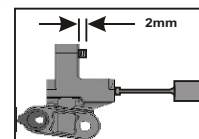
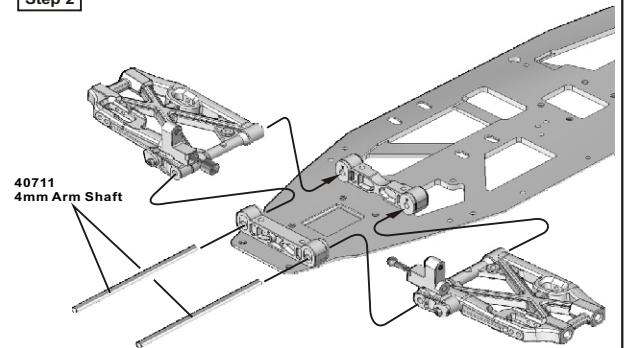

26 ASSEMBLY OF THE FRONT AND REAR GEAR BOX ONTO THE CHASSIS



NO.3
NO.5
NO.6

Step 1

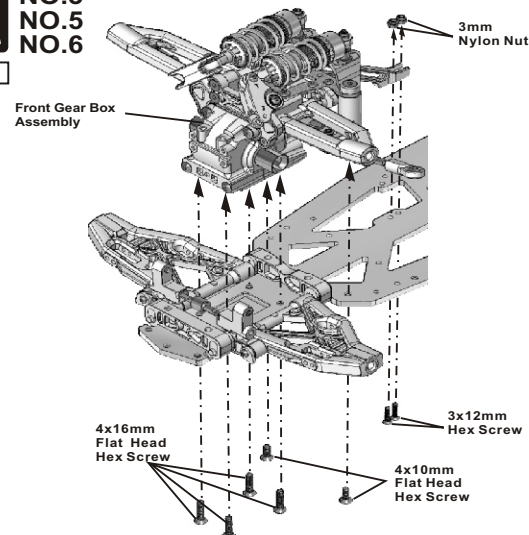
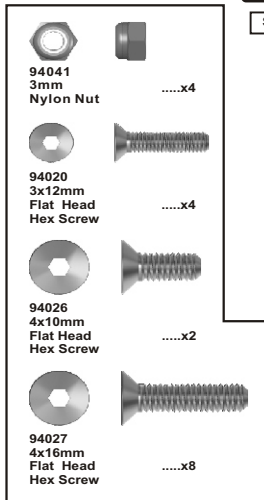

Step 2

3mm Nylon Nut

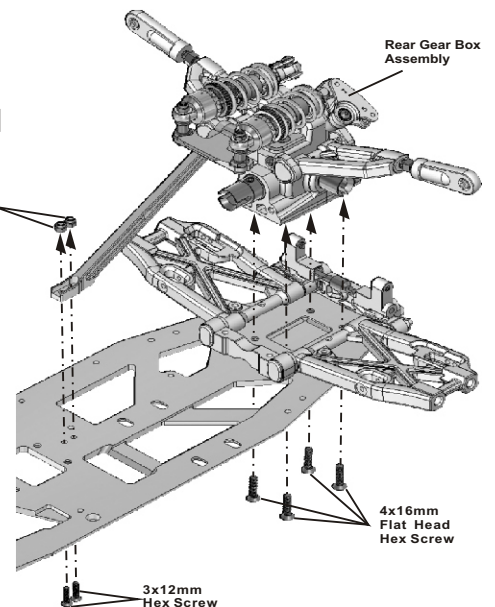

27 ASSEMBLY OF THE FRONT KNUCKLE ARMS

Assembly of the right and left hand side are the same.



NO.6

Step 1

*Notice the direction of the plastic washer.

Step 2

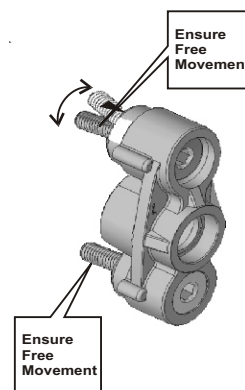
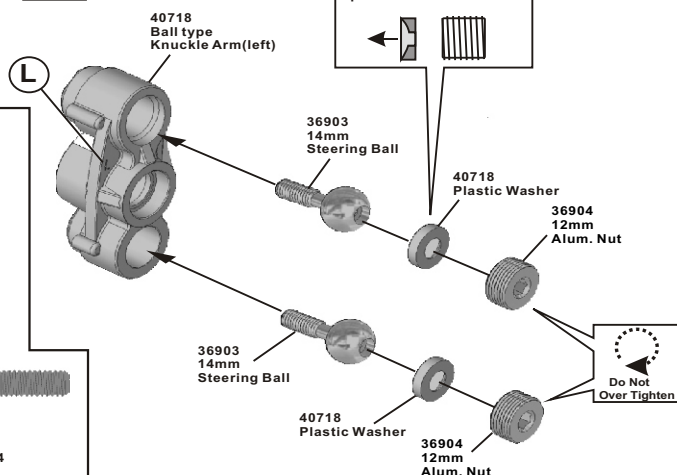
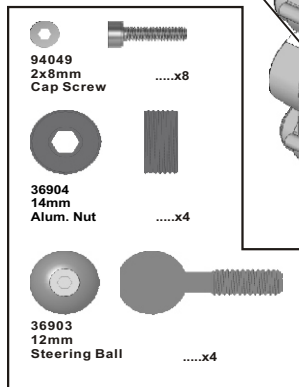

28 ASSEMBLY OF THE FRONT KNUCKLE AND FRONT SUSPENSION ARMS

Assembly of the right and left hand side are the same.



NO.3
NO.6
NO.12

Step 1

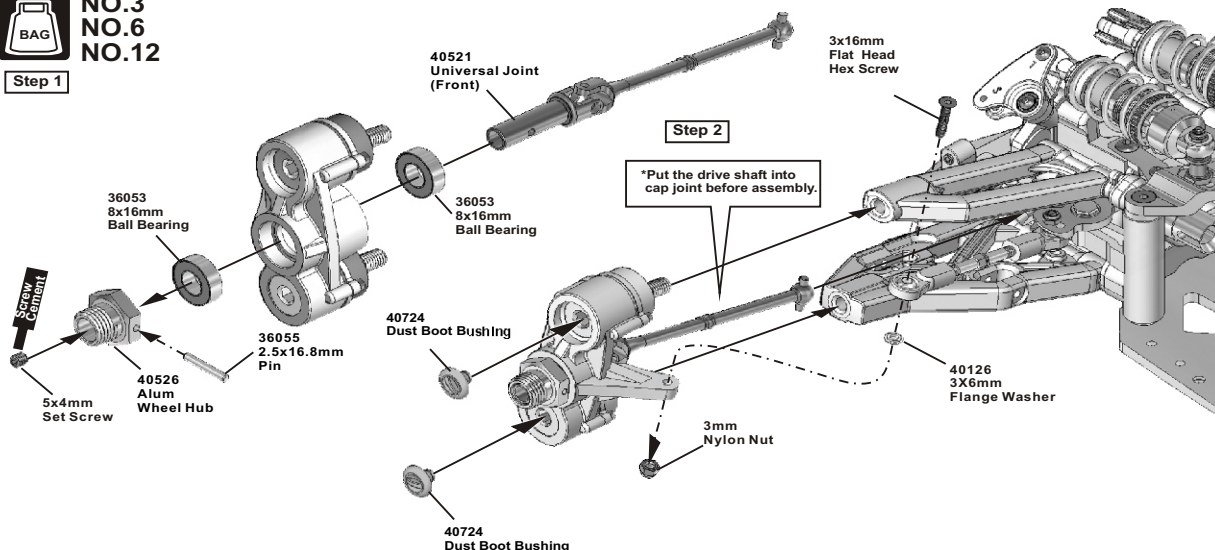
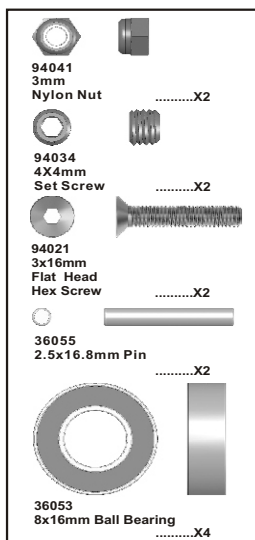

29 ASSEMBLY OF THE REAR WHEEL HUB

Assembly of the right and left hand side are the same.



NO.6
NO.12

Step 1

Step 2

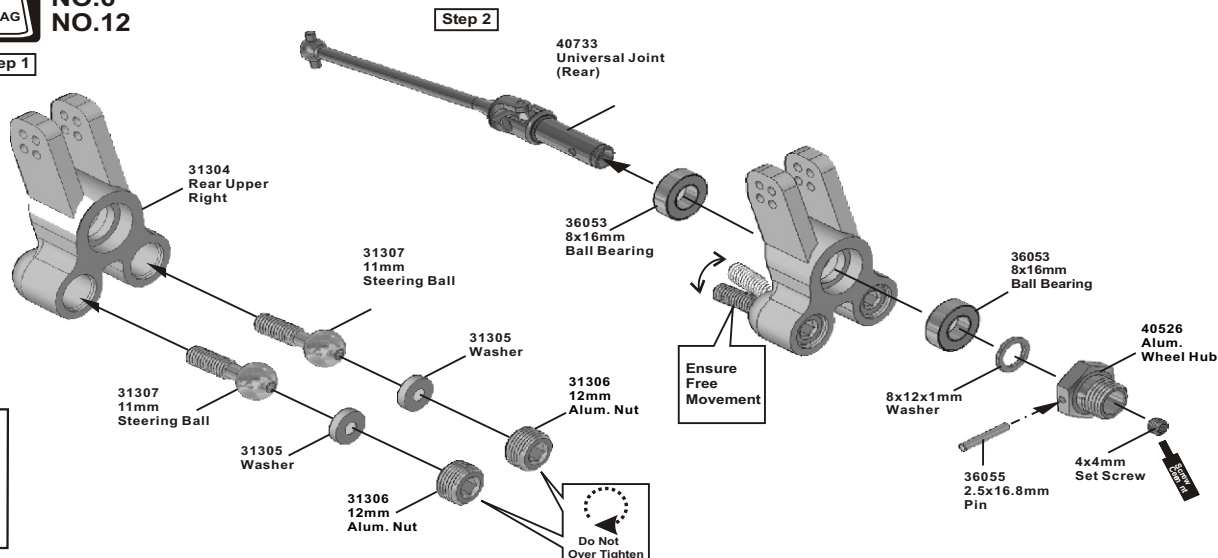
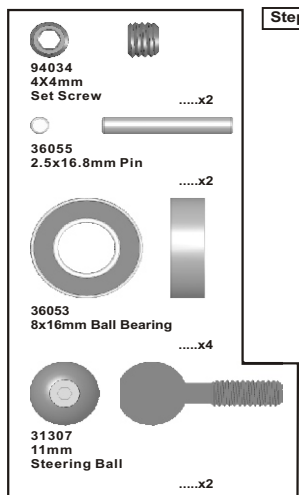

30 ASSEMBLY OF THE REAR SUSPENSION ARMS

Assembly of the right and left hand side are the same.



NO.6



*Insert the drive shaft before assembly.

3x25mm Hex Screw

3mm Nylon Nut

31 ASSEMBLY OF THE FRONT PUSH RODS

Assembly of the right and left hand side are the same.



NO.6

Step 1

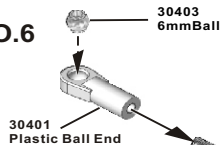

40712 3.5x48mm Turnbuckle

30401 Plastic Ball End

30403 6mm Ball

Step 2

3x12mm Hex Screw

3x20mm Hex Screw

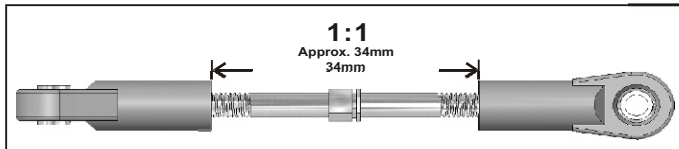

32 ASSEMBLY OF THE REAR PUSH RODS

Assembly of the right and left hand side are the same.



NO.6

Step 1

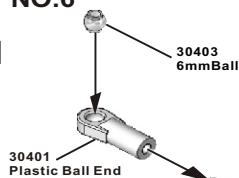

40712 3.5x48mm Turnbuckle

30401 Plastic Ball End

30403 6mm Ball

Step 2

3x12mm Hex Screw

3x20mm Hex Screw

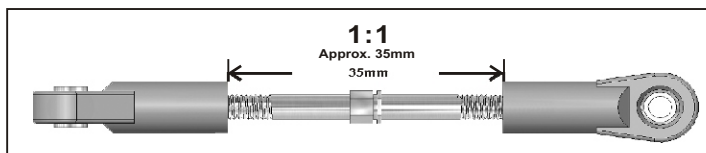

33 ASSEMBLY OF THE TWO SPEED TRANSMISSION ONTO THE CHASSIS

BAG NO.7



94026
4x10mm
Flat Head
Hex Screw
.....x4

*Insert drive shaft into
cap joint before assembly
two speed onto chassis.

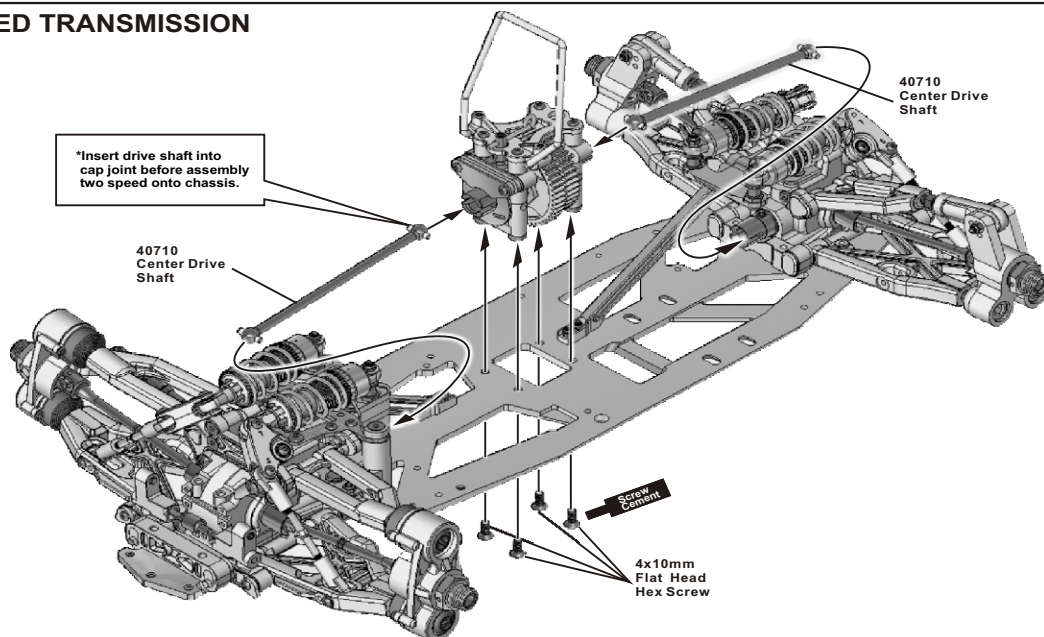

34 ASSEMBLY OF THE CLUTCH

BAG NO.10

* Only use the 10091 pilot shaft for threaded crank
shaft engine.

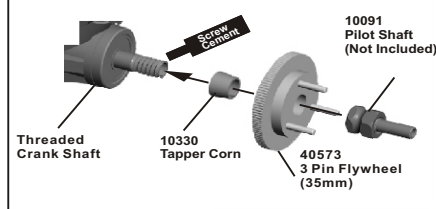

Step 1

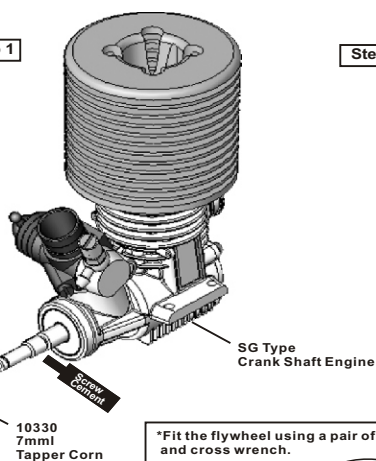

Step 2

*Place the clutch shoes with the clutch
springs over the 3 pins of the flywheel.
*Using a phillips screw driver or needle
nose pliers and bend the small end if the
clutch spring behind the pilot shaft
#174D or #180D than press down.

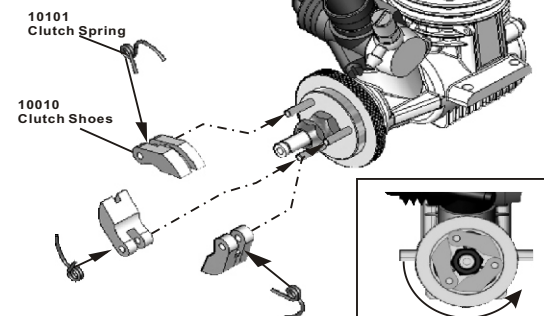

*Fit the flywheel using a pair of the plier
and cross wrench.

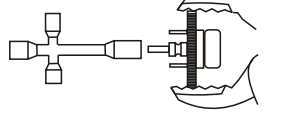

Engine rotation direction.

35 ASSEMBLY OF THE CLUTCH

BAG NO.10

10099
3x7mm
Washer
.....x1

10099
5x8x0.3mm
Washer
.....x3

35958
5x8mm
Ball Bearing
.....x1

34110
5x10x4mm
Ball Bearing
.....x1

10099
3x5mm
Cap Screw
.....x1

Step 1

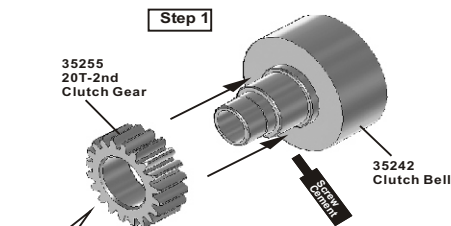

Step 2

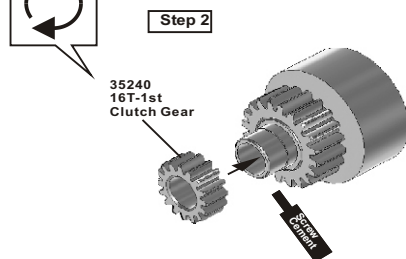

Step 3

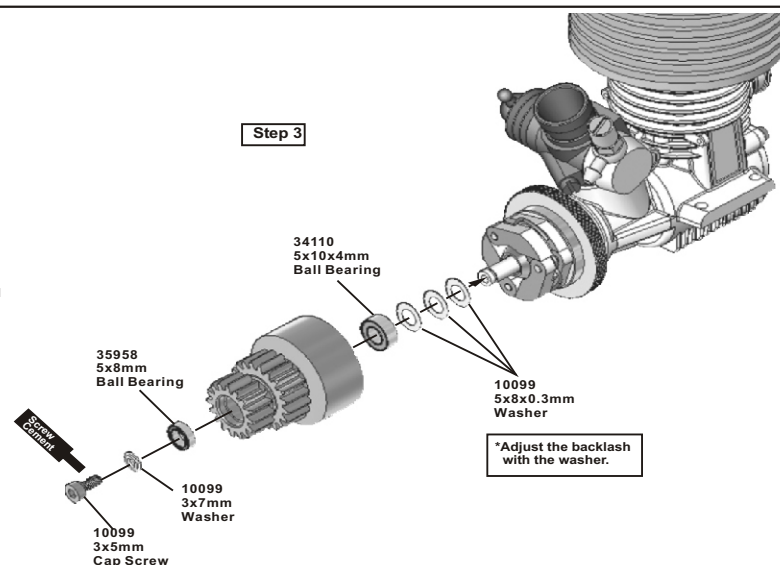

36 ASSEMBLY OF THE MANIFOLD AND MUFFLER



NO.10

Step 1

3x12mm
Cap Screw

Screw
Cement

Step 2

Manifold(Optional)

Not
Included

Not
Included

97501
1/8 Silicone
Seal(Optional)

Not
Included

*The muffler and manifold may not be
included in some kit.

Muffler(Optional)

Not
Included

Not
Included

97501
1/8 Spring

94038
3x12mm
Cap Screw

.....x4

40574
Low Profile
Engine Mount

37 ASSEMBLY OF THE ENGINE ONTO THE CHASSIS



NO.10

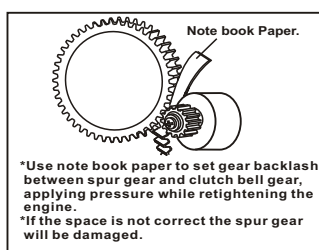

10114
5mm
Engine Mount
Screw

.....x4

10114
Engine Mount
Screw 5mm

Screw
Cement

38 ASSEMBLY OF THE MANIFOLD ONTO THE ENGINE



NO.10
NO.11

94034
4x4mm
Set Screw

.....x1

94036
5x5mm
Set Screw

.....x1

94039
4x10mm
Flat Head
Hex Screw

.....x1

4x4mm
Set Screw

Screw
Cement

10052
Muffler Stay

40050
Muffler Stay
Post

4x10mm
Flat Head
Hex Screw

Screw
Cement

5x5mm
Set Screw

Supplied with pipe
(Not Included)

10120
Manifold
Spring

97501
1/8 Silicone
Seal(Optional)

Not
Included

39 ASSEMBLY OF THE FUEL TANK ONTO THE CHASSIS



NO.3
NO.11

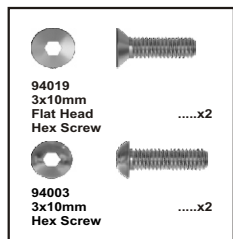

Step 1

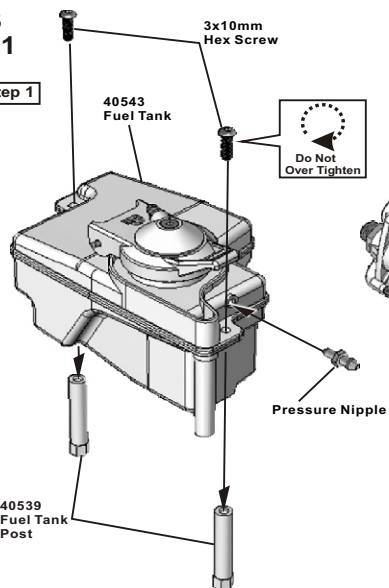

Step 2

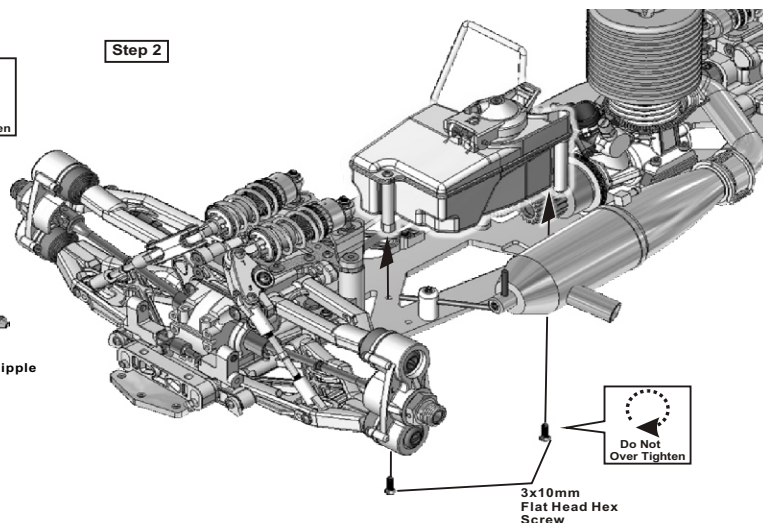

40 ASSEMBLY OF THE RADIO TRAY



NO.9

Step 1

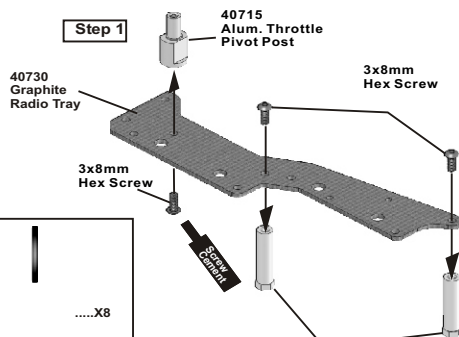

Step 2

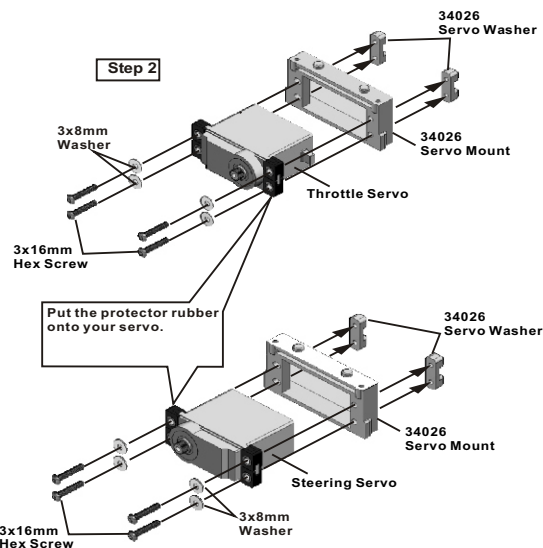

Step 3

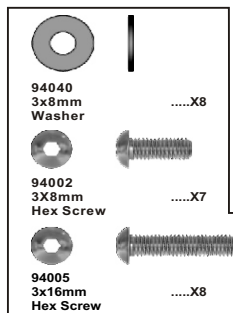
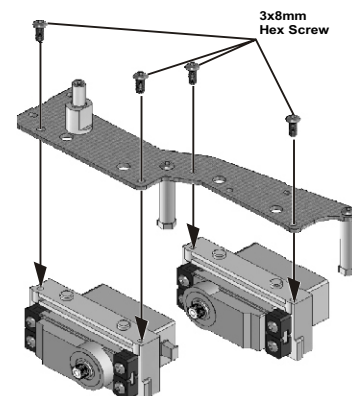

41 ASSEMBLY OF THE RADIO TRAY AND RECEIVER BOX



NO.9

Step 1

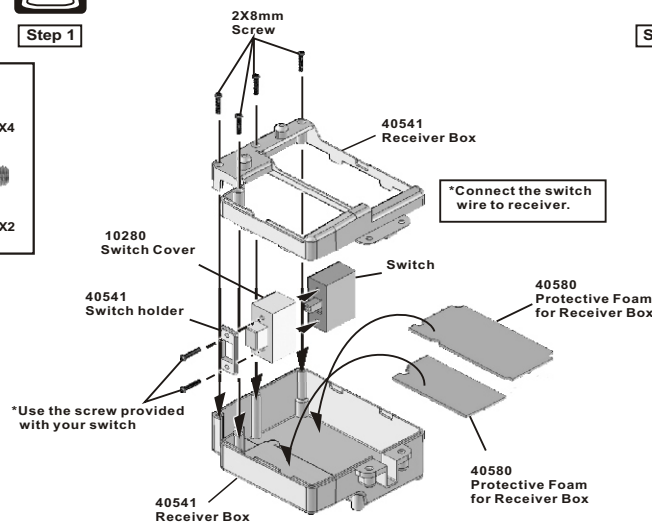
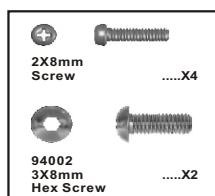

Step 2

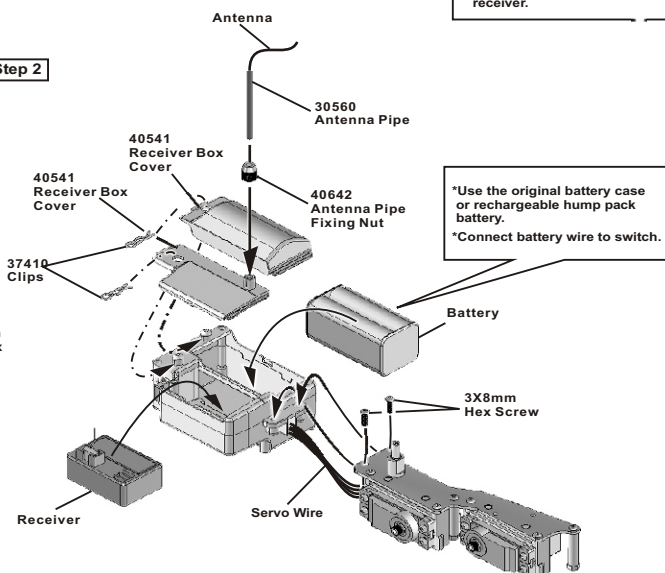

42 ASSEMBLY OF THE THROTTLE LINKAGE

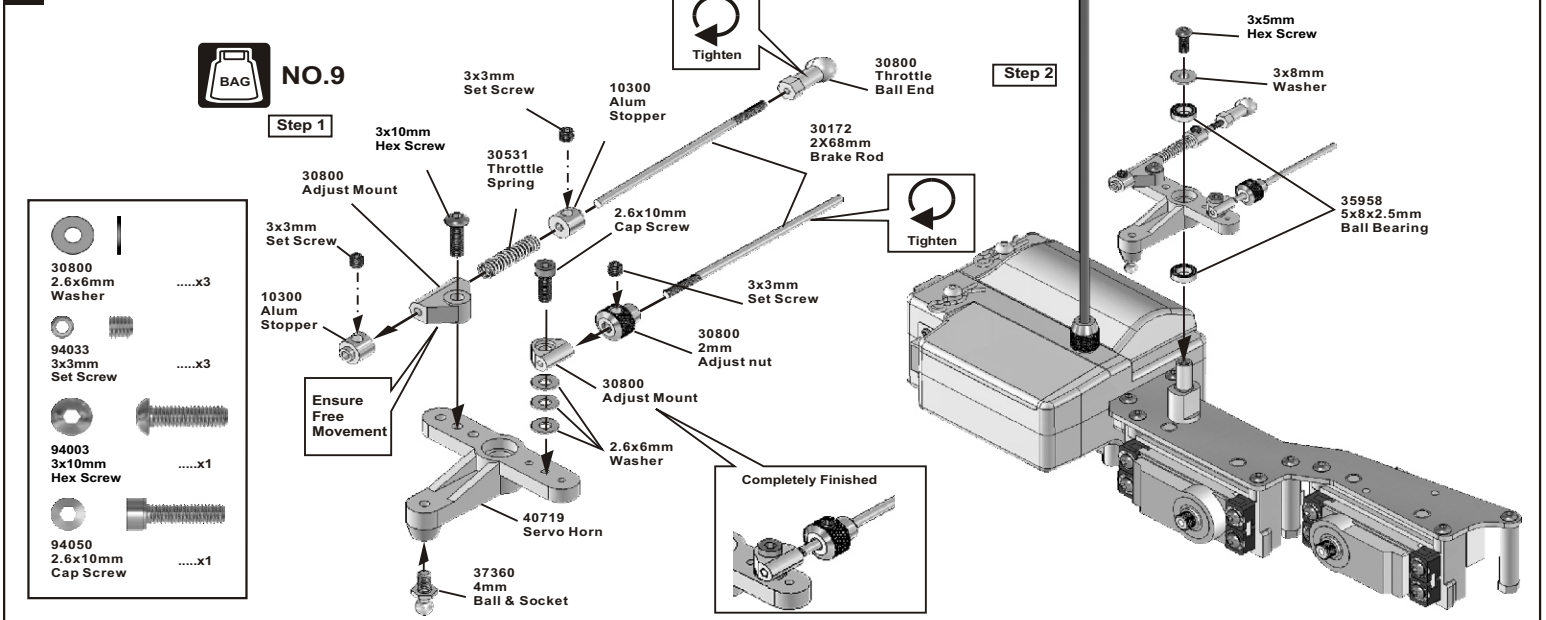

43 ASSEMBLY OF THE THROTTLE LINKAGE INTO SERVO

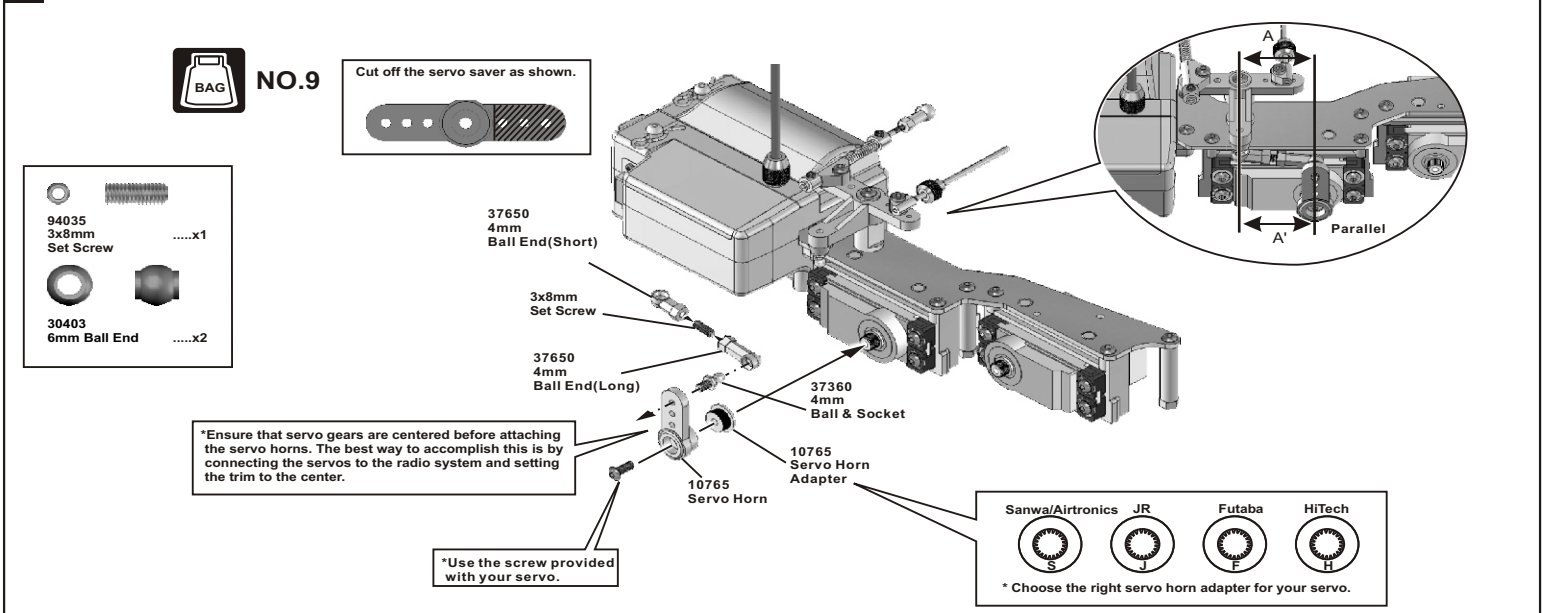

44 ASSEMBLY OF THE STEERING ROD AND RADIO TRAY ONTO THE CHASSIS

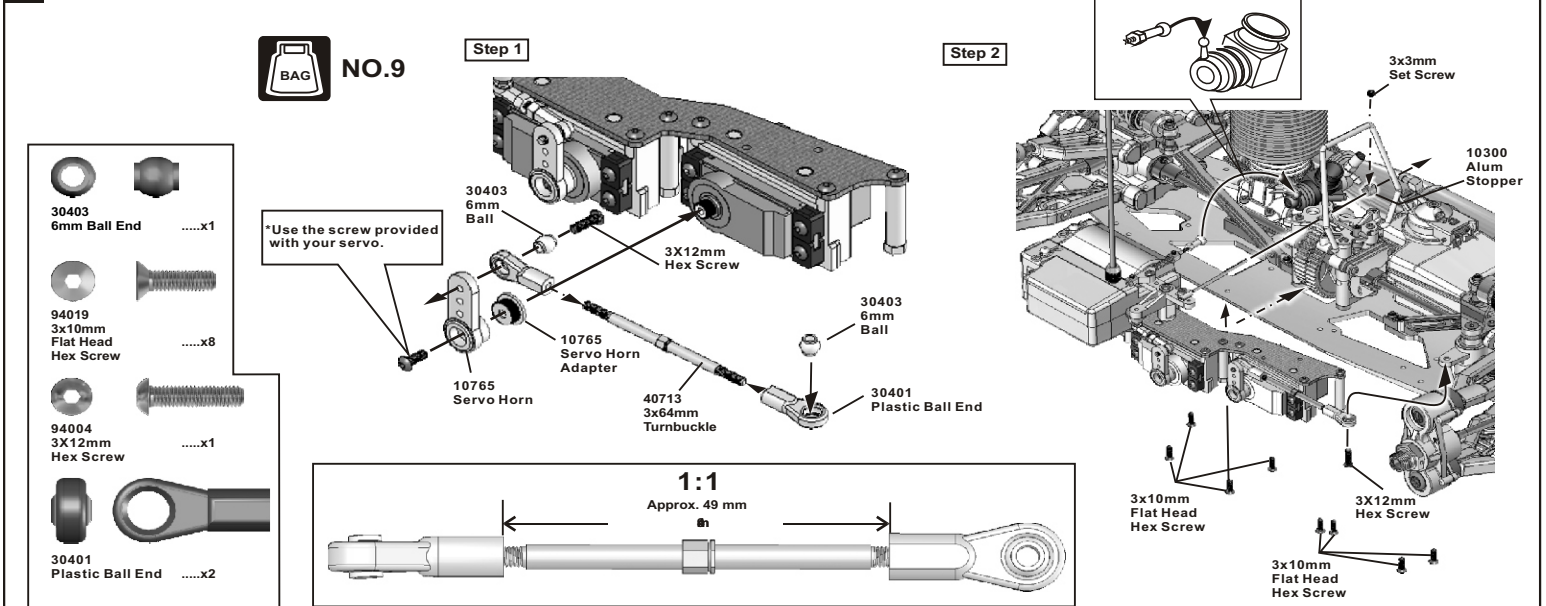

45 ASSEMBLY OF THE SIDE BODY POST



NO.8

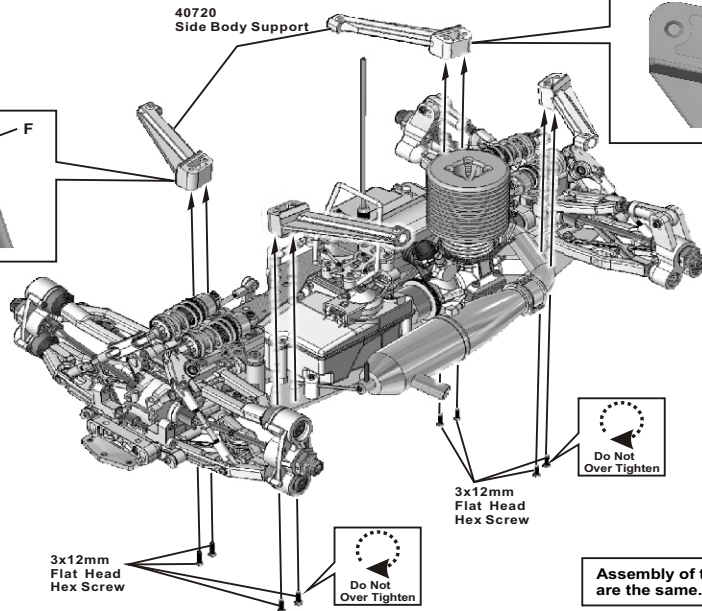
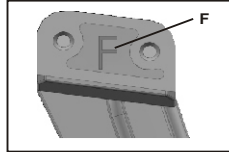
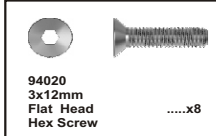

Assembly of the right and left hand side are the same.

46 ASSEMBLY OF THE SIDE IMPACT BUMPER & POST



NO.8

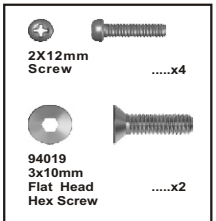

*Push onto side body post.

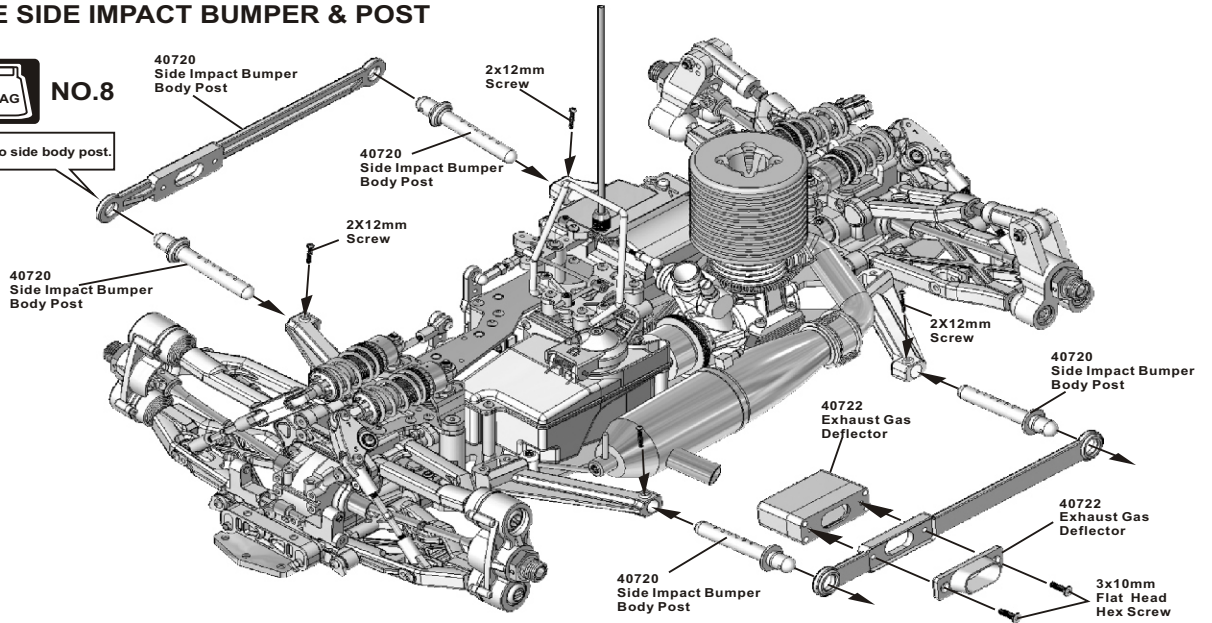

47 ASSEMBLY OF THE FRONT BUMPER



NO.8

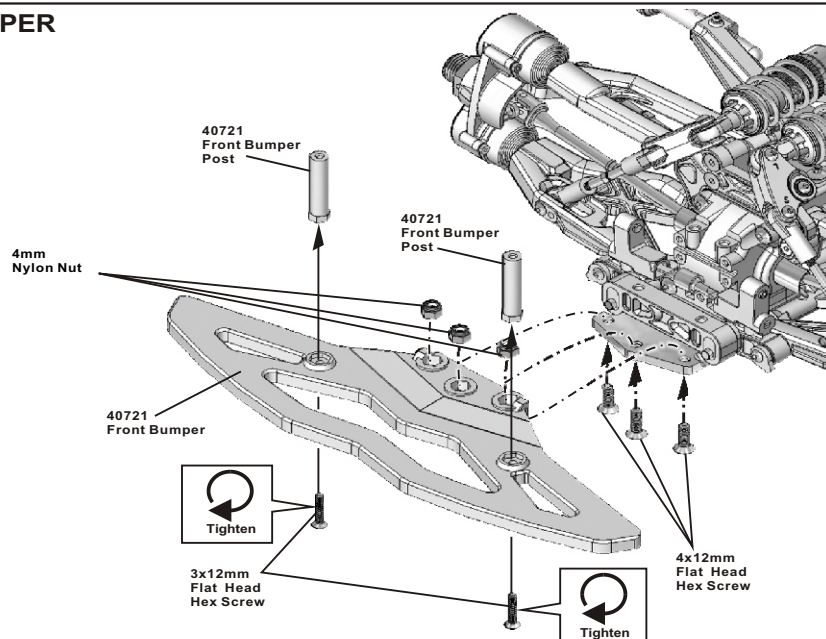
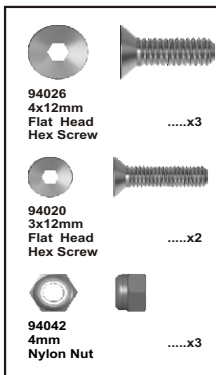

48 ASSEMBLY OF THE FRONT BUMPER



NO.8

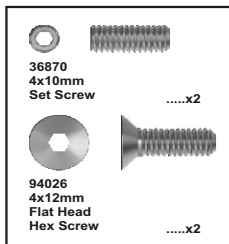

Step 1

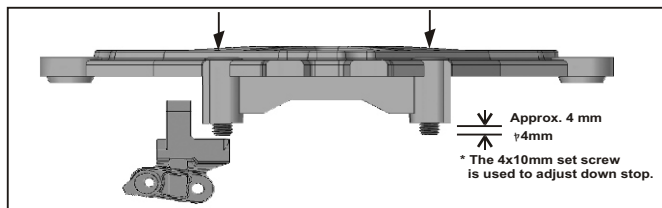
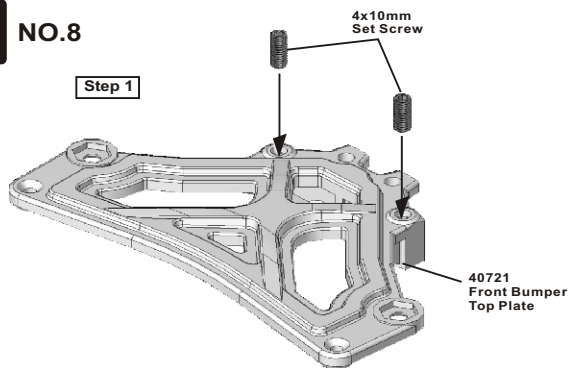

Step 2

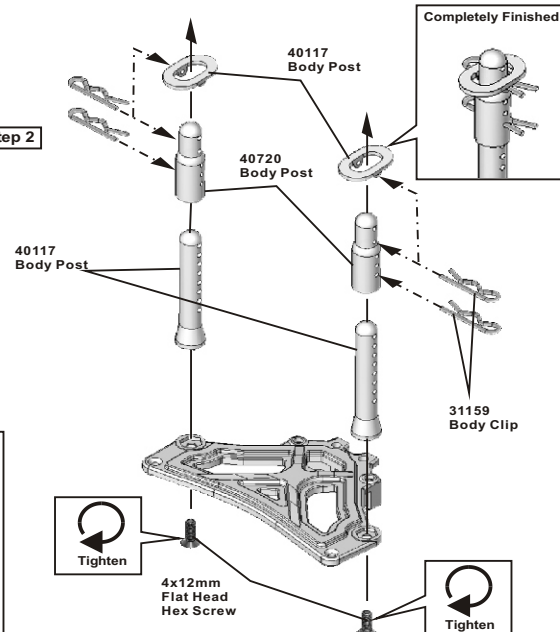

49 ASSEMBLY OF THE FRONT AND REAR BUMPER



NO.8

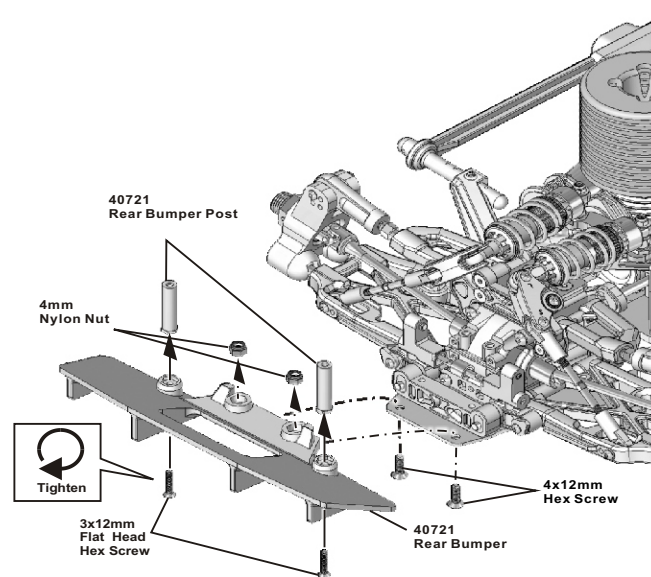
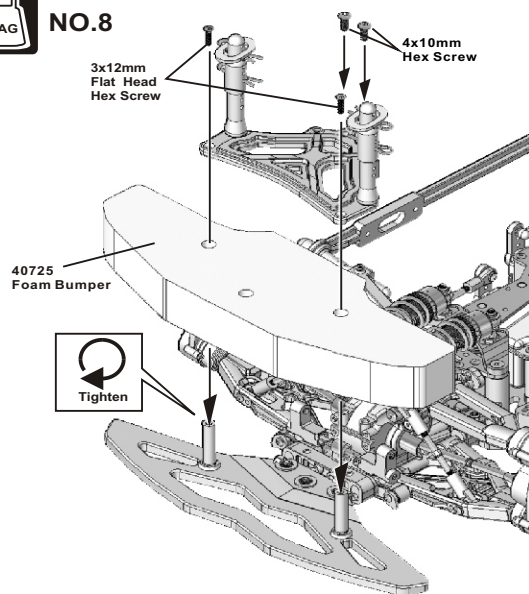
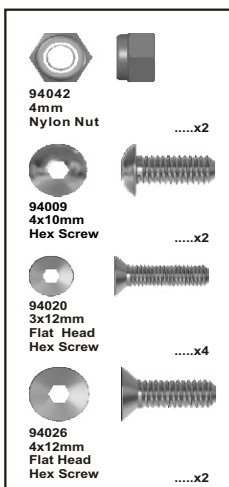

50 ASSEMBLY OF THE REAR BUMPER



NO.8

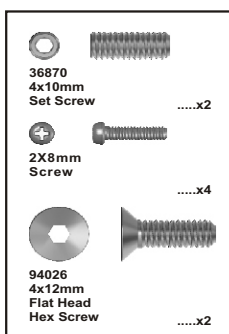

Step 1

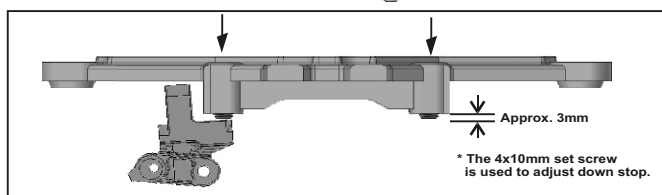
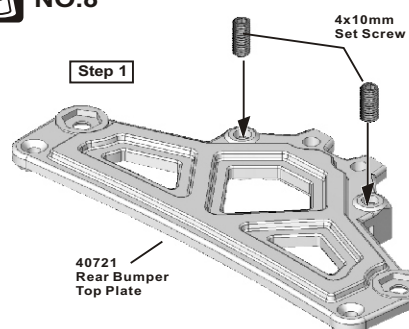

Step 2

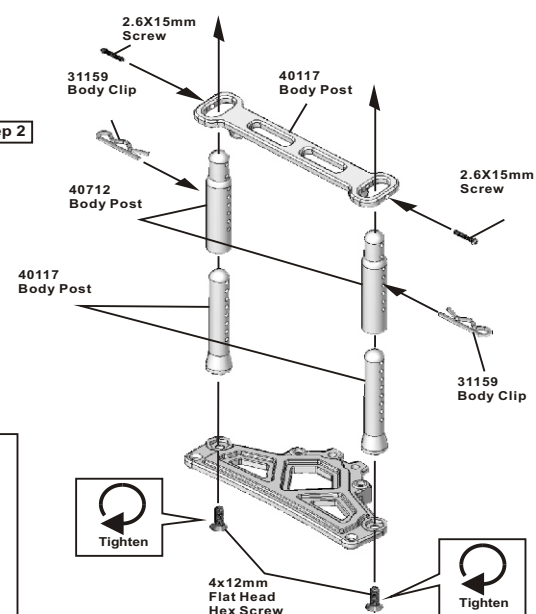

51 ASSEMBLY OF THE REAR EXHAUST PIPE DETAILS

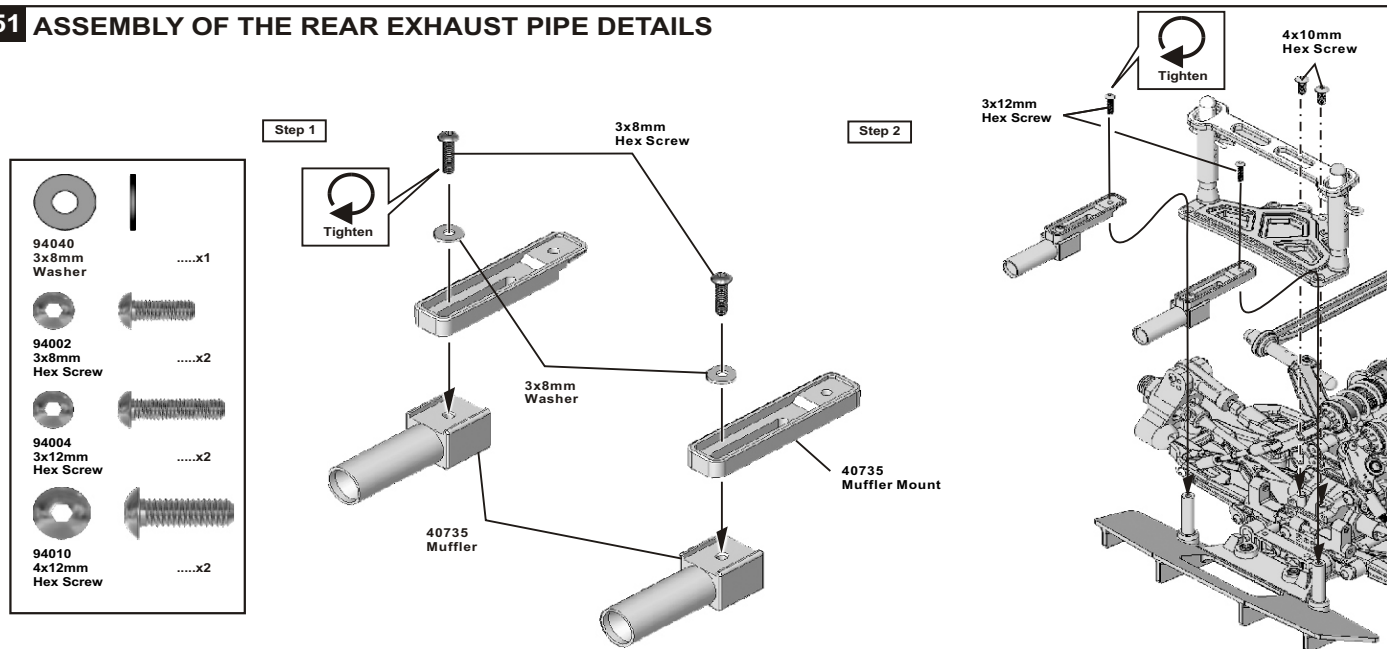

52 ASSEMBLY OF THE AIR FILTER

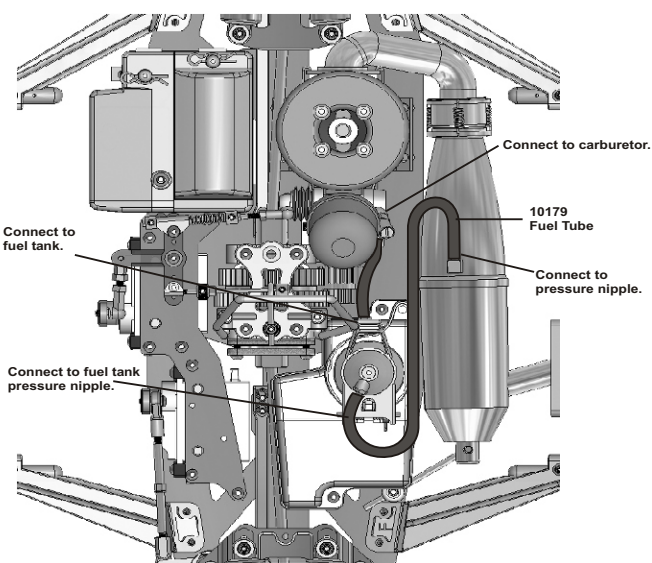
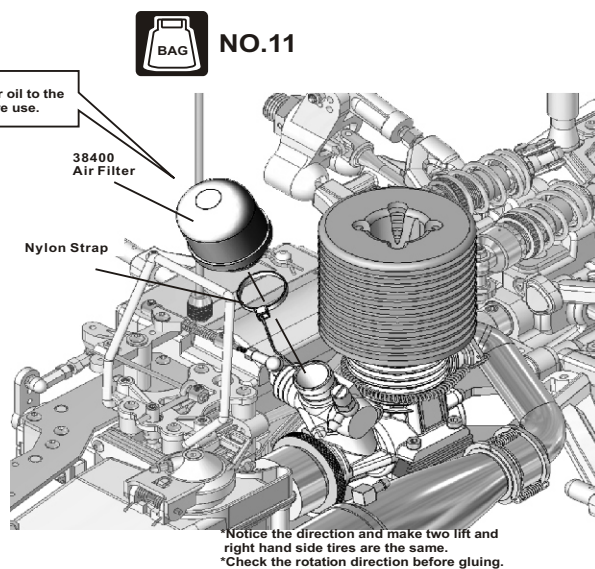

53 ASSEMBLY OF THE TIRES AND WHEELS

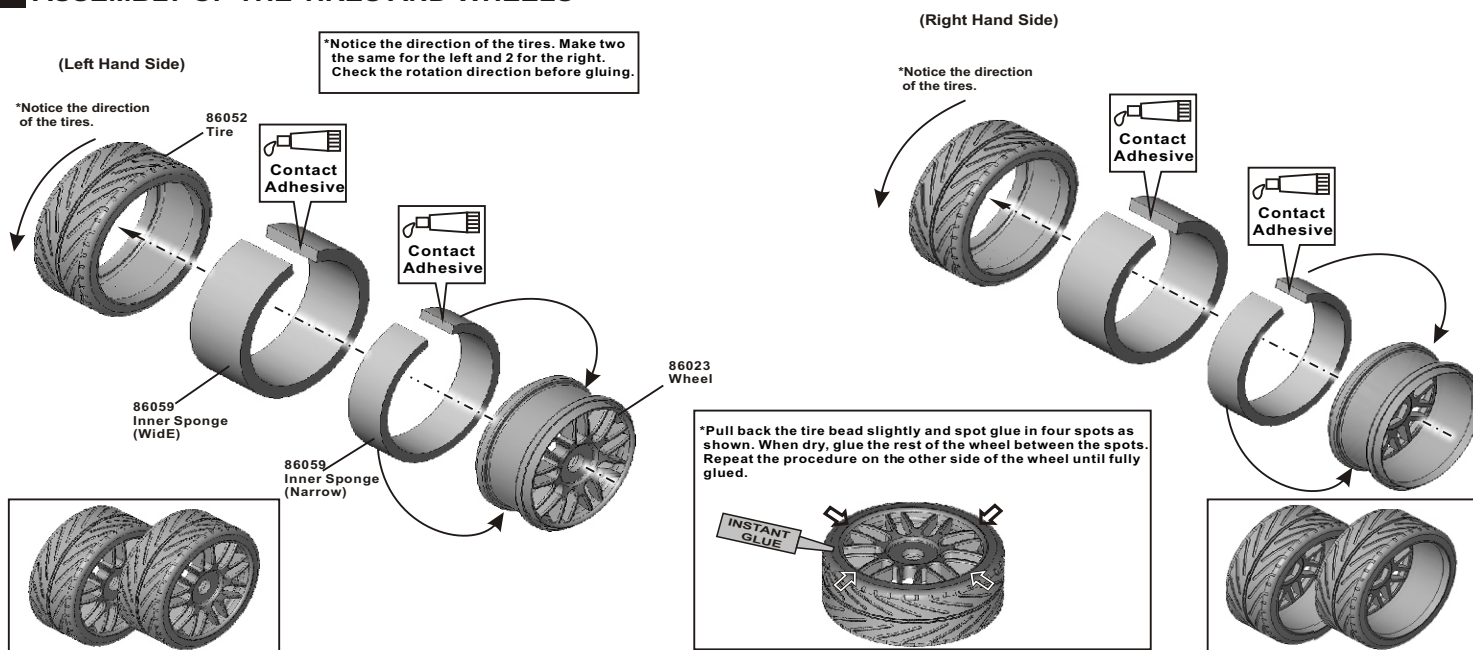

54 ASSEMBLY OF THE WHEELS ONTO THE FRONT KNUCKLE AND REAR HUB

Assembly of the right and left hand side are the same.

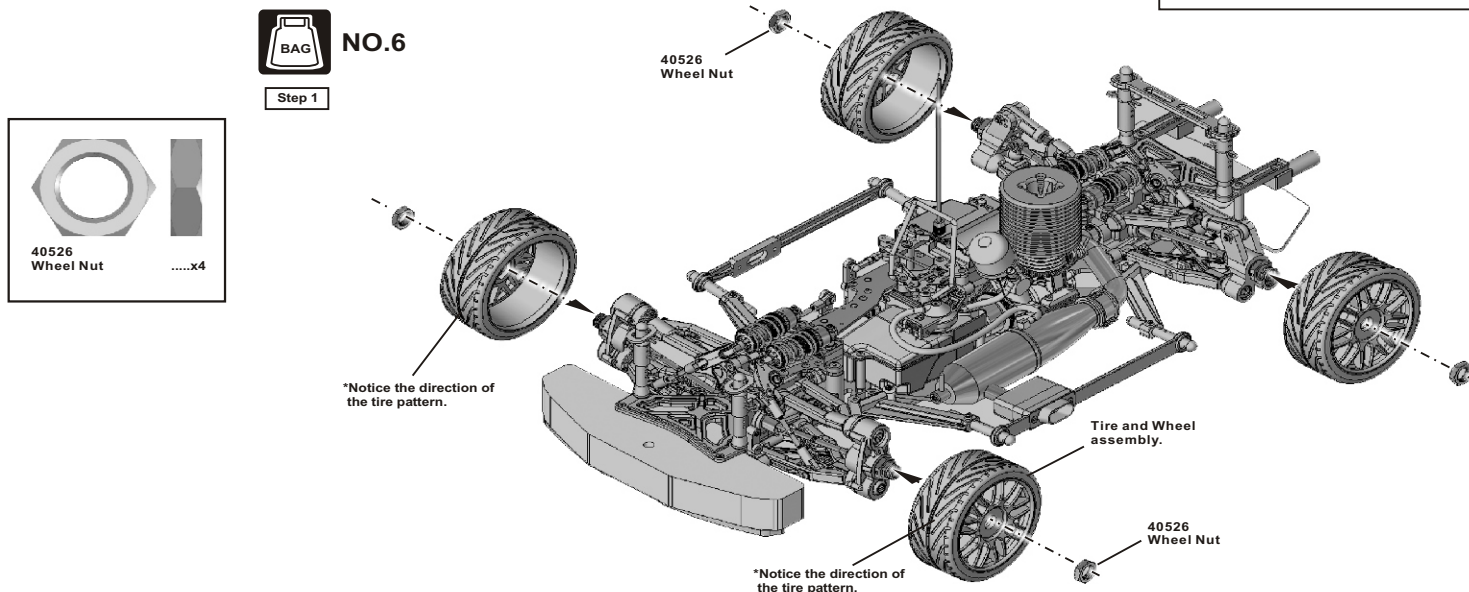

55 ASSEMBLY OF THE BODY AND PAINTING

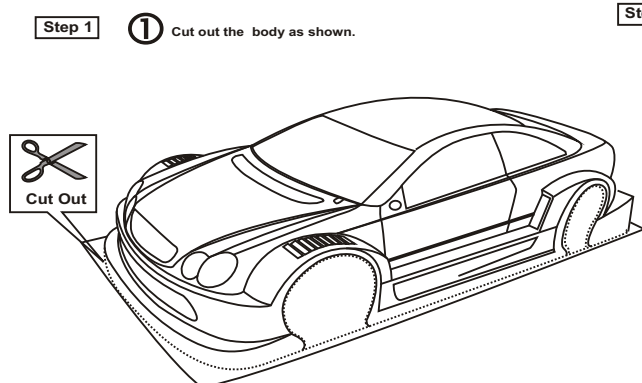

② Before cutting and making holes in the body, put the unpainted body on the chassis to confirm the mounting position and location for holes. Use body reamer or drill to make two 8mm holes in the front and two 8mm holes in the rear.

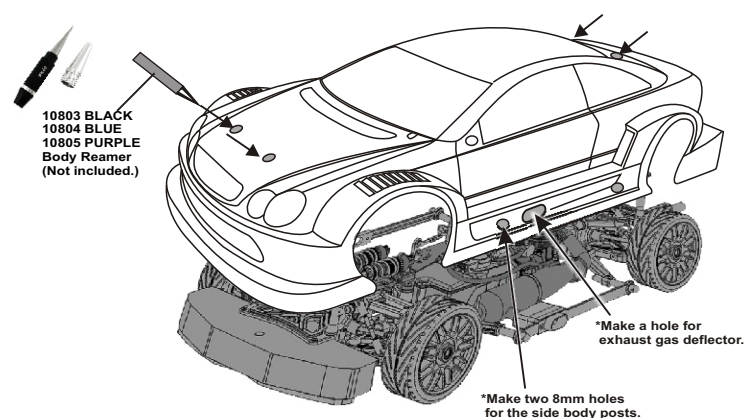

Step 3

③ Wash body with warm soapy water to remove any dirt and oil.

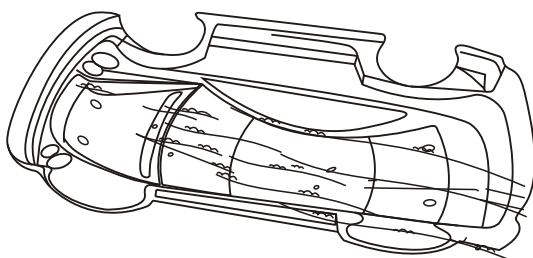

Step 4

④ Mask the windows from the inside with masking tape.

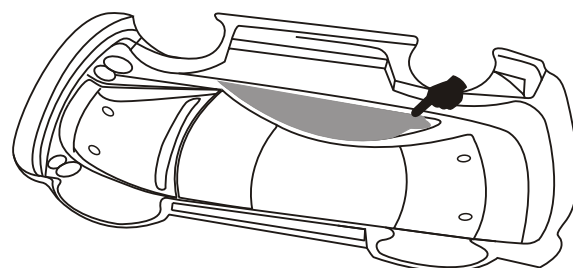

Step 5

⑤ Paint the body with polycarbonate spray paints.

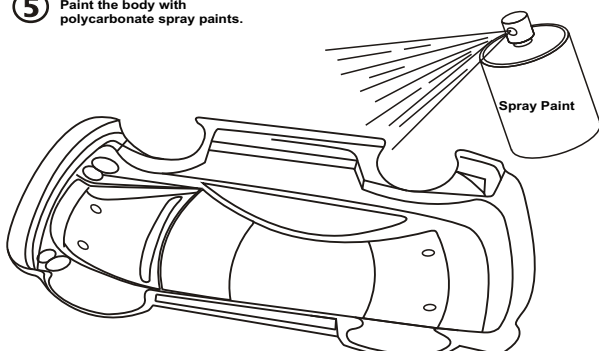

Step 6

⑥ Completely Finished.



56 ASSEMBLY OF THE REAR VIEW MIRRORS AND WIPERS

ボディボルト

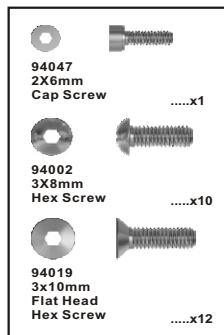

*Put the body clips from inside the body.

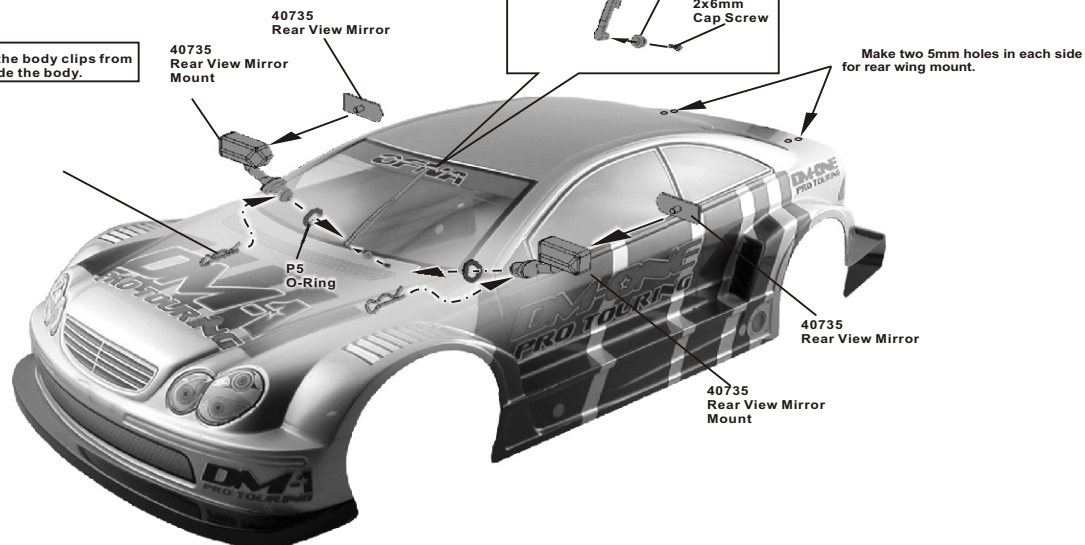

57 ASSEMBLY OF THE REAR WING

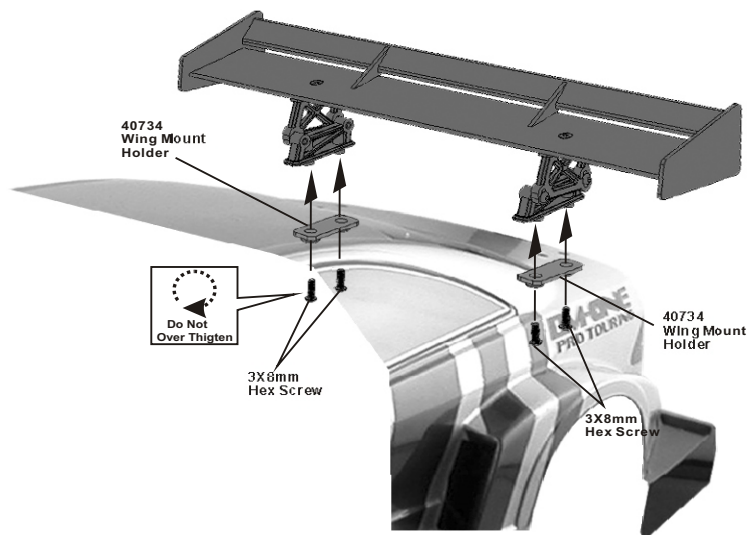
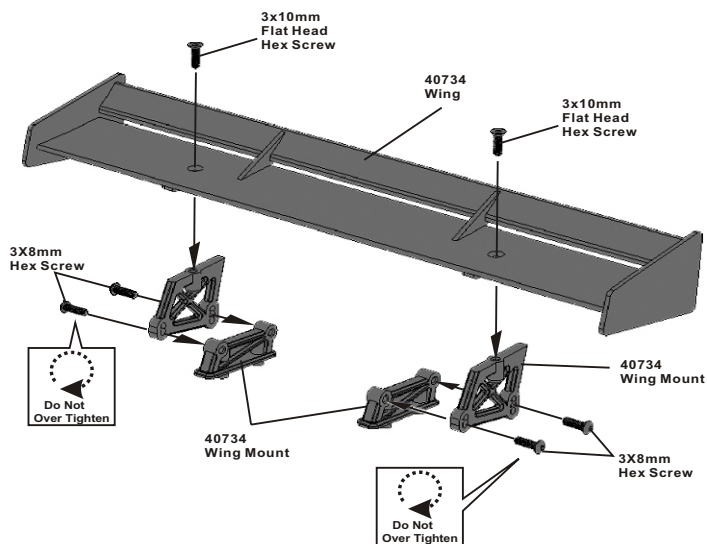

58 MOUNTING BODY



NO.8

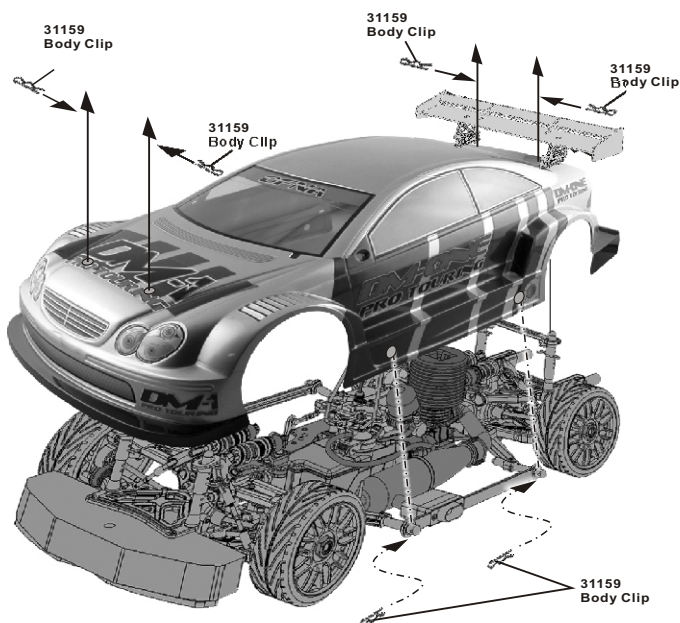

How to start the engine:

1. Turn on transmitter and then receiver.
2. Fill fuel tank with fuel bottle.
3. Connect 1.2V glow plug igniter .
4. Start engine with a 12V starter .
(Notice the direction of the starter.)
5. After the engine has started, remove the 1.2V glow plug igniter .

* Follow the engine manufacturer instruction manuals regarding engine set-up, carburetor and maintenance.

**A 12V Starter Box
(Not Included)**

10250 - Starter Box 1/8 scale
On/Off-Road.

Glow Plug (Not Included)

51007



Normal Plug

51006



Turbo Plug

*There are 2 types of glow plugs available "NORMAL" or "Turbo" depending on the type of the engine.

**1.2V Glow Plug Igniter and
Charger (Not Included)**

10215 - Glow Heater, Extra Long
W/Charger.

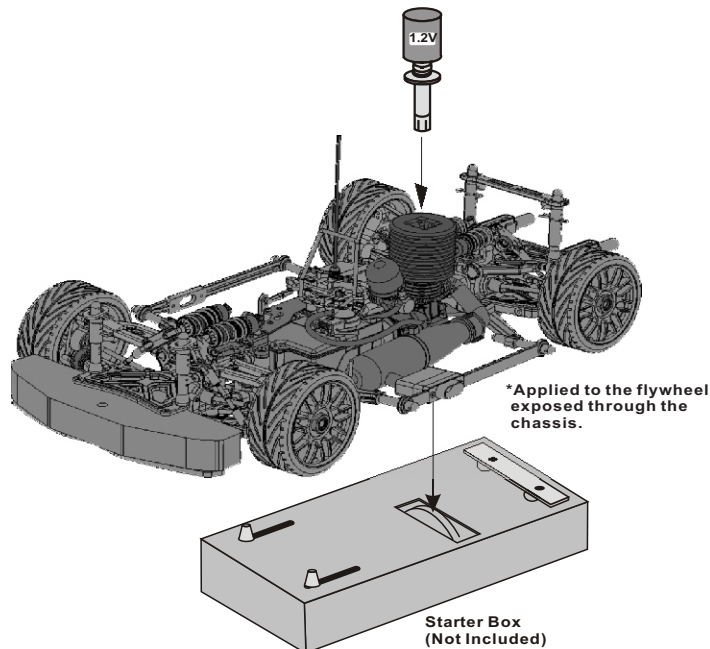
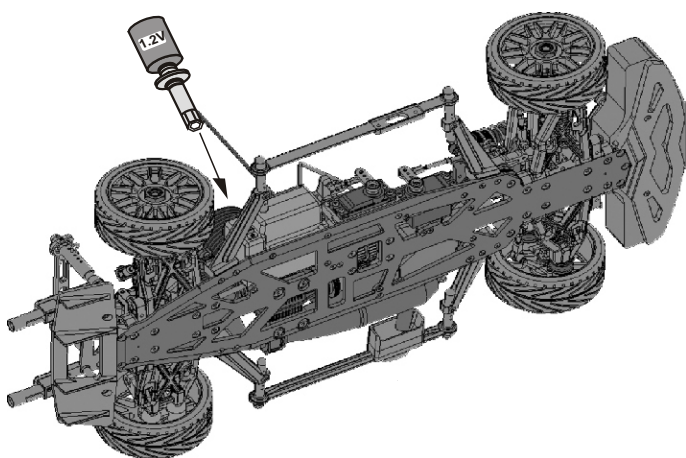

*To start the car, attach a glow plug igniter to the glow plug, and use either a 12V electric starter or starter box applied to the flywheel exposed through the chassis.

**ADJUSTING THE SHIFT POINT**

Adjust the engine before adjusting the clutch shift timing.
Adjust the engine as per engine instruction manual.

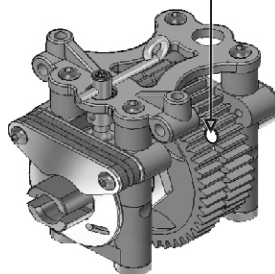
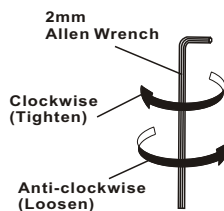
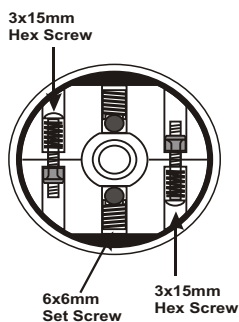
**SHIFT UP TIMING ADJUSTMENT**

1. Once the engine adjustments have been completed, proceed to the adjustment of the clutch shoe shift timing.
(Using a 2mm allen wrench to adjust the clutch shoe on either side.)

Note: Clockwise-----Shift timing will become later.
Counterclockwise---Shift timing will become quicker.

2. Adjust the clutch shift timing for your track conditions.
As you tighten (Clockwise) the 3x15mm screw, the shift timing will become slower.
As you loosen (Counterclockwise) the 3x15mm screw, the shift timing will become quicker.
3. Set the shift timing to the track conditions while the car is running.

2 SPEED GEAR RATION COMBINATIONS

2 speed transmission allows the car to have more punch out of the corners and higher top speed. We offer many different pinion and spur gear combinations which can be used for different tracks.

Spur Gear	Clutch Gear (4 tooth different)			Torque	Speed
	15T-19T	16T-20T	17T-21T		
49T/45T	←		→		
48T/44T					

SETTING GUIDE

FRONT TOE-IN AND TOE-OUT SETTING

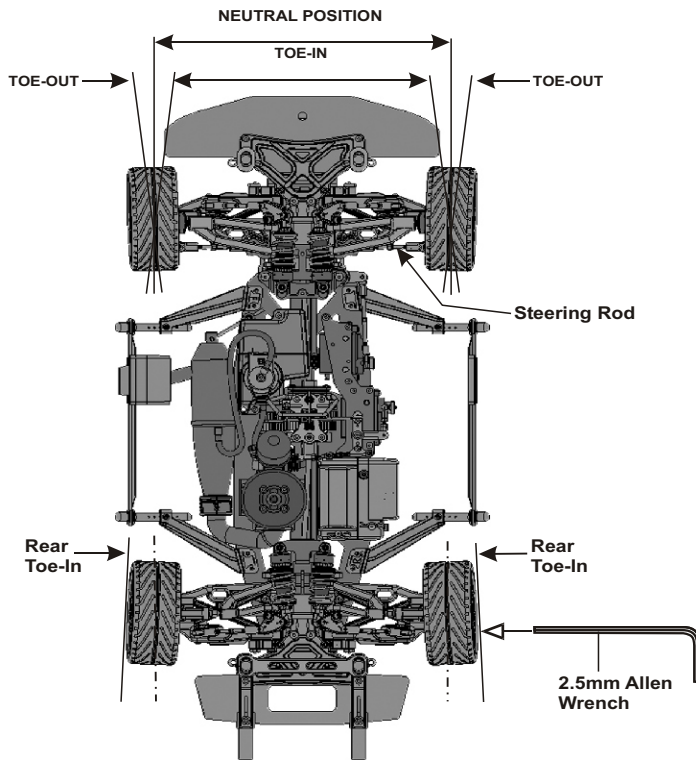

Use a 2.5mm allen wrench to adjust toe-in for front and rear.

(Front) Adjust the length of the front steering rod to change the toe angle.

Making the steering rod longer will make the front tires become toe-in.
Response will be slower and will over steer.

Making the steering rod shorter will make the front tires become toe-out.
Response will be quicker and will under steer.
We recommended adjusting the front toe-out to 1.5 degrees.

(Rear) Adjust the length of the rear hub (12mm ball/rear) to change the toe angle.

Making the 12mm ball longer will make the rear tires toe-in.
Response will be under steer.

Making the 12mm ball shorter will make the rear tires toe-out.
Response will be over steer.
We recommended adjusting the rear toe-in is 2 degrees.

FRONT AND REAR CAMBER ANGLE SETTING

Note: Place the model car on a flat surface. Raise the chassis to it's maximum clearance before the wheels leave the ground.
Adjust the length of the front and rear upper arms so that the wheels are right angles to the ground.

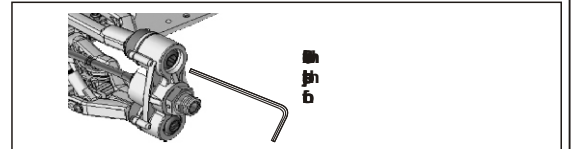

(FRONT)

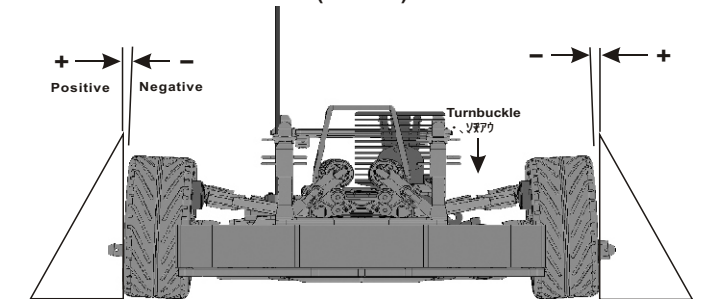

The front camber adjustment can be made by moving the 14mm steering ball at the front upper arms on knuckles, clockwise or anti-clockwise.
We suggest using 1.5 degree of negative camber for the front.

(REAR)

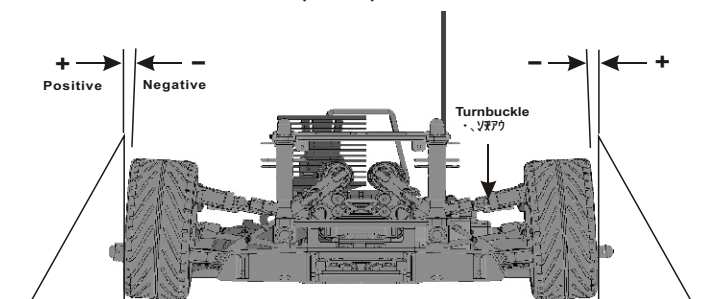

Adjust the length of the turnbuckle on the rear upper arms can be change the rear camber.
We suggest using 2 degree of negative camber for the rear.

FRONT AND REAR SHOCK ANGLE SETTING

(FRONT)

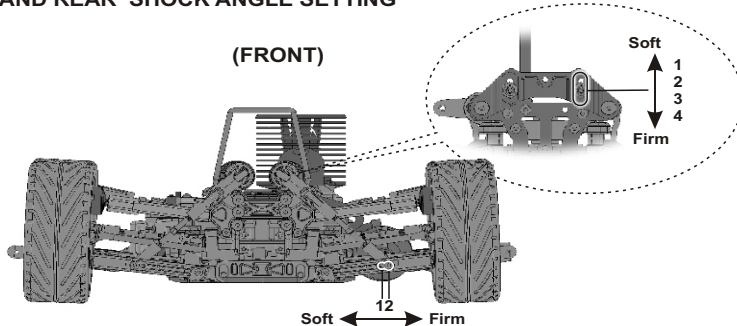

Firm front suspension, less steering.
Soft front suspension, more steering.

(REAR)

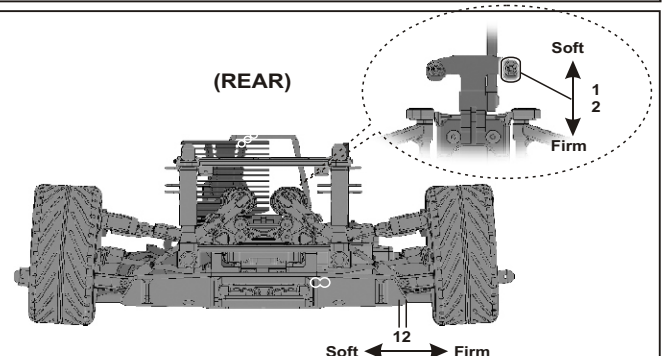

Firm rear suspension, over steering.
Soft rear suspension, under steering.

BLANK

DM1-PRO PARTS LIST

OFNA	Description	RETAIL	OFNA	Description	RETAIL
30171	Brake Lever	1.95	40519	Cap Joint	9.95
30172	Brake Rod	1.50	40521	Universal Joint, Front	44.95
30401	6mm Ball End (Plastic)	2.95	40525	Rear Lower Arm Shaft (3x48.1mm)	6.95
30403	6mm Ball & Socket	4.95	40526	17mm Wheel Hub	11.95
34110	Ball Bearing 5X10X4	6.95	40550	17mm Wheel Nut	4.95
30531	Throttle Spring	2.95	40531	Shock Ball End Post/one- piece/Top	9.95
30560	Antenna Pipe	2.95	40533	Gear Case	11.95
30776	4x10x0.2 Washer	1.95	40537	Front Upper Arms	6.95
30800	2mm Brake Adjust Nut	6.95	40538	Diff. Case (F&R)	9.95
30800	Throttle Linkage Plastic	6.95	40539	Servo Saver & Center Bracer	11.95
30773	4mm Cross Pin	3.95	40541	Receiver Box	14.95
40117	1/8 Truck Body Mount	10.95	40543	Fuel Tank	16.95
86052	1/8 Radial Tire	19.95	40546	Front Arm Shaft 3x42.7mm	11.95
34026	Servo Fixing (Lay down)	7.95	40547	Brake Cam	8.95
40710	Center Drive Shaft 120mm	19.95	40548	M3 Nylon Nut (Thin Type)	1.95
40711	4x90mm Arm Shaft	7.95	40568	Graphite Front Plate	31.95
40712	3.5x48mm Turnbuckle	9.95	40573	3-pin Flywheel, 35mm	19.95
40713	3x64mm Turnbuckle	9.95	40574	Engine Mount (Lowere Type)	18.95
40714	Center Handle Bar	3.95	40580	Protect Foam for Receiver Box	1.95
40715	Throttle Connecting Alum. Post	7.95	40643	Plastic Shock Parts Set	9.95
40716	Rear Upper Arms	9.95	40694	CNC 7075 Chassis Brace, F&R	59.95
40717	Front & Rear Lower Arms	19.95	30401	Plastic Parts Set for Damper	2.95
40718	Ball Type Knuckle Arms (L&R)	19.95	31159	Body Clips	4.95
40719	Arm Holder Plastic	15.95	10120	Manifold Spring	4.95
40720	Body Side Bumper	9.95	10280	Switch Cover, red	3.95
40721	Front & Rear Bumper	19.95	10300	Alum. Stopper	4.95
40722	Exhaust Connector	7.95	10179	Fuel Tube (45cm)	1.95
40723	Dust Proofer Cover	7.95	10270	Fuel Tube Clips	3.95
40724	Rubber Bushing for Hex Screw	4.95	10010	3 Shoe Clutch carbon	13.95
40725	Foam Bumper	14.95	10101	Clutch Spring	4.95
40726	M.Benz CLK DTM Body, clear	79.95	10098	Pilot Shaft, SG Type	4.95
40727	Nissan G35 Body, clear	79.95	10114	Engine Mount Screw, 5mm Hex	7.95
40728	Porsche Carrera GT Body, clear	79.95	35958	5x8x2.5 Ball Bearing	3.95
40729	CNC 7075 Chassis	179.95	10330	Cone, 7mm Brass Tapper	2.95
40730	Graphite Radio Tray	39.95	36053	8x16 Ball Bearing	12.95
40731	CNC Alum Shock Stay, F	39.95	36055	2.5x17 Pins	3.95
40732	CNC Alum Shock Stay R	39.95	30212	5x8x2.5 Frange Bearing	5.95
40733	Universal Joint, Rear	59.95	35225	1st Spur Gear Holder (one-way)	26.95
40734	Wing & Wing Stay Unit	12.95	35228	Alum. Nut (anti-clockwise)	2.95
40735	Real Muffler & Back Mirror	14.95	35230	8 x 12 Flange Bearing	12.95
37360	4mm Ball & Socket	4.95	35248	48T 1st Spur Gear	7.95
37410	Body Pin (S)	3.95	35244	44T 2nd Spur Gear	7.95
37650	4mm Plastic Ball Joint	6.95	35240	Clutch Gear (1st) 16T	11.95
40126	3x6x2.5 Flange Washer	3.95	35255	Clutch Gear (2nd) 20T	11.95
36700	Steering 7mm Ball	6.95	35242	Clutch Bell	24.95
36742	Servo Saver Bushing	1.95	86059	GTP Inner Sponge (L&S)	9.95
36790	4x46 Turnbuckle	10.95	31308	Stablizer (Steel) (L&R)	10.95
36850	7mm Ball	3.95	31304	Rear Hub (Ball Type)	10.95
36861	5x35 Turnbuckle	6.95	31305	Plastic Washer for Ball	8.95
36903	Steering Ball 14mm	7.95	31306	12mm Alum. Hex Screw	8.95
36904	14mm Alum. Nut	9.95	31307	11mm Ball & Screw	8.95
40009	P-6 O-Ring	2.95	35234	2nd Spur Gear Clutch Bell	24.95
40010	2.5x13.8 pin	2.95	35219	Alum. Nut (clockwise)	2.95
40011	Diff. Gaskets	3.95	35236	Clutch Shoe	14.95
40024	Diff Bevel Gear Shim 13x16x0.2mm	2.95	35237	Spring	9.95
40500	Servo Saver Spring (Black)	3.95	35237	4mm Ball	9.95
40034	Alum. Servo Saver Ring Adjuster	5.95	35235	Clutch Shoe Carrier	5.95
40037	Steering Plate Hex Screws	5.95	35237	6x6mm Set Screw	9.95
40038	7mm Balls (Black)	9.95	10765	Universal Servo Horn	8.95
40040	Center Diff Mount (plastic)	4.95	40090	Shock Repair Kit	7.95
40060	M2.5 Nylon Nut	4.95	86023	1/8 Mesh Wheels (Black)	19.95
40050	Muffler Stay Post	6.95	38400	1/10 Air Filter	9.95
40065	Rear Upper Ball End	4.95	36659	SPL Brake Pad for 1/8 Cars	31.95
40073	Bearing, 4x8 Flange	12.95	40642	Antenna Pipe Fixing Nut	2.95
40074	6x10 Ball Bearing	17.95	40633	Shock Cap, 13mm	18.95
49009	SPL CNC Brake Disk	19.95	40634	Shock Spring Adjuster	9.95
40112	2-Speed Shaft	9.95	40635	Shock Shaft Dust Covers	5.95
40120	8mm Cap Joint for Brake	11.95	40636	15x1 O-Ring	3.95
40560	Servo Saver Connecting Plate	12.50	40637	Dust Felt for Shock Absorber	1.95
40563	Alum. Servo Saver Tube	9.95	40638	Shock Piston, 13mm	7.95
40511	Servo Saver Post	6.95	40640	Shock Pressure Top, Orange	5.95
40512	Center Diff. Mount Post	13.95	10052	Spring Muffler Stay	4.95
40513	Diff. Gear (small & large)	16.95	40736	DM-1 Shock Shaft	7.95